

SCHEDULE OF QUANTITIES
IL 83 (BUSSE RD) AT GROVE AVENUE / SHERWOOD DRIVE

NO.	QUANT.	UNIT	DESCRIPTION
1.	1	EACH	MAINTENANCE OF EXISTING TRAFFIC SIGNAL INSTALLATION
2.	4	EACH	TRAFFIC SIGNAL POST, GALVANIZED STEEL 14 FT.
3.	1	EACH	TRAFFIC SIGNAL POST, GALVANIZED STEEL 16 FT.
4.	2	EACH	PEDESTRIAN SIGNAL HEAD, LED, 1-FACE, BRACKET MOUNTED WITH COUNTDOWN TIMER
5.	2	EACH	PEDESTRIAN PUSH-BUTTON
6.	8	EACH	RELOCATE EXISTING SIGNAL HEAD
7.	1	EACH	MODIFY EXISTING CONTROLLER CABINET
8.	1	EACH	REMOVE EXISTING TRAFFIC SIGNAL EQUIPMENT
9.	1	EACH	UNINTERRUPTABLE POWER SUPPLY, SPECIAL

- CONSTRUCTION NOTES:**
- REMOVE EXISTING SIGNAL HEADS AND REPLACE EXISTING 14 FOOT PAINTED POST. INSTALL EXISTING SIGNAL HEADS ON NEW 14 FOOT GALVANIZED STEEL POST. REUSE EXISTING TYPE "A" CONCRETE FOUNDATION AND EXISTING CABLES.
 - REMOVE EXISTING SIGNAL HEADS AND REPLACE EXISTING 16 FOOT PAINTED POST. INSTALL EXISTING SIGNAL HEADS ON NEW 16 FOOT GALVANIZED STEEL POST. REUSE EXISTING TYPE "A" CONCRETE FOUNDATION AND EXISTING CABLES.
 - REMOVE EXISTING PEDESTRIAN SIGNAL HEAD AND PUSH-BUTTON AND ABANDON ALL EXISTING CABLES.
 - REMOVE THE EXISTING PEDESTRIAN PUSH-BUTTON FROM THE POST AND INSTALL A NEW PEDESTRIAN PUSH-BUTTON ON MAST ARM USING SLACK FROM THE EXISTING ELECTRIC CABLE. ALL WORK TO PROPERLY INSTALL THE PEDESTRIAN PUSH-BUTTON ON THE MAST ARM ASSEMBLY SHALL BE INCLUDED IN THE COST OF THE PAY ITEM "PEDESTRIAN PUSH BUTTON"

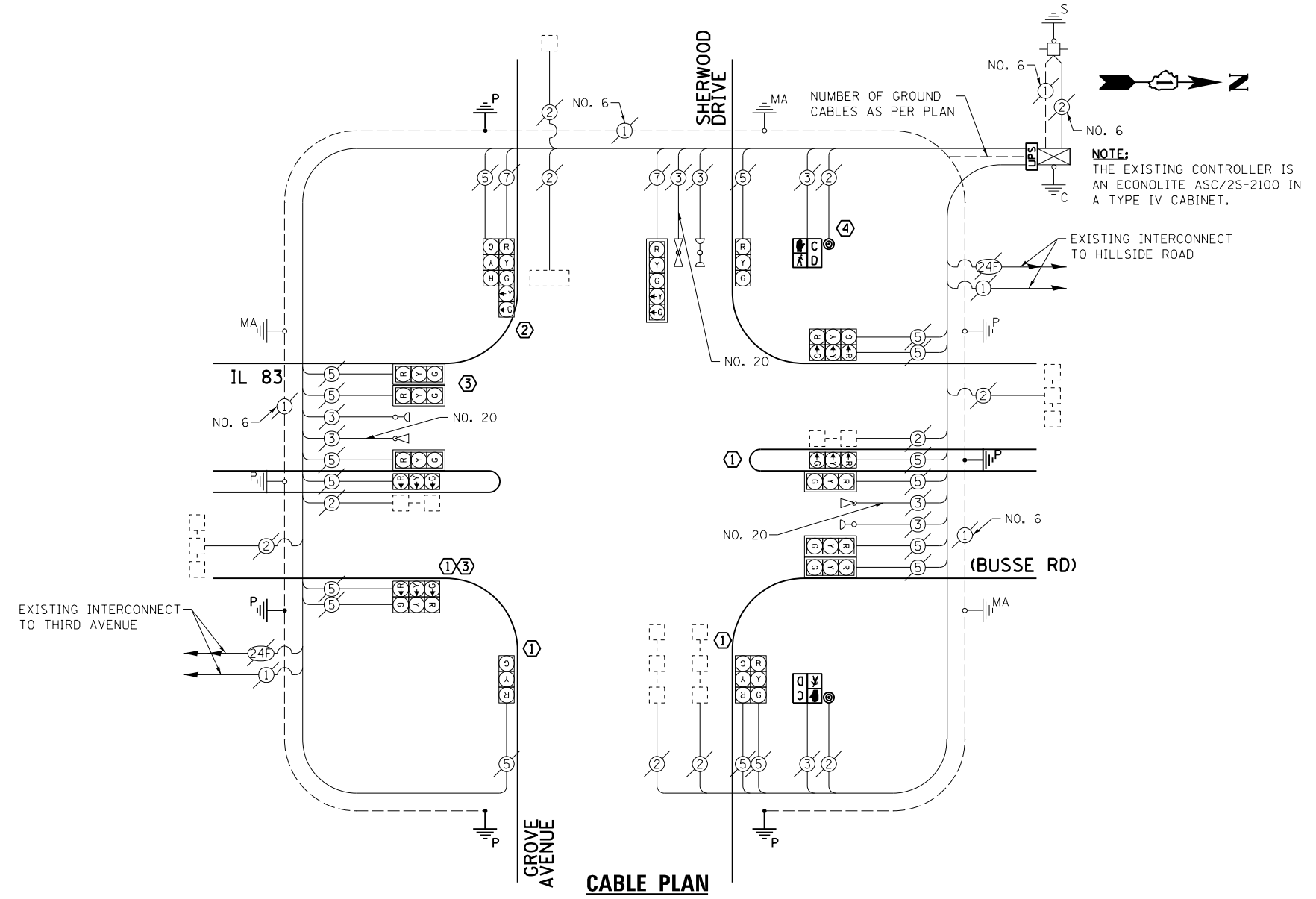

THE FOLLOWING ITEMS SHALL BE REMOVED BY THE CONTRACTOR AND SHALL BE DISPOSED OF BY THEM OUTSIDE THE RIGHT-OF-WAY AT THEIR EXPENSE. THE SALVAGE VALUE OF THE REMOVED EQUIPMENT SHALL BE REFLECTED IN THE CONTRACT BID PRICE.

- 5 EACH TRAFFIC SIGNAL POST
- 4 EACH PEDESTRIAN SIGNAL HEAD, 1-FACE
- 4 EACH PEDESTRIAN PUSH-BUTTON

I.D.O.T. TRAFFIC SIGNAL INSTALLATION ELECTRICAL SERVICE REQUIREMENTS					TOTAL WATTAGE
TYPE	NO. LAMPS	INCAND.	L.E.D.	OPERATION	
SIGNAL (RED)	19	135	17	0.50	161.5
SIGNAL (YELLOW)	19	135	25	0.25	118.75
SIGNAL (GREEN)	19	135	15	0.25	71.25
ARROW	4	135	12	0.10	4.8
PED. SIGNAL	2	90	25	1.00	50.0
CONTROLLER	1	-	100	1.00	100.0
LUMINAIRE	-	-	250	0.50	-
L.E.D. ST. NAME SIGN	-	-	64	0.50	-
VIDEO SYSTEM	-	-	150	1.00	-
BATTERY BACKUP	1	-	25	1.00	25.0
ILLUMINATED SIGN	-	-	25	0.05	-
TOTAL =					531.3

ENERGY COSTS - BILLED TO: IL DEPT. OF TRANSPORTATION
(ADDRESS) 201 W. CENTER COURT
(ADDRESS) SCHALMBURG, IL 60196-1096
ENERGY SUPPLY - CONTACT: JOE STACHO
PHONE: (630) 424-5704
COMPANY: CQM-ED

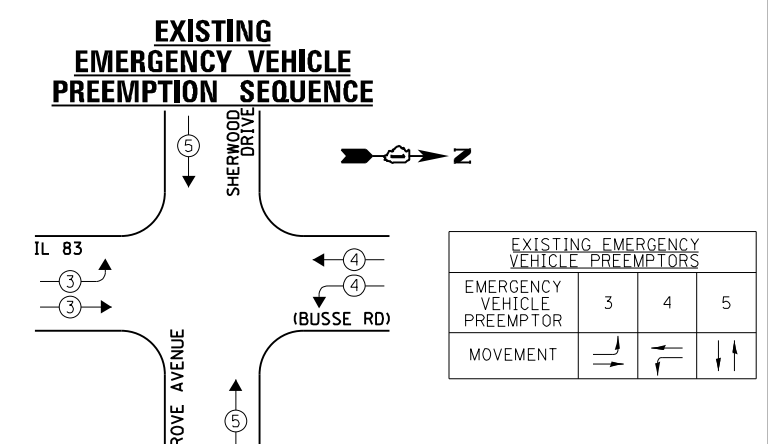
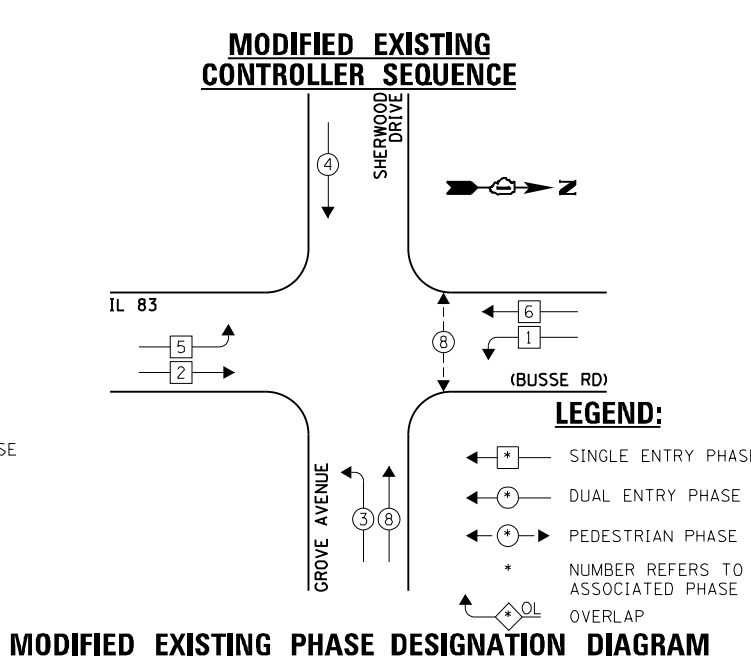
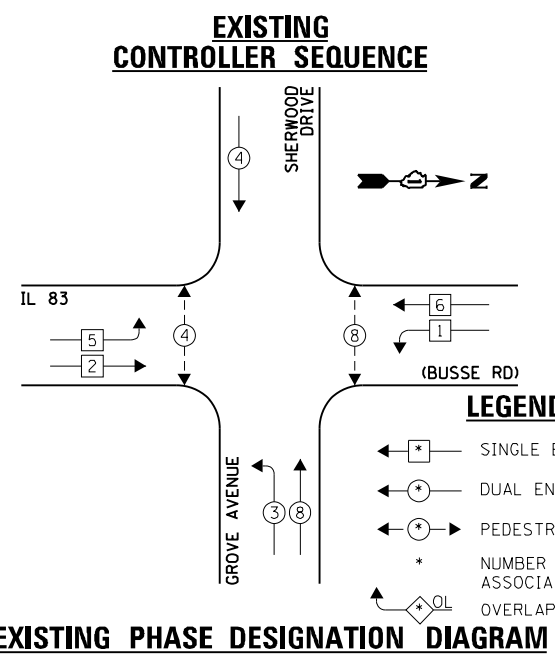

FILE NAME = 60V80-040-ts.dgn	USER NAME = zwallsten	DESIGNED - JRD	REVISED -
Default	PLOT SCALE = 1:20	DRAWN - ZCW	REVISED -
	PLOT DATE = 12/20/2012	CHECKED - KLB	REVISED -
		DATE - 12-20-12	REVISED -

STATE OF ILLINOIS
DEPARTMENT OF TRANSPORTATION

SCHEDULE OF QUANTITIES, CABLE PLAN, PHASE DESIGNATION DIAGRAM, & EMERGENCY VEHICLE PREEMPTION SEQUENCE			
IL 83 (BUSSE RD) AT GROVE AVENUE / SHERWOOD DRIVE			
SCALE: NONE	SHEET	OF SHEETS	STA. TO STA.

F.A. RTE. VARIES	SECTION 2012-070 I	COUNTY DuPAGE	TOTAL SHEETS 103	SHEET NO. 40
ILLINOIS FED. AID PROJECT			CONTRACT NO. 60V80	