

EC CURVE EAST RD-4	
PI STA.	= 34+69.98
Δ	= 6° 29' 39" (RT)
D	= 11° 27' 33"
R	= 500.00'
T	= 28.37'
L	= 56.67'
E	= 0.80'
θ	= NC
T.R.	= N/A
S.E. RUN	= N/A
P.C. STA.	= 34+41.61
P.T. STA.	= 34+98.28

**LEGEND:**

 MICRO-SURFACING, SINGLE PASS

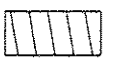
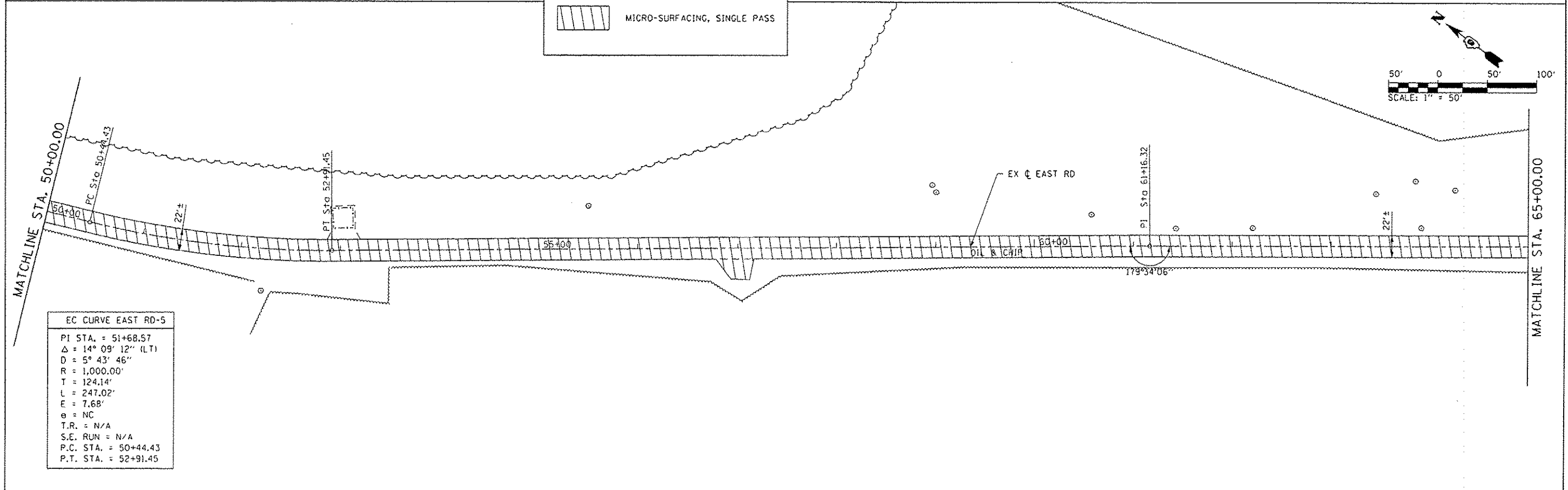
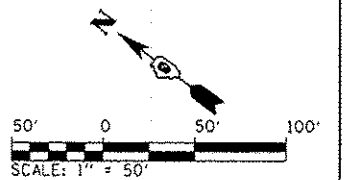

EC CURVE EAST RD-5	
PI STA.	= 51+68.57
Δ	= 14° 09' 12" (LT)
D	= 5° 43' 46"
R	= 1,000.00'
T	= 124.14'
L	= 247.02'
E	= 7.68'
θ	= NC
T.R.	= N/A
S.E. RUN	= N/A
P.C. STA.	= 50+44.43
P.T. STA.	= 52+91.45

FILE NAME * L:\10DOT\11866-10-11\Draw\CADD_Sheets\1808	USER NAME * Jack Blakemore PLAN 2.dgn	DESIGNED - JWB	REVISED -	<b>STATE OF ILLINOIS DEPARTMENT OF TRANSPORTATION</b>	<b>ROADWAY PLAN MERMET LAKE STATE FISH AND WILDLIFE AREA</b>	F.A. RTE.	SECTION	COUNTY	TOTAL SHEETS	SHEET NO.
PLOT SCALE * 100.0000 1/2 in.	CHECKED - SPH	REVISED -				PARK ROADS	MASSAC	16	8	
PLOT DATE * 12/21/2012	DATE - 12/21/2012	REVISED -							CONTRACT NO. 46253	
						SCALE: 1"=50'	SHEET NO. 2 OF 5 SHEETS	STA. 35+00.00 TO STA. 65+00.00	[ILLINOIS] FED. AID PROJECT	