

STATE OF ILLINOIS  
DEPARTMENT OF TRANSPORTATION

F.A.P. RTE.	SECTION	COUNTY	TOTAL SHEETS	SHEET NO.
753	(142BR,BR1,BR2,143BR)BRR	CHRISTIAN	17	1
		ILLINOIS	CONTRACT NO. 72749	

D-96-058-24

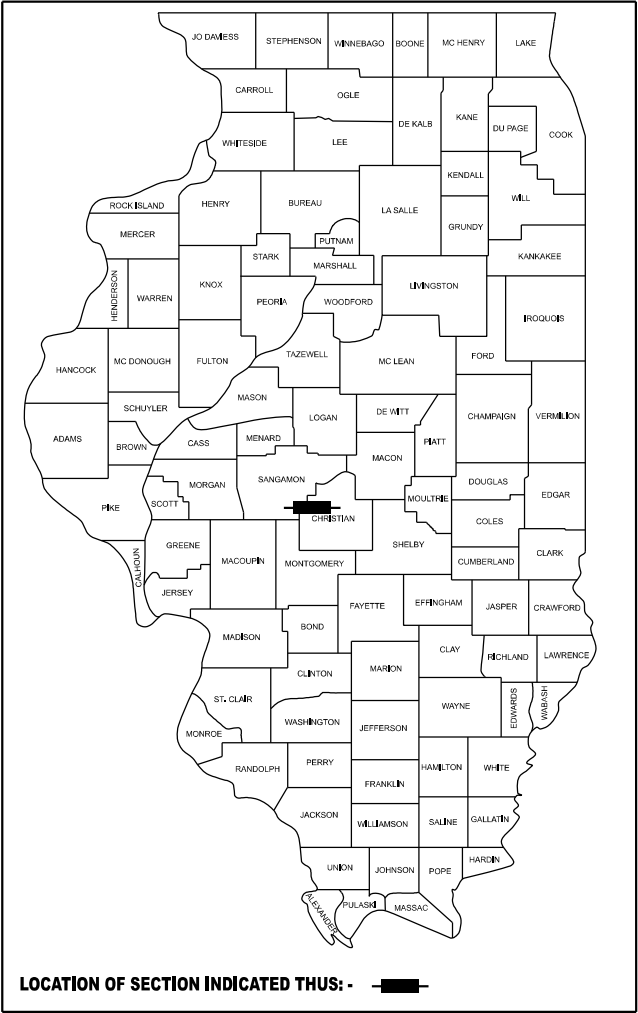

LOCATION OF SECTION INDICATED THUS: -

FOR INDEX OF SHEETS, SEE SHEET NO. 2

PROPOSED  
HIGHWAY PLANS

FAP ROUTE 753 (IL 104)  
SECTION (142BR,BR1,BR2,143BR)BRR  
PROJECT (STATE ONLY)  
BRIDGE PATCHING  
CHRISTIAN COUNTY  
C-96-080-24



LOCATION #1:  
SN 011-0019  
IL 104 OVER  
LAKE SANGCHRIS  
0.25 MI E SANGAMON CO

LOCATION #2:  
SN 011-0020  
IL 104 OVER  
LAKE SANGCHRIS  
1.5 MI E SANGAMON CO

LOCATION #3:  
SN 011-0021  
IL 104 OVER  
LAKE SANGCHRIS  
1.0 MI W TOVEY

LOCATION #4:  
SN 011-0022  
IL 104 OVER  
LAKE SANGCHRIS  
0.75 MI W BULPITT

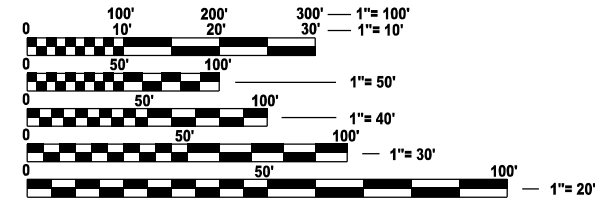

FULL SIZE PLANS HAVE BEEN PREPARED USING STANDARD  
ENGINEERING SCALES. REDUCED SIZED PLANS WILL NOT  
CONFORM TO STANDARD SCALES. IN MAKING MEASUREMENTS  
ON REDUCED PLANS, THE ABOVE SCALES MAY BE USED.

J.U.L.I.E.  
JOINT UTILITY LOCATION INFORMATION FOR EXCAVATION  
1-800-892-0123  
OR 811

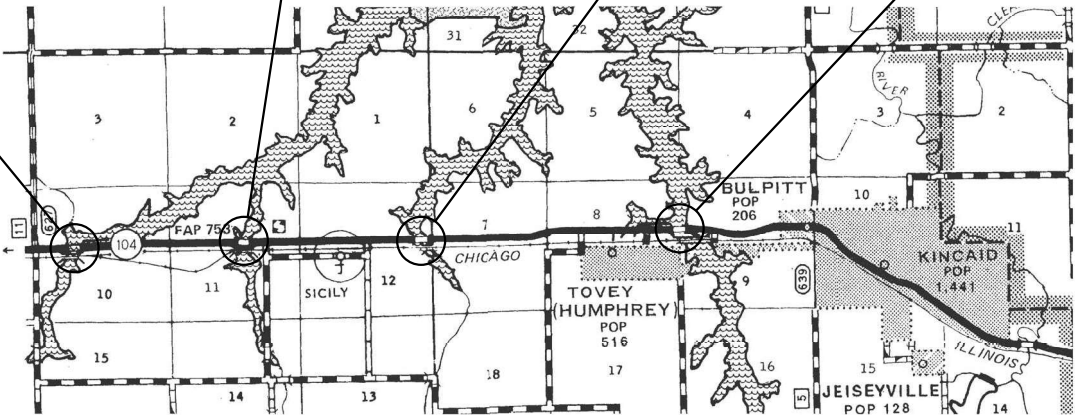

PROJECT ENGINEER: BRANDON DUDLEY - (217-785-9290)  
PROJECT MANAGER

CONTRACT NO. 72749

GROSS LENGTH = x.xx FT. = x.xxx MILE  
NET LENGTH = x.xx FT. = x.xxx MILE

STATE OF ILLINOIS  
DEPARTMENT OF TRANSPORTATION

SUBMITTED December 10 20 24

*Jeff P. Meyer*  
REGIONAL ENGINEER

January 31 20 25  
*Scott A. Etkin*  
ENGINEER OF DESIGN AND ENVIRONMENT

January 31 20 25  
*Jeffrey S. Perry*  
DIRECTOR OF HIGHWAYS PROJECT IMPLEMENTATION

PRINTED BY THE AUTHORITY  
OF THE STATE OF ILLINOIS

INDEX OF SHEETS

- 1 COVER SHEET
- 2 INDEX, STANDARDS, GENERAL NOTES, & SIGNATURES
- 3 SUMMARY OF QUANTITIES
- 4-5 TRAFFIC CONTROL DETAILS
- 6-8 BRIDGE PLANS, SN 011-0019
- 9-11 BRIDGE PLANS, SN 011-0020
- 12-14 BRIDGE PLANS, SN 011-0021
- 15-17 BRIDGE PLANS, SN 011-0022

HIGHWAY STANDARDS

- 000001-08
- 001006
- 701001-02
- 701006-05
- 701301-04
- 701311-03
- 701316-14
- 701901-10
- 780001-05

GENERAL NOTES:

TRAFFIC CONTROL AT SN 011-0021 SHALL CONFORM TO THE DETAIL ON SHEET 5. TRAFFIC CONTROL AT ALL OTHER LOCATIONS SHALL BE PER STANDARD DETAIL 701316.

STATE OF ILLINOIS  
DEPARTMENT OF TRANSPORTATION  
DIVISION OF HIGHWAYS  
DISTRICT 6

EXAMINED

December 10,

20

24



ENGINEER OF OPERATIONS

EXAMINED

December 9,

20

24



ENGINEER OF PROJECT IMPLEMENTATION

EXAMINED

December 11,

20

24



ENGINEER OF PROGRAM DEVELOPMENT

MODEL: index (Sheet)  
FILE NAME: c:\pw\_workspace\brandon.dudley\mtd100696672749 plansheet.dgn

	USER NAME = brandon.dudley	DESIGNED -	REVISED -	STATE OF ILLINOIS DEPARTMENT OF TRANSPORTATION	INDEX OF SHEETS, HIGHWAY STANDARDS GENERAL NOTES, & SIGNATURES	F.A.P	SECTION	COUNTY	TOTAL	SHEET
		DRAWN -	REVISED -			RTE.			SHEETS	NO.
		CHECKED -	REVISED -			753	(142BR,BR1,BR2,143BR)BRR	CHRISTIAN	17	2
	PLOT DATE = 10/30/2024	DATE -	REVISED -			CONTRACT NO. 72749				
	SCALE:					SHEET 1	OF 1	SHEETS	STA.	TO STA.
							ILLINOIS	FED. AID PROJECT		

MODEL: .soq [Sheet]  
FILE NAME: c:\p\work\pwt\td\du\du\c\m\1006966\72749\_plansheet.dgn

CODE NO.	ITEM	UNIT	TOTAL QUANTITY	0-02179-6019	0-02179-6019	0-02179-6019	0-02179-6019
				SN 011-0019	SN 011-0020	SN 011-0021	SN 011-0022
				100% STATE	100% STATE	100% STATE	100% STATE
				BRIDGE	BRIDGE	BRIDGE	BRIDGE
				0047	0047	0047	0047
				RURAL	RURAL	RURAL	RURAL
50300300	PROTECTIVE COAT	SQ YD	253	47	74	78	54
67100100	MOBILIZATION	L SUM	1	0.25	0.25	0.25	0.25
70100100	TRAFFIC CONTROL AND PROTECTION, STANDARD 701316	EACH	4	1	1	1	1
70106500	TEMPORARY BRIDGE TRAFFIC SIGNALS	EACH	4	1	1	1	1
70106700	TEMPORARY RUMBLE STRIPS	EACH	24	6	6	6	6
70107025	CHANGEABLE MESSAGE SIGNS	CAL DAY	100	25	25	25	25
* 78009005	MODIFIED URETHANE PAVEMENT MARKING - LINE 5"	FOOT	4000	1000	1000	1000	1000
78300201	PAVEMENT MARKING REMOVAL - GRINDING	SQ FT	1400	350	350	350	350
X7200201	WIDTH RESTRICTION SIGNING	L SUM	1	0.25	0.25	0.25	0.25
Z0001800	APPROACH SLAB REPAIR (PARTIAL DEPTH)	SQ YD	177	37	57	38	45
Z0016200	DECK SLAB REPAIR (PARTIAL)	SQ YD	76	10	17	40	9
Z0032400	JOINT REPAIR	EACH	14	4	4	3	3
Z0032500	JOINT SEALING (PATCHES)	FOOT	4300	700	1300	1300	1000

\* SPECIALTY ITEM

	USER NAME = brandon.dudley	DESIGNED -	REVISED -	STATE OF ILLINOIS DEPARTMENT OF TRANSPORTATION	SUMMARY OF QUANTITIES			F.A.P RTE.	SECTION	COUNTY	TOTAL SHEETS	SHEET NO.
		DRAWN -	REVISED -					753	(142BR,BR1,BR2,143BR)BRR	CHRISTIAN	17	3
		CHECKED -	REVISED -					CONTRACT NO. 72749				
	PLOT DATE = 11/19/2024	DATE -	REVISED -		SCALE:	SHEET 1	OF 1 SHEETS	STA.	TO STA.	ILLINOIS FED. AID PROJECT		

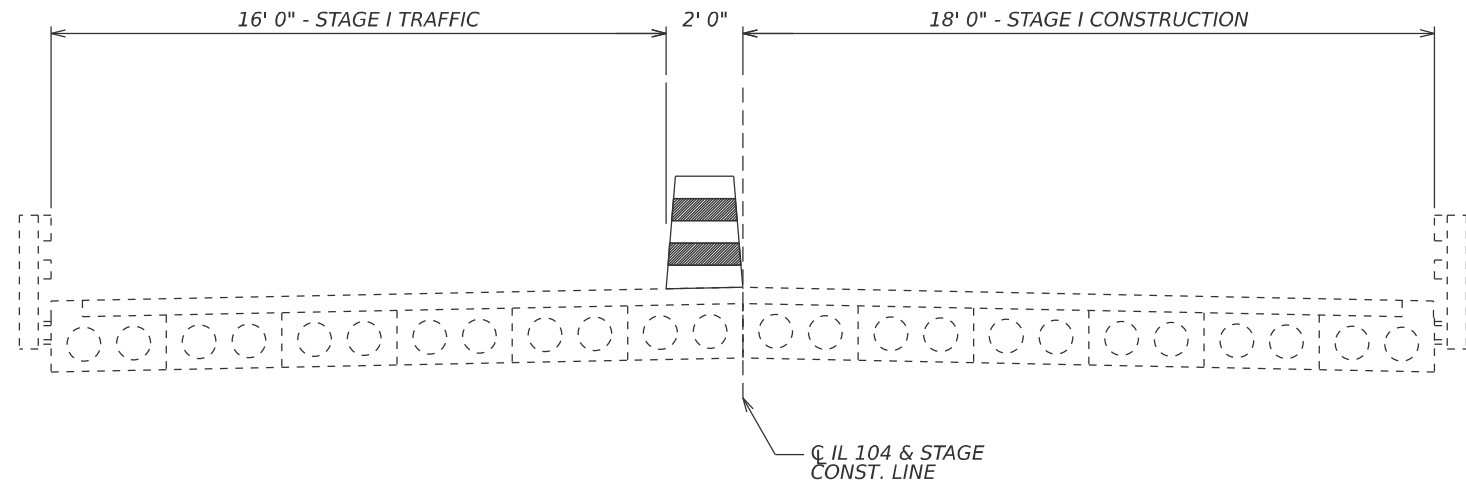

STAGE I TRAFFIC CROSS SECTION  
(LOOKING EAST)

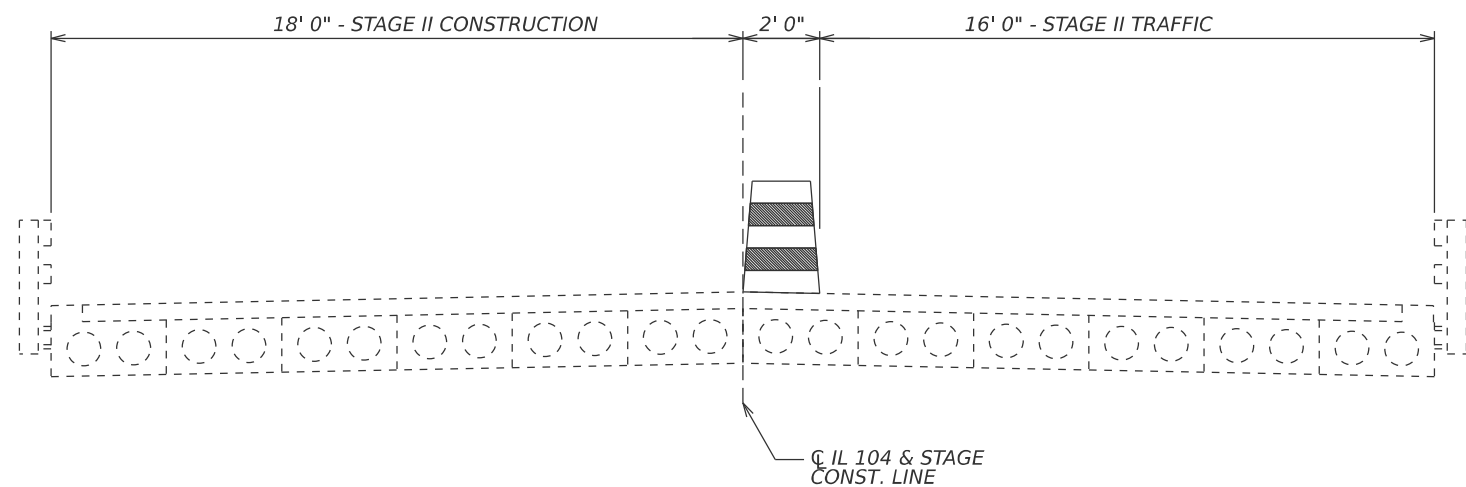

STAGE II TRAFFIC CROSS SECTION  
(LOOKING EAST)

MODEL: staging [Sheet]  
FILE NAME: c:\p\work\p\work\dudley\mld1006966\72749 plansheet.dgn

USER NAME = brandon.dudley	DESIGNED -	REVISED -
	DRAWN -	REVISED -
	CHECKED -	REVISED -
PLOT DATE = 10/30/2024	DATE -	REVISED -

STATE OF ILLINOIS  
DEPARTMENT OF TRANSPORTATION



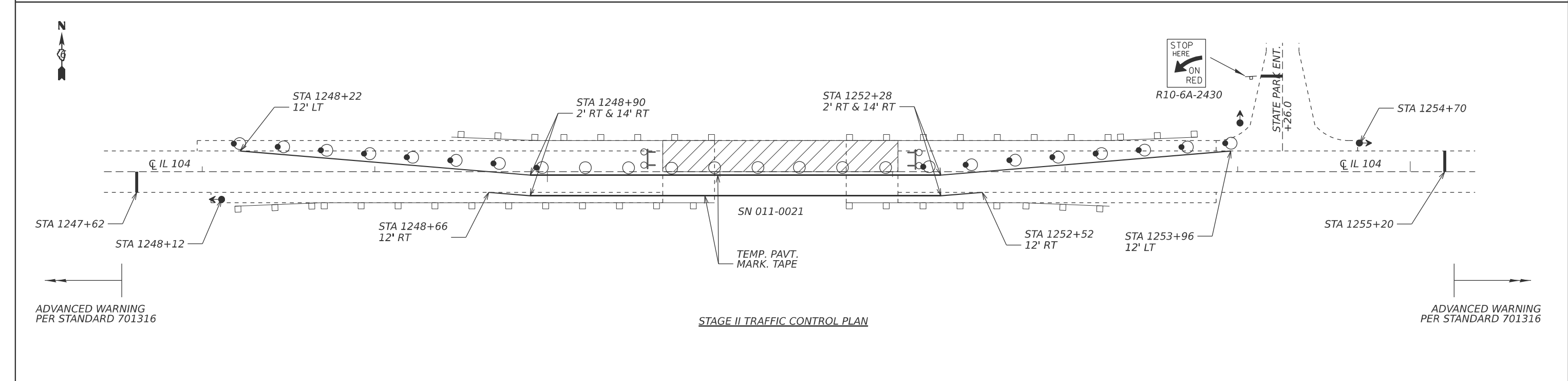
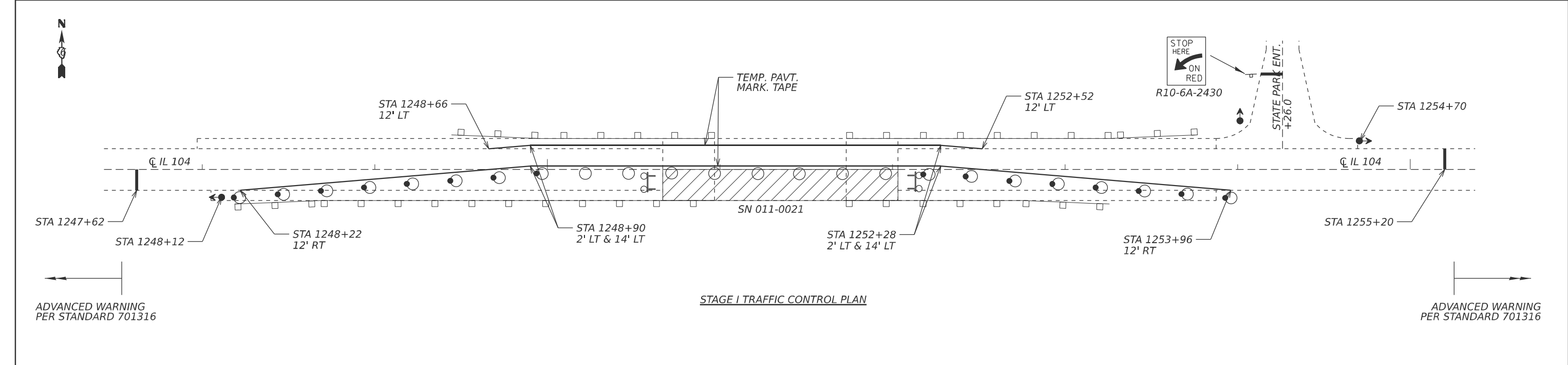

TYPICAL TRAFFIC STAGING DETAIL

SCALE: SHEET 1 OF 2 SHEETS STA. TO STA.

F.A.P RTE.	SECTION	COUNTY	TOTAL SHEETS	SHEET NO.
753	(142BR,BR1,BR2,143BR)BRR	CHRISTIAN	17	4
CONTRACT NO. 72749				
ILLINOIS FED. AID PROJECT				



**SYMBOLS**

-  WORK AREA
-  DRUM WITH STEADY BURN BI-DIRECTIONAL LIGHT
-  DRUM
-  TRAFFIC SIGNAL
-  TYPE III BARRICADE WITH FLASHING LIGHTS

- TRAFFIC CONTROL NOTES:**
- Traffic control devices not shown in this detail shall be per standard 701316. Devices and temporary pavement markings shown in this detail shall be included in the cost of TRAFFIC CONTROL AND PROTECTION, STANDARD 701316. Temporary rumble strips and temporary traffic signals shall be paid separately.
  - An additional traffic signal and R10-6A-2430 sign shall be provided at the Lake Sangchris State Park entrance at STA 1253±26, cost included in the bid price for TEMPORARY BRIDGE TRAFFIC SIGNALS.

MODEL: traffic [Sheet]  
FILE NAME: c:\p\work\pwork\dudley\cml\1006966\72749 plansheet.dgn

	USER NAME = brandon.dudley		DESIGNED -	REVISED -	STATE OF ILLINOIS DEPARTMENT OF TRANSPORTATION	TRAFFIC CONTROL PLAN SN 011-0021			F.A.P RTE.	SECTION	COUNTY	TOTAL SHEETS	SHEET NO.
			DRAWN -	REVISED -					753	(142BR,BR1,BR2,143BR)BRR	CHRISTIAN	17	5
			CHECKED -	REVISED -					CONTRACT NO. 72749				
	PLOT DATE = 10/30/2024		DATE -	REVISED -		SCALE:	SHEET 2	OF 2	SHEETS	STA.	TO STA.	ILLINOIS   FED. AID PROJECT	

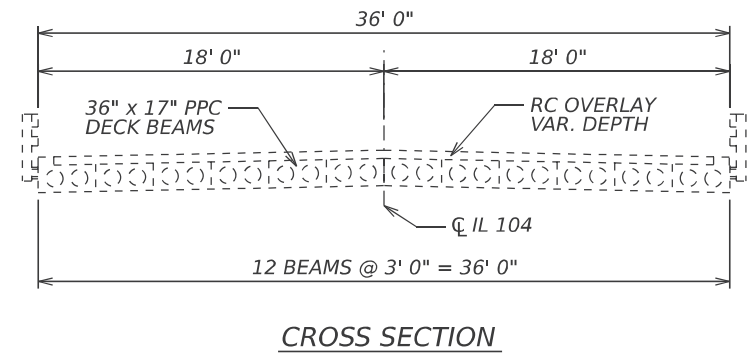

ITEM	UNIT	QUANTITY
Deck Slab Repair (Partial)	Sq. Yd.	10
Approach Slab Repair (Partial Depth)	Sq. Yd.	37
Joint Sealing (Patches)	Foot	700
Protective Coat	Sq. Yd.	47
Joint Repair	Each	4

FILE NAME:	USER NAME = brandon.dudley	DESIGNED - BRANDON DUDLEY	REVISED -	STATE OF ILLINOIS DEPARTMENT OF TRANSPORTATION	BRIDGE PLAN & ELEVATION SN 011-0019					F.A.P RTE.	SECTION		COUNTY	TOTAL SHEETS	SHEET NO.		
		DRAWN - BRANDON DUDLEY	REVISED -							753	(142BR,BR1,BR2,143BR)BRR		CHRISTIAN	17	6		
		CHECKED -	REVISED -							CONTRACT NO. 72749							
	PLOT DATE = 10/30/2024	DATE -	REVISED -		SCALE:	SHEET 1	OF 3 SHEETS	STA.	TO STA.								
											ILLINOIS FED. AID PROJECT						

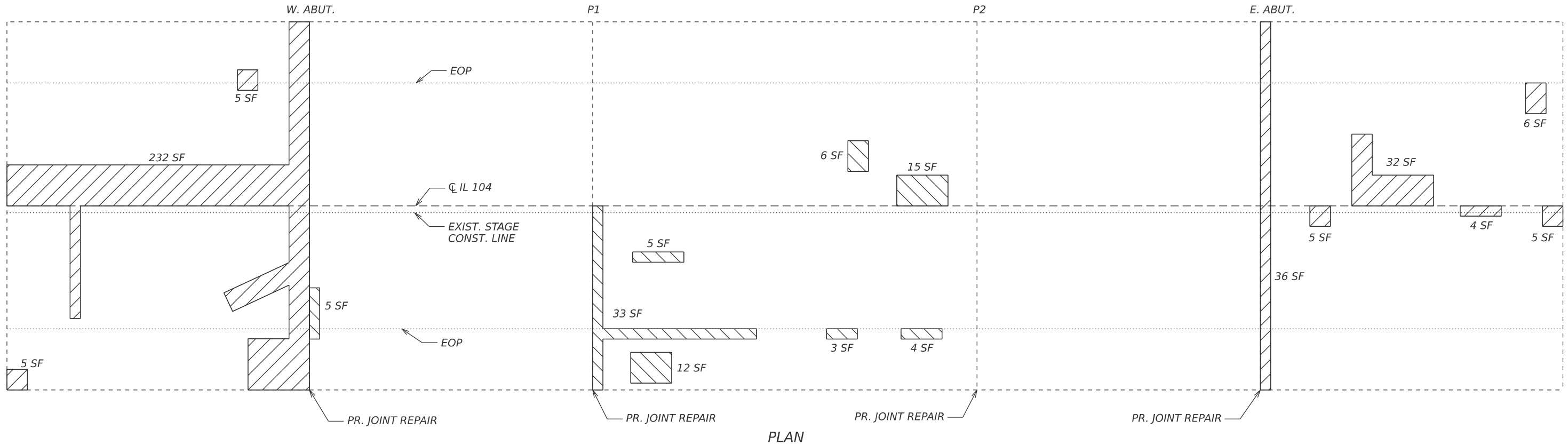

 Approach Slab Repair (Partial Depth)

 Deck Slab Repair (Partial)

*Patches adjacent to areas of joint repair shall have the joint opening formed similar to the existing joint. See sheet 3 of 3.*

ITEM	UNIT	QUANTITY
Deck Slab Repair (Partial)	Sq. Yd.	10
Approach Slab Repair (Partial Depth)	Sq. Yd.	37
Joint Sealing (Patches)	Foot	700
Protective Coat	Sq. Yd.	47
Joint Repair	Each	4

F.A.P RTE.	SECTION	COUNTY	TOTAL SHEETS	SHEET NO.
753	(142BR,BR1,BR2,143BR)BRR	CHRISTIAN	17	7
		CONTRACT NO. 72749		
		ILLINOIS	FED. AID PROJECT	

MODEL: bridge-2 [Sheet]  
FILE NAME: c:\pw\work\pwidot\dudleybm\d1006966\72749 plansheet.dgn

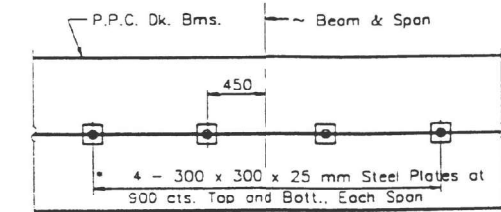

PLAN

- Space plates to miss Temporary Bridge Rail Posts.

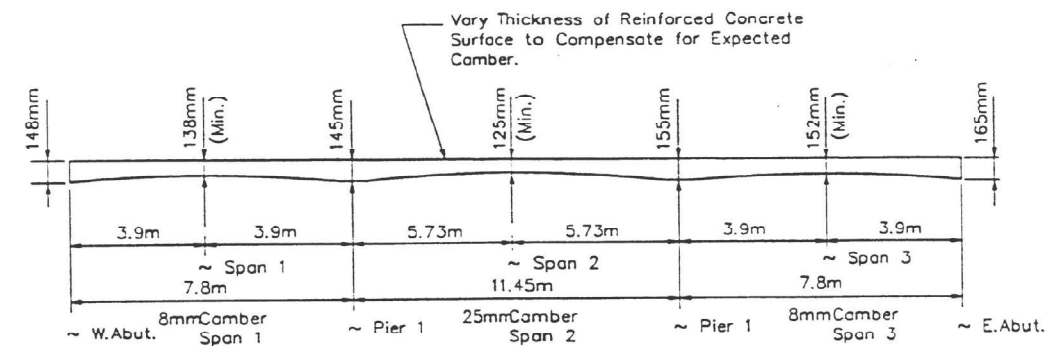

REINFORCED CONCRETE WEARING SURFACE POURING DIAGRAM

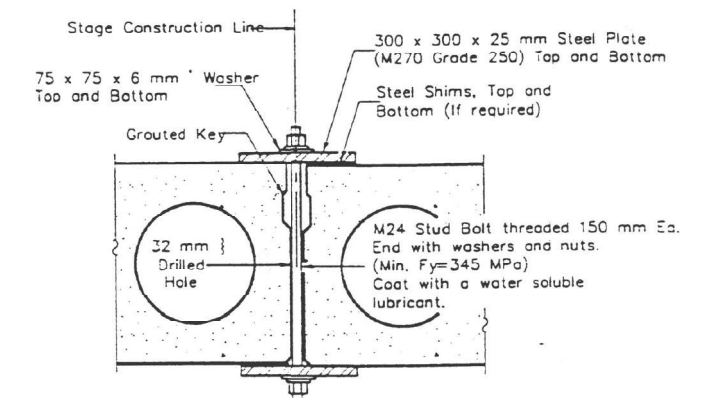

SECTION

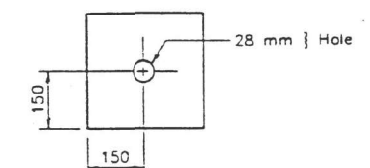

CLAMPING PLATE

SHEAR KEY CLAMPING DETAILS AT STAGE CONST. JT.

Cost included with Precast  
Prestressed Concrete Deck Beams.  
See Stage Construction Detail for traffic lane.



Dowel Rods shall be grouted after beams are in place and allowed to cure (minimum 24 hours) prior to grouting the shear keys.

MODEL: bridge-3 [Sheet]  
FILE NAME: c:\pw\_work\pwidot\dudleyb\m1100966\72749 plansheet.dgn



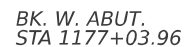

— EXIST. STAGE  
CONST. LINE

*Prior to pouring the new concrete deck, all heavy or loose rust, loose mill scale, and other loose or potentially detrimental foreign material shall be removed from the surfaces in contact with concrete. Tightly adhered paint may remain unless otherwise noted. Removal shall be accomplished by methods that will not damage the steel and the cost will be included in the pay item covering removal of the existing concrete.*

*Plan dimensions and details relative to the existing structure have been taken from existing plans and are subject to nominal construction variations. The Contractor shall field verify existing dimensions and details affecting new construction and make necessary approved adjustments prior to construction or ordering of materials. Such variations shall not be cause for additional compensation for a change in scope of the work, however, the Contractor will be paid for the quantity actually furnished at the unit price bid for the work.*

Areas of deck repairs shown are estimated. The Engineer shall show actual locations of deck repairs on As-built Plans.

*The Contractor shall use extreme care during concrete removal so as not to damage the PPC deck beams. Any damage to the beams shall be repaired at the Contractor's expense.*

*Protective coat to be applied to areas of new concrete only.*

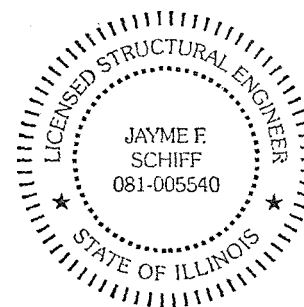

EXPIRES 11-30-2026

Jay F. Schiff

ITEM	UNIT	QUANTITY
Deck Slab Repair (Partial)	Sq. Yd.	17
Approach Slab Repair (Partial Depth)	Sq. Yd.	57
Joint Sealing (Patches)	Foot	1300
Protective Coat	Sq. Yd.	74
Joint Repair	Each	4

**STATE OF ILLINOIS**  
**DEPARTMENT OF TRANSPORTATION**

**BRIDGE PLAN & ELEVATION**  
**SN 011-0020**

SCALE:	SHEET 1	OF 3	SHEETS	STA.	TO STA.
--------	---------	------	--------	------	---------

F.A.P RTE.	SECTION	COUNTY	TOTAL SHEETS	SHEET NO.
753	(142BR,BR1.BR2,143BR)BRR	CHRISTIAN	17	9
		CONTRACT NO. 72749		
ILLINOIS		FED. AID PROJECT		

MODEL: bridge-4 [Sheet]  
FILE NAME: c:\pw work\pwidthot\dudleybm\d1006966\72749 plansheet.dgn

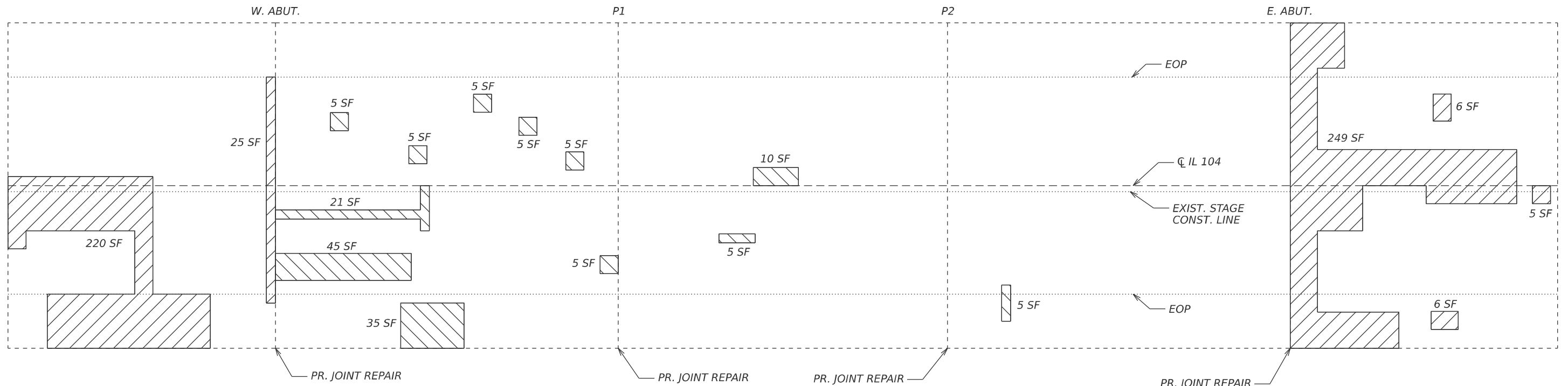

 *Approach Slab Repair (Partial Depth)*

 *Deck Slab Repair (Partial)*

ITEM	UNIT	QUANTITY
Deck Slab Repair (Partial)	Sq. Yd.	17
Approach Slab Repair (Partial Depth)	Sq. Yd.	57
Joint Sealing (Patches)	Foot	1300
Protective Coat	Sq. Yd.	74
Joint Repair	Each	4

F.A.P RTE.	SECTION	COUNTY	TOTAL SHEETS	SHEET NO.
753	(142BR,BR1,BR2,143BR)BRR	CHRISTIAN	17	10
		CONTRACT NO. 72749		
		ILLINOIS	FED. AID PROJECT	

MODEL: bridge-5 [Sheet]  
FILE NAME: c:\pw\_work\pwidot\dudleyb\m11006966\72749 plansheet.dgn

RELATE NO.	SECTION	SUBJECT	1ST CL. SHEET NO.	SHEET NO.
G. C.	F.A.P. 753	142BR-1 CHRISTIAN	75	34
FOL. FROM SHEET NO. 7		PAGE AND SUBJECT		

SHEET NO. 6  
10 SHEETS

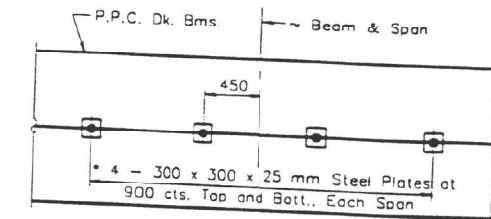
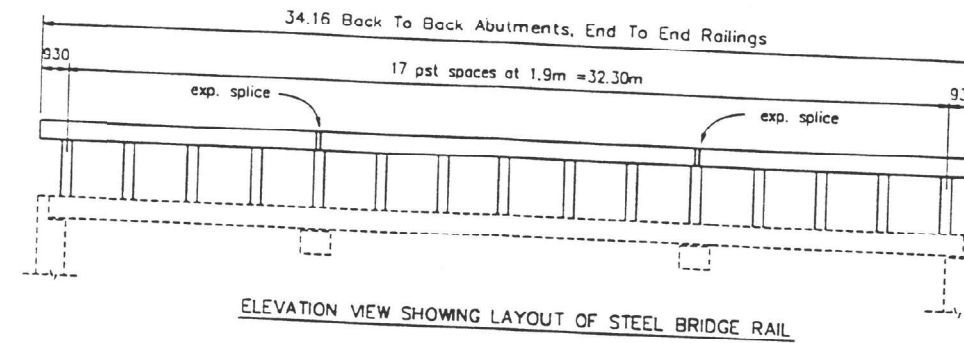

PLAN

- Space plates to miss Temporary Bridge Rail Posts.

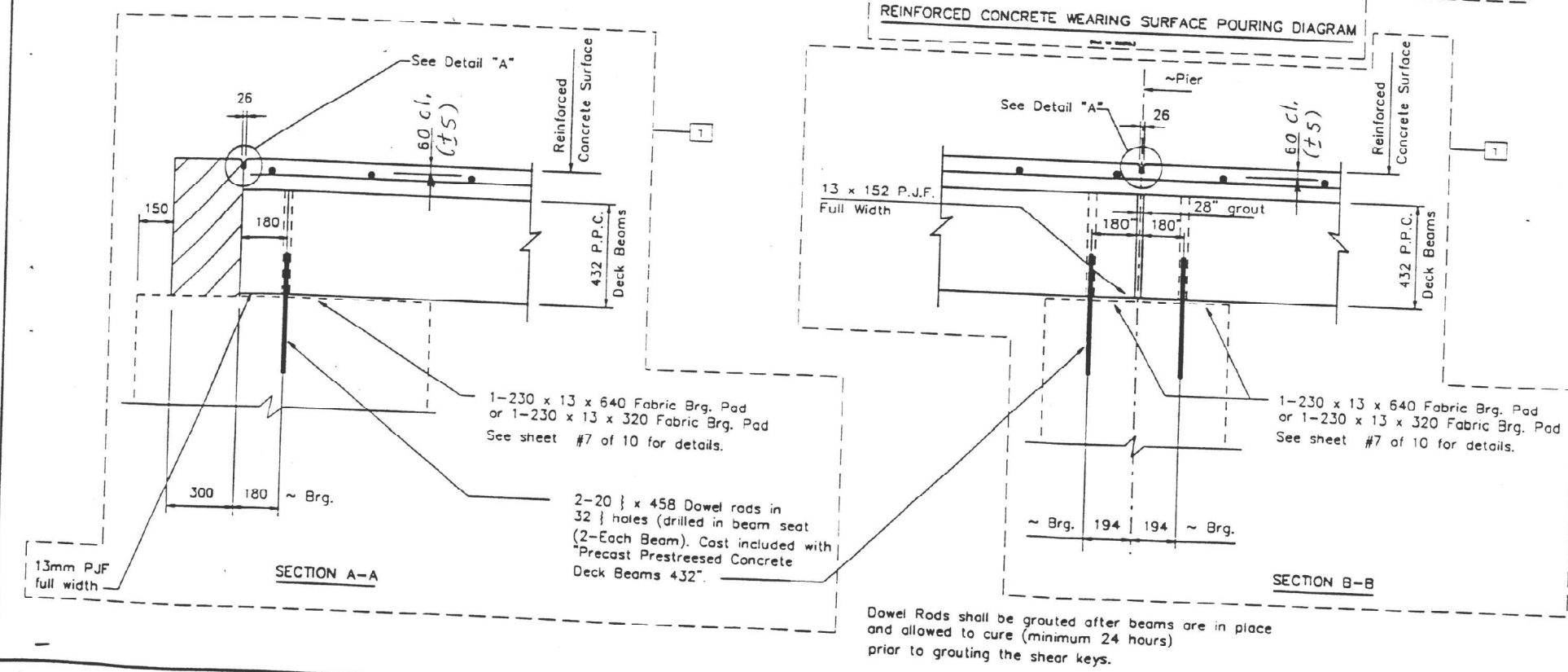
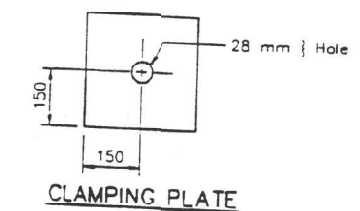
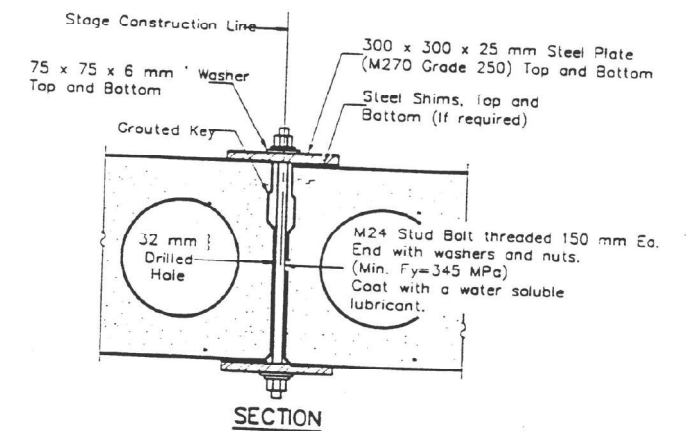
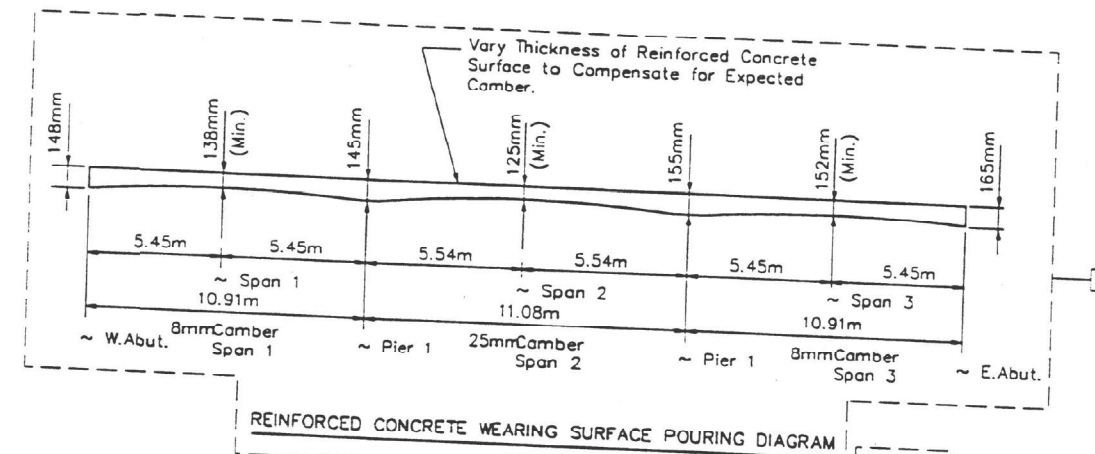

SHEAR KEY CLAMPING DETAILS AT STAGE CONST. JT.

Cost included with Precast  
Prestressed Concrete Deck Beams.  
See Stage Construction Detail for traffic lane.

SUPERSTRUCTURE DETAILS  
ILLINOIS ROUTE 104 OVER  
LAKE SANGCHRIS  
F.A.P. 753 SECTION 142BR-1  
STA. 2+511.57  
CHRISTIAN COUNTY, ILLINOIS  
STRUCTURE NO. 011-0020

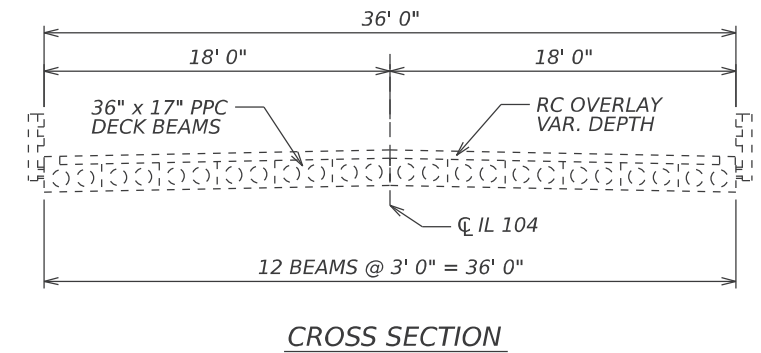

F.A.P RTE.	SECTION	COUNTY	TOTAL SHEETS	SHEET NO.
753	(142BR,BR1,BR2,143BR)BRR	CHRISTIAN	17	12
		CONTRACT NO. 72749		
		ILLINOIS	FED. AID PROJECT	

MODEL: bridge-7 [Sheet]  
FILE NAME: c:\pw\_work\pwidot\dudleybm\d1006966\72749 plansheet.dgn

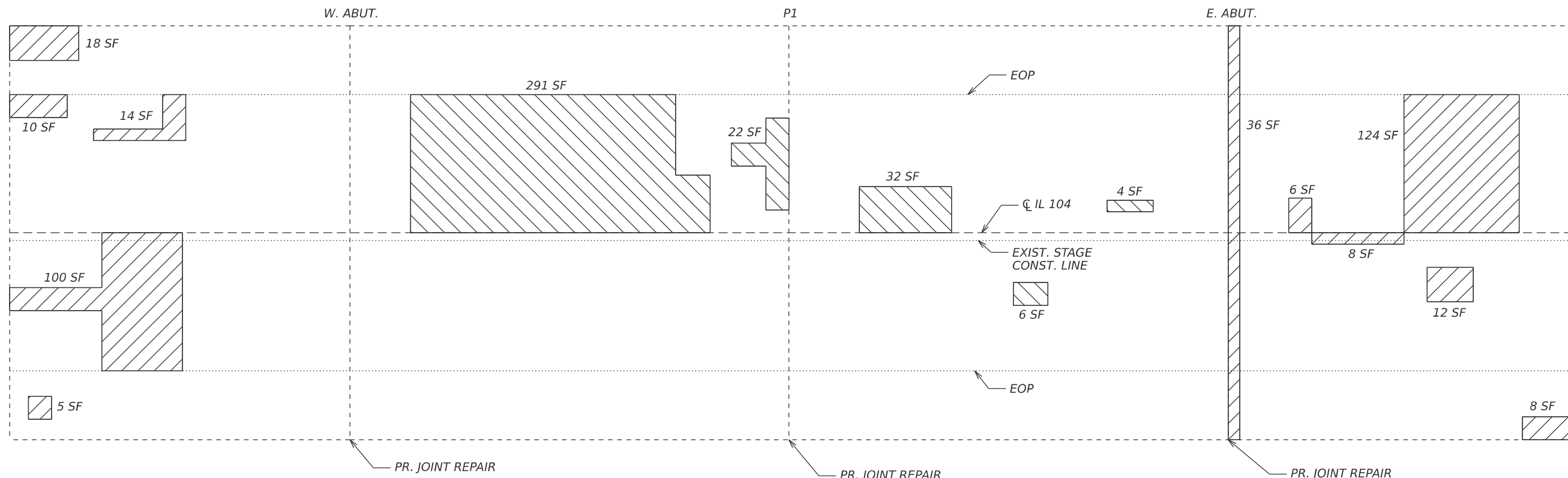

 *Approach Slab Repair (Partial Depth)*

 *Deck Slab Repair (Partial)*

Patches adjacent to areas of joint repair shall have the joint opening formed similar to the existing joint. See sheet 3 of 3.

ITEM	UNIT	QUANTITY
Deck Slab Repair (Partial)	Sq. Yd.	40
Approach Slab Repair (Partial Depth)	Sq. Yd.	38
Joint Sealing (Patches)	Foot	1300
Protective Coat	Sq. Yd.	78
Joint Repair	Each	3

F.A.P RTE.	SECTION	COUNTY	TOTAL SHEETS	SHEET NO.
753	(142BR,BR1,BR2,143BR)BRR	CHRISTIAN	17	13
		CONTRACT NO. 72749		
ILLINOIS		FED. AID PROJECT		

MODEL: bridge-8 [Sheet]  
FILE NAME: c:\pw work\pwidot\dudlevbm\d1006966\72749 plansheet.dgn

MODEL: bridge-61 (Sheet)  
FILE NAME: c:\p\work\illinois\bridge\1006966\72749 plansheet.dgn

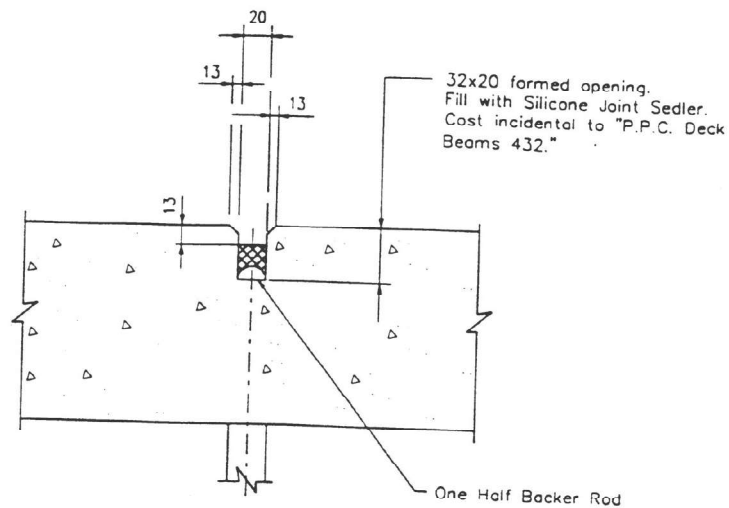

DETAIL "A"

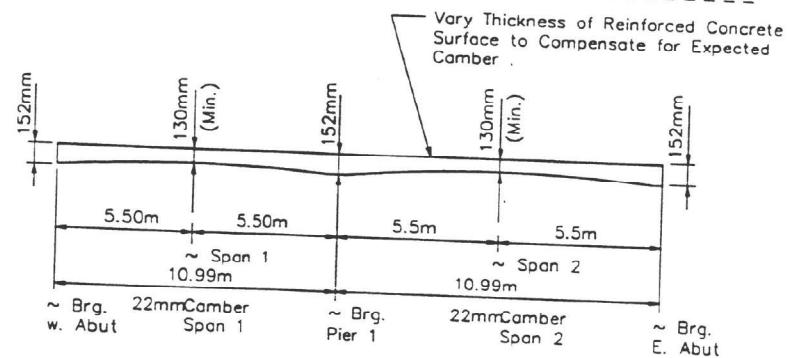
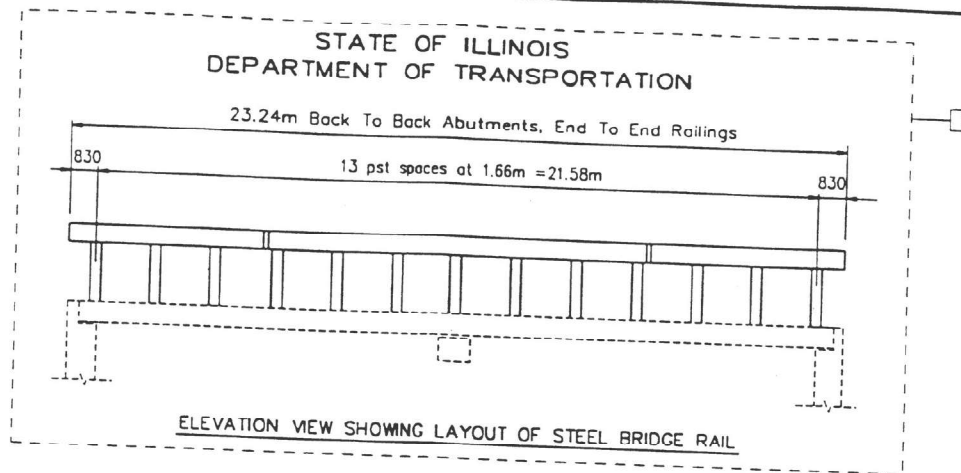

REINFORCED CONCRETE WEARING SURFACE POURING DIAGRAM  
(Not to Scale:)

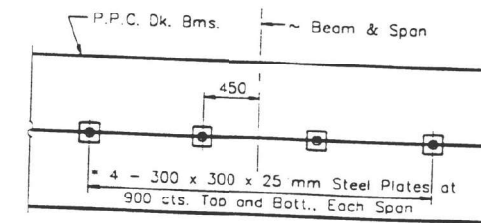

PLAN

\* Space plates to miss Temporary Bridge Rail Posts.

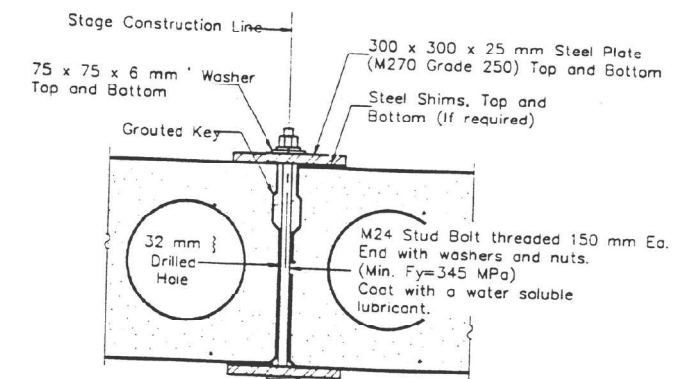

SECTION

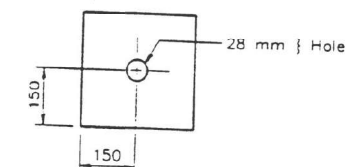

CLAMPING PLATE

SHEAR KEY CLAMPING DETAILS AT STAGE CONST. JT.

Cost incidental with Precast  
Prestressed Concrete Deck Beams.  
See Stage Construction Detail for traffic lane.

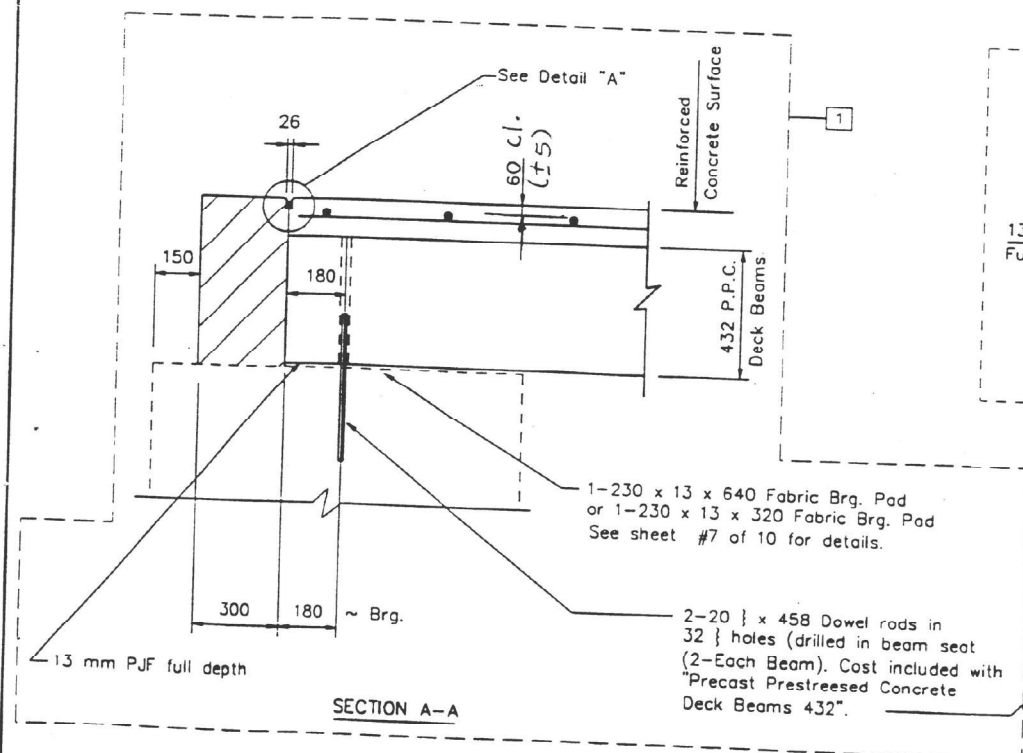

SECTION A-A

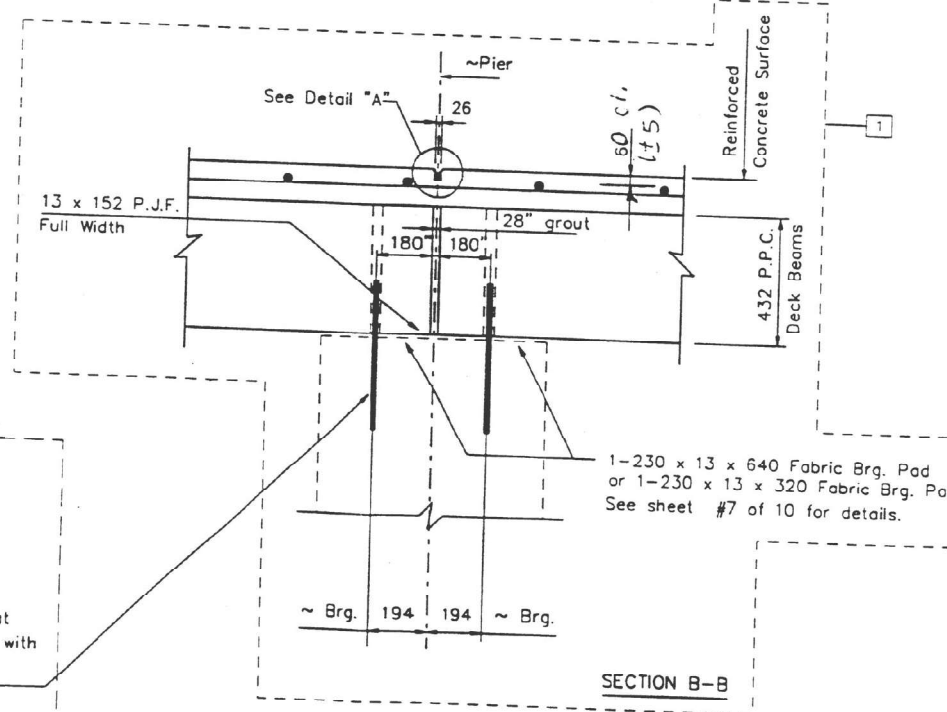

SECTION B-B

Dowel Rods shall be grouted after beams are in place  
and allowed to cure (minimum 24 hours)  
prior to grouting the shear keys.

SUPERSTRUCTURE DETAILS  
ILLINOIS ROUTE 104 OVER  
LAKE SANGCHRIS  
F.A.P. 753 SECTION 142BR-2  
STA. 3+648.75  
CHRISTIAN COUNTY, ILLINOIS  
STRUCTURE NO. 011-0021

1 AS REVISED 9-2-1998

USER NAME = brandon.dudley	DESIGNED -	REVISED -
	DRAWN -	REVISED -
	CHECKED -	REVISED -
PLOT DATE = 10/30/2024	DATE -	REVISED -

STATE OF ILLINOIS  
DEPARTMENT OF TRANSPORTATION

EXISTING OVERLAY DETAILS  
SN 011-0021 (FOR INFORMATION ONLY)

SCALE: SHEET 3 OF 3 SHEETS STA. TO STA.

F.A.P. RTE.	SECTION	COUNTY	TOTAL SHEETS	SHEET NO.
753	(142BR, BR1, BR2, 143BR) BRR	CHRISTIAN	17	14
CONTRACT NO. 72749				
ILLINOIS FED. AID PROJECT				

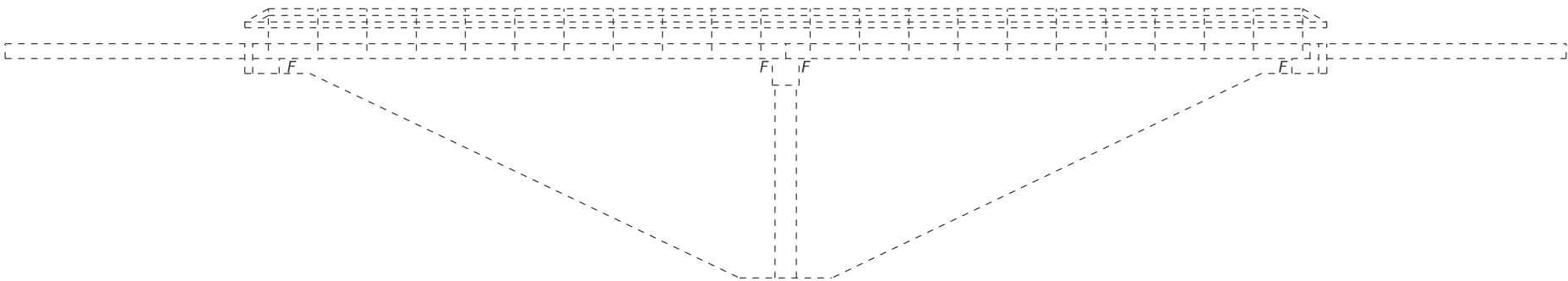

ELEVATION

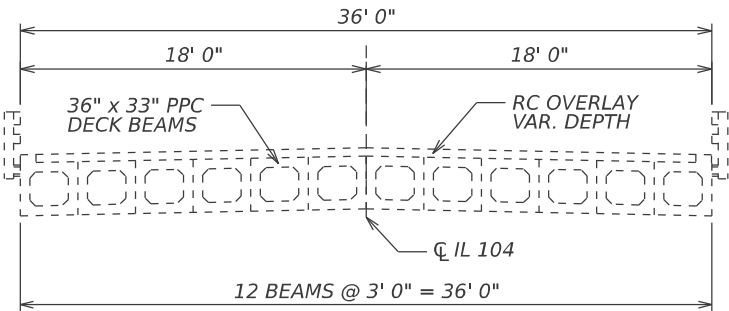

CROSS SECTION

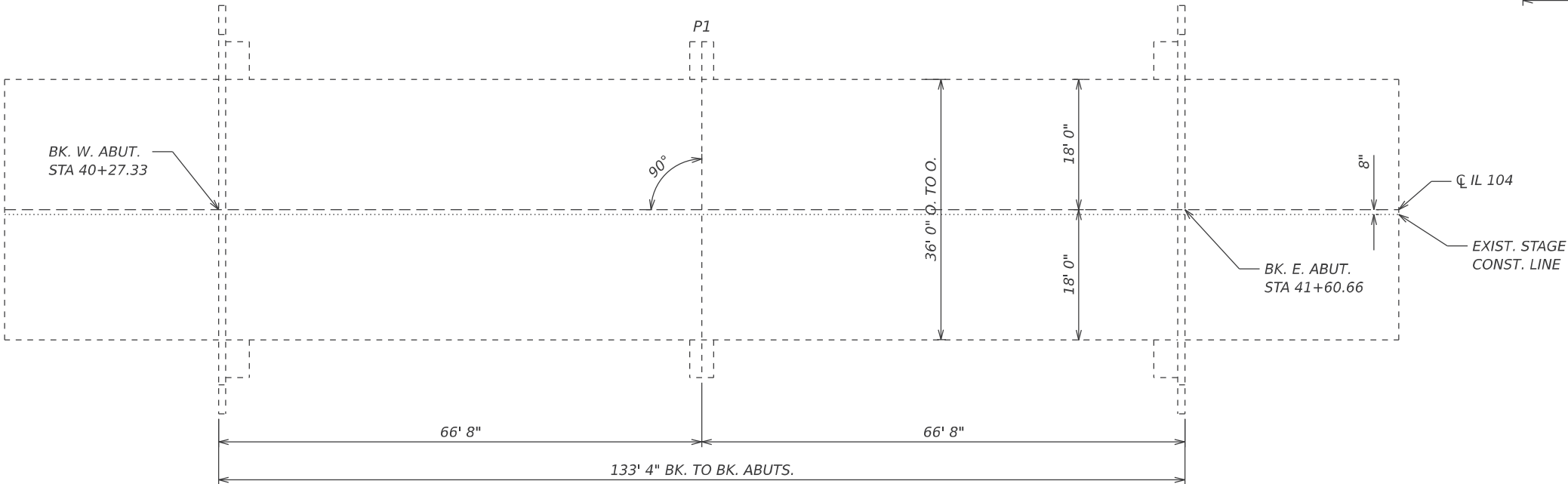

PLAN

GENERAL NOTES

Prior to pouring the new concrete deck, all heavy or loose rust, loose mill scale, and other loose or potentially detrimental foreign material shall be removed from the surfaces in contact with concrete. Tightly adhered paint may remain unless otherwise noted. Removal shall be accomplished by methods that will not damage the steel and the cost will be included in the pay item covering removal of the existing concrete.

Plan dimensions and details relative to the existing structure have been taken from existing plans and are subject to nominal construction variations. The Contractor shall field verify existing dimensions and details affecting new construction and make necessary approved adjustments prior to construction or ordering of materials. Such variations shall not be cause for additional compensation for a change in scope of the work, however, the Contractor will be paid for the quantity actually furnished at the unit price bid for the work.

Areas of deck repairs shown are estimated. The Engineer shall show actual locations of deck repairs on As-built Plans.

The Contractor shall use extreme care during concrete removal so as not to damage the PPC deck beams. Any damage to the beams shall be repaired at the Contractor's expense.

Protective coat to be applied to areas of new concrete only.

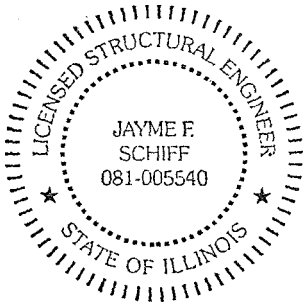

EXPIRES 11-30-2026

Jayme F. Schiff

TOTAL BILL OF MATERIAL (SN 011-0022)

ITEM	UNIT	QUANTITY
Deck Slab Repair (Partial)	Sq. Yd.	9
Approach Slab Repair (Partial Depth)	Sq. Yd.	45
Joint Sealing (Patches)	Foot	1000
Protective Coat	Sq. Yd.	54
Joint Repair	Each	3

MODEL: bridge-10-1 (Sheet)  
FILE NAME: c:\p\work\jw\tdudley\cml\1006966\72749 plansheet.dgn

USER NAME = brandon.dudley	DESIGNED - BRANDON DUDLEY	REVISED -
	DRAWN - BRANDON DUDLEY	REVISED -
	CHECKED -	REVISED -
PLOT DATE = 10/30/2024	DATE -	REVISED -

STATE OF ILLINOIS  
DEPARTMENT OF TRANSPORTATION

BRIDGE PLAN & ELEVATION  
SN 011-0022

SCALE: SHEET 1 OF 3 SHEETS STA. TO STA.

F.A.P. RTE.	SECTION	COUNTY	TOTAL SHEETS	SHEET NO.
753	(142BR,BR1,BR2,143BR)BRR	CHRISTIAN	17	15
CONTRACT NO. 72749				
ILLINOIS FED. AID PROJECT				

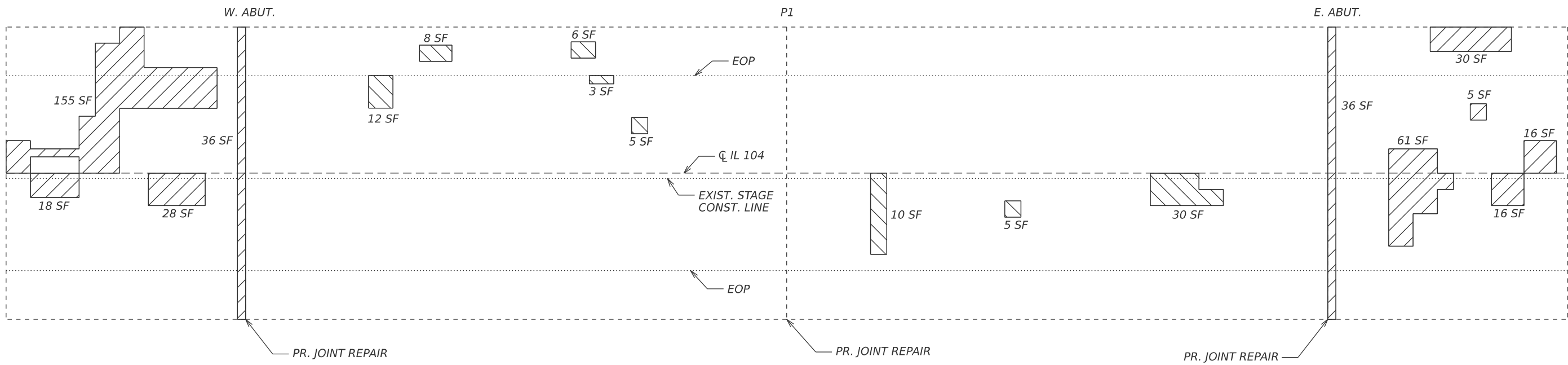

## PLAN



*Patches adjacent to areas of joint repair shall have the joint opening formed similar to the existing joint. See sheet 3 of 3.*

## SLAB REPAIR BILL OF MATERIAL

ITEM	UNIT	QUANTITY
Deck Slab Repair (Partial)	Sq. Yd.	9
Approach Slab Repair (Partial Depth)	Sq. Yd.	45
Joint Sealing (Patches)	Foot	1000
Protective Coat	Sq. Yd.	54
Joint Repair	Each	3

USER NAME = brandon.dudley	DESIGNED -	REVISED -
	DRAWN -	REVISED -
	CHECKED -	REVISED -
PLOT DATE = 10/30/2024	DATE -	REVISED -

**STATE OF ILLINOIS**  
**DEPARTMENT OF TRANSPORTATION**

## SLAB REPAIR DETAILS

### SN 011-0022

SCALE:	SHEET 2	OF 3	SHEETS	STA.	TO STA.
--------	---------	------	--------	------	---------

F.A.P RTE.	SECTION	COUNTY	TOTAL SHEETS	SHEET NO.
753	(142BR,BR1,BR2,143BR)BRR	CHRISTIAN	17	16
		CONTRACT NO. 72749		
ILLINOIS		FED. AID PROJECT		

MODEL: bridge-11-1 [Sheet]  
FILE NAME: c:\pw work\pwidot\dudleyb\m\1006966\72749 plansheet.dgn



STATE OF ILLINOIS  
DEPARTMENT OF TRANSPORTATION

ROUTE NO.	SECTION	COUNTY	TOTAL SHEETS	SHEET NO.
F.A.P. 753	143BR	CHRISTIAN	75	54
SHEET NO. 6				
9 SHEETS				

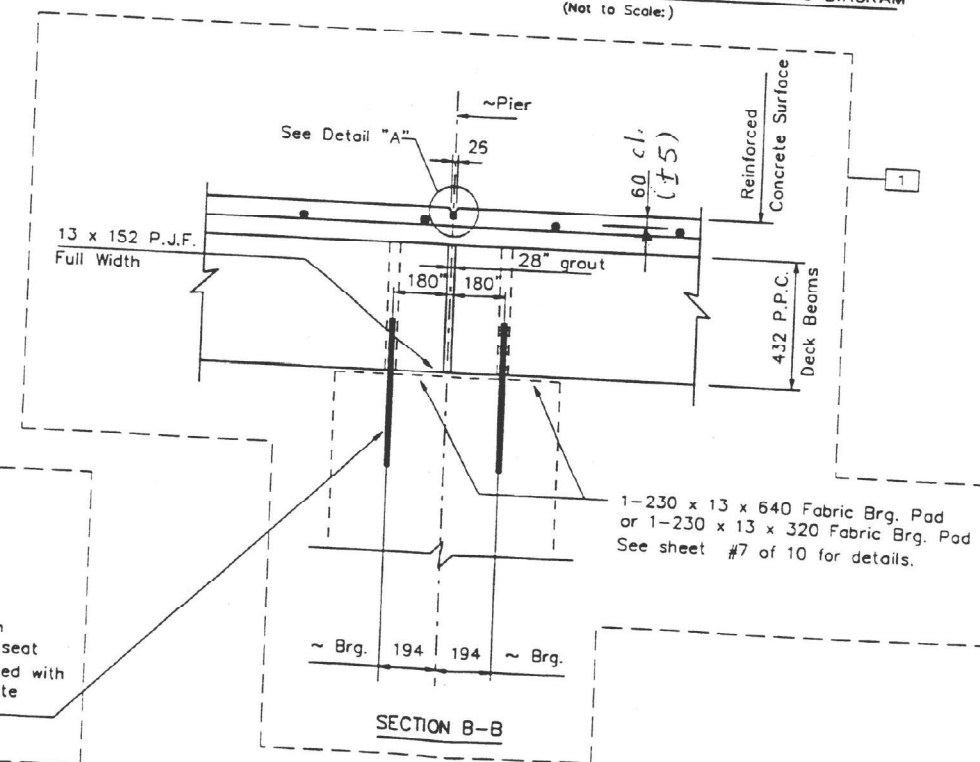
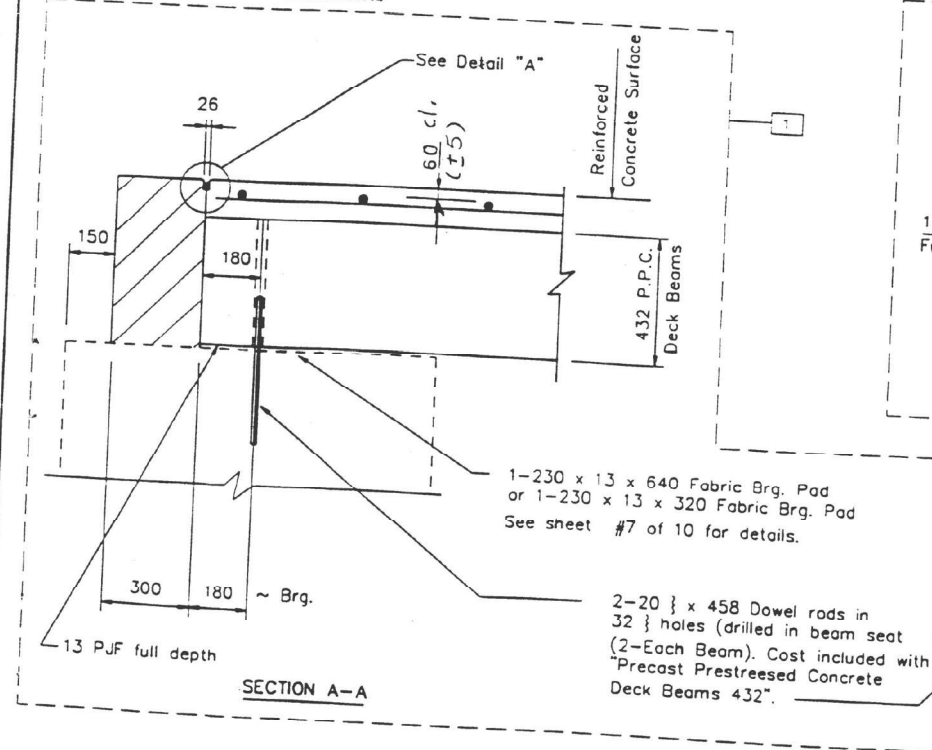
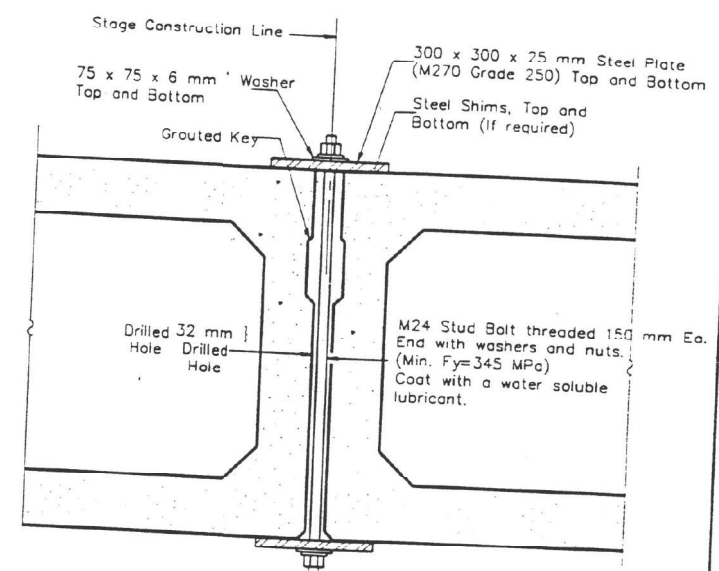
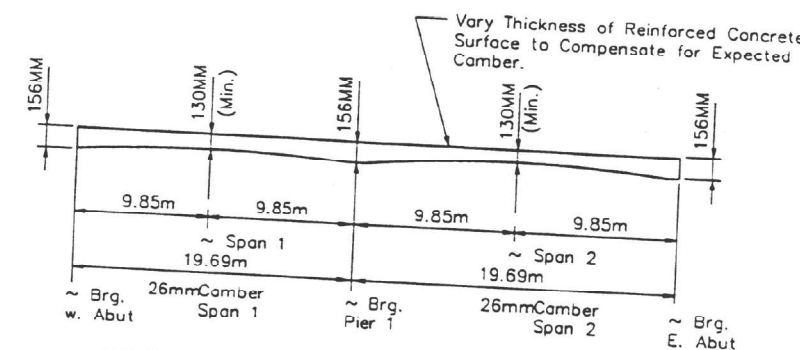
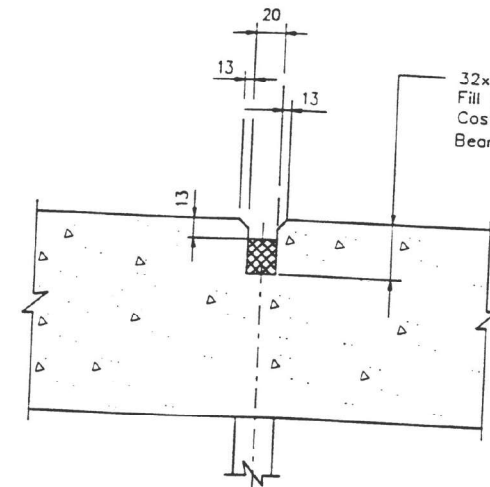
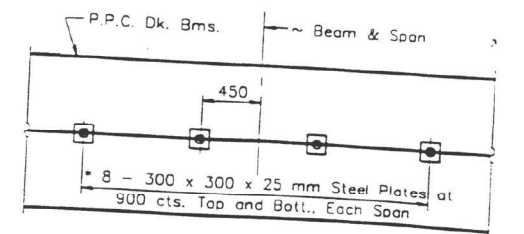
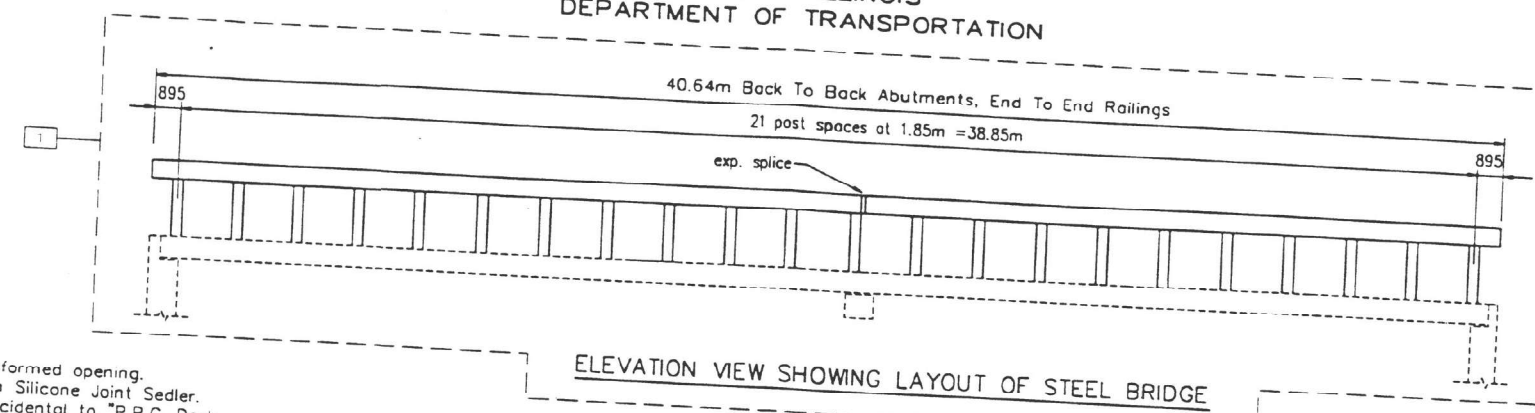

SHEAR KEY CLAMPING DETAILS  
AT STAGE CONST. JT.

See Special Provisions, for Stage Construction  
Precast Prestressed Concrete Deck Beams.  
Cost included with Precast  
Prestressed Concrete Deck Beams.  
See Stage Construction Detail for traffic lane.

SECTION

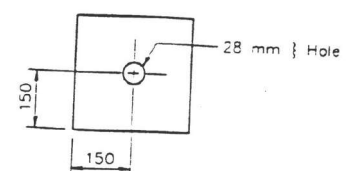

CLAMPING PLATE

SUPERSTRUCTURE DETAILS  
ILLINOIS ROUTE 104 OVER  
LAKE SANGCHRIS  
F.A.P. 753 SECTION 143BR  
STA. 7+938.308  
CHRISTIAN COUNTY, ILLINOIS  
STRUCTURE NO. 011-0022

Dowel Rods shall be grouted after beams are in place and allowed to cure (minimum 24 hours) prior to grouting the shear keys.

I:\cadd\ani\96043\43022s06.dan

USER NAME = brandon.dudley	DESIGNED -	REVISED -
	DRAWN -	REVISED -
	CHECKED -	REVISED -
PLOT DATE = 10/30/2024	DATE -	REVISED -

STATE OF ILLINOIS  
DEPARTMENT OF TRANSPORTATION

EXISTING OVERLAY DETAILS  
SN 011-0022 (FOR INFORMATION ONLY)

SCALE: SHEET 3 OF 3 SHEETS STA. TO STA.

F.A.P. RTE.	SECTION	COUNTY	TOTAL SHEETS	SHEET NO.
753	(142BR, BR1, BR2, 143BR)BRR	CHRISTIAN	17	17
CONTRACT NO. 72749				
ILLINOIS FED. AID PROJECT				

MODEL: bridge-12-1 (Sheet)  
FILE NAME: c:\pw\work\illinois\dudley\cadd\1006966\72749 plansheet.dgn