

STATE OF ILLINOIS  
DEPARTMENT OF TRANSPORTATION

F A P RTE	SECTION	COUNTY	TOTAL SHEETS	SHEET NO
326	128 RS-2	FORD	12	1
		ILLINOIS	CONTRACT NO. 66B76	

**INDEX OF SHEETS**

1	COVER SHEET
2	GENERAL NOTES & COMMITMENTS
3-6	SUMMARY OF QUANTITIES
7	TYPICAL SECTIONS
8-9	SCHEDULES
10	LAYOUT MAP
11-12	MISCELLANEOUS DETAILS

# PROPOSED HIGHWAY PLANS

FAP ROUTE 326 (IL 47)  
SECTION 128 RS-2  
PROJECT NHPP-EASC(707)  
3P MILLING & RESURFACING  
FORD COUNTY

**LIST OF ILLINOIS DOT HIGHWAY STANDARDS**

000001-07	STANDARD SYMBOLS, ABBREVIATIONS AND PATTERNS
001006	DECIMAL OF AN INCH AND OF A FOOT
442201-03	CLASS C AND D PATCHES
542306-03	PRECAST REINFORCED CONCRETE ELLIPTICAL FLARED END SECTION
542311-07	TRAVERSABLE PIPE GRATE FOR CONCRETE END SECTION
667101 02	PERMANENT SURVEY MARKERS
701001-02	OFF-ROAD OPERATIONS 2L, 2W, MORE THAN 15' (4.5 m) AWAY
701006-05	OFF-ROAD OPERATIONS 2L, 2W, 15' (4.5 m) TO 24' (600 mm) FROM PAVEMENT EDGE
701206-05	LANE CLOSURE, 2L, 2W, NIGHT ONLY, FOR SPEEDS $\geq$ 45 MPH
701301 04	LANE CLOSURE, 2L, 2W, SHORT TIME OPERATIONS
701306-04	LANE CLOSURE, 2L, 2W, SLOW MOVING OPERATIONS DAY ONLY, FOR SPEEDS $\geq$ 45 MPH
701311-03	LANE CLOSURE, 2L, 2W, MOVING OPERATIONS - DAY ONLY
701901-08	TRAFFIC CONTROL DEVICES
780001-05	TYPICAL PAVEMENT MARKINGS
781001 04	TYPICAL APPLICATIONS RAISED REFLECTIVE PAVEMENT MARKERS

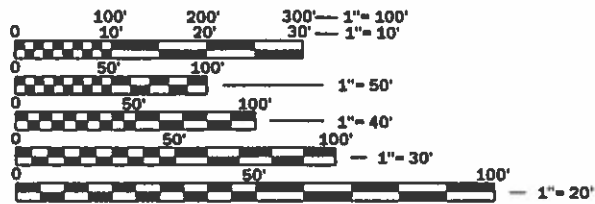

FULL SIZE PLANS HAVE BEEN PREPARED USING STANDARD ENGINEERING SCALES. REDUCED SIZED PLANS WILL NOT CONFORM TO STANDARD SCALES. IN MAKING MEASUREMENTS ON REDUCED PLANS, THE ABOVE SCALES MAY BE USED.

J.U.L.I.E.  
JOINT UTILITY LOCATION INFORMATION FOR EXCAVATION  
1-800-892-0123  
OR 811

PROJECT ENGINEER: JOE KANNEL, P.E.  
UNIT CHIEF: MICHELE LINDEMANN, P.E.  
DISTRICT 3 NO. (815) 434-6131  
CONTRACT NO. 66B76

C-93-025-12

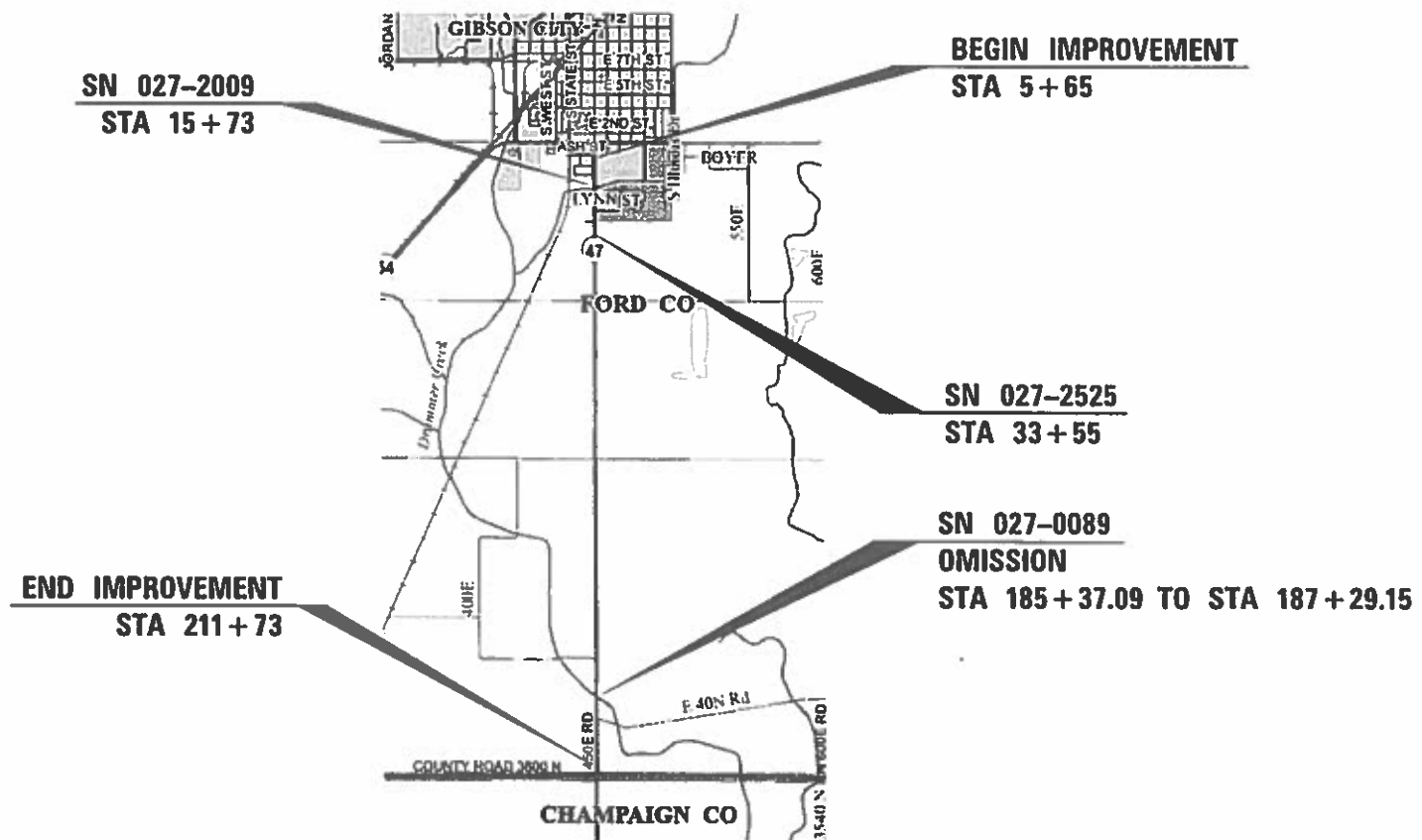

GROSS LENGTH = 20,608 FT. = 3.903 MILES  
NET LENGTH = 20,415.94 FT. = 3.867 MILES

D-93-020-12



FUNCTIONAL CLASSIFICATION:

OTHER ARTERIAL

2017 ADT: 4200

PV = 76.2% SU = 6.5% MU = 17.3%

STATE OF ILLINOIS  
DEPARTMENT OF TRANSPORTATION

SUBMITTED 12/13/2019

*Muhammad Ahmad*  
REGIONAL ENGINEER

*Jan 31 2020*  
ENGINEER OF DESIGN AND ENVIRONMENT

*Jan 31 2020*  
DIRECTOR OF HIGHWAYS PROJECT IMPLEMENTATION

PRINTED BY THE AUTHORITY  
OF THE STATE OF ILLINOIS



CODE NO.	ITEM	UNIT	TOTAL QUANTITY	CONSTR. CODE	
				80% FED 20% STATE	
				ROADWAY	RURAL
20800150	TRENCH BACKFILL	CU YD	5		5
21400100	GRADING AND SHAPING DITCHES	FOOT	450		450
25000210	SEEDING, CLASS 2A	ACRE	0.4		0.4
25000400	NITROGEN FERTILIZER NUTRIENT	POUND	34		34
25000500	PHOSPHORUS FERTILIZER NUTRIENT	POUND	34		34
25000600	POTASSIUM FERTILIZER NUTRIENT	POUND	34		34
25100115	MULCH, METHOD 2	ACRE	0.4		0.4
40200100	AGGREGATE SURFACE COURSE, TYPE A	TON	53		53
40600400	MIXTURE FOR CRACKS, JOINTS, AND FLANGWAYS	TON	20		20
40600901	HOT-MIX ASPHALT BINDER COURSE (HAND METHOD), N70	TON	34		34
40600990	TEMPORARY RAMP	SQ YD	316		316
40602985	HOT-MIX ASPHALT BINDER COURSE, IL-9.5, N70	TON	6575		6575
40604052	HOT-MIX ASPHALT SURFACE COURSE, IL-9.5, MIX "C", N70	TON	7514		7514
40800029	BITUMINOUS MATERIALS (TACK COAT)	POUND	6098		6098

MODEL: Default  
 FILE: \\nlsr01\pub\harcourt\illinois\pwr\DOT\Documents\DOT\_Offices\Illinet\3\Projects\ID366B76\CADD\Drawn\CAD\Drawn\ID366B76-11-500.dgn

USER NAME = corcoranlm	DESIGNED -	REVISED -
	DRAWN -	REVISED -
PLOT SCALE = 100.0000 ' / in.	CHECKED -	REVISED -
PLOT DATE = 12/17/2019	DATE -	REVISED -

**STATE OF ILLINOIS  
DEPARTMENT OF TRANSPORTATION**

**SUMMARY OF QUANTITIES**

SCALE: SHEET OF SHEETS STA. TO STA.

F.A.P. RTE.	SECTION	COUNTY	TOTAL SHEETS	SHEET NO.
326	128 R5-2	FORD	12	3
CONTRACT NO. 66B76			ILLINOIS FED. AID PROJECT	

CODE NO.	ITEM	UNIT	TOTAL QUANTITY	CONSTR. CODE	
				80% FED 20% STATE	
				ROADWAY	RURAL
40800050	INCIDENTAL HOT-MIX ASPHALT SURFACING	TON	145	145	
44000164	HOT-MIX ASPHALT SURFACE REMOVAL, 3 3/4"	SQ YD	67093	67093	
44201851	CLASS D PATCHES, TYPE II, 17 INCH	SQ YD	15	15	
48101200	AGGREGATE SHOULDERS, TYPE B	TON	924	924	
50105220	PIPE CULVERT REMOVAL	FOOT	58	58	
542A5479	PIPE CULVERTS, CLASS A, TYPE 1 EQUIVALENT ROUND-SIZE 24"	FOOT	48	48	
54214509	PRECAST REINFORCED CONCRETE FLARED END SECTIONS, EQUIVALENT ROUND-SIZE 24"	EACH	2	2	
54260315	TRAVERSABLE PIPE GRATE FOR CONCRETE END SECTION	FOOT	22	22	
54390160	INSERTION CULVERT LINER 21"	FOOT	62	62	
59300100	CONTROLLED LOW-STRENGTH MATERIAL	CU YD	12	12	
67000400	ENGINEER'S FIELD OFFICE, TYPE A	CAL MO	4	4	
67100100	MOBILIZATION	L SUM	1	1	
70100455	TRAFFIC CONTROL AND PROTECTION, STANDARD 701206	L SUM	1	1	
70100460	TRAFFIC CONTROL AND PROTECTION, STANDARD 701306	L SUM	1	1	

MODEL: Default  
 FILE: \\blm1c2.pva\pub\harcourt\dat\illinois\gov\PI\DOT\Documents\DOT\_Offices\Dir\dtc\_3\Projects\ID366B76\CADD\ata\CAD\sheet\ID366B76-pl-500.dgn

USER NAME = corcoranlm	DESIGNED -	REVISED -	<b>STATE OF ILLINOIS DEPARTMENT OF TRANSPORTATION</b>	<b>SUMMARY OF QUANTITIES</b>				F.A.P. RTE.	SECTION	COUNTY	TOTAL SHEETS	SHEET NO.
	DRAWN -	REVISED -		326	128 R5-2	FORD	12	4				
PLOT SCALE = 100.0000' / in.	CHECKED -	REVISED -						CONTRACT NO. 66B76				
PLOT DATE = 12/13/2019	DATE -	REVISED -		SCALE:	SHEET OF SHEETS	STA. TO STA.	ILLINOIS FED. AID PROJECT					

CONSTR. CODE
80% FED 20% STATE

CODE NO.	ITEM	UNIT	TOTAL QUANTITY	ROADWAY	
				0005	RURAL
70300100	SHORT TERM PAVEMENT MARKING	FOOT	6180	6180	
70300150	SHORT TERM PAVEMENT MARKING REMOVAL	SQ FT	686	686	
* 78001110	PAINT PAVEMENT MARKING - LINE 4"	FOOT	76213	76213	
* 78001130	PAINT PAVEMENT MARKING - LINE 6"	FOOT	10304	10304	
* 78100100	RAISED REFLECTIVE PAVEMENT MARKER	EACH	941	941	
78300200	RAISED REFLECTIVE PAVEMENT MARKER REMOVAL	EACH	941	941	
X0322936	REMOVE EXISTING FLARED END SECTION	EACH	4	4	
X0326763	REMOVE GRATING	EACH	2	2	
X4401198	HOT-MIX ASPHALT SURFACE REMOVAL, VARIABLE DEPTH	SQ YD	2493	2493	
Z0005300	BOX CULVERTS TO BE CLEANED	EACH	1	1	
Z0015500	DEBRIS REMOVAL	L SUM	1	1	
Z0018500	DRAINAGE STRUCTURES TO BE CLEANED	EACH	2	2	
Z0030850	TEMPORARY INFORMATION SIGNING	SQ FT	42	42	
Z0033700	LONGITUDINAL JOINT SEALANT	FOOT	20417	20417	

\*= SPECIALTY ITEM

MODEL: Default  
 FILE: h:\mhc\p\pub\harcam\dat\illinois\pwr\DOT\Documents\DOT\_Offices\Illin\ct 3\Projects\ID366B76\CADD\Drawn\CAD\Drawn\ID366B76-PL-500.dgn

USER NAME = corcoranlm	DESIGNED -	REVISED -
	DRAWN -	REVISED -
PLOT SCALE = 100.0000 ' / in.	CHECKED -	REVISED -
PLOT DATE = 12/13/2019	DATE -	REVISED -

**STATE OF ILLINOIS**  
**DEPARTMENT OF TRANSPORTATION**

SUMMARY OF QUANTITIES			
SCALE:	SHEET	OF	SHEETS

F.A.P. RTE.	SECTION	COUNTY	TOTAL SHEETS	SHEET NO.
326	128 RS-2	FORD	12	5
CONTRACT NO. 66B76				
ILLINOIS FED. AID PROJECT				

CODE NO.	ITEM	UNIT	TOTAL QUANTITY	CONSTR. CODE	
				80% FED 20% STATE	
				ROADWAY	
				0005	
				RURAL	
∅ Z0076600	TRAINEES	HOUR	2000		2000
Z0034105	MATERIAL TRANSFER DEVICE	TON	14089		14089
∅ Z0076604	TRAINEES - TRAINING PROGRAM GRADUATE	HOUR	2000		2000

∅ 0042

MODEL: Default  
FILE: \\blm1c2.pva\pub\lanscom\data\illinois.gov\PWIDOT\Documents\DOT\_Offices\District\_3\Projects\ID366B76\CADD\data\CAD\sheets\ID366B76-ht-500.dgn

USER NAME = corcoranlm	DESIGNED -	REVISED -	<b>STATE OF ILLINOIS DEPARTMENT OF TRANSPORTATION</b>	<b>SUMMARY OF QUANTITIES</b>				F.A.P. RTE.	SECTION	COUNTY	TOTAL SHEETS	SHEET NO.
	DRAWN -	REVISED -		326	128 R5-2	FORD	12	6				
PLOT SCALE = 100.0000 ' / in.	CHECKED -	REVISED -						CONTRACT NO. 66B76				
PLOT DATE = 12/13/2019	DATE -	REVISED -		SCALE:	SHEET OF SHEETS	STA. TO STA.	ILLINOIS FED. AID PROJECT					

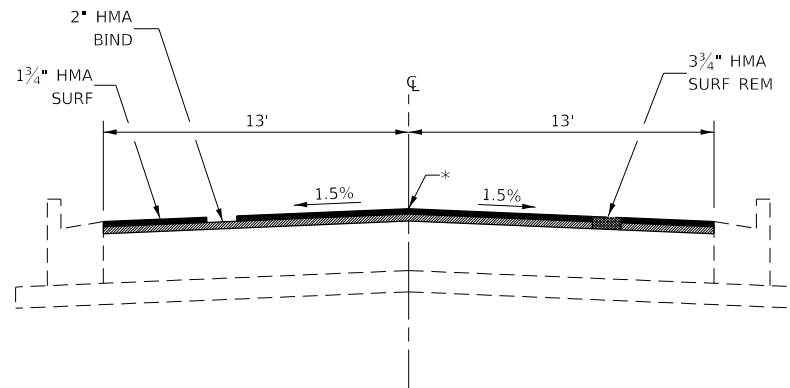

**PROPOSED TYPICAL SECTION**  
STA 5+56 TO STA 27+26.56

\* LONGITUDINAL JOINT SEALANT AT THESE LOCATIONS UNDER SURFACE LIFT

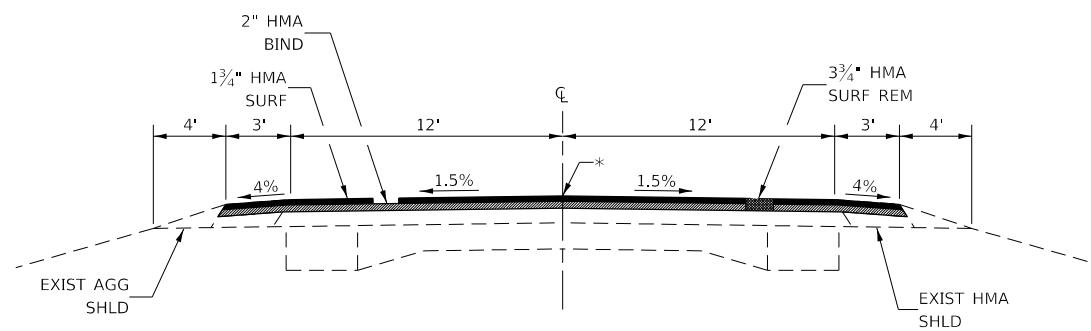

**PROPOSED TYPICAL SECTION**  
STA 27+26.56 TO STA 211+73

MODEL: Default  
FILE: h:\mhc\p\suplanroom\dat\illinois.gov\PWIDOT\Documents\DOT\_Offices\District\_3\Projects\ID366B76\CADD\Drawn\CAD\Drawn\ID366B76-11c1\typical.dgn

USER NAME = corcoranlm	DESIGNED -	REVISED -
	DRAWN -	REVISED -
PLOT SCALE = 100.0000' / in.	CHECKED -	REVISED -
PLOT DATE = 12/13/2019	DATE -	REVISED -

**STATE OF ILLINOIS  
DEPARTMENT OF TRANSPORTATION**

**TYPICAL SECTIONS**

SCALE: SHEET OF SHEETS STA. TO STA.

F.A.P. RTE.	SECTION	COUNTY	TOTAL SHEETS	SHEET NO.
326	128 RS-2	FORD	12	7
CONTRACT NO. 66B76				
ILLINOIS FED. AID PROJECT				

DRAINAGE SCHEDULE											
LOCATION	STRUCTURE NUMBER	STRUCTURE	DESCRIPTION	DRAINAGE STRUCTURES TO BE CLEANED	BOX CULVERT TO BE CLEANED	REMOVE GRATING	REMOVE EXISTING FLARED END SECTION	GRADING AND SHAPING DITCHES	DEBRIS REM	CONTROLLED LOW-STRENGTH MATERIAL	INSERTION CULVERT LINER 21"
				EACH	EACH	EACH	EACH	FOOT	L SUM	CU YD	FOOT
10+71, 31' RT		MANHOLE	CLEAN MH	1							
15+60, 46' RT			CLEAN OUTLET PIPE, REM GRATE			1					
15+73	027-2009	DOUBLE 12'X9' BOX	NO WORK								
15+88, 40' RT			CLEAN OUTLET PIPE, REM GRATE			1					
16+60, 26' LT		MANHOLE	CLEAN MH	1							
33+55	027-2525	10'X4' PRECAST BOX	NO WORK								
90+32		18" PIPE - 58'	FILL AND ABANDON				2			4	
92+00 TO 96+50, RT			GRADING & SHAPING DITCH					150			
106+80		24" PIPE	24" PIPE TO BE LINED								62
118+80 TO 121+00 RT			GRADING & SHAPING DITCH					220			
118+85		18" PIPE	FILL AND ABANDON				2			4	
186+33	SN 027-0089	2-SPAN PPC I-BEAM BRIDGE	EROSION REPAIR & DEBRIS REM						1	4	
202+14		3'X2' BOX CULVERT	CLEAN CULVERT		1						
<b>TOTAL</b>				<b>2</b>	<b>1</b>	<b>2</b>	<b>4</b>	<b>370</b>	<b>1</b>	<b>12</b>	<b>62</b>

PIPE CULVERT REPLACEMENT											
LOCATION	STRUCTURE	FLOWLINE ELEVATION		PIPE CULV REM FOOT	PIPE CULV CL A, TY 1 EQUIV RS 24" FOOT	PRC FLARED ES EQUIV ROUND SIZE 24" EACH	TRENCH BACK FILL CU YD	TRAVERSABLE PIPE GRATE FOR CONC END SECTION FOOT	CLASS D PATCH TY II, 17"		GRADING AND SHAPING DITCHES FOOT
		U.S. LEFT	D.S. RIGHT						LEFT SQ YD	RIGHT SQ YD	
106+03	24" PIPE - REPLACE	MEET EXISTING	MEET EXISTING	58	48	2	5	22.3	7.5	7.5	80
<b>TOTAL</b>				<b>58</b>	<b>48</b>	<b>2</b>	<b>5</b>	<b>22.3</b>	<b>15</b>	<b>15</b>	<b>80</b>

SEEDING SCHEDULE						
LOCATION	AREA SQ YD	SEEDING CLASS 2A	MULCH METHOD 2	NIT FERT NUT LB	PHOS FERT NUT LB	POT FERT NUT LB
		ACRE	ACRE			
24+85 TO 25+60 RT	125	0.026	0.026	2.3	2.3	2.3
82+40 TO 83+30 RT	120	0.025	0.025	2.3	2.3	2.3
191+50 TO 192+40	150	0.031	0.031	2.8	2.8	2.8
92+00 TO 95+50 RT	778	0.161	0.161	14.5	14.5	14.5
106+03 LT & RT	178	0.037	0.037	3.3	3.3	3.3
118+80 TO 121+00 RT	489	0.101	0.101	9.1	9.1	9.1
<b>TOTAL</b>	<b>1840</b>	<b>0.381</b>	<b>0.381</b>	<b>34.3</b>	<b>34.3</b>	<b>34.3</b>

PAVING SCHEDULE												
LOCATION	LENGTH FOOT	AVG PVMT WIDTH FOOT	HMA PVMT AREA SQ YD	HMA SURF CSE TON	HMA BINDER TON	HMA SURF REM 3-3/4" SQ YD	LONG JOINT SEAL FOOT	AGG SHLDR TY B TON	TEMP RAMP SQ YD	BIT MAT (TACK COAT) POUND	MIX FOR CRACKS, JOINTS & FLGWYS TON	HMA BINDER (HM) TON
27+26.56 TO 185+37.09	15810.53	30	52702	5902.6	5164.8	52702	15811	800	42	3952.7	15.8	26.4
185+37.09 TO 187+29.15 - OMISSION SN 027-0089	192.06	30										
187+29.15 TO 211+73	2443.85	30	8146	912.4	798.3	8146	2444	124	84	611	2.4	4.1
<b>TOTAL</b>	<b>20608</b>			<b>7514.4</b>	<b>6575.1</b>	<b>67093</b>	<b>20417</b>	<b>924</b>	<b>162</b>	<b>5032.1</b>	<b>20.1</b>	<b>33.6</b>

MODEL: Default  
 FILE: h:\mhc\p\pub\haronom.dwg  
 PLOT DATE: 12/13/2019  
 PROJECT: I185+37.09 TO 187+29.15 - OMISSION SN 027-0089

USER NAME = corcoranlm	DESIGNED -	REVISED -
	DRAWN -	REVISED -
PLOT SCALE = 100.0000' / in.	CHECKED -	REVISED -
PLOT DATE = 12/13/2019	DATE -	REVISED -

**STATE OF ILLINOIS**  
**DEPARTMENT OF TRANSPORTATION**

**SCHEDULE**

SCALE: SHEET OF SHEETS STA. TO STA.

F.A.P. RTE.	SECTION	COUNTY	TOTAL SHEETS	SHEET NO.
326	128 R5-2	FORD	12	8
CONTRACT NO. 66B76				
ILLINOIS FED. AID PROJECT				



PAVEMENT MARKING SCHEDULE						
LOCATION	LENGTH	PAINT PAVEMENT MARKING LINE			RAISED REF PMVT MARKER REMOVAL EACH	RAISED REFLECT PVMT MARKER EACH
		4 INCH		6 INCH		
		WHITE FOOT	YELLOW FOOT	YELLOW FOOT		
5+65 TO 27+26.56	2161.56			1081	28	28
27+26.56 TO 185+37.09	15810.53	63242	2428	7905	791	791
185+37.09 TO 187+29.15	192.06	768		96		
187+29.15 TO 211+73	2443.85	9775		1222	122	122
<b>SUBTOTAL</b>		<b>73785</b>	<b>2428</b>			
<b>TOTAL</b>		<b>76213</b>		<b>10304</b>	<b>941</b>	<b>941</b>

SHORT TERM PAVEMENT MARKING SCHEDULE			
LOCATION	LENGTH	SHORT TERM PVMT MARK	SHORT TERM PAVEMENT MARKER REMOVAL
		FOOT	SQ FT
5+65 TO 27+26.56	2161.56	648	72
27+26.56 TO 185+37.09	15810.53	4743	527
185+37.09 TO 187+29.15	192.06	57	6
187+29.15 TO 211+73	2443.85	732	81
<b>TOTAL</b>		<b>6180</b>	<b>686</b>

NOTE: PROPOSED NO PASSING ZONES SHALL BE STRIPED AS EXISTING.  
ADDITIONAL QUANTITY HAS BEEN INCLUDED TO ALLOW FOR TWO SEPARATE APPLICATIONS OF PAINT PAVEMENT MARKING LINE

SIDEROADS AND ENTRANCES										
STATION	SIDE	TYPE	ENTRANCE	WIDTH	AREA	HMA SURF REM - VAR DEPTH	INC HMA SURF	BIT MATL (TACK CT)	AGG SURF CSE	TEMP RAMP
				FOOT	SQ YD	SQ YD	TON	POUND	TON	SQ YD
35+57	LT	AGG	FE	24	37.8	37.8			2.2	
38+39	RT	AGG	FE	24	37.8	37.8			2.2	
41+19	LT	HMA/AGG	PE & MBTO	56	84.4	84.4	14.2	57.0		
53+22	LT	HMA	E 300N RD	40	176.0	176.0	9.2	118.8		25.8
53+22	RT	HMA	E 300N RD	35	160.0	160.0	8.3	108.0		22.6
58+43	LT	AGG	FE	24	37.8	37.8			2.2	
69+59	RT	AGG	FE	24	37.8	37.8			2.2	
79+43	LT	AGG	FE	24	37.8	37.8			2.2	
80+02	RT	AGG	FE	24	37.8	37.8			2.2	
80+09	LT	AGG	FE	24	37.8	37.8			2.2	
85+30	RT	AGG	FE	30	44.4	44.4			2.5	
92+95	LT	AGG	FE	24	37.8	37.8			2.2	
105+02	RT	AGG	FE	24	37.8	37.8			2.2	
106+30	LT	HMA	E 200N RD	40	176.0	176.0	9.2	118.8		25.8
106+33	RT	HMA	E 200N RD	40	176.0	176.0	9.2	118.8		25.8
110+94	LT	HMA/AGG	PE & MBTO	65	94.4	94.4	15.8	63.7		
111+16	RT	HMA/AGG	PE	40	55.6	55.6	9.2	37.5		
114+31	RT	AGG	FE	24	37.8	37.8			2.2	
114+41	LT	HMA/AGG	PE & MBTO	54	82.2	82.2	13.9	55.5		
133+41	LT	AGG	FE	24	37.8	37.8			2.2	
133+50	RT	AGG	FE	24	37.8	37.8			2.2	
142+32	RT	AGG	FE	24	37.8	37.8			2.2	
143+67	LT	AGG	FE	24	37.8	37.8			2.2	
145+13	LT	HMA/AGG	PE & MBTO	51	62.2	62.2	11.1	42.0		
145+93	LT	HMA/AGG	PE & MBTO	51	62.2	62.2	11.1	42.0		
146+18	RT	HMA/AGG	PE	24	37.8	37.8	6.4	25.5		
147+18	LT	AGG	FE	24	37.8	37.8			2.2	
148+98	RT	AGG	FE	24	37.8	37.8			2.2	
159+42	LT	AGG	FE	24	37.8	37.8			2.2	
159+42	RT	AGG	FE	24	37.8	37.8			2.2	
160+63	LT	AGG	FE	24	37.8	37.8			2.2	
172+48	LT	AGG	FE	24	37.8	37.8			2.2	
172+83	RT	HMA	E 80N RD	40	176.0	176.0	9.2	118.8		25.8
173+20	LT	AGG	FE	24	37.8	37.8			2.2	
188+64	RT	HMA/AGG	PE	32	46.7	46.7	7.8	31.5		
190+03	LT	AGG	FE	24	37.8	37.8			2.2	
193+12	LT	HMA	E 500N RD	44	190.0	190.0	9.9	128.3		28.4
206+10	LT	AGG	FE	24	37.8	37.8			2.2	
<b>TOTALS</b>						<b>2493.3</b>	<b>144.5</b>	<b>1066.2</b>	<b>53.1</b>	<b>154.2</b>

NOTE: NO WORK ON SIDEROADS IN CURB AND GUTTER SECTIONS

MODEL: Default  
FILE: h:\mhc\p\pub\barroom.dwg  
PROJECT: 3\Projects\10366B76\CADDData\CAD\sheet\10366B76-hs-500.dgn

USER NAME = corcoranlm	DESIGNED -	REVISED -	<b>STATE OF ILLINOIS DEPARTMENT OF TRANSPORTATION</b>	<b>SCHEDULE</b>				F.A.P. RTE.	SECTION	COUNTY	TOTAL SHEETS	SHEET NO.		
	DRAWN -	REVISED -		SCALE:	SHEET	OF	SHEETS	STA.	TO STA.	326	128 RS-2	FORD	12	9
PLOT SCALE = 100.0000' / in.	CHECKED -	REVISED -		CONTRACT NO. 66B76										
PLOT DATE = 12/13/2019	DATE -	REVISED -		ILLINOIS FED. AID PROJECT										

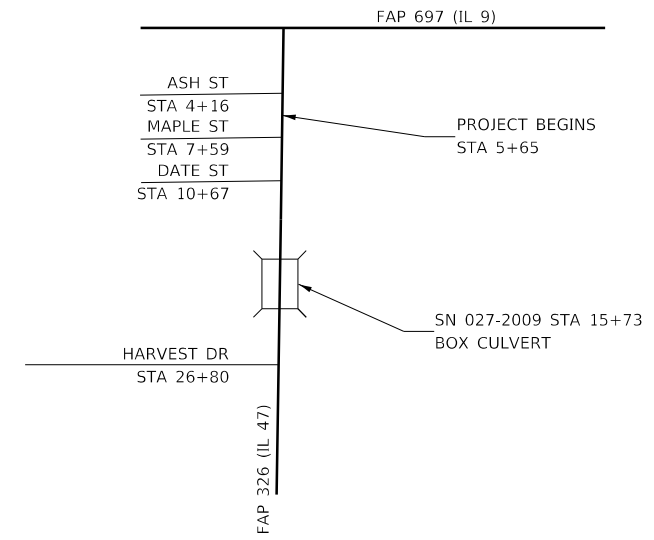
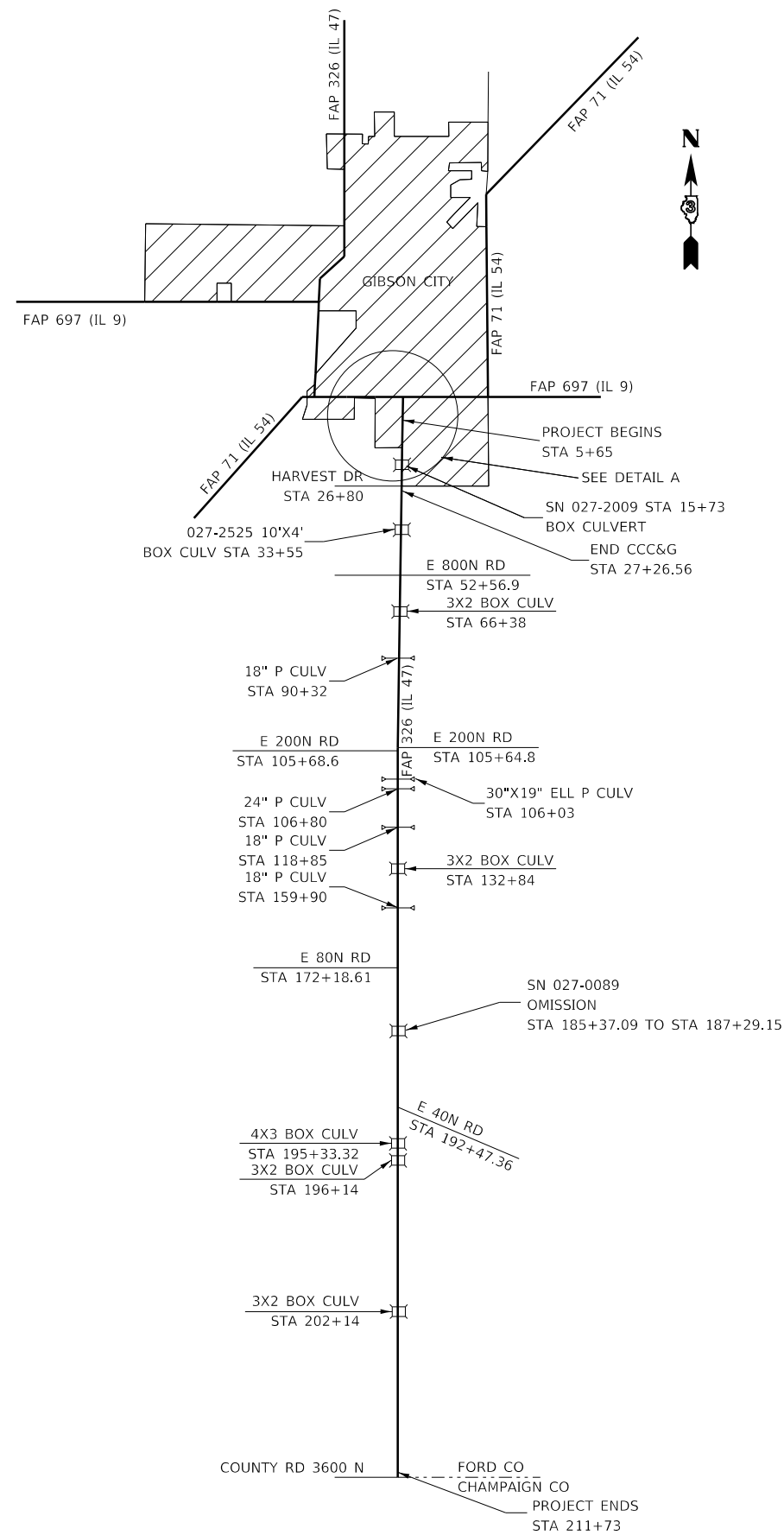

DETAIL A



MODEL: Default  
 FILE: \\blm1c:\pub\planroom\dat\illinois.gov\PWIDOT\Documents\IDOT\_Offices\District\_3\Projects\ID366B76\CADD\Drawings\CADD\Drawings\ID366B76-Plan\Layout.dgn

USER NAME = corcoranlm	DESIGNED -	REVISED -
	DRAWN -	REVISED -
PLOT SCALE = 100.0000' / in.	CHECKED -	REVISED -
PLOT DATE = 12/13/2019	DATE -	REVISED -

**STATE OF ILLINOIS**  
**DEPARTMENT OF TRANSPORTATION**

<b>LAYOUT MAP</b>			
SCALE:	SHEET	OF SHEETS	STA. TO STA.

F.A.P. RTE.	SECTION	COUNTY	TOTAL SHEETS	SHEET NO.
326	128 R5-2	FORD	12	10
CONTRACT NO. 66B76				
ILLINOIS FED. AID PROJECT				

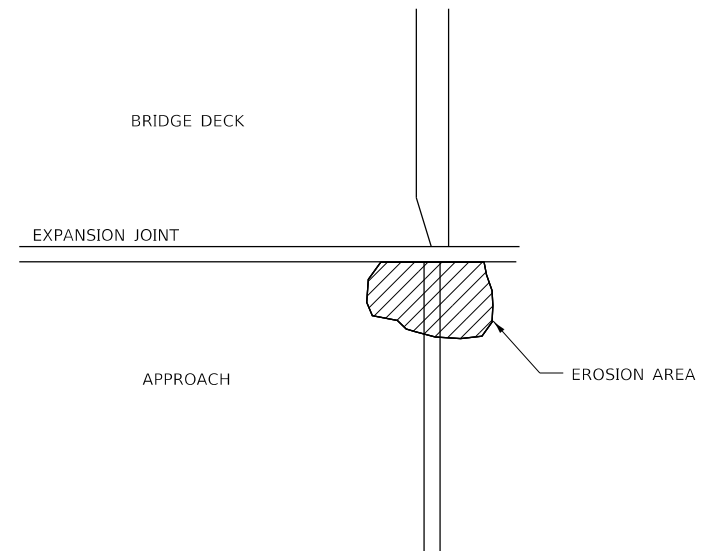

EROSION AREA:  
 FILL WITH CONTROLLED LOW-STRENGTH MATERIAL.

PLACE 4" VEGETATIVE SUSTAINING SOIL, SEEDING, FERTILIZER NUTRIENTS AND EROSION CONTROL BLANKET. THESE ITEMS WILL NOT BE PAID FOR SEPARATELY, BUT WILL BE INCLUDED IN THE COST OF CONTROLLED LOW-STRENGTH MATERIAL.

**EROSION AT SN 027-0089**  
 TYPICAL AT ALL 4 QUADRANTS

**POTENTIAL SITES TO PLACE EXCAVATED MATERIAL**

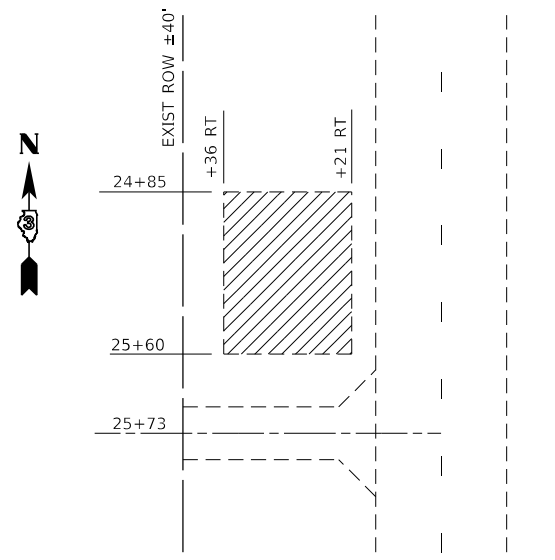

DEPTH = 1.5"  
 VOLUME = (75' x 15' x 1.5/12) x 1/27 = 5.2 CY

**LOCATION 1**

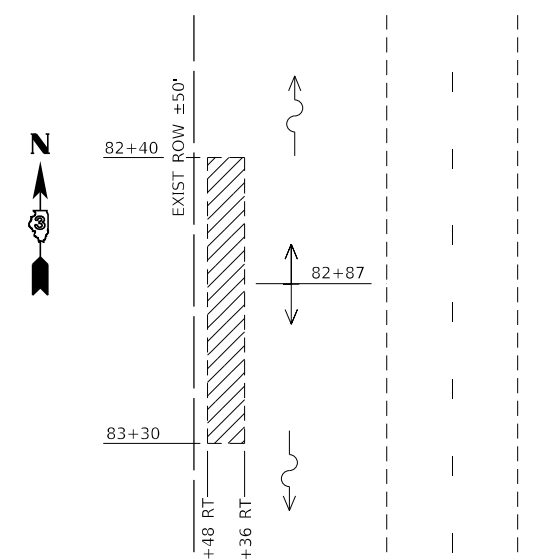

DEPTH = 1.5"  
 VOLUME = (90' x 12' x 1.5/12) x 1/27 = 5.0 CY

**LOCATION 2**

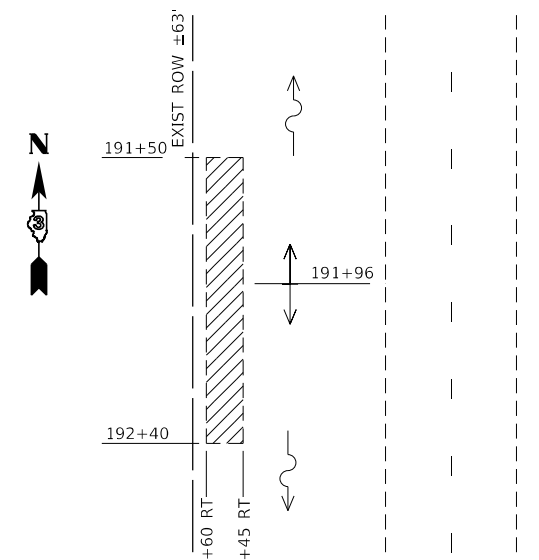

DEPTH = 1.5"  
 VOLUME = (90' x 15' x 1.5/12) x 1/27 = 6.3 CY

**LOCATION 2**

NOTE:  
 AREAS SHALL BE SEEDED AND MULCHED AS DESCRIBED IN THE PLANS AND THE SPECIAL PROVISIONS

MODEL: Default  
 FILE: h:\mfc\_2019\pub\harcourt.dwg  
 PROJECT: 0366B76\CADD\Drawings\DOT - Office\Drawings\3\Projects\0366B76\CADD\Drawings\0366B76-11-11-19.dwg

USER NAME = corcoranlm	DESIGNED -	REVISED -
	DRAWN -	REVISED -
PLOT SCALE = 100.0000' / in.	CHECKED -	REVISED -
PLOT DATE = 12/13/2019	DATE -	REVISED -

**STATE OF ILLINOIS  
 DEPARTMENT OF TRANSPORTATION**

<b>DETAILS</b>	
SCALE:	SHEET OF SHEETS STA. TO STA.

F.A.P. RTE.	SECTION	COUNTY	TOTAL SHEETS	SHEET NO.
326	128 R5-2	FORD	12	11
CONTRACT NO. 66B76				
ILLINOIS FED. AID PROJECT				

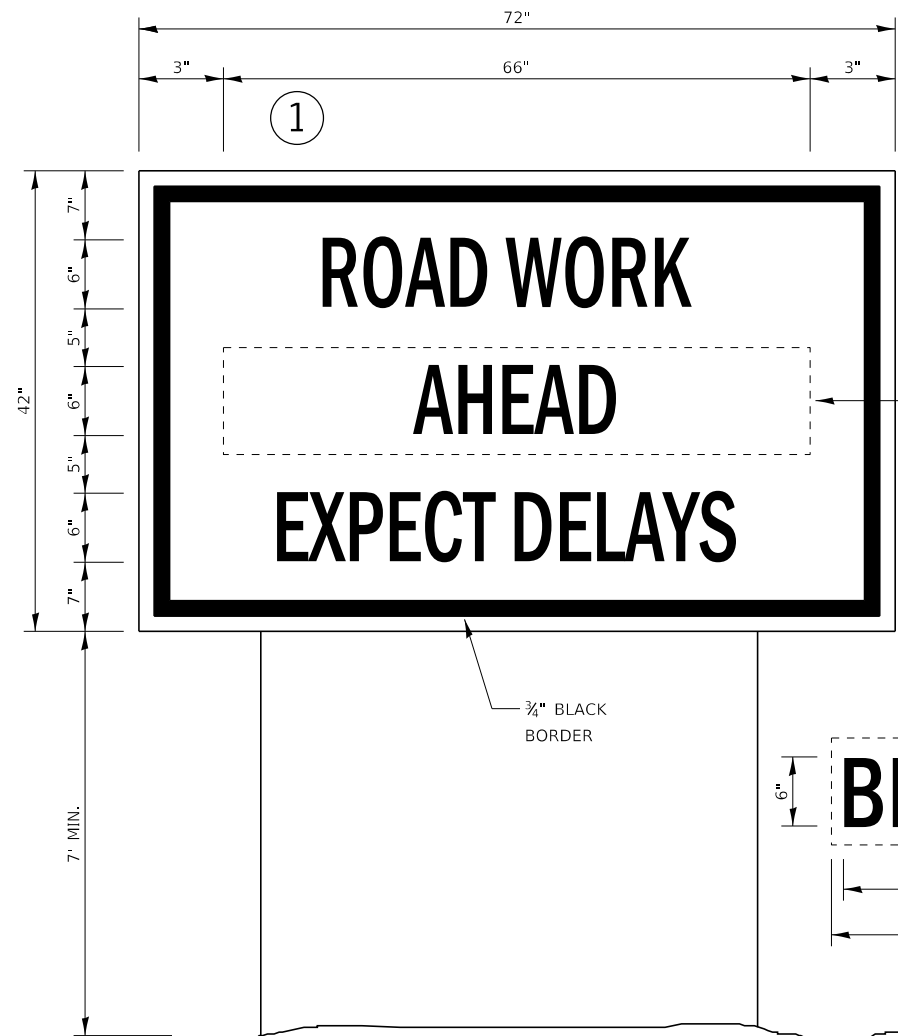

**TEMPORARY INFORMATION SIGNING**

**NOTES:**

- USE 6" D BLACK LETTERING ON FLUORESCENT ORANGE BACKGROUND.
- ERECT SIGNS AT LOCATIONS IN ADVANCE OF THE "ROAD CONSTRUCTION AHEAD" SIGNS AS DIRECTED BY THE ENGINEER.
- ERECT SIGN ① WITH INSTALLED PANEL ② A MINIMUM OF ONE WEEK PRIOR TO THE START OF THE LANE CLOSURE.
- REMOVE PANEL ② ON THAT DATE.
- SEE SPECIAL PROVISION "TEMPORARY INFORMATION SIGNING" FOR ADDITIONAL INFORMATION.
- WILL BE PAID FOR PER SQ FT AS "TEMPORARY INFORMATION SIGNING". EACH SIGN = 21 SQ FT AND THE DATE PANEL ② WILL NOT BE MEASURED SEPARATELY FOR PAYMENT.

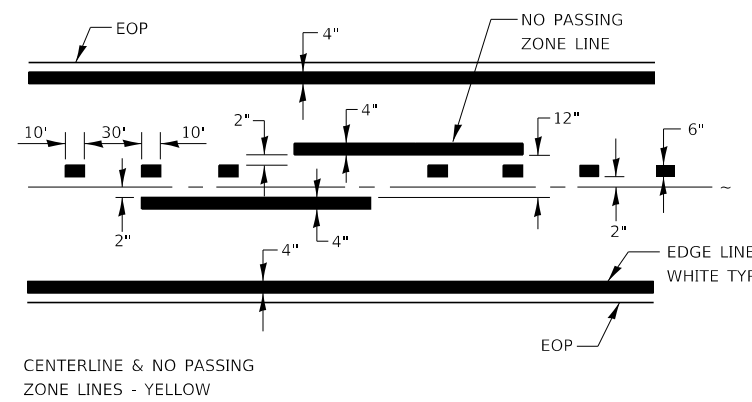

**PAVEMENT MARKING**

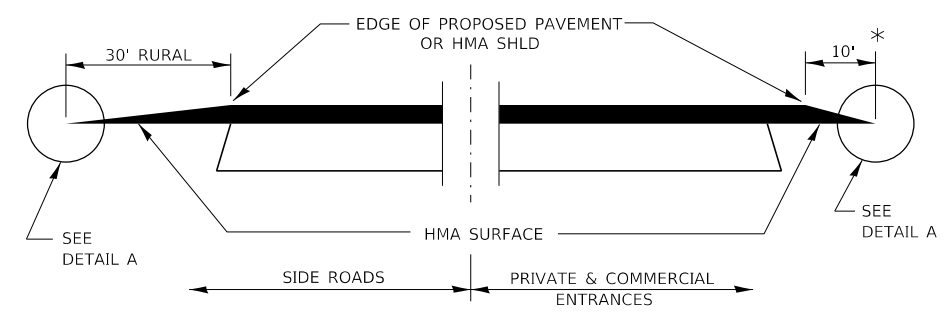

**SECTION A-A  
DETAILS AT ENTRANCES & SIDE ROADS**

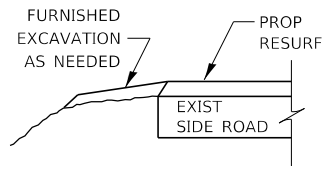

**SECTION B-B**  
IF NEEDED, THE COST OF FURNISHED EXCAVATION AND ASSOCIATED SEEDING ITEMS WILL BE INCLUDED IN THE COST OF THE PAVING PAY ITEMS

THE COST OF REMOVAL AT EXISTING HMA OR PCC LOCATIONS SHALL BE PAID FOR PER SQ YD BY THE APPROPRIATE PAY ITEM. REMOVAL AT THE EXISTING AGG LOCATIONS SHALL BE INCIDENTAL TO THE HMA. A-3 LOCATIONS SHALL BE FEATHER TAPERED.

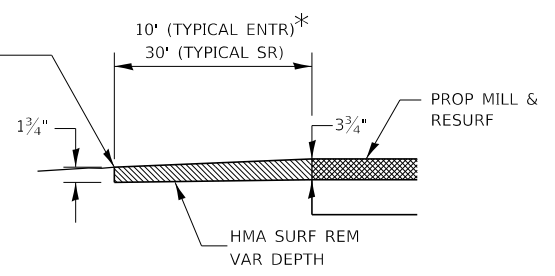

**DETAIL A**

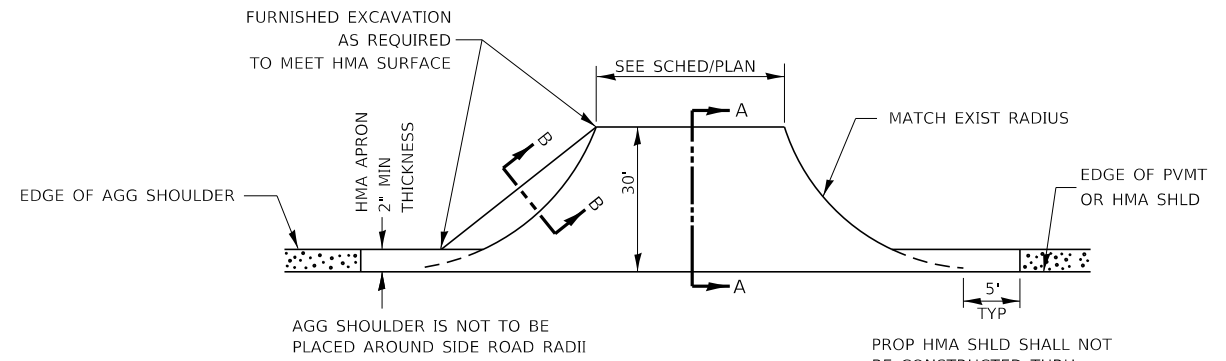

**PLAN AT SIDE ROADS**

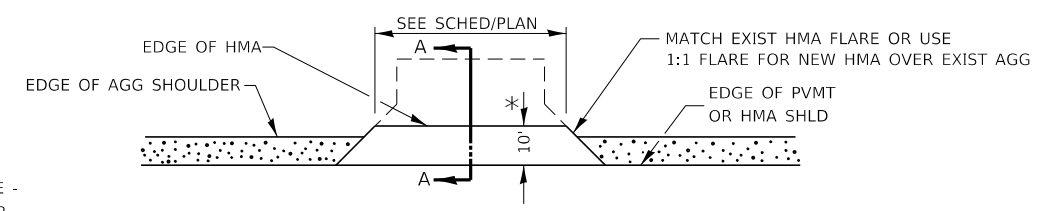

**PLAN AT PRIVATE & COMMERCIAL ENTRANCES**

(DO NOT RESURFACE FIELD ENTRANCES)

\* PROPOSED HMA RESURFACING AT PUBLIC EDUCATIONAL FACILITY ENTRANCES SHALL BE EXTENDED TO THE RIGHT-OF-WAY LIMITS.

MODEL: Default  
FILE: \\bls01\pub\blsroom\dat\illinois\gov\pww\dot\Documents\DOT Office\Drawings\3\Projects\0366B76\CADDData\CAD\sheet\0366B76-11c1\11c1.dgn

USER NAME = corcoranlm	DESIGNED -	REVISED -
PLOT SCALE = 100.0000' / in.	DRAWN -	REVISED -
PLOT DATE = 12/13/2019	CHECKED -	REVISED -
	DATE -	REVISED -

**STATE OF ILLINOIS  
DEPARTMENT OF TRANSPORTATION**

<b>DETAILS</b>	
SCALE:	SHEET OF SHEETS STA. TO STA.

F.A.P. RTE.	SECTION	COUNTY	TOTAL SHEETS	SHEET NO.
326	128 RS-2	FORD	12	12
CONTRACT NO. 66B76				
ILLINOIS FED. AID PROJECT				