

KA038

K:\Kankakee\0807508 Lighting Ph.2\Draw\Sheets
FILE: Econd-04.dwg
LAYOUT: Layout1
UPDATE BY: Jim Ohse
SURVEY BOOK #
DATE: Thursday, January 15, 2009 11:17:11 AM
XREF DWG: tbcInt.dwg
tb.dwg
elec-base.dwg

REVISIONS

NUMBER	BY	DATE

0 1 2
THIS BAR IS EQUAL TO 2"
AT FULL SCALE (34X22).

**GREATER KANKAKEE AIRPORT
KANKAKEE, ILLINOIS**

**REHABILITATE AIRFIELD LIGHTING SYSTEM -
RUNWAY 4/22 PARALLEL AND CONNECTING TAXIWAYS**

**EXISTING CONDITIONS/PROPOSED REMOVALS
STA. 130+00 TO STA. 142+00**

© Copyright CMT, Inc.

CMT
CRAWFORD, MURPHY & TILLY, INC.
CONSULTING ENGINEERS
License No. 84-000613

DESIGN BY:	MND
DRAWN BY:	JRO
CHECKED BY:	MND
APPROVED BY:	
DATE:	01/16/09
JOB No:	08075-06
IL PROJECT:	IKK-3863
A.I.P. PROJECT:	3-17-0057-B15
FINAL SUBMITTAL	
SHEET	9 OF 20 SHEETS

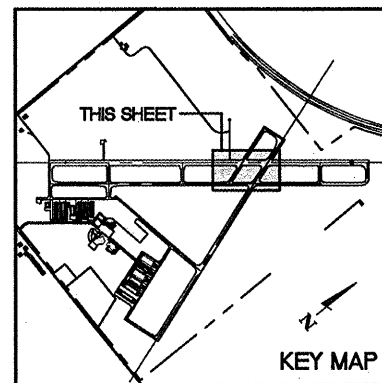
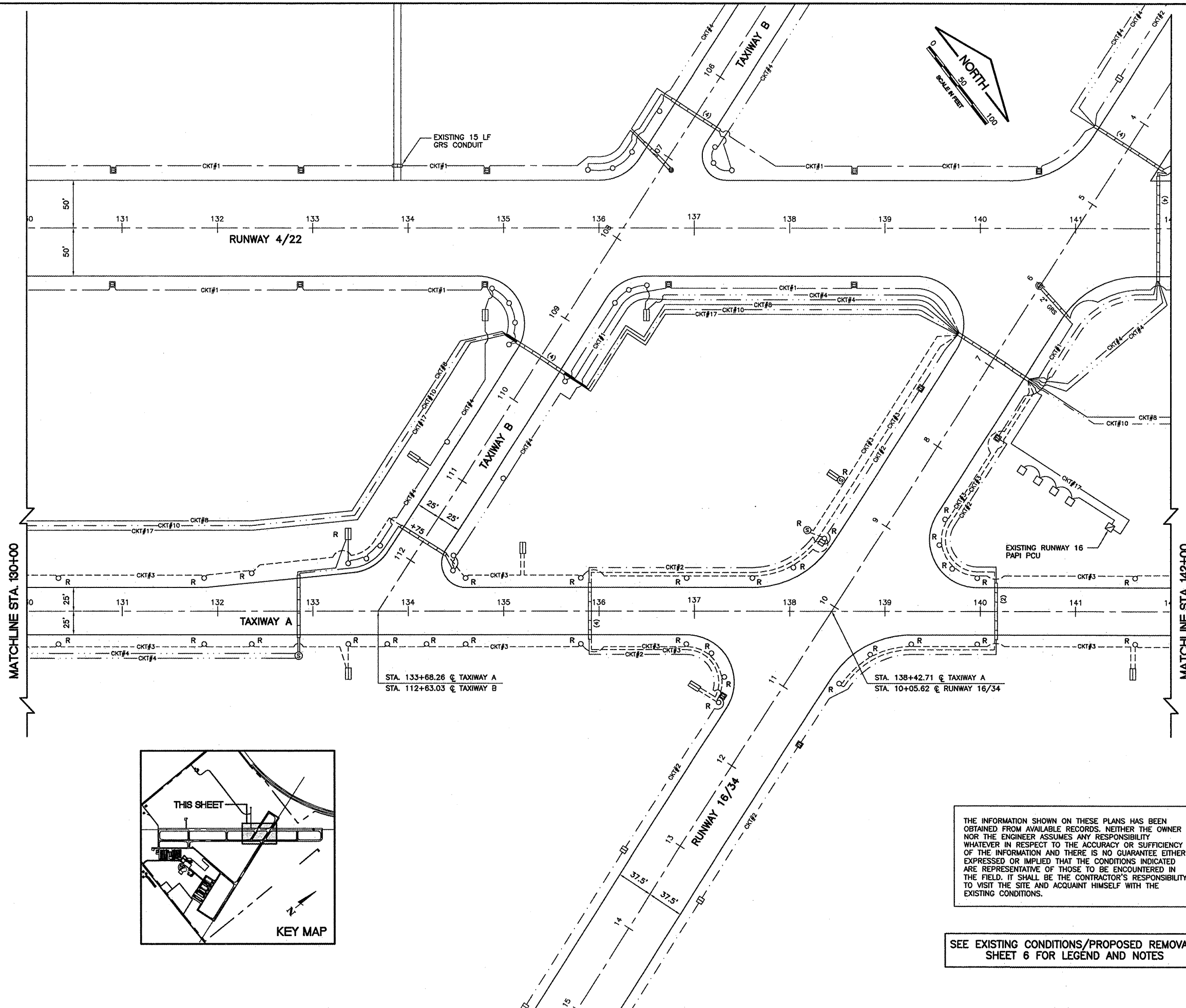

THE INFORMATION SHOWN ON THESE PLANS HAS BEEN OBTAINED FROM AVAILABLE RECORDS. NEITHER THE OWNER NOR THE ENGINEER ASSUMES ANY RESPONSIBILITY WHATEVER IN RESPECT TO THE ACCURACY OR SUFFICIENCY OF THE INFORMATION AND THERE IS NO GUARANTEE EITHER EXPRESSED OR IMPLIED THAT THE CONDITIONS INDICATED ARE REPRESENTATIVE OF THOSE TO BE ENCOUNTERED IN THE FIELD. IT SHALL BE THE CONTRACTOR'S RESPONSIBILITY TO VISIT THE SITE AND ACQUAINT HIMSELF WITH THE EXISTING CONDITIONS.

SEE EXISTING CONDITIONS/PROPOSED REMOVALS SHEET 6 FOR LEGEND AND NOTES