

KA038

K:\Kankakee\0807508 Lighting Ph.2\Draw\Sheets
FILE: Econd-02.dwg
LAYOUT: Layout1
UPDATE BY: Jim Ohse
SURVEY BOOK #
DATE: Thursday, January 15, 2009 11:15:31 AM
XREF DWG: tbcint.dwg
tb.dwg
elec-base.dwg

THE INFORMATION SHOWN ON THESE PLANS HAS BEEN OBTAINED FROM AVAILABLE RECORDS. NEITHER THE OWNER NOR THE ENGINEER ASSUMES ANY RESPONSIBILITY WHATSOEVER IN RESPECT TO THE ACCURACY OR SUFFICIENCY OF THE INFORMATION AND THERE IS NO GUARANTEE EITHER EXPRESSED OR IMPLIED THAT THE CONDITIONS INDICATED ARE REPRESENTATIVE OF THOSE TO BE ENCOUNTERED IN THE FIELD. IT SHALL BE THE CONTRACTOR'S RESPONSIBILITY TO VISIT THE SITE AND ACQUAINT HIMSELF WITH THE EXISTING CONDITIONS.

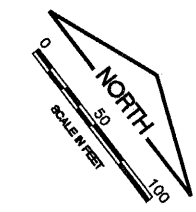

REVISIONS		
NUMBER	BY	DATE

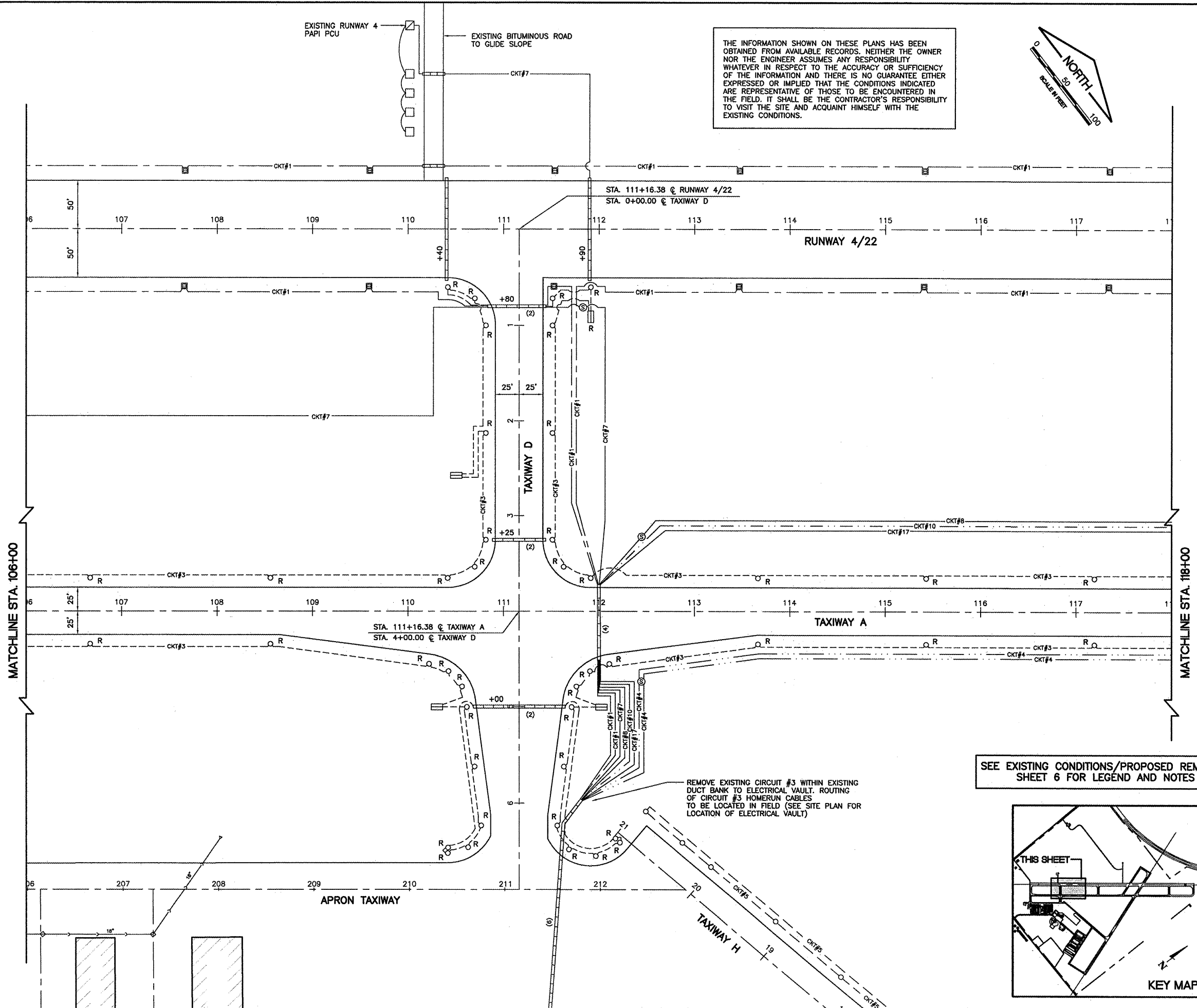
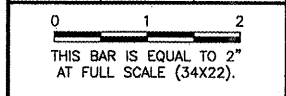

SEE EXISTING CONDITIONS/PROPOSED REMOVALS SHEET 6 FOR LEGEND AND NOTES

REMOVE EXISTING CIRCUIT #3 WITHIN EXISTING DUCT BANK TO ELECTRICAL VAULT. ROUTING OF CIRCUIT #3 HOMERUN CABLES TO BE LOCATED IN FIELD (SEE SITE PLAN FOR LOCATION OF ELECTRICAL VAULT)

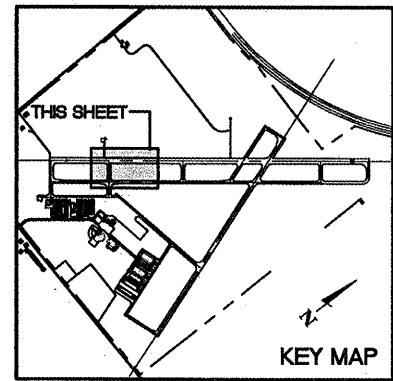

**GREATER KANKAKEE AIRPORT
KANKAKEE, ILLINOIS
REHABILITATE AIRFIELD LIGHTING SYSTEM -
RUNWAY 4/22 PARALLEL AND CONNECTING TAXIWAYS
EXISTING CONDITIONS/PROPOSED REMOVALS
STA. 106+00 TO STA. 118+00**

© Copyright CMT, Inc.
CMT
CRAWFORD, MURPHY & TILLY, INC.
CONSULTING ENGINEERS
License No. 084-0000318

DESIGN BY:	MND
DRAWN BY:	JRO
CHECKED BY:	MND
APPROVED BY:	
DATE:	01/16/09
JOB No:	08075-06
IL PROJECT: IKK-3863 A.I.P. PROJECT: 3-17-0057-B15	
FINAL SUBMITTAL	
SHEET 7 OF 20 SHEETS	