

GR003

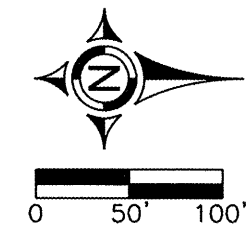

27

GENERAL NOTE

EXISTING UNDERGROUND AIRFIELD LIGHTING CIRCUITS ARE SHOWN WHERE LOCATIONS ARE RELEVANT TO NEW CONSTRUCTION. LOCATIONS SHOWN ARE APPROXIMATE. THESE AREAS SHALL BE HAND-EXCAVATED TO AVOID DAMAGE. ANY DAMAGE TO SAME SHALL BE REPAIRED OR REPLACED TO THE SATISFACTION OF THE ENGINEER.

PLAN NOTES

- ① Disconnect and remove wind tee, and all above-grade wiring. Wiring below grade shall be abandoned in place.
- ② Locate and avoid existing airfield lighting underground cables. Any damage to same shall be repaired or replaced to the satisfaction of the Engineer.
- ③ 81'-4" steel 1-way duct pushed or bored under taxiway.
- ④ 4/C #2 (36 REIL), and 3/C #2 (36 wind cone) Type C unit ducts.
- ⑤ 3/C #4 600 V Type C in unit duct for 120 volt feed to supplemental wind cone (Runway 18).
- ⑥ See Sheet 7 for continuation.

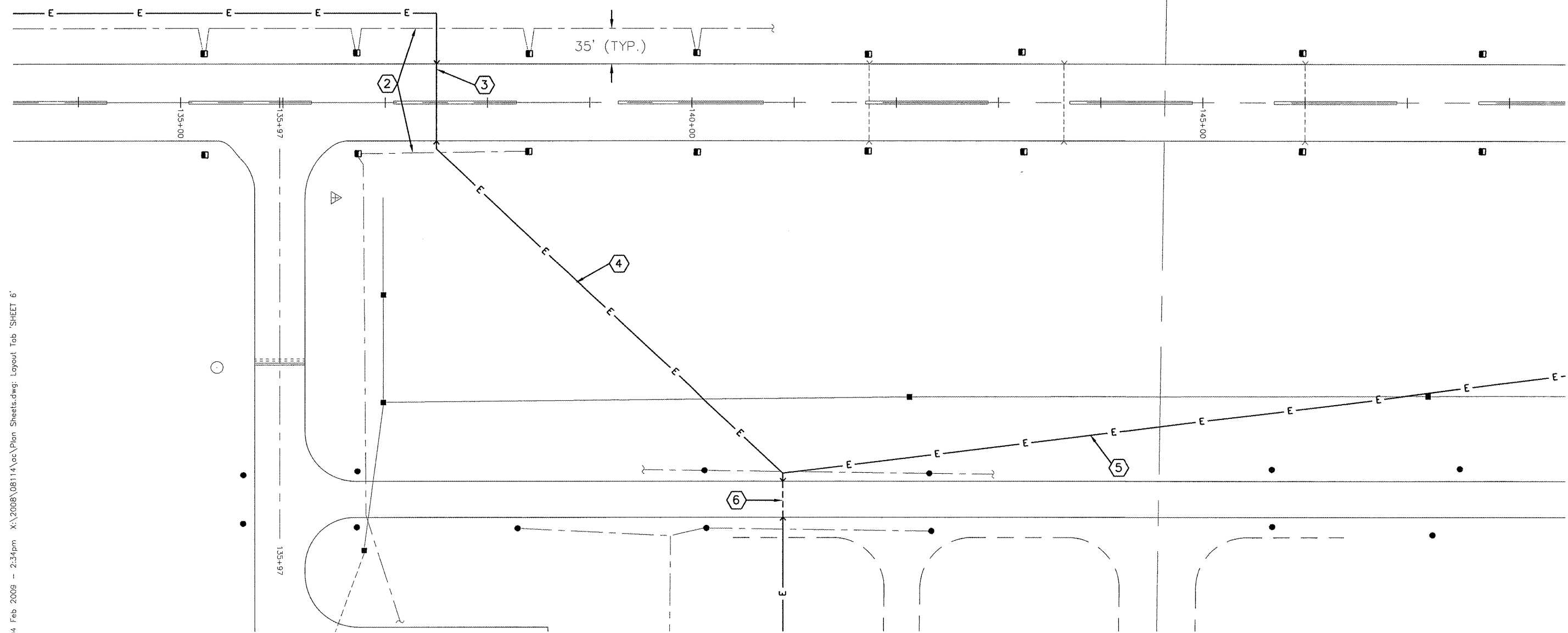
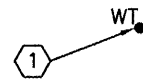

04 Feb 2009 - 2:34pm X:\2008\08114\loc\Plan Sheets.dwg: Layout Tab 'SHEET 6'