

GROUND CONTROL FREQUENCY - 121.90
 AIR CONTROL FREQUENCY - 124.30
 MAXIMUM HEIGHT OF EQUIPMENT - 25'

CRITICAL POINTS			
POINT	LATITUDE	LONGITUDE	ELEVATION
A	39°51'13.21"	89°40'05.87"	595.27
B	39°51'17.57"	89°40'09.02"	594.73

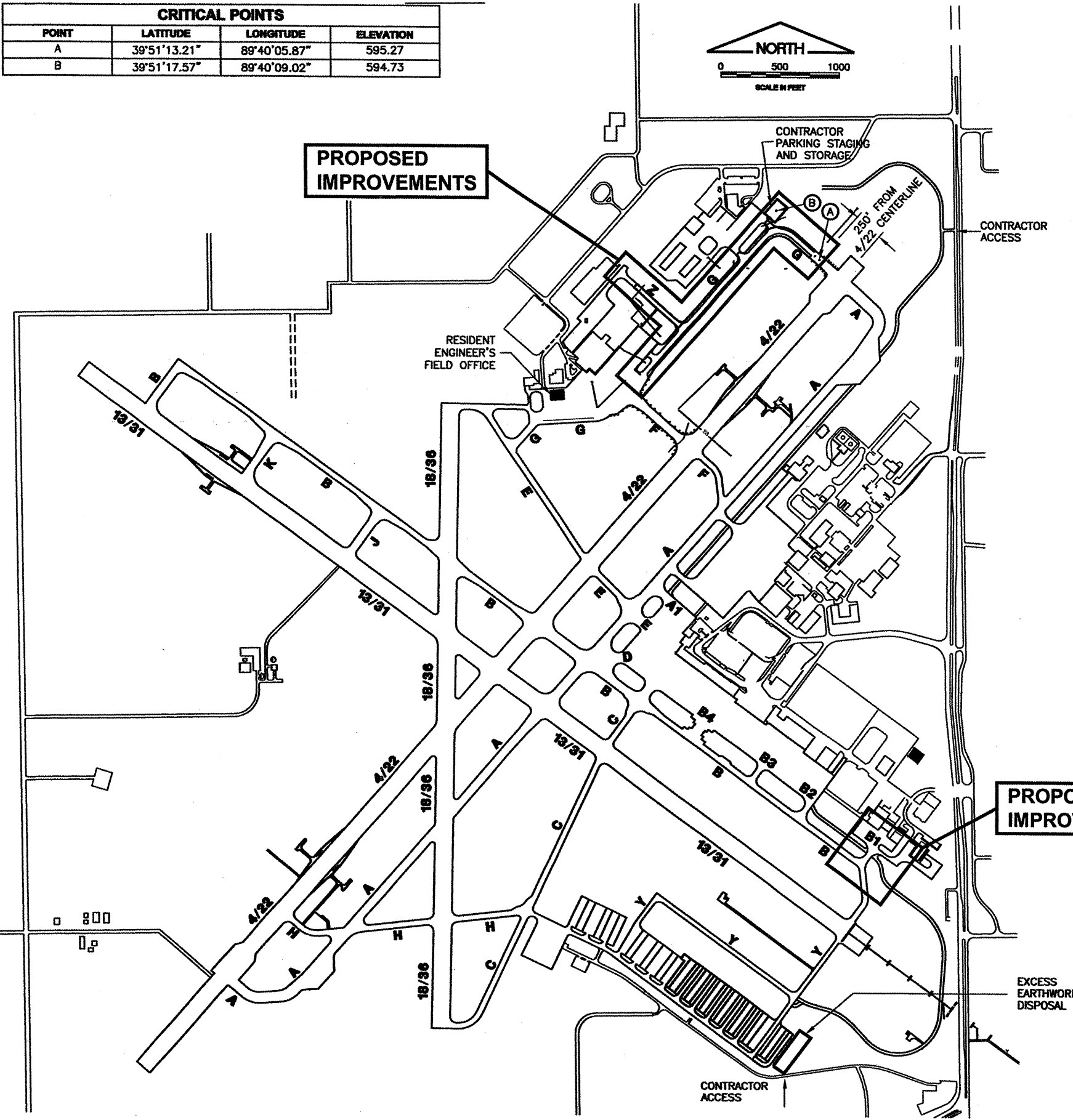

GENERAL NOTES

- ALL RUNWAYS, TAXIWAYS, AND APRONS SHALL BE KEPT OPEN TO AIRPORT TRAFFIC DURING CONSTRUCTION EXCEPT AS NOTED IN THE CONSTRUCTION ACTIVITY PLAN.
- ALL CONSTRUCTION TRAFFIC OPERATING ON OR CROSSING RUNWAYS, TAXIWAYS, AND APRONS OPEN TO AIRCRAFT TRAFFIC SHALL BE UNDER CONTROL OF A FLAGMAN IN RADIO CONTACT WITH FAA AIR TRAFFIC CONTROL TOWER PERSONNEL AT ALL TIMES. THE CONTRACTOR SHALL PROVIDE HIS OWN RADIOS AND ONLY HIS PERSONNEL WHO HAVE SUCCESSFULLY COMPLETED THE APPROVED SAA/FAA SAFETY COURSE MAY OPERATE THESE RADIOS.
- WHEN CONFLICTS ARISE BETWEEN CONSTRUCTION ACTIVITIES AND AIRCRAFT OPERATIONS AND SAFETY, AIRCRAFT OPERATIONS AND SAFETY SHALL TAKE PRECEDENCE AND SHALL GOVERN. FINAL AUTHORITY IN THE APPROVAL OF CONSTRUCTION SEQUENCING LIES WITH THE AIRPORT DIRECTOR.
- THE CONTRACTOR WILL BE PERMITTED TO STORE EQUIPMENT AND MATERIALS AT THE LOCATIONS SHOWN ON THE CONSTRUCTION ACTIVITY PLAN. THE MAXIMUM HEIGHT OF EQUIPMENT, MATERIALS AND STOCKPILES SHALL BE 25' ABOVE GROUND ELEVATION.
- BROKEN ASPHALT SHALL BE DISPOSED OF BY THE CONTRACTOR OFF OF AIRPORT PROPERTY UNLESS OTHERWISE DIRECTED BY THE AIRPORT.
- VEHICLES AND EQUIPMENT SHALL NOT BE ALLOWED WITHIN 95' FROM THE CENTERLINE OF ACTIVE TAXIWAYS OR 250' FROM THE CENTERLINE OF ACTIVE RUNWAYS.
- ROADS OR STORAGE AREAS SHALL BE MAINTAINED AND REPAIRED IN KIND BY THE CONTRACTOR TO THE SATISFACTION OF THE ENGINEER AND THE AIRPORT. NO ADDITIONAL COMPENSATION SHALL BE MADE TO THE CONTRACTOR FOR THIS WORK.
- EXISTING TURF AREAS DISTURBED BY THE CONTRACTOR'S OPERATIONS SHALL BE RESTORED BY HIM AT HIS EXPENSE TO THE SATISFACTION OF THE ENGINEER AND THE AIRPORT.
- THE CONTRACTOR SHALL CONTINUOUSLY CLEAN CONSTRUCTION AREAS WHICH ARE OR WILL BE OPENED TO AIR TRAFFIC.
- IT WILL BE NECESSARY FOR THE CONTRACTOR TO MAKE HIS OWN FIELD INVESTIGATION TO DETERMINE THE EXACT LOCATION OF THE UNDERGROUND UTILITIES AT CRITICAL POINTS SO AS TO AVOID ANY DAMAGE. ANY UTILITY, INCLUDING AIRFIELD ELECTRICAL CABLE AND LIGHTS, DAMAGED BY THE CONTRACTOR SHALL BE REPAIRED BY HIM AT HIS OWN EXPENSE IN A MANNER WHICH IS SATISFACTORY TO THE ENGINEER AND TO THE OWNER OF THE UTILITY. ANY REPAIRS THAT MUST BE MADE BY THE OWNER OF THE UTILITY SHALL HAVE THE COST REIMBURSED TO THE UTILITY BY THE CONTRACTOR. AIRFIELD LIGHTING CABLES DAMAGED BY THE CONTRACTOR SHALL BE REPAIRED BY A QUALIFIED ELECTRICIAN WITH THE COSTS TO BE BORNE BY THE CONTRACTOR.
- CONTRACTOR'S ACCESS SHALL BE AS FOLLOWS:
 - THE CONTRACTOR'S ACCESS TO WORK SHALL BE AS SHOWN IN THE PLANS.
 - THE CONTRACTOR SHALL COMPLETE A SECURITY FORM FOR ALL PERSONNEL HE PROPOSES TO USE ON THE AIRPORT. THESE FORMS SHALL BE COMPLETED PRIOR TO THAT PERSON BEING ALLOWED ON THE AIRFIELD. A LIST OF PERSONNEL AUTHORIZED TO WORK ON THE AIRFIELD SHALL BE PROVIDED TO THE RESIDENT ENGINEER BY THE CONTRACTOR.
 - THE CONTRACTOR SHALL USE AN EXISTING GATE(S) FOR ACCESS TO THE AIRFIELD. THE CONTRACTOR SHALL INSTALL AND MAINTAIN A HEAVY-DUTY PADLOCK ON THE ACCESS GATE. HE SHALL PROVIDE KEYS FOR HIS PADLOCK TO THE RESIDENT ENGINEER, S.A.A. MAINTENANCE SUPERVISOR, AND S.A.A. SECURITY CHIEF. NO ADDITIONAL KEYS ARE TO BE DISTRIBUTED UNLESS AUTHORIZED BY THE RESIDENT ENGINEER.
 - CONTRACTOR SHALL OBTAIN ALL NECESSARY PERMITS AND TEMPORARY EASEMENTS FOR THE PUBLIC ACCESS ROAD(S) SHOWN AND SHALL COMPLY WITH ALL REQUIREMENTS, LOAD RESTRICTIONS, & TRAFFIC CONTROL SIGNAGE REQUIRED BY THE CITY, COUNTY, TOWNSHIP, OR I.D.O.T.
 - DURING ADVERSE WEATHER THE CONTRACTOR SHALL MAINTAIN ACCESS TO THE WORK AT NO ADDITIONAL COST TO THE CONTRACT. NO EXTENSION OF THE CONTRACT TIME WILL BE CONSIDERED FOR DELAYS DUE TO LACK OF ADEQUATE ACCESS TO THE WORK SITE.
 - THE CONTRACTOR SHALL BE RESPONSIBLE FOR KEEPING THE ACCESS GATE(S) CLOSED DURING WORK HOURS. THE CONTRACTOR SHALL POST A COMPETENT SECURITY GUARD TO CONTROL ACCESS AT THE GATE. THE CONTRACTOR SHALL REPLACE ANY UNSATISFACTORY SECURITY GUARDS AS DIRECTED.
 - THE CONTRACTOR SHALL CLOSE AND LOCK THE ACCESS GATE(S) UPON LEAVING THE SITE.
 - ALL COSTS RELATING TO CONTRACTOR'S ACCESS AND SECURITY SHALL BE THE RESPONSIBILITY OF THE CONTRACTOR.
 - THE CONTRACTOR SHALL STORE EQUIPMENT AND MATERIALS IN SUCH A WAY AS NOT TO VIOLATE AIRPORT PART 77 SURFACES, OR RUNWAY AND TAXIWAY SAFETY AREAS.
 - THE CONTRACTOR SHALL BE RESPONSIBLE FOR CLEANING ACTIVE AIRFIELD PAVEMENTS WHICH ARE CROSSED BY HIS VEHICLES.
- EXCESS EARTHWORK DISPOSAL SHALL BE AS FOLLOWS:
 - EXCESS EARTHWORK SHALL BE DISPOSED AT THE LOCATION SHOWN, AS DIRECTED BY THE AIRPORT.
 - EXCESS EARTHWORK SHALL BE PLACED AND COMPACTED IN ACCORDANCE WITH ITEM 152.
 - THE CONTRACTOR SHALL INSTALL A TEMPORARY ACCESS GATE AT A LOCATION APPROVED BY THE AIRPORT FOR ACCESS TO THE DISPOSAL AREA.

K:\Springfield\0703509\Draw\Sheets\Phase 2 File
 FILE: SITEPLAN.dwg
 UPDATE BY: Kristy Brod
 PLOT DATE: 1/23/2009 1:27 PM
 BASE_PROPOSED
 SPIBASE_EXISTGEO
 BASE_EXISTSTOPO

CA007

REVISIONS		
NUMBER	BY	DATE

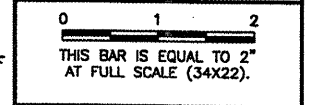

SPRINGFIELD AIRPORT AUTHORITY
ABRAHAM LINCOLN CAPITAL AIRPORT
SPRINGFIELD, ILLINOIS

WIDEN TAXIWAY G - PHASE 2
AIRPORT SITE PLAN

© Copyright CMT, Inc.

CMT
 CRAWFORD, MERRY & TILLY, INC.
 CONSULTING ENGINEERS
 License No. 984-006813

DESIGN BY:	CBG
DRAWN BY:	CMT
CHECKED BY:	RLW
APPROVED BY:	RLW
DATE:	01/30/2009
JOB No:	07035-09-00

IL PROJ. NO. SPI-3860
 AIP PROJ. NO. 3-17-0096-XX
 SHEET 03 OF 65 SHEETS