

F.A. RTE.	SECTION	COUNTY	TOTAL SHEETS	SHEET NO.
8894	05-00073-01-PV	MADISON	68	63
STA. 95+22.21		TO STA. 96+50.00		
FED. ROAD DIST. NO.	ILLINOIS	FEDERAL AID PROJECT		

FINAL SURVEY	DATE
WORKSHEET	BY
PLATE	
NOTE BOOK	
AREAS	
AREAS CHECKED	

ORIGINAL SURVEY	DATE
SURVEY	BY
NO.	

PLOT DATE = 12/2/2008  
 FILE NAME = I:\asw\8894\074610\draw\95+22.21-96+50.00.dwg  
 PLOT SCALE = 10.0000 / IN.  
 USER NAME = Rusty Miller-bms

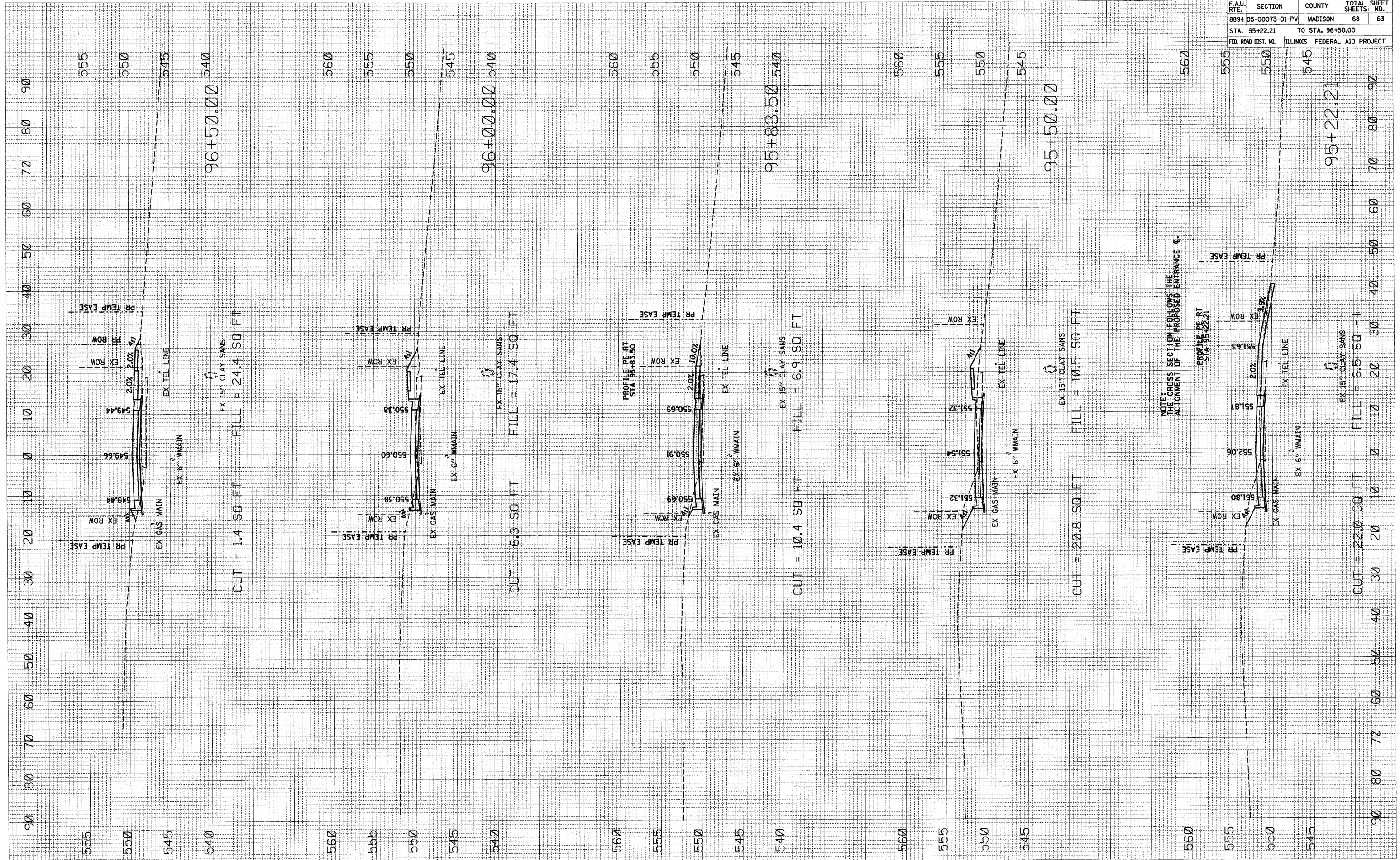

NOTE:  
 THE GROSS SECTION FOLLOWS THE  
 ALIGNMENT OF THE PROPOSED ENTRANCE &

GERBER ROAD: STA 95+22.21 TO STA 96+50.00

SCALE H: 1" = 10'  
 V: 1" = 5'