

F.A.U. RTE.	SECTION	COUNTY	TOTAL SHEETS	SHEET NO.
8894	05-00073-01-PV	MADISON	68	32
STA. N.A.	TO STA. N.A.			
FED. ROAD DIST. NO.	ILLINOIS	FEDERAL AID PROJECT		

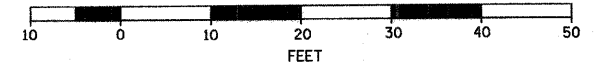

GRAPHIC SCALE



- (A) STA 102+96.41, 25.90' LT
- (B) STA 103+02.80, 18.92' LT
- (C) STA 103+04.43, 16.89' RT
- (D) STA 103+09.34, 15.95' RT

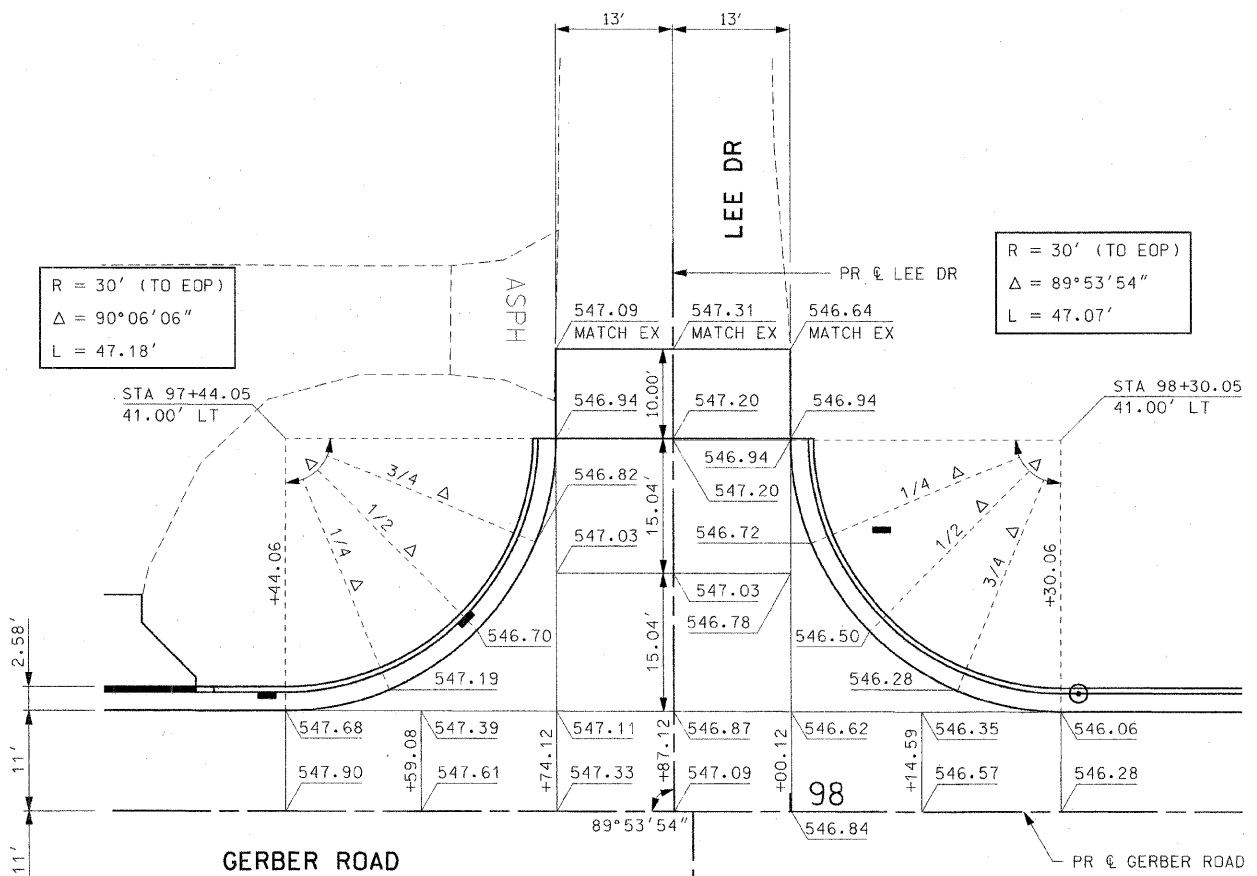

R = 125' (TO EOP)  
 Δ = 16°41'09"  
 L = 36.40'

R = 30' (TO EOP)  
 Δ = 89°53'54"  
 L = 47.07'

R = 30' (TO EOP)  
 Δ = 73°06'34"  
 L = 38.28'

R = 30' (TO EOP)  
 Δ = 59°02'31"  
 L = 30.91'

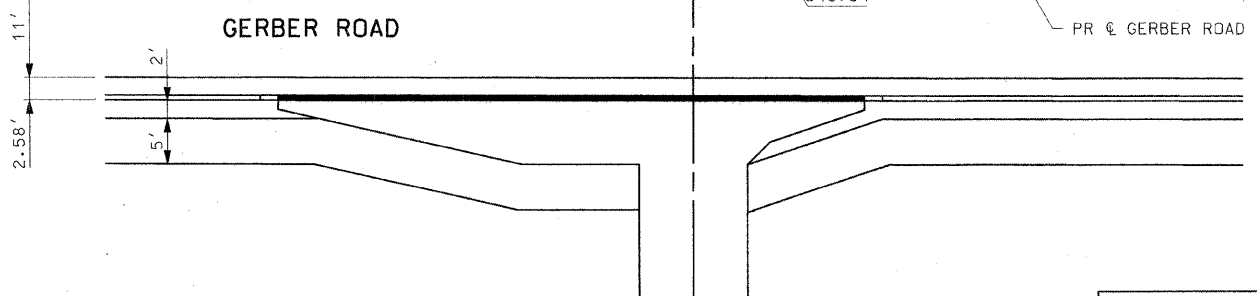

GERBER ROAD AND LEE DRIVE

GERBER ROAD AND FRANKLIN DRIVE

REVISIONS	
NAME	DATE

ILLINOIS DEPARTMENT OF TRANSPORTATION

INTERSECTION DETAILS

SCALE: VERT. N/A  
 HORIZ. 1"=10'  
 DATE 11/5/03  
 DRAWN BY AJK, RJM  
 CHECKED BY JWB

INTERSECTION DETAILS: GERBER ROAD