

F.A.J. RTE.	SECTION	COUNTY	TOTAL SHEETS	SHEET NO.
6713	06-00139-00-GE	TAZEWELL	13	7
STA. _____		TO STA. _____		
PROJECT: HFP 0750013 ILLINOIS CITY OF EAST PEORIA				

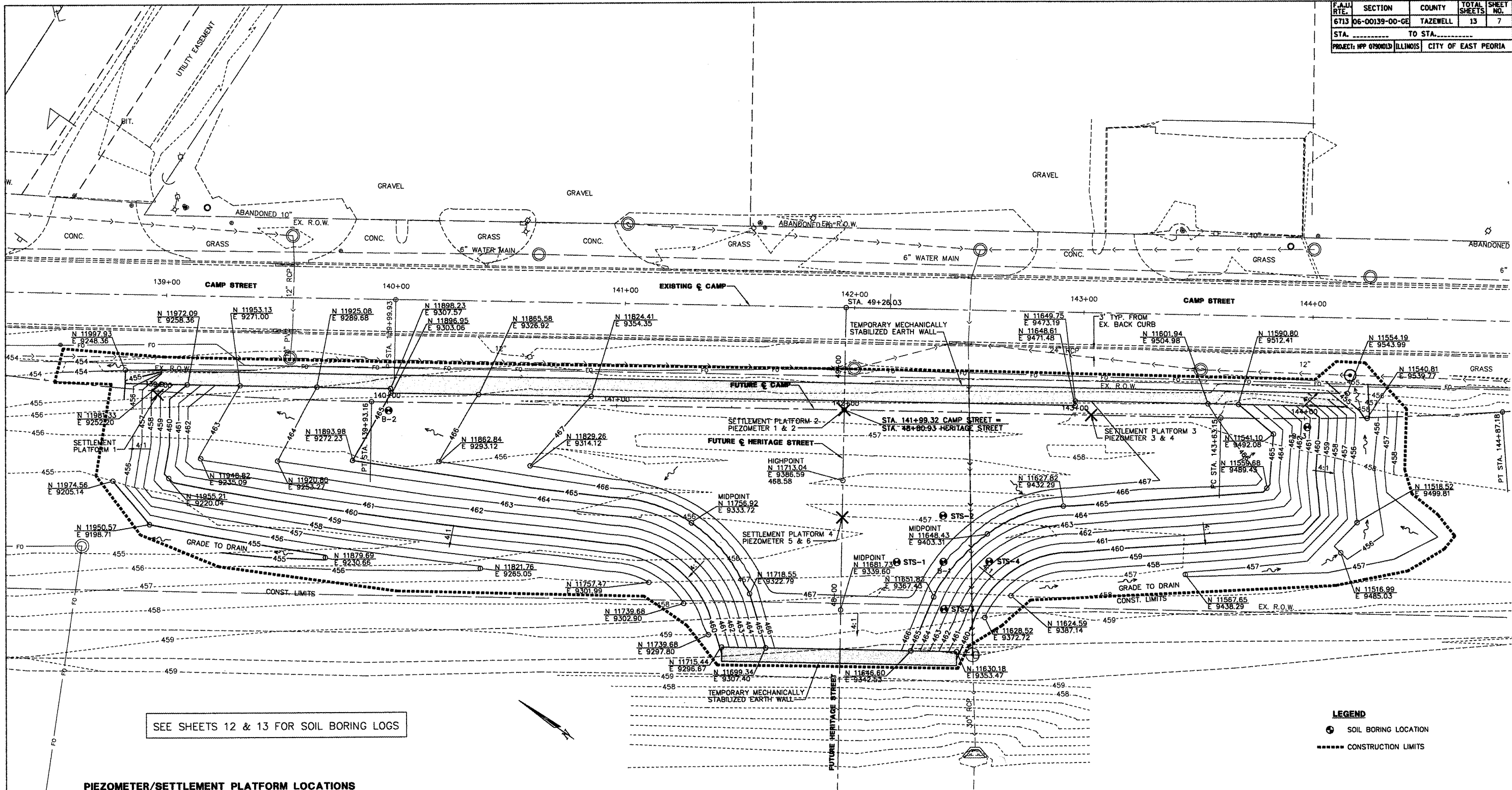

SEE SHEETS 12 & 13 FOR SOIL BORING LOGS

PIEZOMETER/SETTLEMENT PLATFORM LOCATIONS

SETTLEMENT PLATFORM 1 N 11704.06 E 9373.14	SETTLEMENT PLATFORM 3 AND PIEZOMETER 3 & 4 N 11640.56 E 9472.10
SETTLEMENT PLATFORM 2 AND PIEZOMETER 1 & 2 N 11730.13 E 9412.32	SETTLEMENT PLATFORM 4 AND PIEZOMETER 5 & 6 N 11704.06 E 9373.14

- NOTES:**
1. AT STATIONS 139+59 AND 142+59 ALONG FUTURE CENTERLINE CAMP STREET, DETAIL TEMPORARY MSE WALL TO PROVIDE FOR FUTURE EXCAVATION OF 18" STORM SEWER GOING THROUGH WALL AT RIGHT ANGLES.
 2. THE TEMPORARY MECHANICALLY STABILIZED EARTH WALL WILL NOT BE REMOVED, IT WILL REMAIN IN PLACE AND BECOME THE PROPERTY OF THE OWNER.

PLAN VIEW

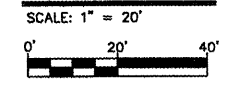

LEGEND

⊙	SOIL BORING LOCATION
-----	CONSTRUCTION LIMITS

REVISIONS	
NAME	DATE

ILLINOIS DEPARTMENT OF TRANSPORTATION
CAMP STREET FILL

LAYOUT AND GRADING PLAN

SCALE: 1" = 20'
DATE: 1-5-2009

DRAWN BY: MLB/MEW
CHECKED BY: DDB

DATE: 1-5-2009
DRAWN BY: MLB/MEW
CHECKED BY: DDB
SCALE: 1" = 20'
PROJECT: HFP 0750013
SHEET NO.: 7