

|      |                       |      |
|------|-----------------------|------|
| PLAN | SURVEYED              | DATE |
|      | PLOTTED               | BY   |
|      | CHECKED               |      |
|      | NO. OF SHEETS         |      |
|      | NO. OF SHEETS CHECKED |      |
|      | FILE NAME             |      |

|         |                       |      |
|---------|-----------------------|------|
| PROFILE | SURVEYED              | DATE |
|         | PLOTTED               | BY   |
|         | CHECKED               |      |
|         | NO. OF SHEETS         |      |
|         | NO. OF SHEETS CHECKED |      |
|         | FILE NAME             |      |

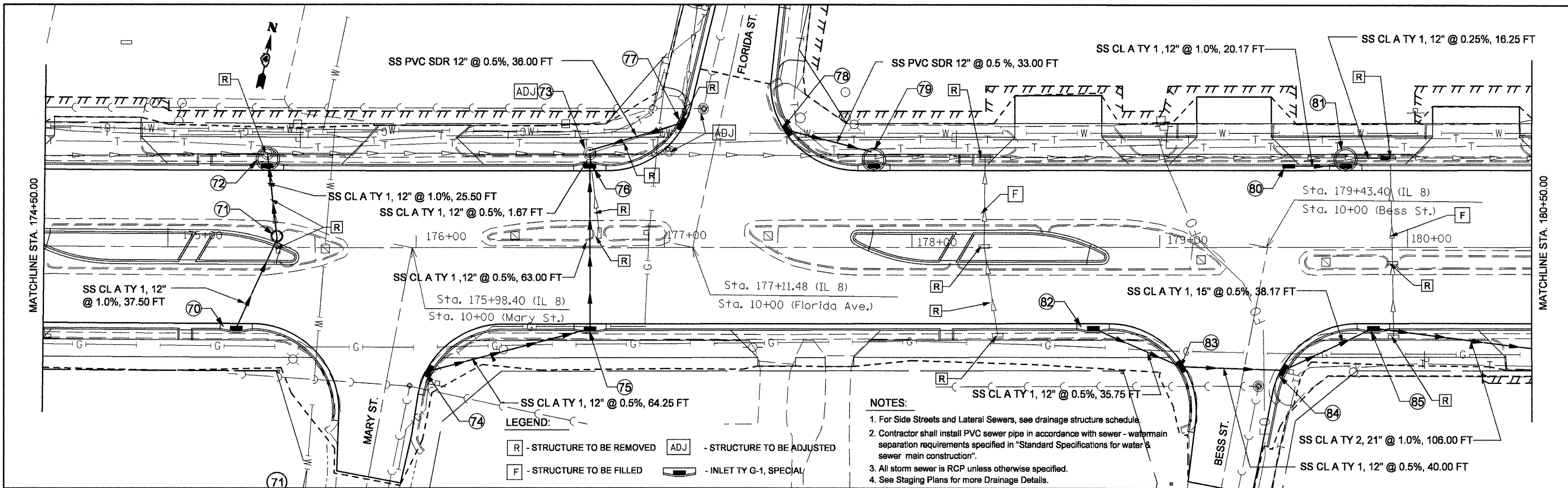

- NOTES:**
1. For Side Streets and Lateral Sewers, see drainage structure schedule.
  2. Contractor shall install PVC sewer pipe in accordance with sewer - watermain separation requirements specified in "Standard Specifications for water & sewer main construction".
  3. All storm sewer is RCP unless otherwise specified.
  4. See Staging Plans for more Drainage Details.

**LEGEND:**

R - STRUCTURE TO BE REMOVED    ADJ - STRUCTURE TO BE ADJUSTED

F - STRUCTURE TO BE FILLED    INLET TY G-1, SPECIAL

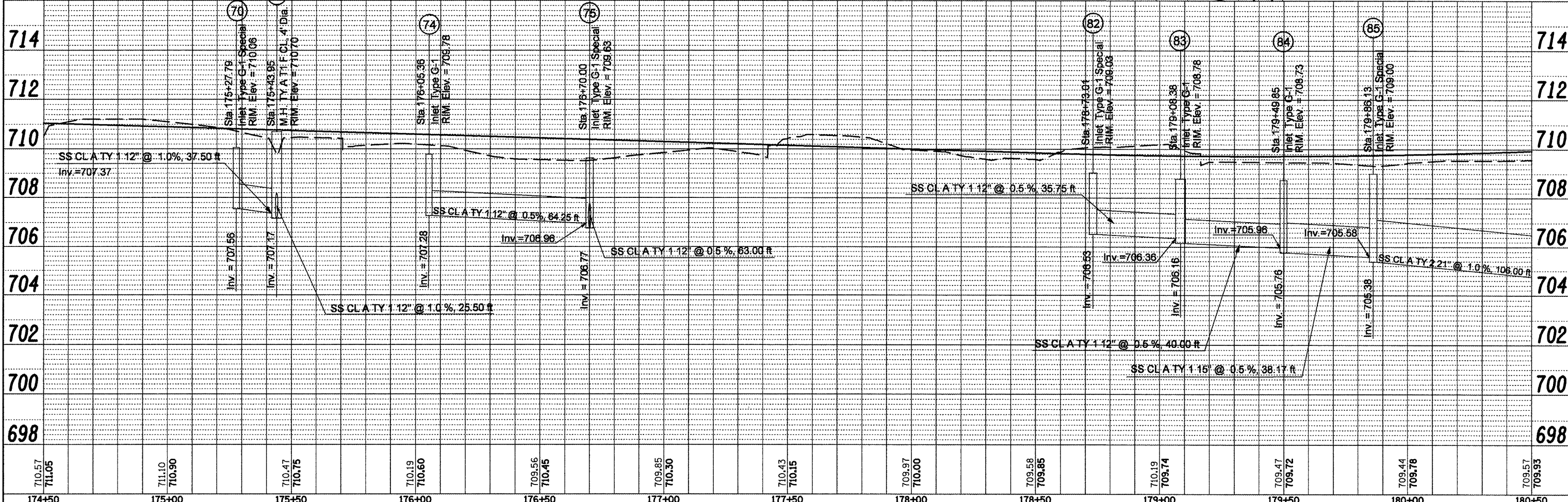

|                                              |                        |            |           |                                                           |                                          |                                                 |         |          |              |           |  |
|----------------------------------------------|------------------------|------------|-----------|-----------------------------------------------------------|------------------------------------------|-------------------------------------------------|---------|----------|--------------|-----------|--|
| FILE NAME =<br>copy of drainage plan r.t.dgn | USER NAME = swisher-dh | DESIGNED - | REVISED - | <b>STATE OF ILLINOIS<br/>DEPARTMENT OF TRANSPORTATION</b> | <b>IL RTE 8 - DRAINAGE PLANS RT SIDE</b> | F.A.P. RTE.                                     | SECTION | COUNTY   | TOTAL SHEETS | SHEET NO. |  |
|                                              |                        | DRAWN -    | REVISED - |                                                           |                                          | 399                                             | 36 R-8  | TAZEWELL | 429          | 119       |  |
|                                              |                        | CHECKED -  | REVISED - |                                                           |                                          | CONTRACT NO. 68258                              |         |          |              |           |  |
|                                              |                        | DATE -     | REVISED - |                                                           |                                          | FED. ROAD DIST. NO. 4 ILLINOIS FED. AID PROJECT |         |          |              |           |  |
|                                              |                        | SCALE:     | SHEET NO. | OF                                                        | SHEETS                                   | STA.                                            | TO      | STA.     |              |           |  |