

DATE	
BY	
REVIEWED	
NOTED	
ALIGNMENT CHECKED	
NO. 1	
NO. 2	
NO. 3	
NO. 4	
NO. 5	
NO. 6	
NO. 7	
NO. 8	
NO. 9	
NO. 10	
NO. 11	
NO. 12	
NO. 13	
NO. 14	
NO. 15	
NO. 16	
NO. 17	
NO. 18	
NO. 19	
NO. 20	
NO. 21	
NO. 22	
NO. 23	
NO. 24	
NO. 25	
NO. 26	
NO. 27	
NO. 28	
NO. 29	
NO. 30	

DATE	
BY	
REVIEWED	
NOTED	
GRADES CHECKED	
B.M. NOTED	
NO. 1	
NO. 2	
NO. 3	
NO. 4	
NO. 5	
NO. 6	
NO. 7	
NO. 8	
NO. 9	
NO. 10	
NO. 11	
NO. 12	
NO. 13	
NO. 14	
NO. 15	
NO. 16	
NO. 17	
NO. 18	
NO. 19	
NO. 20	
NO. 21	
NO. 22	
NO. 23	
NO. 24	
NO. 25	
NO. 26	
NO. 27	
NO. 28	
NO. 29	
NO. 30	

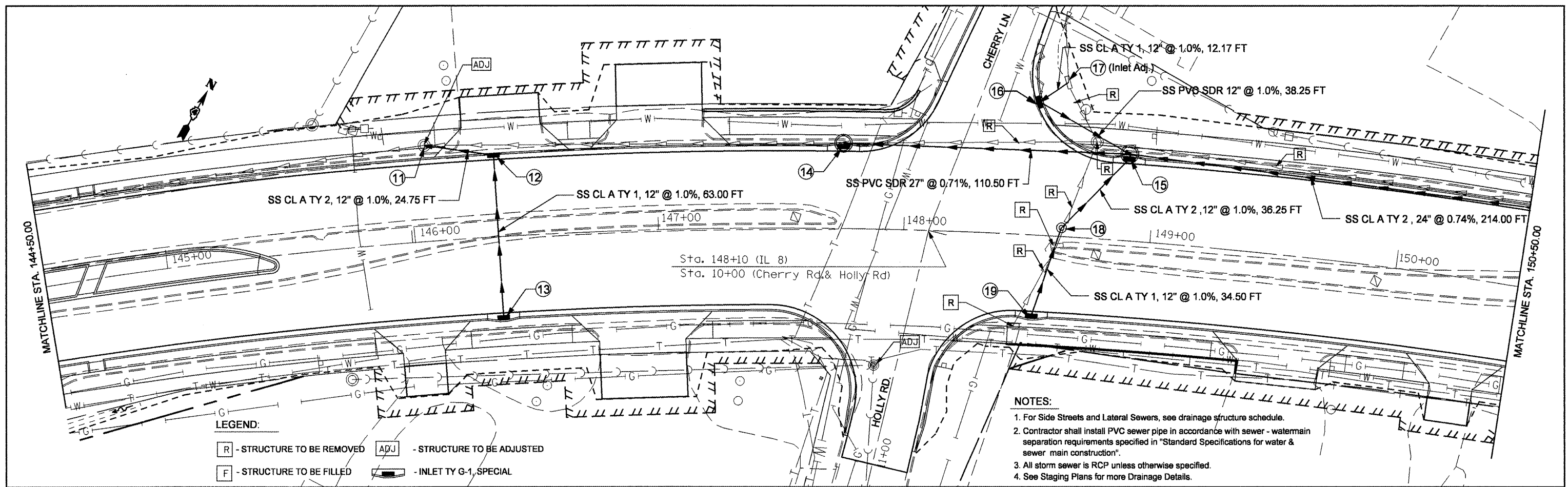

- LEGEND:**
- [R] - STRUCTURE TO BE REMOVED
 - [ADJ] - STRUCTURE TO BE ADJUSTED
 - [F] - STRUCTURE TO BE FILLED
 - [Symbol] - INLET TY G-1, SPECIAL

- NOTES:**
- For Side Streets and Lateral Sewers, see drainage structure schedule.
 - Contractor shall install PVC sewer pipe in accordance with sewer - watermain separation requirements specified in "Standard Specifications for water & sewer main construction".
 - All storm sewer is RCP unless otherwise specified.
 - See Staging Plans for more Drainage Details.

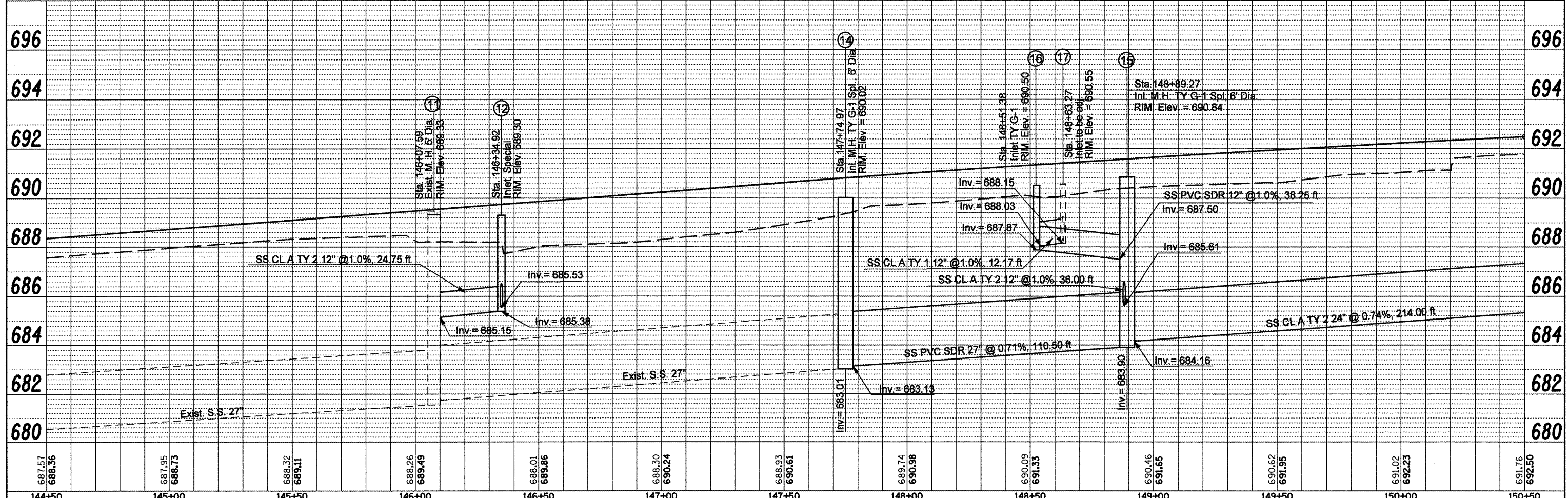

687.57 688.36	687.95 688.73	688.32 689.11	688.26 689.49	688.01 689.86	688.30 690.24	688.93 690.61	689.74 690.98	690.09 691.33	690.46 691.65	690.62 691.95	691.02 692.23	691.76 692.50
144+50	145+00	145+50	146+00	146+50	147+00	147+50	148+00	148+50	149+00	149+50	150+00	150+50

STATE OF ILLINOIS
DEPARTMENT OF TRANSPORTATION

IL RTE 8 - DRAINAGE PLANS LT SIDE

F.A.P. RTE.	SECTION	COUNTY	TOTAL SHEETS	SHEET NO.
399	36 R-8	TAZEWELL	429	102
CONTRACT NO. 68258				

FILE NAME =
copy of drainage plan lt.dgn

USER NAME = swisher-dh	DESIGNED -	REVISED -
PLOT SCALE = 48,00000' / IN.	DRAWN -	REVISED -
PLOT DATE = 12/11/2008	CHECKED -	REVISED -
	DATE -	REVISED -

SCALE: SHEET NO. OF SHEETS STA. TO STA.

FED. ROAD DIST. NO. 4 ILLINOIS FED. AID PROJECT