

PLAN	SURVEYED	DATE
	PLOTTED	BY
	CHECKED	
	BY	
	DATE	
	FILE NAME	
	NO.	

PROFILE	SURVEYED	DATE
	PLOTTED	BY
	CHECKED	
	BY	
	DATE	
	FILE NAME	
	NO.	

LEGEND:

PROPOSED

- (A) PROPOSED HOT-MIX ASPHALT SURFACE COURSE, MIX C, N50, 1 1/2"
- (B) PROPOSED LEVELING BINDER, N50, 3/4"
- (C) PROPOSED HOT-MIX ASPHALT BASE COURSE 10 1/2"
- (D) PROPOSED HOT-MIX ASPHALT SHOULDERS, 8"
- (E) PROPOSED POROUS GRANULAR EMBANKMENT
- (F) STEEL PLATE BEAM GUARD RAIL, ATTACHED TO STRUCTURES.
- (G) PROPOSED CONCRETE BOX CULVERT 14' X 6'
- (H) PAVEMENT MARKING

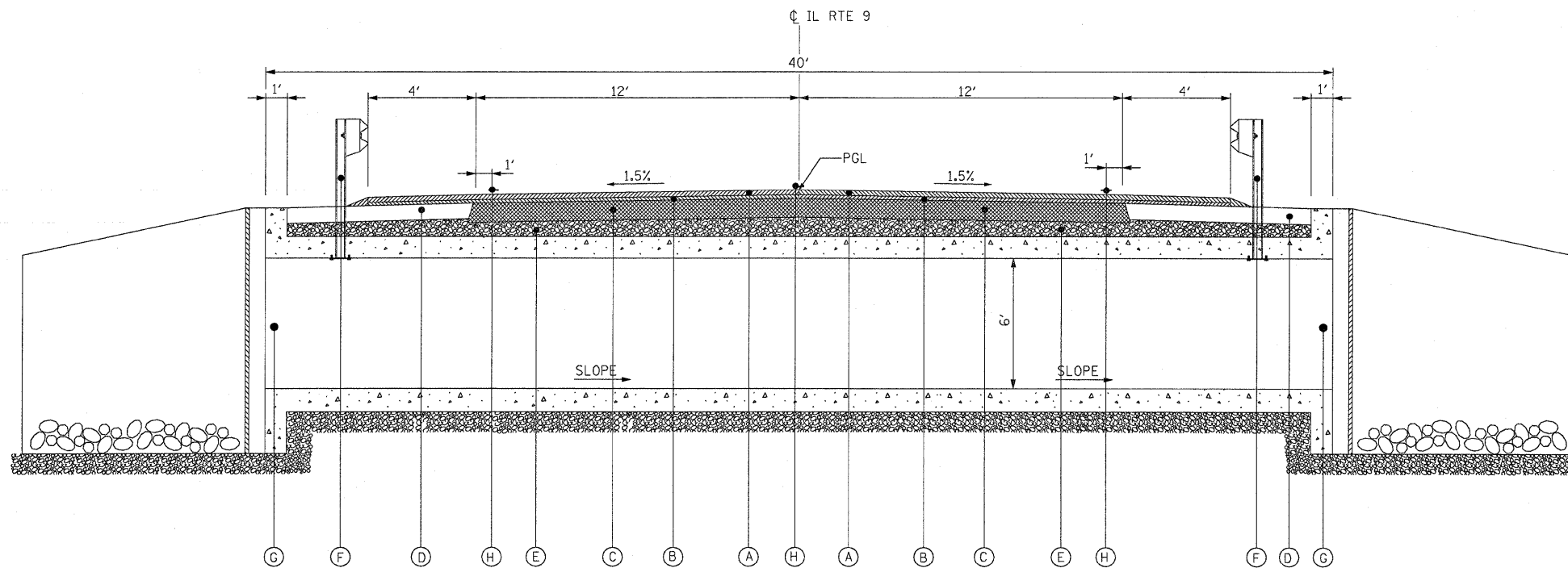

PROPOSED BOX CULVERT SECTION LOOKING EAST

NTS
FROM STA 50+47.17 TO STA 50+62.83

REVISOR'S MARK: Δ REVISED SHEET 2/19/09

FILE NAME =	USER NAME = carpenterdj	DESIGNED DB	REVISED -	STATE OF ILLINOIS DEPARTMENT OF TRANSPORTATION	TYPICAL SECTIONS SN 027-2552 SHEET 2 OF 2	F.A.P. RTE.	SECTION	COUNTY	TOTAL SHEETS	SHEET NO.	
ca:\pwork\pwwd01\CARPENTERD\dms77953\027-2552-05typ-sh2.dgn	DRAWN NS/RM	CHECKED AS	REVISED -			697	(17I)	FORD	29	5	
PLOT SCALE = 21.1764' / IN.	DATE DECEMBER 2008	REVISED -	SCALE: NTS			SHEET NO. 1 OF SHEETS		STA.	TO STA.		CONTRACT NO. 66874
PLOT DATE = Feb 17, 2009 - 01:25:53 PM	REVISED -					FED. ROAD DIST. NO.		ILLINOIS FED. AID PROJECT			



DATE	
BY	
SURVEYED	
DESIGNED	
CHECKED	
NOTED	
STRUCTURE	
NOTATIONS	
DATE	
BY	
SURVEYED	
DESIGNED	
CHECKED	
NOTED	
STRUCTURE	
NOTATIONS	

DATE	
BY	
SURVEYED	
DESIGNED	
CHECKED	
NOTED	
STRUCTURE	
NOTATIONS	
DATE	
BY	
SURVEYED	
DESIGNED	
CHECKED	
NOTED	
STRUCTURE	
NOTATIONS	

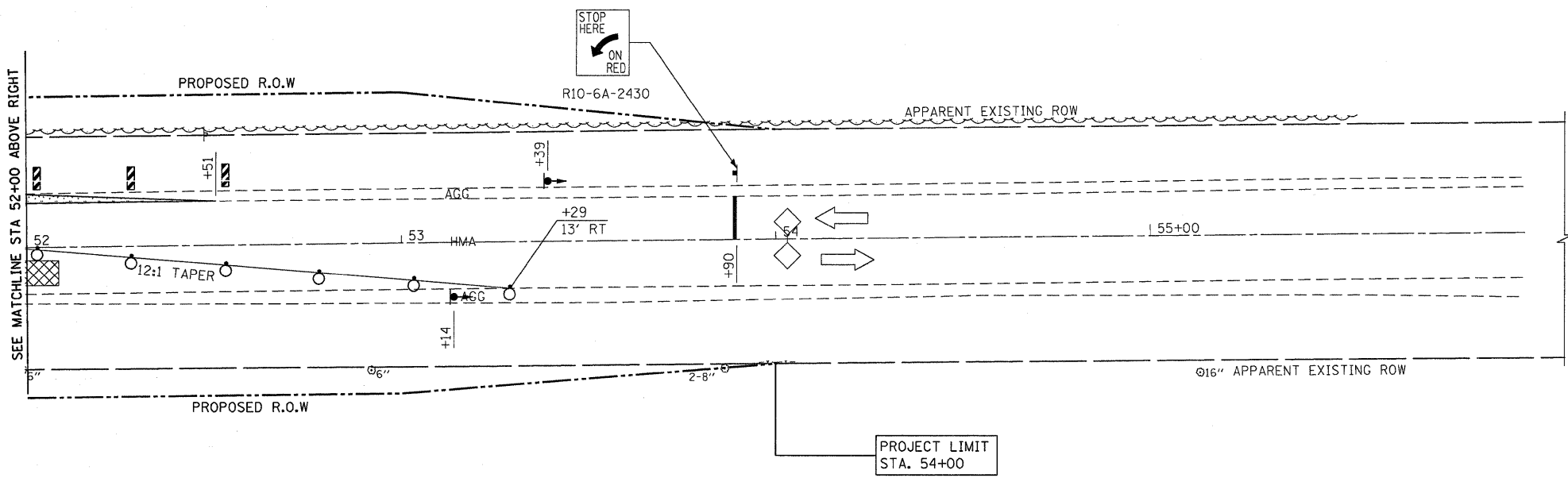
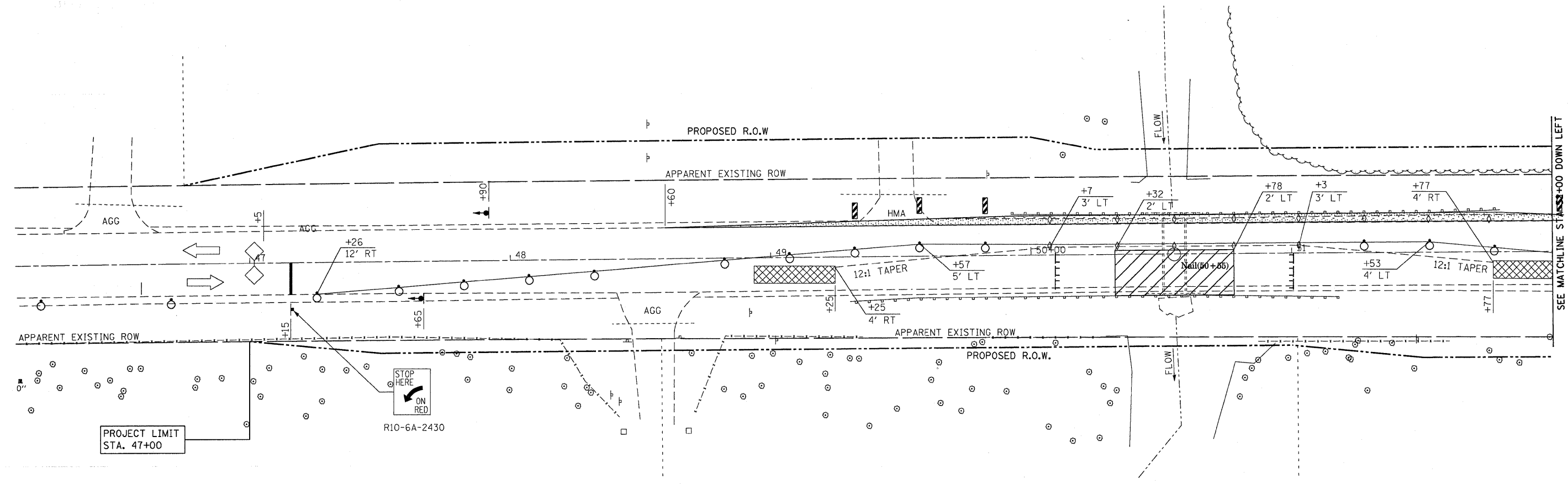

LEGEND:

- HOT-MIX ASPHALT SHOULDERS, 8"
- DRUM WITH STEADY BURN LIGHT
- TRAFFIC SIGNALS WITH BACKPLATE
- MICROWAVE DETECTOR
- SIGN
- TYPE III BARRICADE WITH FLASHING LIGHTS
- TYPE "C" BIDIRECTIONAL REFLECTOR
- DOUBLE VERTICAL PANEL (SEE DETAIL)
- TEMPORARY CONCRETE BARRIER
- IMPACT ATTENUATORS, TEMPORARY (NON-REDIRECTIVE) TEST LEVEL 3
- WORK AREA

NOTES:

1. SEE STANDARD 701321 FOR DETAILS.
2. SEE STRUCTURAL SHEETS FOR STAGES OF CONSTRUCTION.
3. TEMPORARY PAVEMENT FOR STAGE 1 TRAFFIC CONTROL WILL BE CONSTRUCTED IN PRE-STAGE.

2 REVISED SHEET 2/19/09

FILE NAME =	USER NAME = carpenterdj	DESIGNED DB	REVISED -	STATE OF ILLINOIS DEPARTMENT OF TRANSPORTATION	STAGE I TRAFFIC CONTROL			F.A.P. RTE.	SECTION	COUNTY	TOTAL SHEETS	SHEET NO.
c:\pw\work\PWIDOT\CARPENTERDJ\dms77953\027-2592-11MOT-stage1.dgn		DRAWN NS/RM	REVISED -		SCALE: 1"=20'	SHEET NO. 1 OF 2 SHEETS	STA. 46+10 TO STA. 54+90	697	(17)I	FORD	29	11
PLOT SCALE = 20.0000' / IN.		CHECKED AS	REVISED -		CONTRACT NO. 66874							
PLOT DATE = Feb 17, 2009 - 01:45:22 PM		DATE DECEMBER 2008	REVISED -		FED. ROAD DIST. NO. ILLINOIS FED. AID PROJECT							



PLAN	SURVEYED	BY	DATE
	PLOTTED		
	CHECKED		
	NO. OF WAY CHECKED		
	NO.		
	PAID FILE NAME		

PROFILE	SURVEYED	BY	DATE
	PLOTTED		
	CHECKED		
	NO. OF WAY CHECKED		
	NO.		
	STRUCTURE NOTATIONS DRWD		

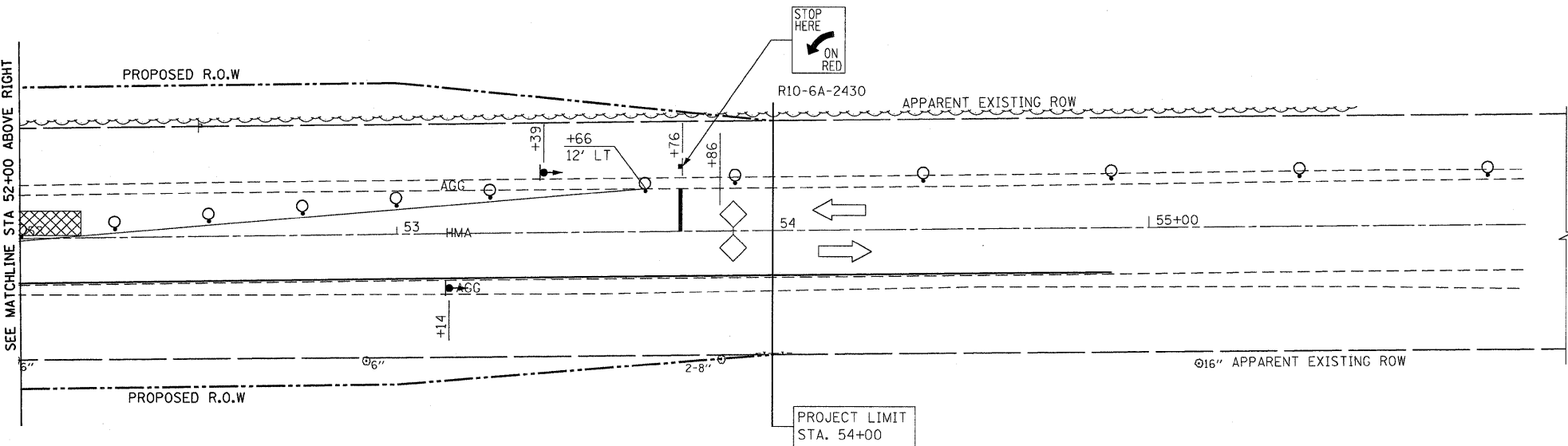
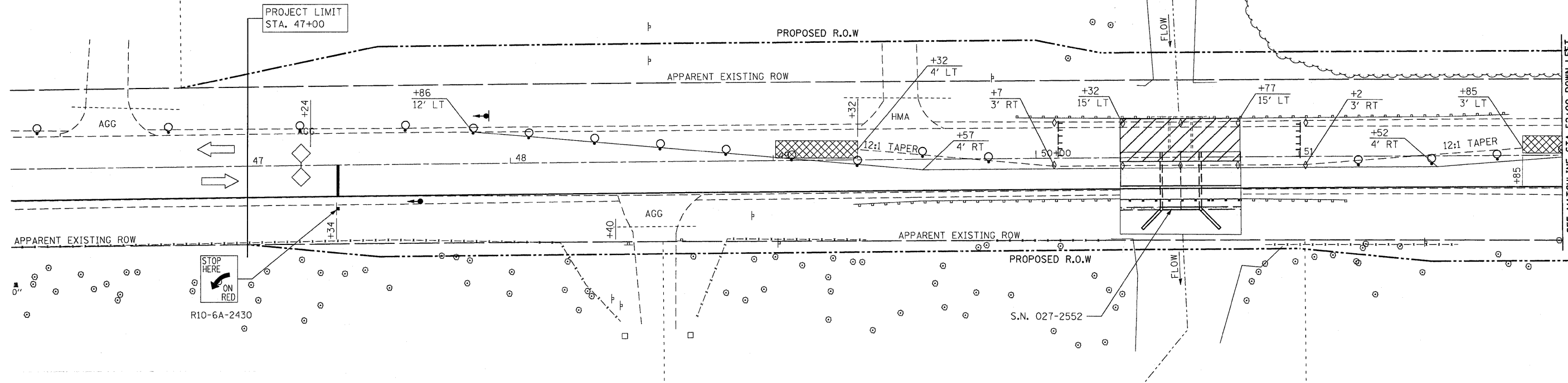

LEGEND:

- HOT-MIX ASPHALT SHOULDERS, 8"
- DRUM WITH STEADY BURN LIGHT
- TRAFFIC SIGNALS WITH BACKPLATE
- MICROWAVE DETECTOR
- SIGN
- TYPE III BARRICADE WITH FLASHING LIGHTS
- TYPE "C" BIDIRECTIONAL REFLECTOR
- DOUBLE VERTICAL PANEL (SEE DETAIL)
- TEMPORARY CONCRETE BARRIER
- IMPACT ATTENUATORS, TEMPORARY (NON-REDIRECTIVE) TEST LEVEL 3
- WORK AREA

NOTES:

1. SEE STANDARD 701321 FOR DETAILS.
2. SEE STRUCTURAL SHEETS FOR STAGING PLAN.
3. THE ENTRANCE AT STATION 49+49 TO BE RELOCATED PRIOR TO SWITCHING TO STAGE II TRAFFIC CONTROL.

2 REVISED SHEET 2/19/09

FILE NAME =	USER NAME = carpenterdj	DESIGNED DB	REVISED -	STATE OF ILLINOIS DEPARTMENT OF TRANSPORTATION	STAGE II TRAFFIC CONTROL			F.A.P. RTE.	SECTION	COUNTY	TOTAL SHEETS	SHEET NO.
c:\pw_work\PW\IDOT\CARPENTERDJ\dms77953\027-2552-12MOT-stage2.dgn	DRAWN NS/RM	REVISIED -	REVISED -		SCALE: 1"=20'	SHEET NO. 2 OF 2 SHEETS	STA. 46+10 TO STA. 54+90	697	(17)I	FORD	29	12
PLOT SCALE = 28.00000' / IN.	CHECKED AS	REVISIED -	REVISED -		CONTRACT NO. 66874							
PLOT DATE = Feb 17, 2009 - 01:47:25 PM	DATE DECEMBER 2008	REVISIED -	REVISED -		FED. ROAD DIST. NO. ILLINOIS FED. AID PROJECT							