

# STAGE 1

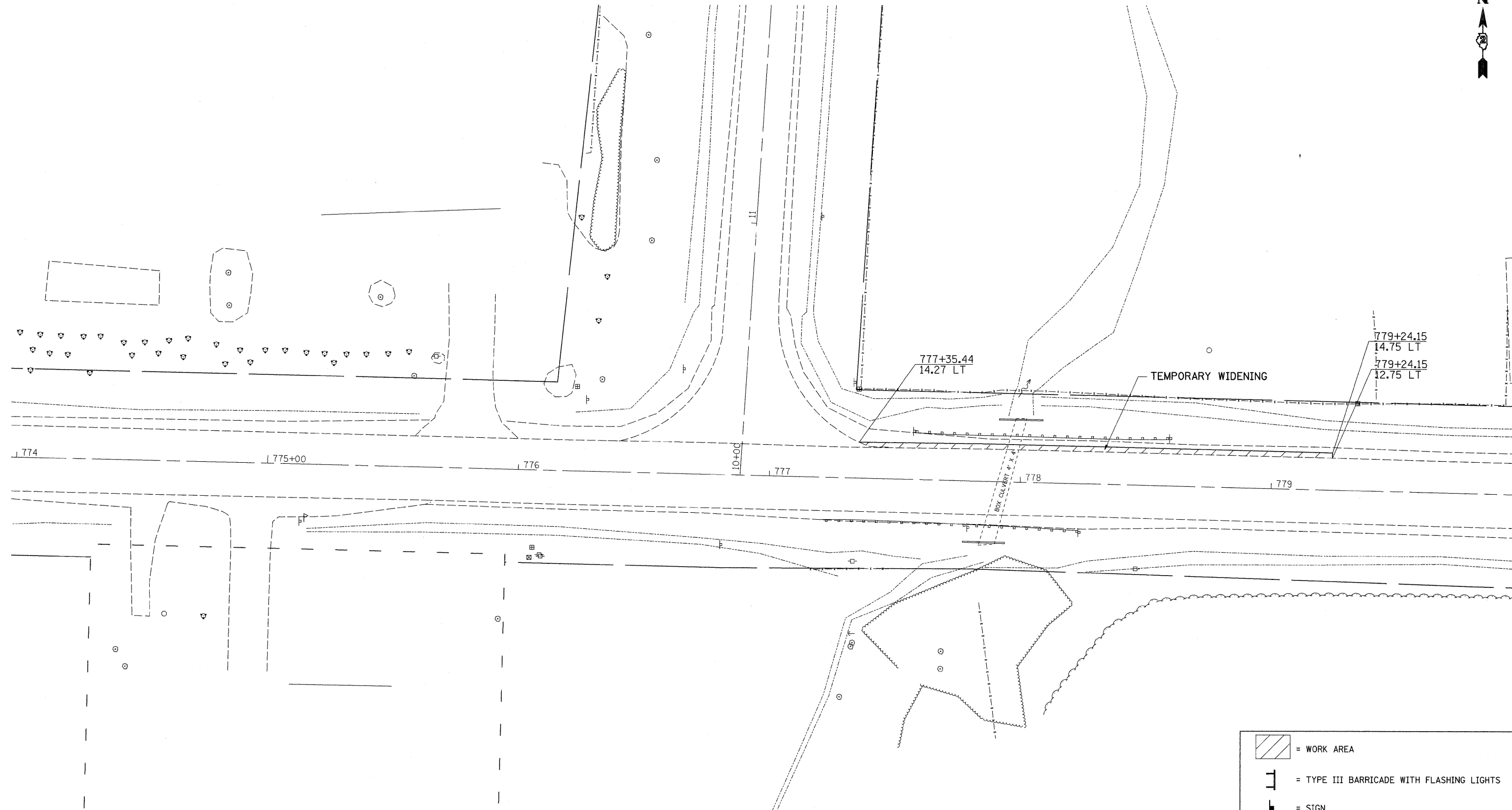

### STAGE 1 NOTES

1. USE STANDARD 701201 FOR SHOULDER WORK.
2. PLACE 2' WIDE TEMPORARY SHOULDERS STA. 777+35.44 TO STA. 779+24.15 LT.

	= WORK AREA
	= TYPE III BARRICADE WITH FLASHING LIGHTS
	= SIGN
	= BARRICADE, OR DRUM WITH STEADY BURNING LIGHTS
	= INDUCTION LOOP DETECTOR
	= TRAFFIC SIGNAL

FILE NAME = c:\pw_work\FWIDOT\HENSONKE\dms34455\d1506stg.dgn	USER NAME = hensonke	DESIGNED -	REVISED -	<b>STATE OF ILLINOIS DEPARTMENT OF TRANSPORTATION</b>	<b>STAGING PLANS</b>			F.A.P. RTE.	SECTION	COUNTY	TOTAL SHEETS	SHEET NO.
	PLOT SCALE = 20.0000' / 1" IN.	DRAWN -	REVISED -					611	103T-2	HENRY	35	13
PLOT DATE = Tue Dec 02 13:33:42 2008	CHECKED -	REVISED -	REVISED -	SCALE: SHEET NO. OF SHEETS STA. TO STA.			CONTRACT NO. 64C66					
	DATE -	REVISED -	REVISED -				ILLINOIS FED. AID PROJECT					