

F.A. RTE.	SECTION	COUNTY	TOTAL SHEETS	SHEET NO.
---	08-00067-00-RS	COOK	15	1
STA.	---	TO STA.	---	
FED. ROAD DIST. NO.	ILLINOIS	FED. AID PROJECT		
CONTRACT NO. 63103				

INDEX OF SHEETS

SHEET NO.	DESCRIPTION
1	TITLE SHEET
2	GENERAL NOTES AND IDOT STANDARDS
3	SUMMARY OF QUANTITIES
4	TYPICAL SECTIONS
5 - 6	PROPOSED PLAN - WOLF ROAD
7 - 8	PROPOSED PLAN - VILLAGE DRIVE
9 - 10	PROPOSED PLAN - DICKENS AVENUE
11	CONSTRUCTION DETAILS
12	CURB OR CURB AND GUTTER REMOVAL AND REPLACEMENT
13	BUTT JOINT AND HMA TAPER DETAILS
14	DISTRICT ONE TYPICAL PAVEMENT MARKINGS
15	TRAFFIC CONTROL AND PROTECTION FOR SIDE ROADS, INTERSECTIONS, AND DRIVEWAYS

**STATE OF ILLINOIS
DEPARTMENT OF TRANSPORTATION
DIVISION OF HIGHWAYS**

PLANS FOR PROPOSED FEDERAL AID HIGHWAY

**WOLF ROAD (FAU 2690) - FROM LAKE ST. TO NORTH AV.
VILLAGE DRIVE - FROM LaPORTE AV. TO ROY AV.
DICKENS AVENUE - FROM ROBERTA AV. TO GENEVA AV.**

**Section No.: 08-00067-00-RS
STREET RESURFACING**

Project No.: HD-M-9003 (024)

**CITY OF NORTHLAKE
COOK COUNTY**

JOB NO.: C-91-406-08

R 12 E

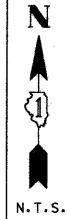
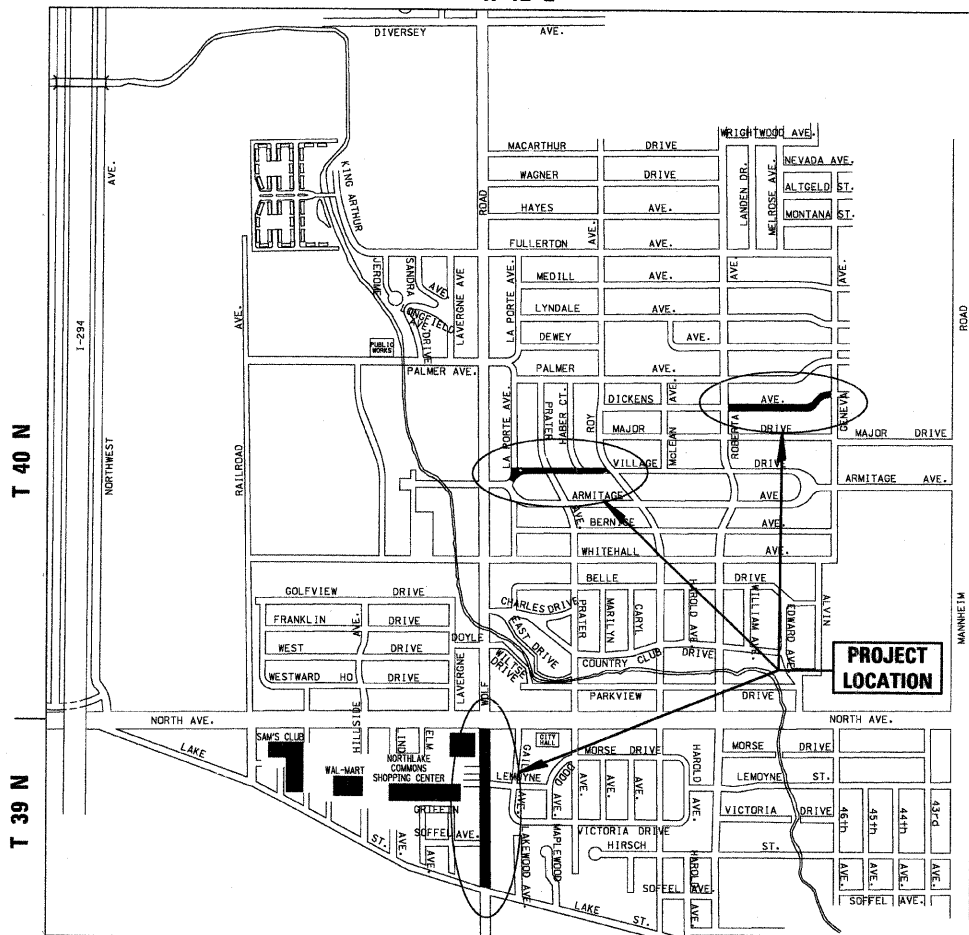

THE CONTRACTOR SHALL BE SOLELY RESPONSIBLE FOR JOB SITE SAFETY AS WELL AS SUPERVISION/DIRECTION AND MEANS/METHODS OF CONSTRUCTION.

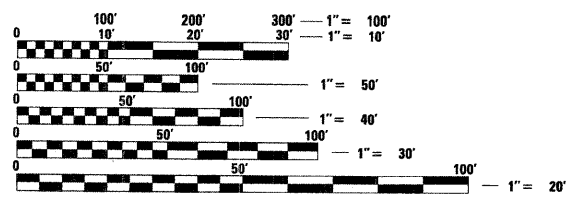

FULL SIZE PLANS HAVE BEEN PREPARED USING STANDARD ENGINEERING SCALES. REDUCED SIZED PLANS WILL NOT CONFORM TO STANDARD SCALES. IN MAKING MEASUREMENTS ON REDUCED PLANS, THE ABOVE SCALES MAY BE USED.

J.U.L.I.E.
JOINT UTILITY LOCATION INFORMATION FOR EXCAVATION
811

TRAFFIC DATA
WOLF ROAD
ADT (YEAR) = 8900 (2008)
SPEED LIMIT = 35 MPH

VILLAGE DRIVE AND DICKENS AVENUE
ADT (YEAR) = 600 (2008)
SPEED LIMIT = 25 MPH

DESIGN DESIGNATION
VILLAGE DRIVE AND DICKENS AVENUE -
RESIDENTIAL COLLECTOR STREET

WOLF ROAD - ARTERIAL

**STATE OF ILLINOIS
DEPARTMENT OF TRANSPORTATION
DIVISION OF HIGHWAYS**

APPROVED 11/12 20 2008
 MAYOR
CITY OF NORTHLAKE

PASSED JANUARY 7 20 09
 DISTRICT 1 ENGINEER OF LOCAL ROADS AND STREETS

RELEASING FOR
BID BASED ON
LIMITED REVIEW JANUARY 8, 2009

Diane M. O'Keefe
DEPUTY DIRECTOR OF HIGHWAYS
REGION ONE ENGINEER



PRINTED BY THE AUTHORITY OF THE STATE OF ILLINOIS

11/12 2008

Jason G. Souden
ILLINOIS REGISTRATION No. 062-050850 ENGINEER
EXPIRATION DATE: 11/30/09

CHRISTOPHER B. BURKE ENGINEERING L.T.D.
9575 West Higgins Road, Suite 600
Rosemont, Illinois 60018
(847) 823-0500

MARILYN SOLOMON
201 W. CENTER COURT
SCHALMURG, ILLINOIS 60196-1096
(847) 705-4407

CONTRACT NO. 63103

LOCATION MAP - PROVISO TOWNSHIP
GROSS LENGTH OF PROJECT = 4413 LINEAL FEET (0.84 MI.)
NET LENGTH OF PROJECT = 4413 LINEAL FEET (0.84 MI.)

GENERAL NOTES

F.A. RTE.	SECTION	COUNTY	TOTAL SHEETS	SHEET NO.
---	08-00067-00-RS	COOK	15	2
STA. ---		TO STA. ---		
FED. ROAD DIST. NO.	ILLINOIS	FED. AID PROJECT		

CONTRACT NO. 63103

SPECIFICATIONS, STANDARDS AND SPECIAL PROVISIONS

ALL CONSTRUCTION SHALL BE DONE IN ACCORDANCE WITH THE "STANDARD SPECIFICATIONS FOR ROAD AND BRIDGE CONSTRUCTION", ADOPTED JANUARY 1, 2007; THE "SUPPLEMENTAL SPECIFICATIONS AND RECURRING SPECIAL PROVISIONS", ADOPTED JANUARY 1, 2009; THE LATEST EDITION OF THE "ILLINOIS MANUAL ON UNIFORM TRAFFIC CONTROL DEVICES FOR STREETS AND HIGHWAYS" (IMUTCD), "THE STANDARD SPECIFICATIONS FOR WATER AND SEWER MAIN CONSTRUCTION IN ILLINOIS" MAY 1996 FIFTH EDITION, THE "DETAILS" IN THE PLANS, LATEST EDITION OF THE MANUAL OF TEST PROCEDURE OF MATERIALS, THE AMERICAN WITH DISABILITIES ACT OF 1990 ACCESSIBILITY GUIDELINES, THE "DRAFT" REHABILITATION ACT OF 1973 (SECTION 504), THE PUBLIC RIGHTS -OF-WAY ACCESSIBILITY GUIDELINES, AND THE "SPECIAL PROVISIONS" INCLUDED IN THE CONTRACT DOCUMENTS.

UTILITIES

THE CONTRACTOR SHALL COOPERATE WITH THE CITY IN ANY UNDERGROUND UTILITY CONSTRUCTION WHICH THE CITY MAY WANT TO PLACE DURING THE CONTRACTOR'S OPERATIONS.

THE CONTRACTOR SHALL BE RESPONSIBLE FOR CONTACTING THE OWNERS OF ALL EXISTING FACILITIES SO THAT THE UTILITIES AND THEIR APPURTENANCES MAY BE LOCATED AND ADJUSTED OR MOVED, IF NECESSARY, PRIOR TO THE START OF CONSTRUCTION OPERATIONS. THE CONTRACTOR SHALL COOPERATE WITH ALL UTILITY OWNERS AS PROVIDED FOR IN THE STANDARD SPECIFICATIONS.

THE LOCATIONS OF EXISTING DRAINAGE STRUCTURES, STORM AND SANITARY SEWERS, WATER SERVICE LINES AND OTHER UTILITY LINES ARE APPROXIMATE, AND THE CITY DOES NOT GUARANTEE THEIR ACCURACY. THEIR EXACT HORIZONTAL AND VERTICAL LOCATIONS ARE TO BE DETERMINED IN THE FIELD BY THE CONTRACTOR AT HIS OWN EXPENSE.

THE CONTRACTOR SHALL BE RESPONSIBLE FOR THE PROTECTION OF ALL UNDERGROUND OR SURFACE UTILITIES EVEN THOUGH THEY MAY NOT BE SHOWN ON THE PLANS. ANY UTILITY THAT IS DAMAGED DURING CONSTRUCTION SHALL BE REPAIRED OR REPLACED TO THE SATISFACTION OF THE ENGINEER OR THE CITY. THIS WORK SHALL BE AT THE CONTRACTOR'S EXPENSE.

COORDINATION OF ALL UTILITY WORK INVOLVED IN THE CONSTRUCTION AREA WILL BE DISCUSSED AT THE PRECONSTRUCTION CONFERENCE.

BEFORE STARTING ANY EXCAVATION, THE CONTRACTOR SHALL CALL "JULIE" AT 811 OR 800-892-0123 FOR FIELD LOCATIONS OF BURIED ELECTRIC, TELEPHONE, GAS AND CABLE TELEVISION FACILITIES. (48 HOURS NOTIFICATION IS REQUIRED.)

STAKING

THE CONTRACTOR SHALL PROTECT AND CAREFULLY PRESERVE ALL SECTION OR SUBSECTION MONUMENTS OR PROPERTY OR REFERENCE MARKERS UNTIL THE CITY, HIS AGENT OR AN AUTHORIZED SURVEYOR HAS WITNESSED OR OTHERWISE REFERENCED THEIR LOCATIONS.

ALL RADII FOR PROPOSED CURB AND GUTTER ARE TO THE EDGE OF PAVEMENT UNLESS OTHERWISE NOTED, AND SHALL BE AS INDICATED ON THE PLANS. ELEVATIONS SHOWN AT POINT OF CURVE, ETC. IS EDGE OF PAVEMENT UNLESS OTHERWISE NOTED.

WATER, STORM SEWER AND SANITARY SEWER

WHENEVER DURING CONSTRUCTION OPERATIONS ANY LOOSE MATERIAL IS DEPOSITED IN THE FLOW LINE OF DRAINAGE STRUCTURES SUCH THAT THE NATURAL FLOW OF WATER IS OBSTRUCTED, IT SHALL BE REMOVED AT THE CLOSE OF EACH WORKING DAY. AT THE CONCLUSION OF CONSTRUCTION OPERATIONS, ALL UTILITY STRUCTURES SHALL BE FREE FROM DIRT AND DEBRIS. THE WORK SPECIFIED ABOVE WILL NOT BE PAID FOR SEPARATELY BUT SHALL BE INCIDENTAL TO THE CONTRACT.

ANY EXISTING OR PROPOSED STORM SEWER DAMAGED BY THE CONTRACTOR DURING CONSTRUCTION SHALL BE REPLACED BY THE CONTRACTOR AT NO COST TO THE OWNER.

THE CONTRACTOR SHALL NOT OPEN OR SHUT ANY WATER VALVES OR FIRE HYDRANTS WITHOUT PRIOR AUTHORIZATION FROM THE CITY WATER DEPARTMENT. UNAUTHORIZED USE SHALL SUBJECT THE OFFENDER TO ARREST AND PROSECUTION.

MISCELLANEOUS

ACCESS: THE CONTRACTOR SHALL PROVIDE ACCESS TO ABUTTING PROPERTY AT ALL TIMES DURING THE CONSTRUCTION OF THIS PROJECT, EXCEPT FOR PERIODS OF SHORT DURATION. THE COST TO PROVIDE ACCESS SHALL BE PAID FOR AND INCLUDED IN THE ITEM AGGREGATE FOR TEMPORARY ACCESS.

DIMENSIONS: IT SHALL BE THE CONTRACTOR'S RESPONSIBILITY TO VERIFY ALL DIMENSIONS AND CONDITIONS EXISTING IN THE FIELD PRIOR TO ORDERING MATERIALS AND BEGINNING CONSTRUCTION.

ALL SAWCUTTING SHALL BE INCIDENTAL TO REMOVAL ITEMS AND SHALL BE PERFORMED PRIOR TO BEGINNING REMOVAL. ANY ITEMS OF WORK REMOVED PRIOR TO SAWCUTTING WILL NOT BE MEASURED FOR PAYMENT.

COMBINATION CONCRETE CURB AND GUTTER REMOVAL AND REPLACEMENT, DRIVEWAY PAVEMENT REMOVAL, PORTLAND CEMENT CONCRETE DRIVEWAY PAVEMENT, 7 INCH, PORTLAND CEMENT CONCRETE SIDEWALK, 5 INCH AND 7 INCH, DETECTABLE WARNINGS, MIXTURE FOR CRACKS, JOINTS AND FLANGWAYS, MEDIAN REMOVAL, CORRUGATED MEDIAN, CONCRETE MEDIAN, TYPE SB-6.12, CLASS B PATCHES 10" (SPECIAL) AND CLASS C AND D PATCHES 6" (SPECIAL) ARE NOT SHOWN ON THE PLANS BUT WILL BE DETERMINED BY THE ENGINEER IN THE FIELD AND WILL NOT EXCEED THE PLAN QUANTITY.

THE THICKNESSES OF HOT-MIX ASPHALT MIXTURES SHOWN IN THE PLANS ARE NOMINAL. DEVIATIONS MAY OCCUR DUE TO IRREGULARITIES IN THE SURFACES OR BASIS ON WHICH THEY ARE TO BE PLACED. PLAN THICKNESSES SHOULD BE CONSIDERED THE MINIMUM THICKNESS PERMITTED.

DETECTABLE WARNINGS MEETING ADA REQUIREMENTS SHALL BE INSTALLED AT ALL INTERSECTING STREETS, SIGNALIZED COMMERCIAL DRIVEWAYS, AND SIGNALIZED ALLEYS AS DIRECTED BY THE ENGINEER (SEE IDOT STD. 424001-05 INCLUDED IN THE SPECIFICATIONS). CONTRACTOR SHALL VERIFY THAT ALL SLOPES MEET ADA REQUIREMENTS PRIOR TO INSTALLING SIDEWALK DETECTABLE WARNINGS AND ADJACENT CURB AND GUTTER.

PAVEMENT GRADES: THE ELEVATIONS INDICATED ON THE PLANS ARE FINISHED GRADES OF PROPOSED PAVEMENT OR SURFACE COURSE, UNLESS OTHERWISE INDICATED.

RELOCATING EXISTING SIGNS: EXISTING SIGNS WHICH ARE IN CONFLICT WITH PROPOSED IMPROVEMENTS SHALL BE REMOVED AND REINSTALLED UPON COMPLETION OF CONFLICTING IMPROVEMENTS IN ACCORDANCE WITH THE ILLINOIS DEPARTMENT OF TRANSPORTATION "MANUAL OF UNIFORM TRAFFIC CONTROL DEVICES" AND THE "STANDARD SPECIFICATIONS FOR ROAD AND BRIDGE CONSTRUCTION". STOP SIGNS, SPEED LIMIT SIGNS, AND STREET NAME SIGNS SHALL BE UP AND VISIBLE AT ALL TIMES. THIS WORK SHALL BE INCLUDED TO THE PAY ITEM TRAFFIC CONTROL AND PROTECTION.

PER ARTICLE 107.20, MAILBOXES WHICH ARE IN CONFLICT WITH PROPOSED IMPROVEMENTS SHALL BE REMOVED, TEMPORARILY RELOCATED, AND REPLACED UPON COMPLETION OF THE PROPOSED IMPROVEMENTS AS DIRECTED BY THE ENGINEER.

PROPOSED CONCRETE CURB AND GUTTER SHALL BE TRANSITIONED TO EXISTING CURB AND GUTTER OVER A LENGTH OF 6 FEET. THIS WORK SHALL BE PAID FOR AT THE CONTRACT UNIT PRICE PER FOOT FOR COMBINATION CONCRETE CURB AND GUTTER REMOVAL AND REPLACEMENT.

ALL UNDERGROUND, DRIVEWAY, CONCRETE, AND LANDSCAPE RESTORATION WORK IS TO BE COMPLETED BEFORE THE SURFACE COURSE IS INSTALLED.

THE HMA SURFACE COURSE USED TO REPLACE DRIVEWAYS WILL BE PAID FOR PER TON. THE NUMBER OF DRIVEWAYS TO BE REPLACED WILL BE DETERMINED IN THE FIELD BY THE ENGINEER.

HIGHWAY STANDARDS

000001-05	STANDARD SYMBOLS, ABBREVIATIONS, AND PATTERNS
424001-05	CURB RAMPS FOR SIDEWALKS
442101-07	CLASS B PATCHES
442201-03	CLASS C AND D PATCHES
602011-01	CATCH BASIN TYPE C
604001-03	FRAME AND LIDS TYPE 1
606001-04	CONCRETE CURB TYPE B AND COMBINATION CONCRETE CURB AND GUTTER
606301-04	PC CONCRETE ISLANDS AND MEDIANS
606306-03	CORRUGATED PC CONCRETE MEDIANS
701301-03	LANE CLOSURE, 2L, 2W, SHORT TIME OPERATIONS
701501-05	URBAN LANE CLOSURE, 2L, 2W UNDIVIDED
701606-06	URBAN LANE CLOSURE, MULTILANE, 2W WITH MOUNTABLE MEDIAN
701701-06	URBAN LANE CLOSURE, MULTILANE INTERSECTION
701801-04	LANE CLOSURE MULTILANE 1W OR 2W CROSSWALK OR SIDEWALK CLOSURE
701901-01	TRAFFIC CONTROL DEVICES
780001-02	TYPICAL PAVEMENT MARKINGS
886001-01	DETECTOR LOOP INSTALLATIONS
BLR 17-4	TRAFFIC CONTROL DEVICES - DAY LABOR CONSTRUCTION
BLR 18-5	TRAFFIC CONTROL DEVICES - DAY LABOR MAINTENANCE

REVISIONS	
NAME	DATE

ILLINOIS DEPARTMENT OF TRANSPORTATION
 GENERAL NOTES AND IDOT STANDARDS
 CITY OF NORTHLAKE
 WOLF ROAD, VILLAGE DRIVE, DICKENS AVENUE
 SCALE N.T.S. DRAWN BY EDT
 DATE 12/5/2008 CHECKED BY MW

CHRISTOPHER B. BURKE ENGINEERING LTD.
 9575 West Higgins Road, Suite 600
 Rosemont, Illinois 60018
 (847) 823-0500
CB
 SURVEYED _____ DATE _____
 PLOTTED _____
 NOTED _____
 CHECKED _____
 RT. OF WAY CHECKED _____
 NO. _____
 ADD. FILE NAME _____

CONTRACT NO. 63103

SUMMARY OF QUANTITIES

LOCATION OF WORK					STP - LAPP					
FUNDING SOURCE					WOLF ROAD		VILLAGE DR.		DICKENS AVE.	
					80% FED.		100% FED. (\$80,000 MAX.)		100% FED. (\$80,000 MAX.)	
					20% LOCAL		REMAINDER LOCAL		REMAINDER LOCAL	
					STP		SECTION 112		SECTION 112	
SUMMARY OF QUANTITIES					CONSTRUCTION TYPE CODE					
ITEM #	ITEM	UNIT	TOTAL QUANTITIES	L23	1000	LY60	1000	LY60	1000	
28000510	INLET FILTERS	EACH	65		44		12		9	
31101100	SUB-BASE GRANULAR MATERIAL, TYPE B	CU YD	70		25		20		25	
35101800	AGGREGATE BASE COURSE, TYPE B 6"	SQ YD	1080		825		80		175	
35501308	HOT-MIX ASPHALT BASE COURSE, 6"	SQ YD	1155		900		80		175	
35800200	AGGREGATE BASE REPAIR	TON	40		0		20		20	
40201000	AGGREGATE FOR TEMPORARY ACCESS	TON	700		500		100		100	
40600100	BITUMINOUS MATERIALS (PRIME COAT)	GAL	2375		1530		455		390	
40600300	AGGREGATE (PRIME COAT)	TON	47		30		9		8	
40600400	MIXTURE FOR CRACKS, JOINTS AND FLANGEWAYS	TON	50		50		0		0	
40600625	LEVELING BINDER (MACHINE METHOD), N50	TON	889		0		479		410	
40600635	LEVELING BINDER (MACHINE METHOD), N70	TON	1610		1610		0		0	
40600982	HOT-MIX ASPHALT SURFACE REMOVAL - BUTT JOINT	SQ YD	405		225		125		55	
40603310	HOT-MIX ASPHALT SURFACE COURSE, MIX "C", N50	TON	860		100		405		355	
40603340	HOT-MIX ASPHALT SURFACE COURSE, MIX "D", N70	TON	1320		1320		0		0	
42300300	PORTLAND CEMENT CONCRETE DRIVEWAY PAVEMENT, 7 INCH	SQ YD	75		75		0		0	
42400200	PORTLAND CEMENT CONCRETE SIDEWALK, 5 INCH	SQ FT	5950		2450		1750		1750	
42400400	PORTLAND CEMENT CONCRETE SIDEWALK, 7 INCH	SQ FT	2350		300		500		1550	
42400800	DETECTABLE WARNINGS	SQ FT	500		330		140		30	
~ 44000162	HOT-MIX ASPHALT SURFACE REMOVAL, 3 1/4"	SQ YD	23720		15300		4545		3875	
44000200	DRIVEWAY PAVEMENT REMOVAL	SQ YD	1155		900		80		175	
44000600	SIDEWALK REMOVAL	SQ FT	8300		2750		2250		3300	
~ 44001700	COMBINATION CONCRETE CURB AND GUTTER REMOVAL AND REPLACEMENT	FOOT	885		665		120		100	
44003100	MEDIAN REMOVAL	SQ FT	1000		1000		0		0	
44300100	AREA REFLECTIVE CRACK CONTROL TREATMENT	SQ YD	23720		15300		4545		3875	
60206905	CATCH BASINS, TYPE C, TYPE 1 FRAME, OPEN LID	EACH	1		0		0		1	
60250400	CATCH BASINS TO BE ADJUSTED WITH NEW TYPE 1 FRAME, OPEN LID	EACH	2		2		0		0	
60251740	CATCH BASINS TO BE ADJUSTED WITH NEW TYPE 24 FRAME AND GRATE	EACH	3		3		0		0	
60252800	CATCH BASINS TO BE RECONSTRUCTED	EACH	3		3		0		0	
60619600	CONCRETE MEDIAN, TYPE SB-6.12	SQ FT	300		300		0		0	
60624600	CORRUGATED MEDIAN	SQ FT	700		700		0		0	
67100100	MOBILIZATION	L. SUM	1		0.6		0.2		0.2	
70102620	TRAFFIC CONTROL AND PROTECTION, STANDARD 701501	L. SUM	1		0.6		0.2		0.2	
70102635	TRAFFIC CONTROL AND PROTECTION, STANDARD 701701	L. SUM	1		0.6		0.2		0.2	
70102640	TRAFFIC CONTROL AND PROTECTION, STANDARD 701801	L. SUM	1		0.6		0.2		0.2	
*78000100	THERMOPLASTIC PAVEMENT MARKING - LETTERS AND SYMBOLS	SQ FT	340		340		0		0	
*78000200	THERMOPLASTIC PAVEMENT MARKING - LINE 4"	FOOT	3800		3800		0		0	
*78000400	THERMOPLASTIC PAVEMENT MARKING - LINE 6"	FOOT	5270		4500		675		95	
*78000600	THERMOPLASTIC PAVEMENT MARKING - LINE 12"	FOOT	335		335		0		0	
*78000650	THERMOPLASTIC PAVEMENT MARKING - LINE 24"	FOOT	450		265		165		20	
~ 88600600	DETECTOR LOOP REPLACEMENT	FOOT	1450		1450		0		0	
~ XX005809	CLASS B PATCHES, 10 INCH	SQ YD	865		865		0		0	
~ XX006392	CLASS D PATCHES, 6" (SPECIAL)	SQ YD	205		0		110		95	
~ XX006940	CLASS C PATCHES, 6" (SPECIAL)	SQ YD	205		0		110		95	
~ *Z0013798	CONSTRUCTION LAYOUT	L. SUM	1		0.6		0.2		0.2	
~ Z0018100	DRAINAGE STRUCTURE ADJUSTMENT (SPECIAL)	EACH	17		9		7		1	
~ Z0018400	DRAINAGE STRUCTURES TO BE ADJUSTED	EACH	57		36		12		9	
~ Z0018700	DRAINAGE STRUCTURES TO BE REMOVED	EACH	1		0		0		1	
Δ Z0076600	TRAINEES	HOUR	500		500		0		0	

~ INDICATES SPECIAL PROVISION
 * INDICATES SPECIALTY ITEM
 Δ Y080

DATE _____ BY _____
 SURVEYED _____ PLOTTED _____
 GRADES CHECKED _____
 B.M. NOTED _____
 STRUCTURE NOTATIONS CHECKED _____
 NOTE BOOK NO. _____
 DATE _____ BY _____
 SURVEYED _____ PLOTTED _____
 GRADES CHECKED _____
 B.M. NOTED _____
 STRUCTURE NOTATIONS CHECKED _____
 NOTE BOOK NO. _____

CHRISTOPHER B. BURKE ENGINEERING LTD.
 9575 West Higgins Road, Suite 600
 Rosemont, Illinois 60018
 (847) 823-0500

REVISIONS		ILLINOIS DEPARTMENT OF TRANSPORTATION
NAME	DATE	
		SUMMARY OF QUANTITIES

CITY OF NORTHLAKE
 WOLF ROAD, VILLAGE DRIVE, DICKENS AVENUE
 SCALE N.T.S. DRAWN BY EDT
 DATE 12/5/2008 CHECKED BY MW

F.A. RTE.	SECTION	COUNTY	TOTAL SHEETS	SHEET NO.
---	08-00067-00-RS	COOK	15	4
STA.	TO STA.		---	
FED. ROAD DIST. NO.	ILLINOIS	FED. AID PROJECT		

CONTRACT NO. 63103

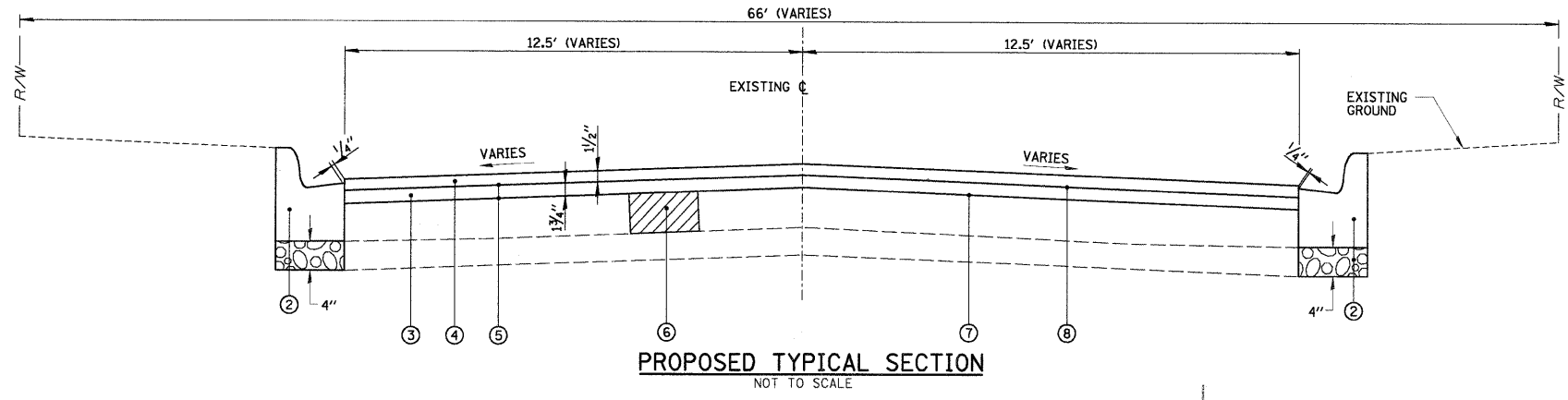
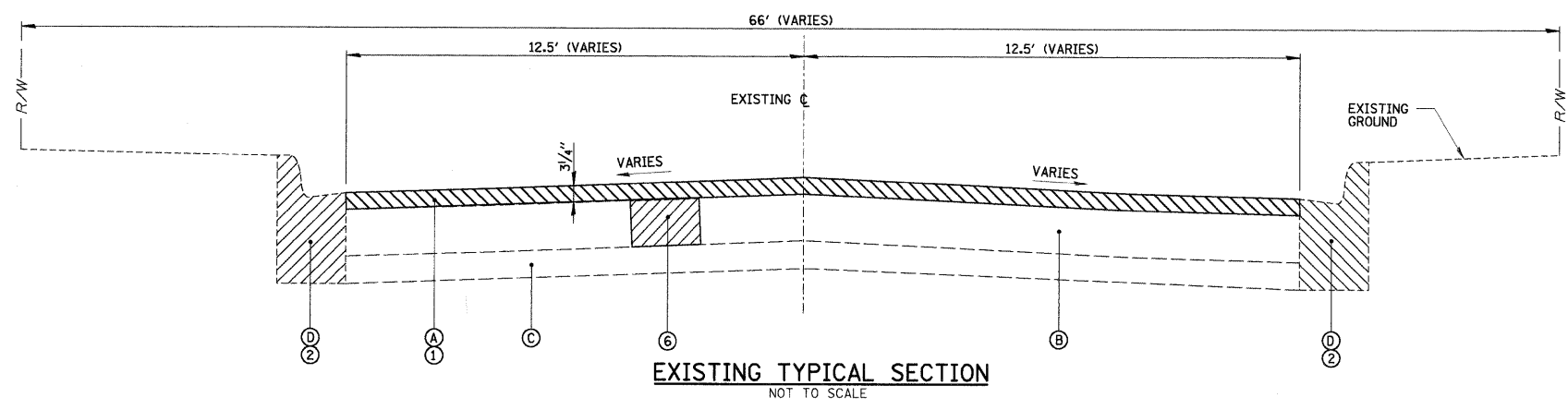

VILLAGE DRIVE
STA. 40+36 TO STA. 52+70

DICKENS AVENUE
STA. 60+43 TO STA. 73+28

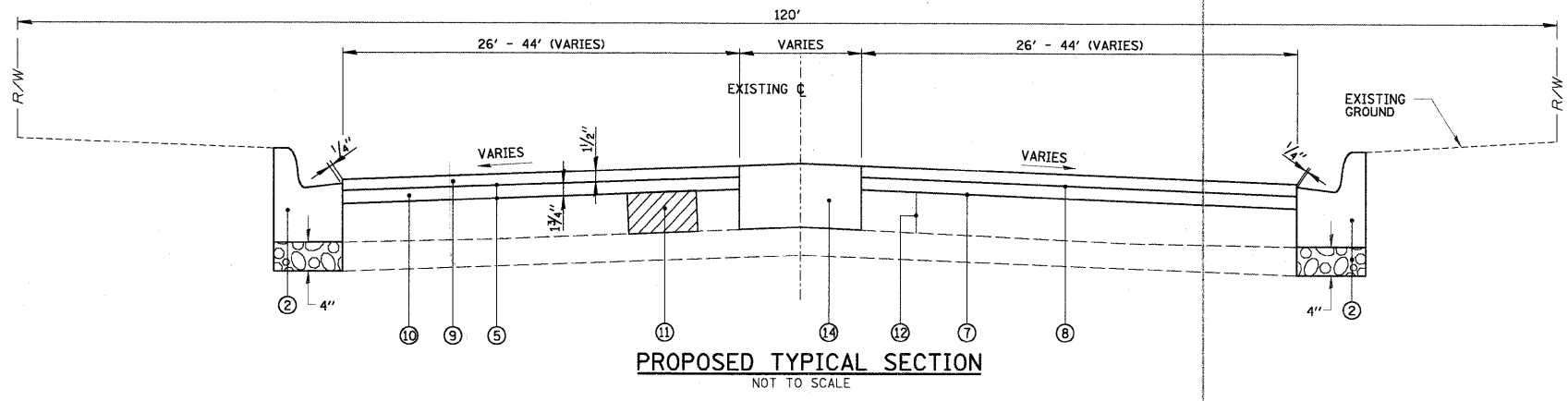
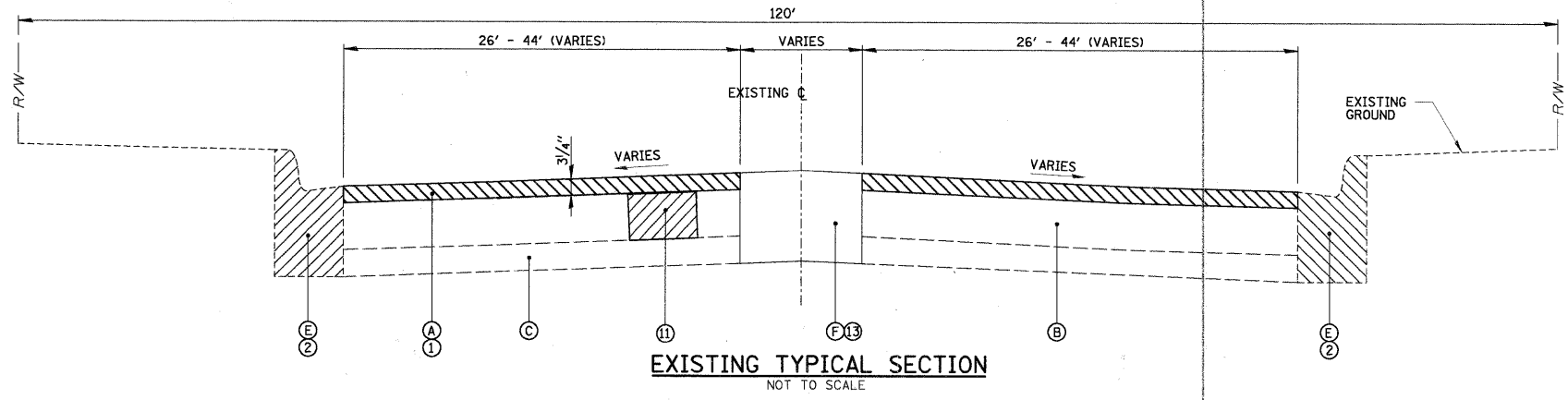

WOLF ROAD
STA. 10+29 TO STA. 29+23

LEGEND

- (A) EXISTING ASPHALT PAVEMENT (+/- 2.4" TO 7.9")
- (B) EXISTING P.C.C. BASE (+/- 4" TO 7")
- (C) EXISTING AGGREGATE BASE (+/- 0" TO 7")
- (D) EXISTING COMBINATION CURB AND GUTTER, TYPE M-4.12
- (E) EXISTING COMBINATION CURB AND GUTTER, TYPE B-6.24 OR B-6.12
- (F) EXISTING CORRUGATED/BARRIER CONCRETE MEDIAN
- (1) HOT-MIX ASPHALT SURFACE REMOVAL, 3 1/4"
- (2) COMBINATION CONCRETE CURB AND GUTTER REMOVAL AND REPLACEMENT (AS DIRECTED BY ENGINEER) (SEE DETAIL SHEET 12) OF TYPE SPECIFIED.
- (3) LEVELING BINDER (MACHINE METHOD), N50 - 1 3/4" MIN.
- (4) HOT-MIX ASPHALT SURFACE COURSE, MIX "C", N50 - 1 1/2"
- (5) BITUMINOUS MATERIALS (PRIME COAT)
- (6) CLASS C OR D PATCHES, 6" (SPECIAL)
- (7) AGGREGATE (PRIME COAT)
- (8) AREA REFLECTIVE CRACK CONTROL TREATMENT
- (9) HOT-MIX ASPHALT SURFACE COURSE, MIX "D", N70 - 1 1/2"
- (10) LEVELING BINDER (MACHINE METHOD), N70 - 1 3/4" MIN.
- (11) CLASS B PATCHES 10"
- (12) MIXTURE FOR CRACKS, JOINTS AND FLANGEWAYS
- (13) MEDIAN REMOVAL (AS DIRECTED BY ENGINEER)
- (14) CORRUGATED MEDIAN OR CONCRETE MEDIAN, TYPE SB-6.12 (AS DIRECTED BY ENGINEER)

HOT-MIX ASPHALT MIXTURE REQUIREMENTS

ITEM	AC-TYPE	VOIDS
ROADWAYS		
HOT-MIX ASPHALT SURFACE COURSE, MIX "C", N50 (IL-9.5 MM)	PG 64-22	4% @ 50 GYR
HOT-MIX ASPHALT SURFACE COURSE, MIX "D", N70 (IL-9.5 MM)	PG 64-22	4% @ 70 GYR
LEVELING BINDER (MACHINE METHOD), N50 (IL-9.5 MM)	PG 64-22*	4% @ 50 GYR
LEVELING BINDER (MACHINE METHOD), N70 (IL-9.5 MM)	PG 64-22*	4% @ 70 GYR
CLASS D PATCHES, (HMA BINDER IL-19 MM) 6" (SPECIAL)	PG 64-22*	4% @ 70 GYR
DRIVEWAYS		
HOT-MIX ASPHALT SURFACE COURSE, MIX "C", N50 (IL-9.5 MM) - 2"	PG 64-22	4% @ 50 GYR
HOT-MIX ASPHALT BASE COURSE, 6"	PG 64-22*	4% @ 50 GYR

NOTE:

1. THE UNIT WEIGHT USED TO CALCULATE ALL HOT-MIX ASPHALT SURFACE MIXTURE QUANTITIES IS 112 LBS/SY/IN.
2. WHEN RAP EXCEEDS 20%, THE NEW ASPHALT BINDER IN THE MIX SHALL BE PG 58-22.

REVISIONS	
NAME	DATE

ILLINOIS DEPARTMENT OF TRANSPORTATION

TYPICAL SECTIONS

CITY OF NORTHLAKE

WOLF ROAD, VILLAGE DRIVE, DICKENS AVENUE

SCALE N.T.S. DRAWN BY EDT

DATE 12/5/2008 CHECKED BY MW

SURVEYED BY: DATE: _____
 PLOTTED BY: DATE: _____
 CHECKED BY: DATE: _____
 NOTE BOOK NO. _____
 STRUCTURE NOTATION: CPDRO

SURVEYED BY: DATE: _____
 PLOTTED BY: DATE: _____
 CHECKED BY: DATE: _____
 NOTE BOOK NO. _____
 STRUCTURE NOTATION: CPDRO

CHRISTOPHER B. BURKE ENGINEERING LTD.
 9575 West Higgins Road, Suite 600
 Rosemont, Illinois 60018
 (847) 823-0500

DATE: _____ BY: _____
 SURVEYED: _____ CHECKED: _____
 PLOTTED: _____
 PLAN: _____
 NOTE BOOK: _____
 NO. _____

CHRISTOPHER B. BURKE ENGINEERING LTD.
 9575 West Higgins Road, Suite 600
 Rosemont, Illinois 60018
 (847) 823-0500



DATE: _____ BY: _____
 SURVEYED: _____ CHECKED: _____
 PLOTTED: _____
 PROFILE: _____
 NOTE BOOK: _____
 NO. _____

F.A. RTE.	SECTION	COUNTY	TOTAL SHEETS	SHEET NO.
---	08-00067-00-RS	COOK	15	5
STA.	10+29.00	TO STA.	19+80.00	
FED. ROAD DIST. NO.	ILLINOIS	FED. AID PROJECT		

CONTRACT NO. 63103

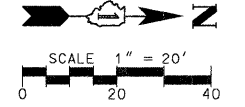
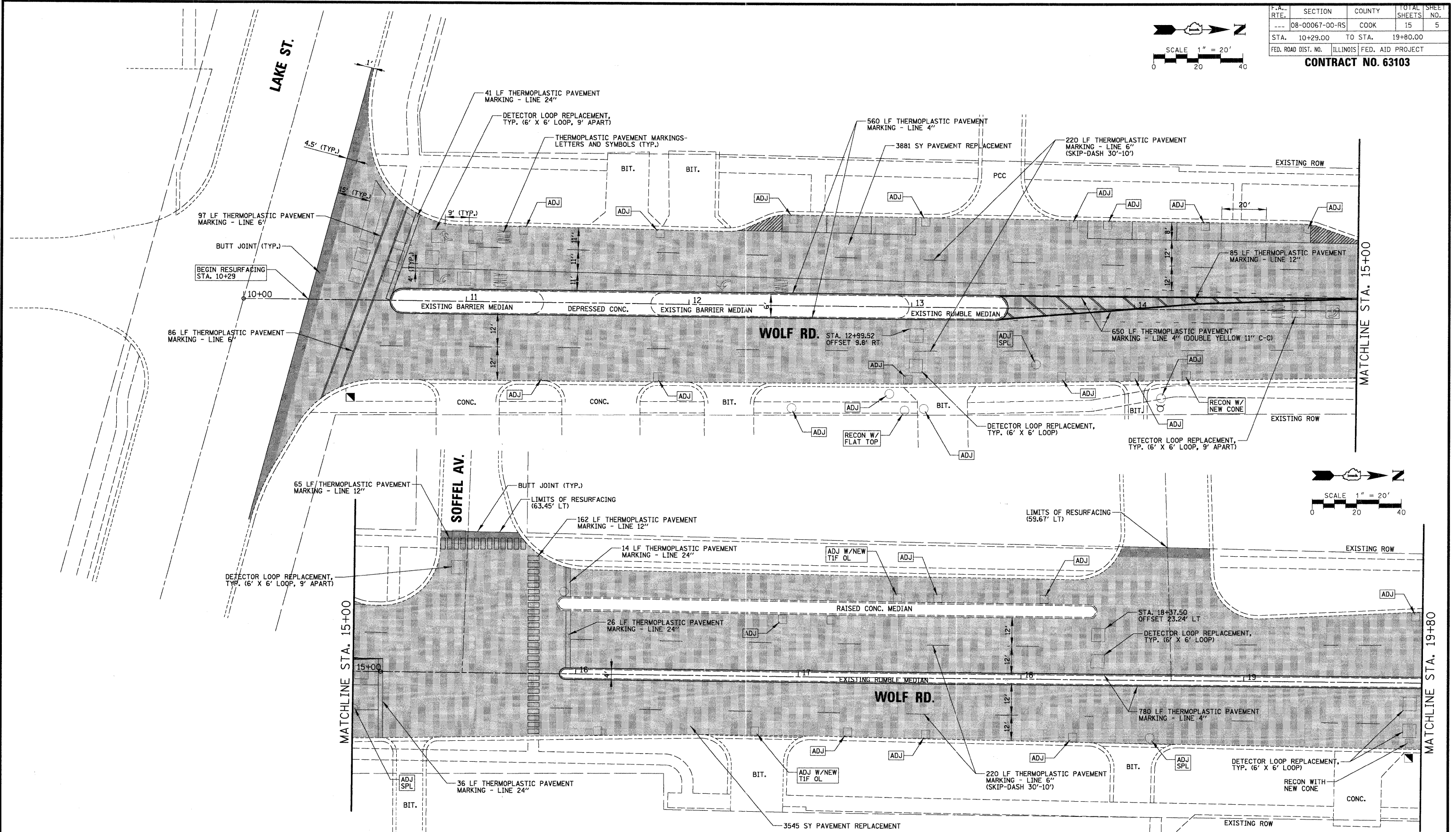
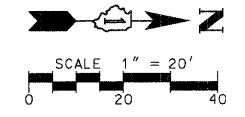

REVISIONS	
NAME	DATE

ILLINOIS DEPARTMENT OF TRANSPORTATION
 PROPOSED PLAN
 CITY OF NORTHLAKE
 WOLF ROAD
 SCALE 1" = 20'
 DATE 12/5/2008
 DRAWN BY EDT
 CHECKED BY MW

DATE: _____ BY: _____
 SURVEYED: _____
 PLOTTED: _____
 CHECKED: _____
 NO. OF WAY CHECKED: _____
 PLAN: _____
 NOTE BOOK NO.: _____
 CAD FILE NAME: \\NORTHLAKE\940032hr\193\Civil\hr193_wolf2.dwg

CHRISTOPHER B. BURKE ENGINEERING LTD.
 9575 West Higgins Road, Suite 600
 Rosemont, Illinois 60018
 (847) 823-0500

DATE: _____ BY: _____
 SURVEYED: _____
 PLOTTED: _____
 CHECKED: _____
 NO. OF WAY CHECKED: _____
 PROFILE: _____
 NOTE BOOK NO.: _____
 STRUCTURE NOTATIONS CHKD: _____

F.A. RTE.	SECTION	COUNTY	TOTAL SHEETS	SHEET NO.
---	08-00067-00-RS	COOK	15	6
STA.	19+80.00	TO STA.	29+23.00	
FED. ROAD DIST. NO.	ILLINOIS	FED. AID PROJECT		

CONTRACT NO. 63103

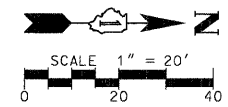
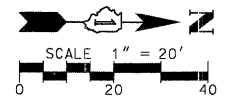
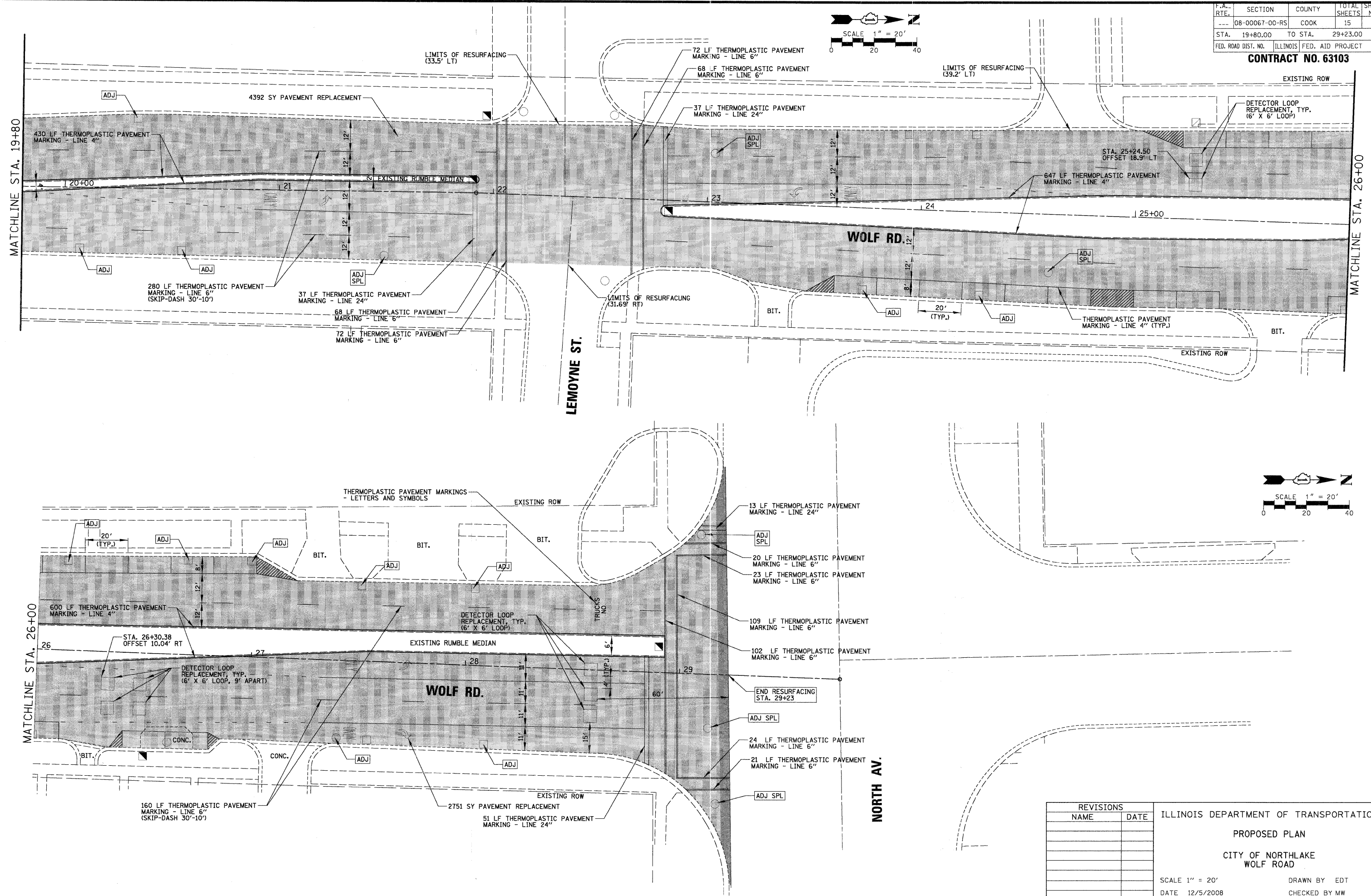

REVISIONS	
NAME	DATE

ILLINOIS DEPARTMENT OF TRANSPORTATION
 PROPOSED PLAN
 CITY OF NORTHLAKE
 WOLF ROAD
 SCALE 1" = 20'
 DATE 12/5/2008
 DRAWN BY EDT
 CHECKED BY MW

F.A. RTE.	SECTION	COUNTY	TOTAL SHEETS	SHEET NO.
---	08-00067-00-RS	COOK	15	7
STA. 40+36.00		TO STA. 44+00.00		
FED. ROAD DIST. NO.	ILLINOIS	FED. AID PROJECT		

CONTRACT NO. 63103

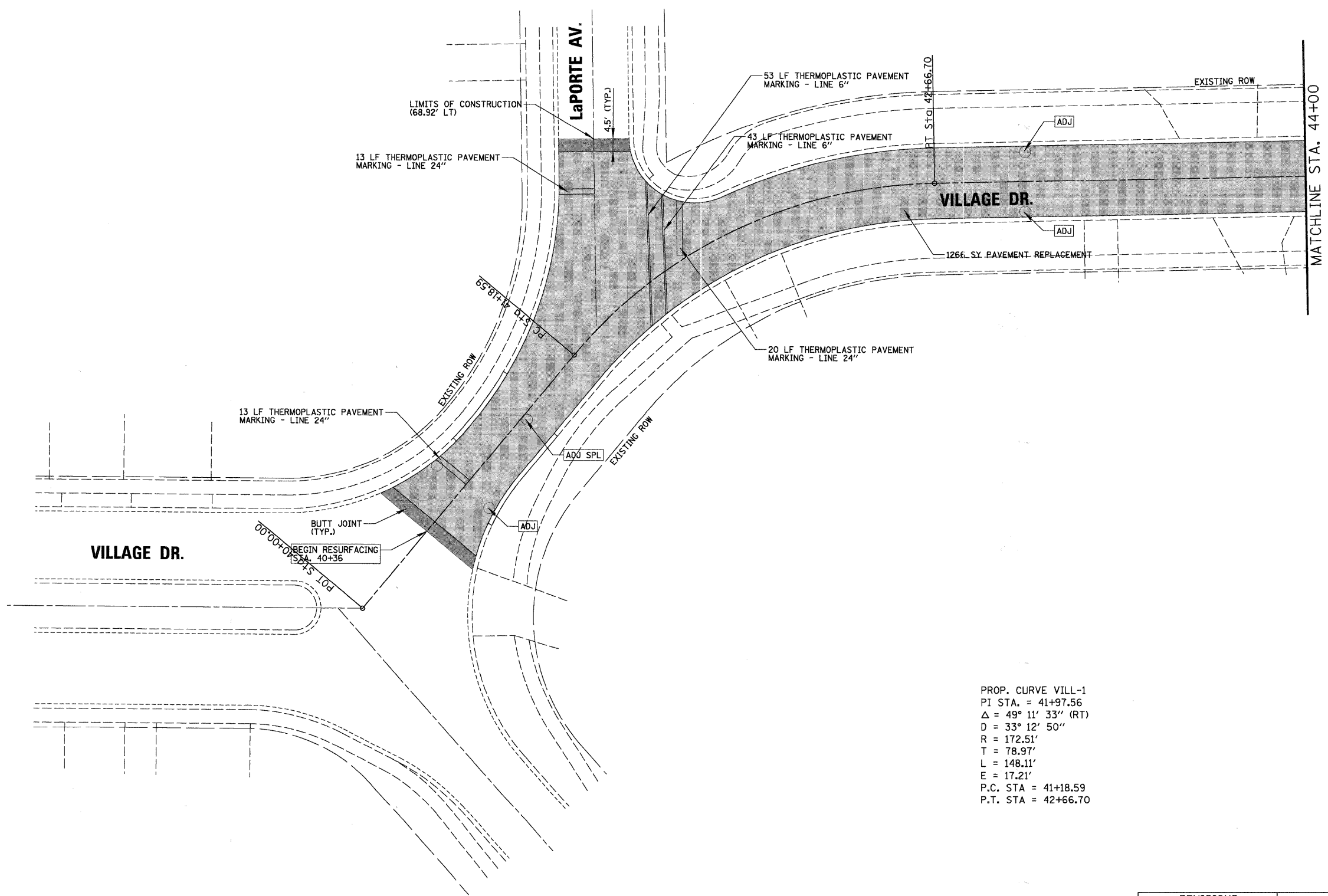
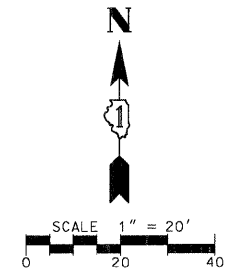

PROP. CURVE VILL-1
 PI STA. = 41+97.56
 $\Delta = 49^\circ 11' 33''$ (RT)
 $D = 33^\circ 12' 50''$
 $R = 172.51'$
 $T = 78.97'$
 $L = 148.11'$
 $E = 17.21'$
 P.C. STA = 41+18.59
 P.T. STA = 42+66.70

PLAN	DATE
BY	
CHECKED	
DATE	
NO.	

CHRISTOPHER B. BURKE ENGINEERING LTD.
 9575 West Higgins Road, Suite 600
 Rosemont, Illinois 60018
 (847) 823-0500

PROFILE	DATE
BY	
CHECKED	
DATE	
NO.	

REVISIONS		ILLINOIS DEPARTMENT OF TRANSPORTATION
NAME	DATE	
		PROPOSED PLAN
		CITY OF NORTHLAKE VILLAGE DRIVE
		SCALE 1" = 20'
		DATE 12/5/2008
		DRAWN BY EDT
		CHECKED BY MW

F.A.L. RTE.	SECTION	COUNTY	TOTAL SHEETS	SHEET NO.
---	08-00067-00-RS	COOK	15	8
STA.	44+00.00	TO STA.	52+70.00	
FED. ROAD DIST. NO.	ILLINOIS	FED. AID PROJECT		

CONTRACT NO. 63103

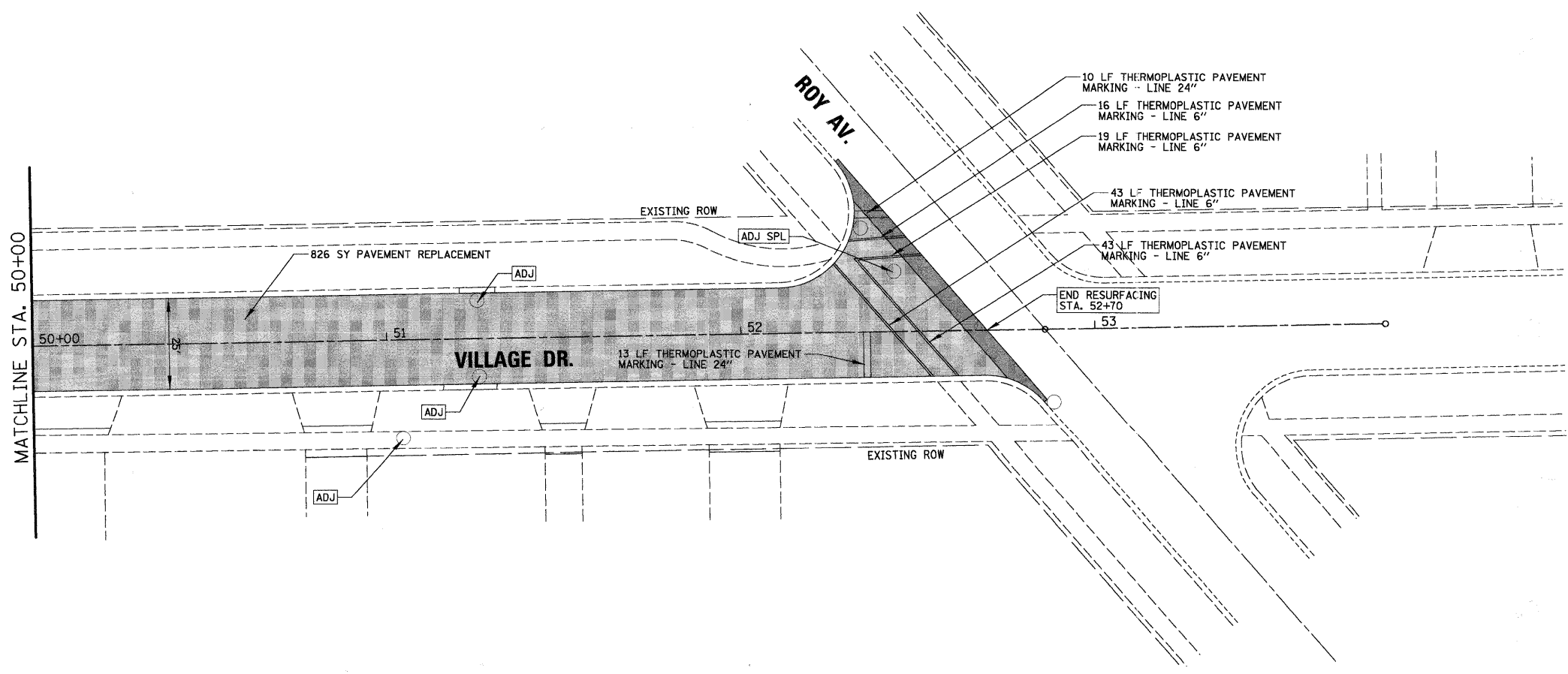
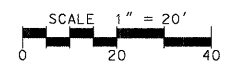
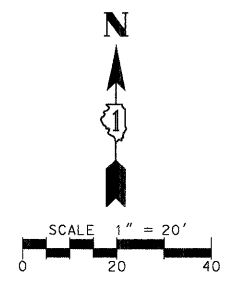
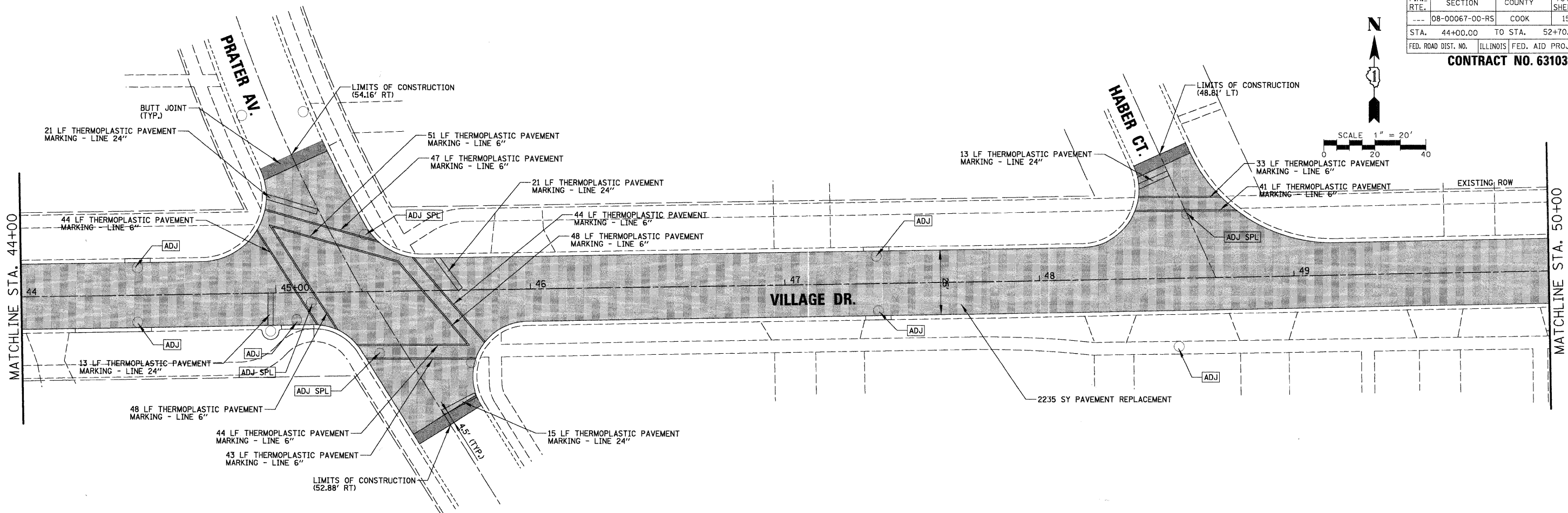
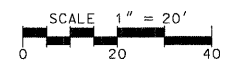

REVISIONS	
NAME	DATE

ILLINOIS DEPARTMENT OF TRANSPORTATION
 PROPOSED PLAN
 CITY OF NORTHLAKE
 VILLAGE DRIVE
 SCALE 1" = 20'
 DATE 12/5/2008
 DRAWN BY EDT
 CHECKED BY MW

DATE	
BY	
SURVEYED	
PLOTTED	
CHECKED	
DATE	
BY	
NOTE BOOK	
NO.	

CHRISTOPHER B. BURKE ENGINEERING LTD. PLAN
 9575 West Higgins Road, Suite 600
 Rosemont, Illinois 60018
 (847) 823-0500

DATE	
BY	
SURVEYED	
GRADES CHECKED	
DATE	
BY	
NOTE BOOK	
NO.	

PROFILE
 SURVEYED
 GRADES CHECKED
 DATE
 BY
 NOTE BOOK
 NO.

DATE: _____
 BY: _____
 SURVEYED: _____
 PLOTTED: _____
 CHECKED: _____
 RL OF MAY CHECKED: _____
 NOTE BOOK NO.: _____
 CADD FILE NAME: N:\NORTHLAKE\940032\12/5/08\193.dwg

CHRISTOPHER B. BURKE ENGINEERING LTD.
 9575 West Higgins Road, Suite 600
 Rosemont, Illinois 60018
 (847) 823-0500

PROFILE: _____
 SURVEYED: _____
 GRADES CHECKED: _____
 G.M. NOTED: _____
 STRUCTURE NOTATIONS: CHRD

F.A. RTE.	SECTION	COUNTY	TOTAL SHEETS	SHEET NO.
08-00067-00-RS		COOK	15	9
STA. 60+43.00	TO STA. 71+00.00			
FED. ROAD DIST. NO.	ILLINOIS	FED. AID PROJECT		

CONTRACT NO. 63103

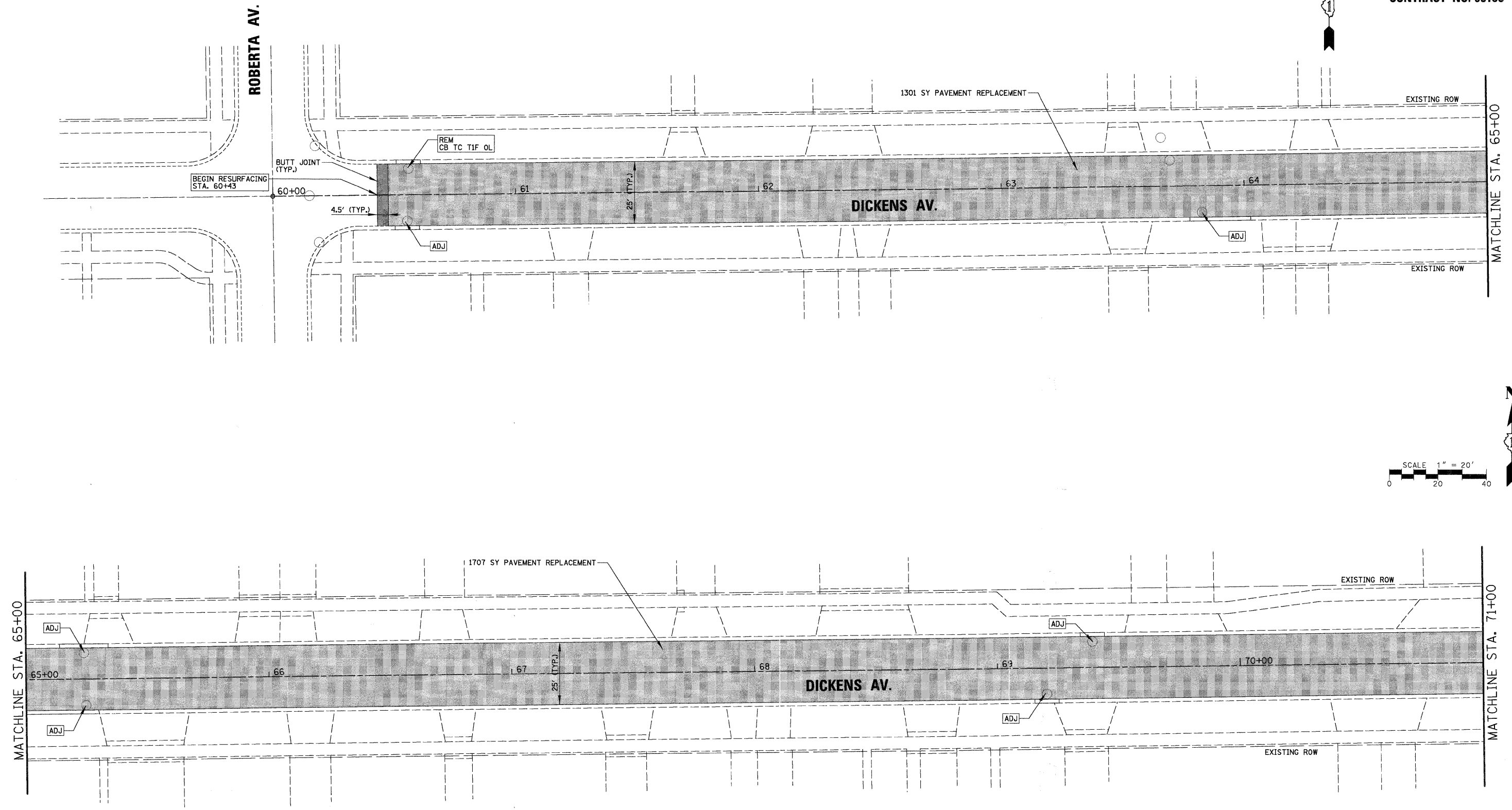
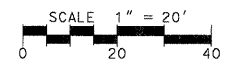
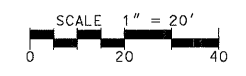

REVISIONS	
NAME	DATE

ILLINOIS DEPARTMENT OF TRANSPORTATION
 PROPOSED PLAN
 CITY OF NORTHLAKE
 DICKENS AVENUE
 SCALE 1" = 20'
 DATE 12/5/2008
 DRAWN BY EDT
 CHECKED BY MW

F.A. RTE.	SECTION	COUNTY	TOTAL SHEETS	SHEET NO.
08-00067-00-RS	COOK	15	10	
STA. 71+00.00		TO STA. 73+28.00		
FED. ROAD DIST. NO.	ILLINOIS	FED. AID PROJECT		

CONTRACT NO. 63103

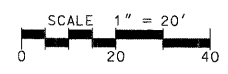

PROP. CURVE DICK-1
 PI STA. = 72+26.79
 $\Delta = 23^\circ 28' 21''$ (LT)
 $D = 13^\circ 11' 24''$
 $R = 434.39'$
 $T = 90.24'$
 $L = 177.96'$
 $E = 9.28'$
 P.C. STA = 71+36.55
 P.T. STA = 73+14.51

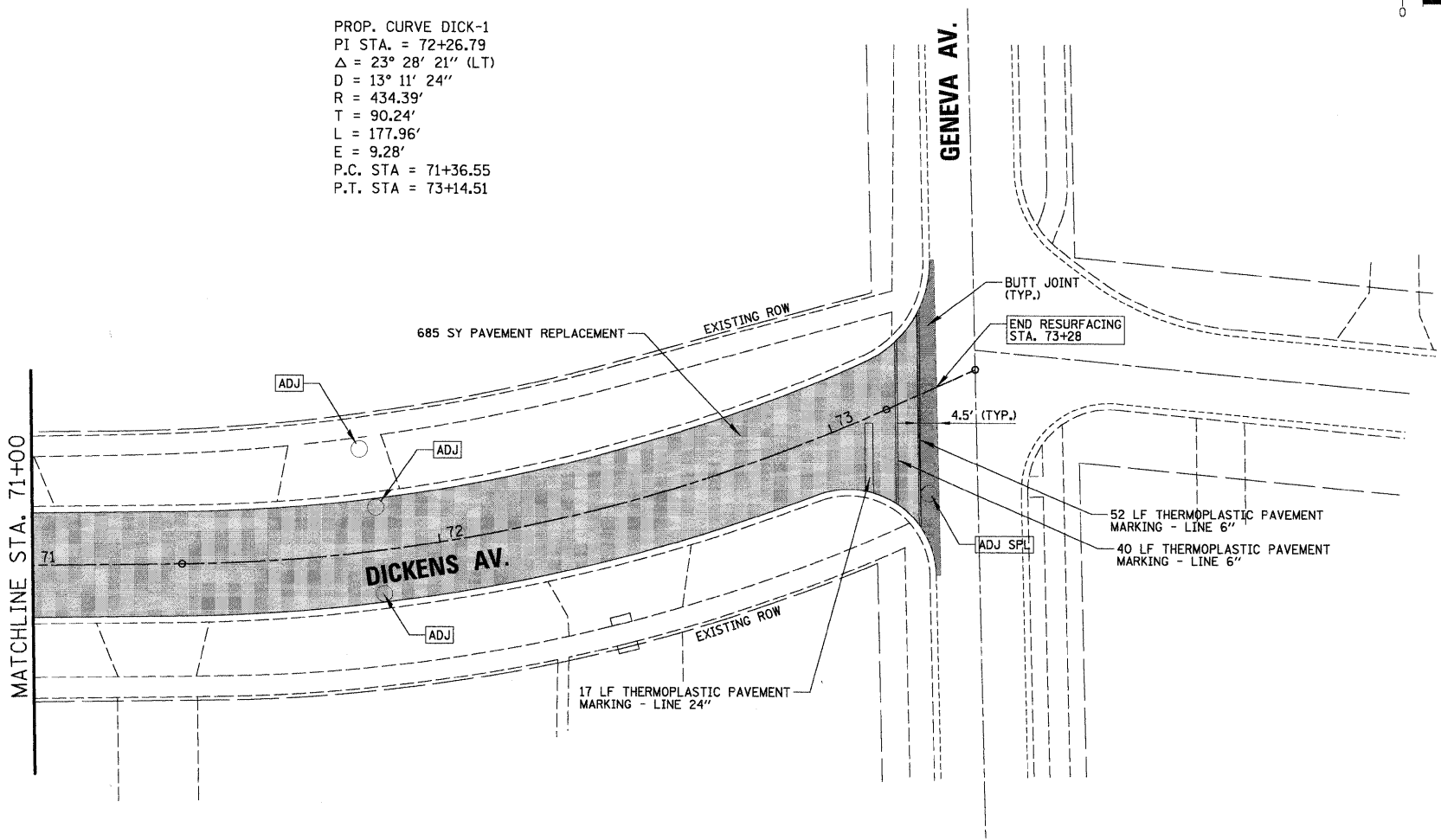

DATE	BY
SURVEYED	CHECKED
PLANNED	CHECKED
NOTE BOOK NO.	CAD FILE NAME

CHRISTOPHER B. BURKE ENGINEERING LTD.
 9575 West Higgins Road, Suite 600
 Rosemont, Illinois 60018
 (847) 823-0500

DATE	BY
SURVEYED	CHECKED
PLANNED	CHECKED
NOTE BOOK NO.	CAD FILE NAME

REVISIONS		ILLINOIS DEPARTMENT OF TRANSPORTATION
NAME	DATE	
		PROPOSED PLAN CITY OF NORTHLAKE DICKENS AVENUE SCALE 1" = 20' DATE 12/5/2008 DRAWN BY EDT CHECKED BY MW

CHRISTOPHER B. BURKE ENGINEERING LTD.
 9575 West Higgins Road, Suite 600
 Rosemont, Illinois 60018
 (847) 823-0500

CBB

DATE	BY	DATE	BY

SUBMITTED BY: _____
 CHECKED BY: _____
 PLANNED BY: _____
 DATE OF WAY CHECK: _____
 DATE OF CHECK: _____
 NO. OF WAY CHECKS: _____
 NO. OF CHECKS: _____
 NO. OF NOTES: _____
 NO. OF REVISIONS: _____
 NO. OF SHEETS: _____

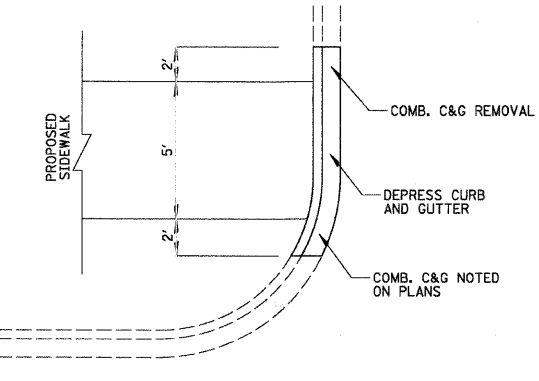
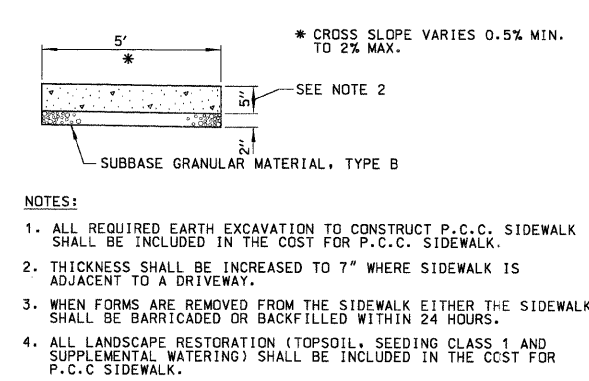

NOTES:

- ALL REQUIRED EARTH EXCAVATION TO CONSTRUCT P.C.C. SIDEWALK SHALL BE INCLUDED IN THE COST FOR P.C.C. SIDEWALK.
- THICKNESS SHALL BE INCREASED TO 7" WHERE SIDEWALK IS ADJACENT TO A DRIVEWAY.
- WHEN FORMS ARE REMOVED FROM THE SIDEWALK EITHER THE SIDEWALK SHALL BE BARRICADED OR BACKFILLED WITHIN 24 HOURS.
- ALL LANDSCAPE RESTORATION (TOPSOIL, SEEDING CLASS 1 AND SUPPLEMENTAL WATERING) SHALL BE INCLUDED IN THE COST FOR P.C.C. SIDEWALK.

P.C.C. SIDEWALK DETAIL

PROPOSED DEPRESSED CURB & GUTTER EXISTING CURB & GUTTER NOT DEPRESSED
 NOT TO SCALE

F.A. RTE.	SECTION	COUNTY	TOTAL SHEETS	SHEET NO.
---	08-00067-00-RS	COOK	15	11
STA. ---	TO STA. ---		---	
FED. ROAD DIST. NO. ILLINOIS			FED. AID PROJECT	

CONTRACT NO. 63103

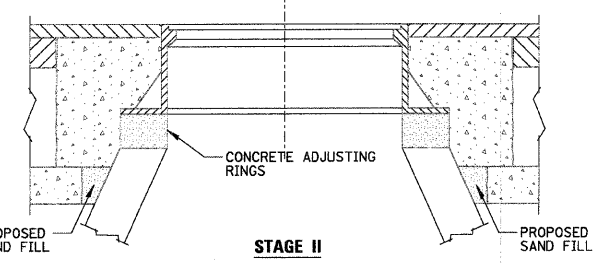
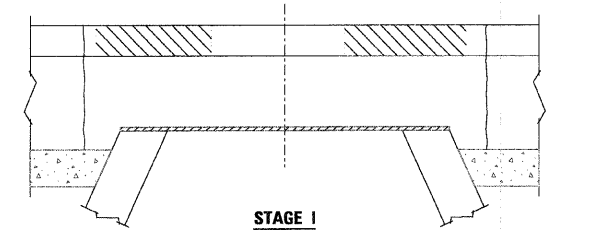

CONSTRUCTION PROCEDURES

- STAGE I (BEFORE PAVEMENT MILLING)**
- REMOVE A MINIMUM OF 12" OF THE PAVEMENT FROM AROUND THE STRUCTURE.
 - REMOVE THE EXISTING FRAME AND LID FROM THE STRUCTURE.
 - COVER THE STRUCTURE OPENING WITH A 36" DIAMETER METAL PLATE.
 - BACKFILL WITH CRUSHED STONE AND A MINIMUM 1 1/2" THICK BITUMINOUS MATERIAL APPROVED BY THE ENGINEER.
- STAGE II (AFTER PAVEMENT MILLING)**
- REMOVE THE HOT-MIX ASPHALT MATERIAL AND CRUSHED STONE.
 - INSTALL THE FRAME AND LID; ADJUST THE FRAME TO ITS FINAL SURFACE ELEVATION.
 - THE SURROUNDING SPACE SHALL BE FILLED WITH CLASS SI CONCRETE TO THE ELEVATION OF THE SURFACE OF THE EXISTING BASE COURSE.

THE PROCEDURE EXPLAINED ABOVE SHALL CONFORM TO THE APPLICABLE PORTIONS OF SECTIONS 353, 406, 602 AND 603 OF THE STANDARD SPECIFICATIONS.

LOCATION OF STRUCTURES

THE CONTRACTOR WILL BE REQUIRED TO KEEP A RECORD OF THE LOCATIONS OF THE BURIED STRUCTURES ACCORDING TO THE STATION AND DISTANCE LEFT OR RIGHT OF THE CENTERLINE OF PAVEMENT. UPON COMPLETION OF THE WORK, THE CONTRACTOR WILL DELIVER THE RECORD TO THE ENGINEER.

BASIS OF PAYMENT

DRAINAGE STRUCTURE ADJUSTMENT (SPECIAL).

NOTES

- EXISTING BROKEN FRAMES AND LIDS SHALL BE REMOVED AND DISPOSED OF BY THE CONTRACTOR AND SHALL BE REPLACED AS DIRECTED BY THE ENGINEER. REPLACEMENT FRAMES AND LIDS WILL BE PAID FOR IN ACCORDANCE WITH ARTICLE 109.04 OF THE STANDARD SPECIFICATIONS UNLESS A SEPARATE PAY ITEM HAS BEEN PROVIDED.
- IF THE EXISTING LIDS ARE OPEN, THE FRAME WILL BE ADJUSTED TO THE ELEVATION OF THE MILLED PAVEMENT SURFACE PRIOR TO THE MILLING OPERATION. THE FRAME WILL NOT BE REMOVED AND COVERED BY THE METAL PLATE.
- THE METAL PLATE USED TO COVER THE STRUCTURE SHALL REMAIN THE PROPERTY OF THE CONTRACTOR.

DRAINAGE STRUCTURE ADJUSTMENT (SPECIAL)

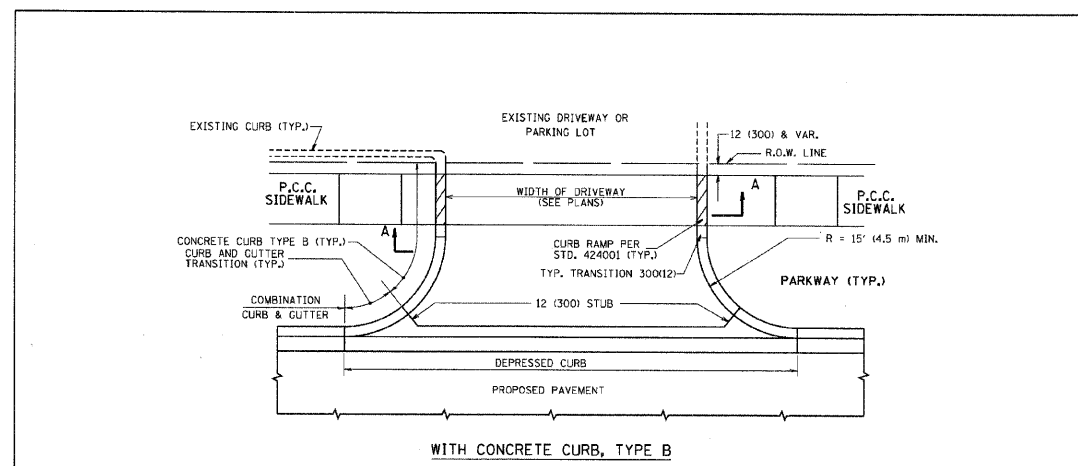

WITH CONCRETE CURB, TYPE B

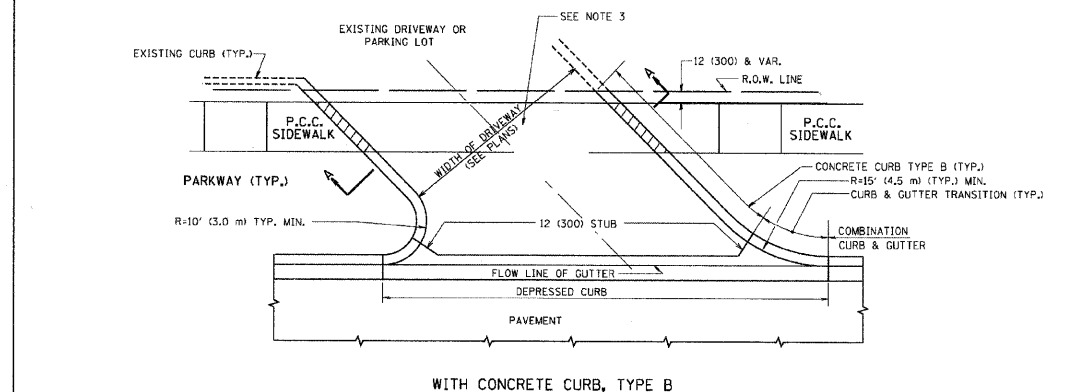

WITH CONCRETE CURB, TYPE B

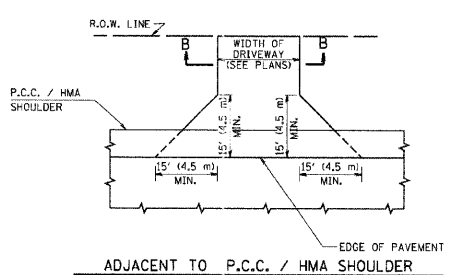

ADJACENT TO P.C.C. / HMA SHOULDER

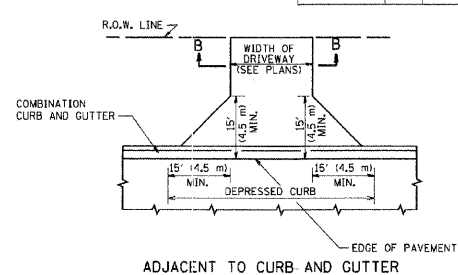

ADJACENT TO CURB AND GUTTER

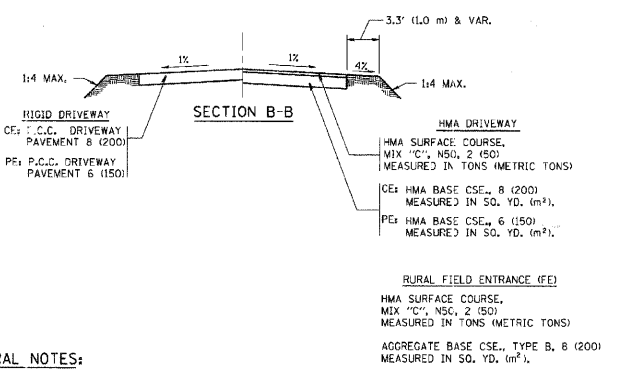

GENERAL NOTES:

DRIVEWAY SLOPES, LOCATIONS, & GEOMETRIC LAYOUT SHALL BE IN ACCORDANCE WITH THE LATEST EDITION OF THE "HANDBOOK FOR POLICY ON PERMITS FOR ACCESS DRIVEWAYS TO STATE HIGHWAYS". FOR FURTHER LAYOUT REQUIREMENTS, REFER TO ILLUSTRATIONS IN THE PERMIT HANDBOOK. DRIVEWAYS SHALL BE REPLACED IN KIND, UNLESS OTHERWISE NOTED ON THE PLANS.

COMMERCIAL DRIVEWAYS SHALL BE CONSTRUCTED WITH CONCRETE CURB, TYPE B RETURNS EXCEPT WHEN THE SIDEWALK EDGE IS 4 FEET (1.2 METERS) OR LESS FROM THE BACK OF CURB, CONSTRUCT A FLARE DRIVEWAY WITHOUT CURB.

THE RESIDENT ENGINEER SHALL CONTACT THE TRAFFIC PERMIT OFFICE AT 847/ 705-4131 FOR ANY QUESTIONS ON DRIVEWAYS SHOWN IN THE PLANS; SPECIFICALLY IN REFERENCE TO ADDITIONAL AND/OR RELOCATION/REMOVAL OF A DRIVEWAY.

COMBINATION CONCRETE CURB & GUTTER SHALL BE MEASURED STRAIGHT ACROSS THE DRIVEWAY. NO ADDITIONAL COMPENSATION WILL BE ALLOWED FOR THE CURB & GUTTER TRANSITION.

1 (25) PREFORMED EXPANSION JOINT FILLER WILL NOT BE PAID SEPARATELY, BUT SHALL BE CONSIDERED INCLUDED IN THE COST OF THE P.C.C. DRIVEWAY PAVEMENT OR P.C.C. SIDEWALK.

WHEN THE P.C.C. SIDEWALK EXTENDS THROUGH THE DRIVEWAY, THE THICKNESS OF THE SIDEWALK IN THE DRIVEWAY AREA SHALL BE THE SAME AS THE DRIVEWAY THICKNESS. SIDEWALK WILL BE PAID FOR AS P.C.C. SIDEWALK OF THE THICKNESS SPECIFIED. SIDEWALK CROSS SLOPE THRU DRIVEWAY AREA TO BE A MAXIMUM OF 150.

ILLINOIS DEPARTMENT OF TRANSPORTATION
DRIVEWAY DETAILS
 DISTANCE BETWEEN R.O.W. AND FACE OF CURB & EDGE OF SHOULDER ≥ 15' (4.5 m)

REVISIONS	NAME	DATE
1	R. SMITH	01-24-95
2	J. POLLASTRINI	08-12-96
3	J. POLLASTRINI	12-14-98
4	A. ABRAS	03-21-97
5	T. HOLIF	04-08-97
6	M. GOMEZ	04-08-01
7	P. LEFLEUR	04-13-03
8	R. BORO	01-01-07
9	R. BORO	06-11-08

SCALE: VERT. NONE
 HORIZ.

DRAWN BY: _____
 CHECKED BY: _____
 800156-07 (80-01)

REVISIONS	NAME	DATE

ILLINOIS DEPARTMENT OF TRANSPORTATION
 CONSTRUCTION DETAILS
 CITY OF NORTHLAKE
 WOLF ROAD, VILLAGE DRIVE, DICKENS AVENUE

SCALE N.T.S.
 DATE 11/14/2008

DRAWN BY: EDT
 CHECKED BY: MW

PLOT DATE: 6/25/2008
 PLOT SCALE: 1/4"=1'-0"
 USER: JMB

F.A. RTE.	SECTION	COUNTY	TOTAL SHEETS	SHEET NO.
---	08-00067-00-RS	COOK	15	12
STA.	---	TO STA.	---	---
FED. ROAD DIST. NO.	ILLINOIS	FED. AID PROJECT		

CONTRACT NO. 63103

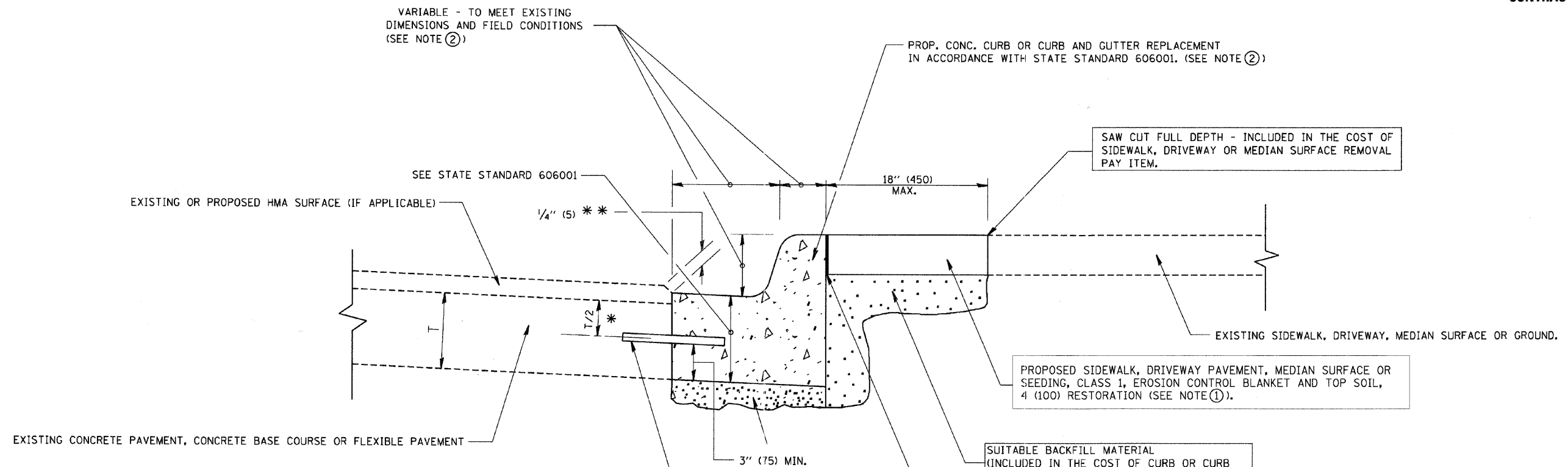

- * 3" (75) MINIMUM FROM TOP AND BOTTOM OF THE CONCRETE PAVEMENT OR BASE COURSE.
- ** IF THE FINAL SURFACE OF THE PAVEMENT IS CONCRETE, THE GUTTER IS TO BE FLUSH WITH THE PAVEMENT.

- NOTE: ① SIDEWALK, DRIVEWAY PAVEMENT OR MEDIAN SURFACE SHALL BE SIMILAR TO THE MATERIAL BEING REMOVED AND WILL BE PAID FOR SEPARATELY.
SEEDING, CLASS 1, EROSION CONTROL BLANKET AND TOP SOIL, 4 (100) RESTORATION WILL NOT BE PAID FOR SEPARATELY, BUT SHALL BE INCLUDED IN THE COST OF CURB OR CURB AND GUTTER REMOVAL AND REPLACEMENT.
- ② CURB OR CURB AND GUTTER REPLACEMENT SHALL MATCH THE SHAPE OF THE EXISTING CURB OR CURB AND GUTTER UNLESS OTHERWISE SPECIFIED.
- ③ FOR CURB OR CURB AND GUTTER REMOVAL AND REPLACEMENT ADJACENT TO FLEXIBLE PAVEMENT DELETE EPOXY COATED TIE BARS.
- ④ LONGITUDINAL BARS, IF ENCOUNTERED IN THE EXISTING CURB OR CURB AND GUTTER, ARE NOT TO BE REPLACED. CUTTING AND REMOVING LONGITUDINAL BARS SHALL BE INCLUDED IN THE COST OF CURB OR CURB AND GUTTER REMOVAL AND REPLACEMENT.
- ⑤ THE COST OF HMA SURFACE REMOVAL IN THE EXISTING GUTTER FLAG SHALL BE INCLUDED IN THE COST OF THE CURB AND GUTTER REMOVAL AND REPLACEMENT.
- ⑥ THE REMOVAL AND REPLACEMENT OF THE EXISTING CURB OR CURB AND GUTTER SHALL BE DONE IN ACCORDANCE WITH THE APPLICABLE PORTIONS OF SECTION 440 AND 606 OF THE STANDARD SPECIFICATIONS.
- ⑦ THE LOCATIONS OF REMOVAL AND REPLACEMENT OF EXISTING CURB OR CURB AND GUTTER SHALL BE DETERMINED BY THE RESIDENT ENGINEER AT THE TIME OF CONSTRUCTION.

BASIS OF PAYMENT:
THIS WORK WILL BE PAID FOR AT THE CONTRACT UNIT PRICE PER FOOT (METER) FOR "CURB REMOVAL AND REPLACEMENT" OR "COMBINATION CONCRETE CURB AND GUTTER REMOVAL AND REPLACEMENT".

ALL DIMENSIONS ARE IN INCHES (MILLIMETERS) UNLESS OTHERWISE SHOWN.

REVISIONS	
NAME	DATE
A. HOUSEH	03/11/94
R. SHAH	02/24/95
R. SHAH	03/02/95
R. SHAH	08/19/96
R. SHAH	09/12/96
R. SHAH	09/19/96
R. SHAH	10/03/96
A. ABBAS	03/21/97
M. GOMEZ	01/22/01
R. BORO	01/01/07

ILLINOIS DEPARTMENT OF TRANSPORTATION
CURB OR CURB AND GUTTER REMOVAL AND REPLACEMENT

SCALE: VERT. NONE
HORIZ. NONE
DRAWN BY
CHECKED BY
BD600-06 (BD-24)

CURB OR CURB AND GUTTER REMOVAL AND REPLACEMENT

CHRISTOPHER B. BURKE ENGINEERING LTD.
 9575 West Higgins Road, Suite 600
 Rosemont, Illinois 60018
 (847) 823-0500
 CBB
 SURVEYED BY DATE
 ALIGNED BY DATE
 CHECKED BY DATE
 IN CHARGE BY DATE
 NOTE BOOK NO.
 PROJECT NO.

PLOT DATE: 3/5/2007
 FILE NAME: K:\projects\bd600-06.dgn
 USER: R. BORO
 SCALE: 1/8" = 1'-0"
 USDR: R. BORO

F.A. SECTION	COUNTY	TOTAL SHEETS	SHEET NO.
08-00067-00-RS	COOK	15	13
STA. ---	TO STA. ---		
FED. ROAD DIST. NO.	ILLINOIS FED. AID PROJECT		

CONTRACT NO. 63103

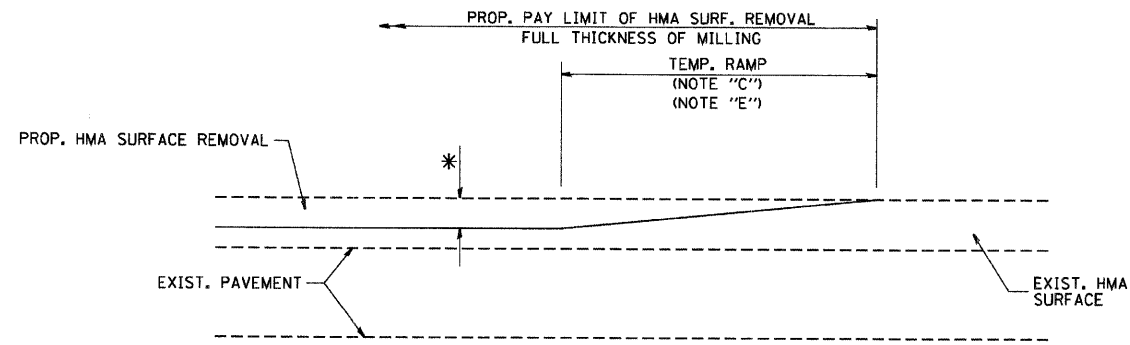

MILLED TEMPORARY RAMP
(FOR BUTT JOINT AND HMA TAPER SEE DETAIL BELOW)

OPTION 1

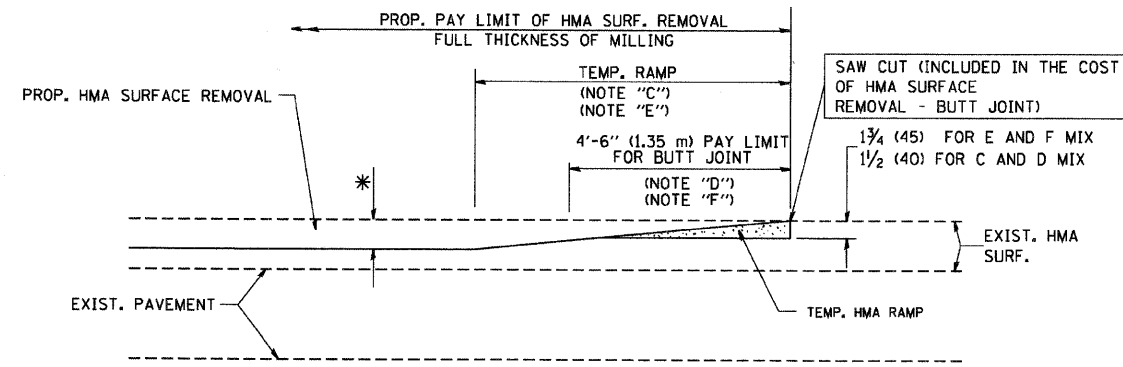

HMA CONSTRUCTED TEMPORARY RAMP
(FOR BUTT JOINT AND HMA TAPER SEE DETAIL BELOW)

OPTION 2
TYPICAL TEMPORARY RAMP

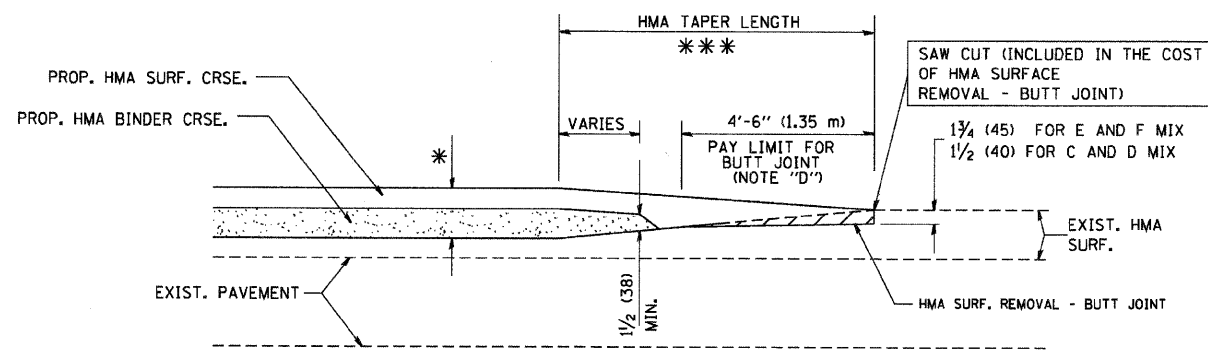

BUTT JOINT AND
HMA TAPER

TYPICAL BUTT JOINT AND HMA TAPER
FOR MILLING AND RESURFACING

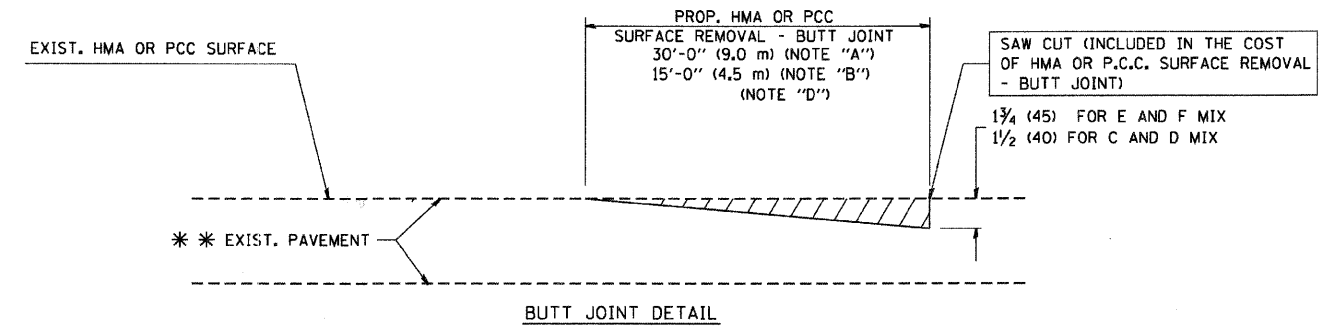

BUTT JOINT DETAIL

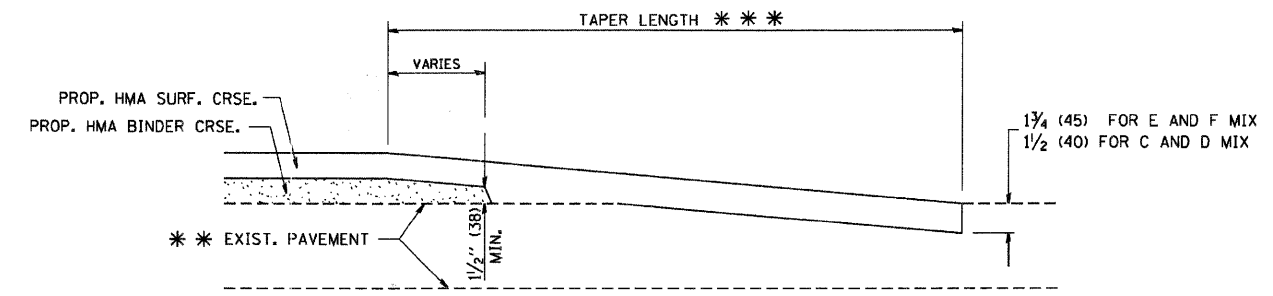

HMA TAPER DETAIL

TYPICAL BUTT JOINT AND HMA TAPER
FOR RESURFACING ONLY

*** PC CONCRETE, HMA OR HMA RESURFACED PAVEMENT.

NOTES

- A: MAINLINE ROADWAYS AND MAJOR SIDE ROADS.
- B: MINOR SIDE ROADS.
- C: THE TEMP. RAMP SHALL BE CONSTRUCTED IMMEDIATELY UPON REMOVAL OF THE EXISTING HMA SURFACE.
- D: THE BUTT JOINT SHALL BE CONSTRUCTED IMMEDIATELY PRIOR TO PLACING THE PROPOSED HMA COURSES.
- E: TAPER THE TEMP. RAMP AT A RATE OF 3'-0" (900 mm) PER 1 INCH (25 mm) OF MILLING THICKNESS.
- F: INSTALLATION AND REMOVAL OF THE 4'-6" (1.35 m) TEMP. RAMP IS INCLUDED IN COST OF HMA SURFACE REMOVAL - BUTT JOINT
- G: SEE ARTICLE 406.08 AND 406.14 OF THE STANDARD SPECIFICATIONS FOR "HMA AND/OR PCC SURFACE REMOVAL, BUTT JOINT".
- * SEE TYPICAL SECTIONS FOR MILLING THICKNESS.

*** 20'-0" (6.1 m) PER 1 (25) RESURFACING (NOTE "A")
10'-0" (3.0 m) PER 1 (25) RESURFACING (NOTE "B")

ALL DIMENSIONS ARE IN INCHES (MILLIMETERS) UNLESS OTHERWISE SHOWN.

BASIS OF PAYMENT:

THE BUTT JOINT WILL BE PAID FOR AT THE CONTRACT UNIT PRICE PER SQUARE YARD (SQUARE METER) FOR "HOT-MIX ASPHALT SURFACE REMOVAL - BUTT JOINT" OR FOR "PORTLAND CEMENT CONCRETE SURFACE REMOVAL - BUTT JOINT".

REVISIONS	
NAME	DATE
M. DE YONG	6-13-90
M. DE YONG	7-3-90
M. DE YONG	3-27-92
R. SHAH	09/09/94
R. SHAH	10/25/94
A. ABBAS	03/21/97
M. GOMEZ	04/06/01
R. BORO	01/01/07

ILLINOIS DEPARTMENT OF TRANSPORTATION

BUTT JOINT AND
HMA TAPER
DETAILS

SCALE: VERT. NONE
HORIZ.

DRAWN BY
CHECKED BY

BD400-05 (VI-BD32)

DATE
BY
SURVEYED
PLOTTED
CHECKED
DATE
NO. OF RAY CHECKED
PAID FILE NAME

PLAN
NO.
NO. OF RAY CHECKED
PAID FILE NAME
CHRISTOPHER B. BURKE ENGINEERING LTD.
9575 West Higgins Road, Suite 600
Rosemont, Illinois 60018
(847) 823-0500

DATE
BY
PROFILE
SURVEYED
PLOTTED
CHECKED
DATE
NO. OF RAY CHECKED
PAID FILE NAME

P.A. RTE.	SECTION	COUNTY	TOTAL SHEETS	SHEET NO.
---	08-00067-00-RS	COOK	15	14
STA.	TO STA.		---	
FED. ROAD DIST. NO.	ILLINOIS	FED. AID PROJECT		

CONTRACT NO. 63103

SURVEYED BY: DATE: _____
 ALIGNED BY: CHECKED BY: _____
 PLAN NO.: _____
 DATE: _____
 ENGINEER: _____
 CHECKED: _____
 DATE: _____
 PROJECT: _____
 SHEET: _____ OF _____
 DRAWN BY: _____
 CHECKED BY: _____
 DATE: _____

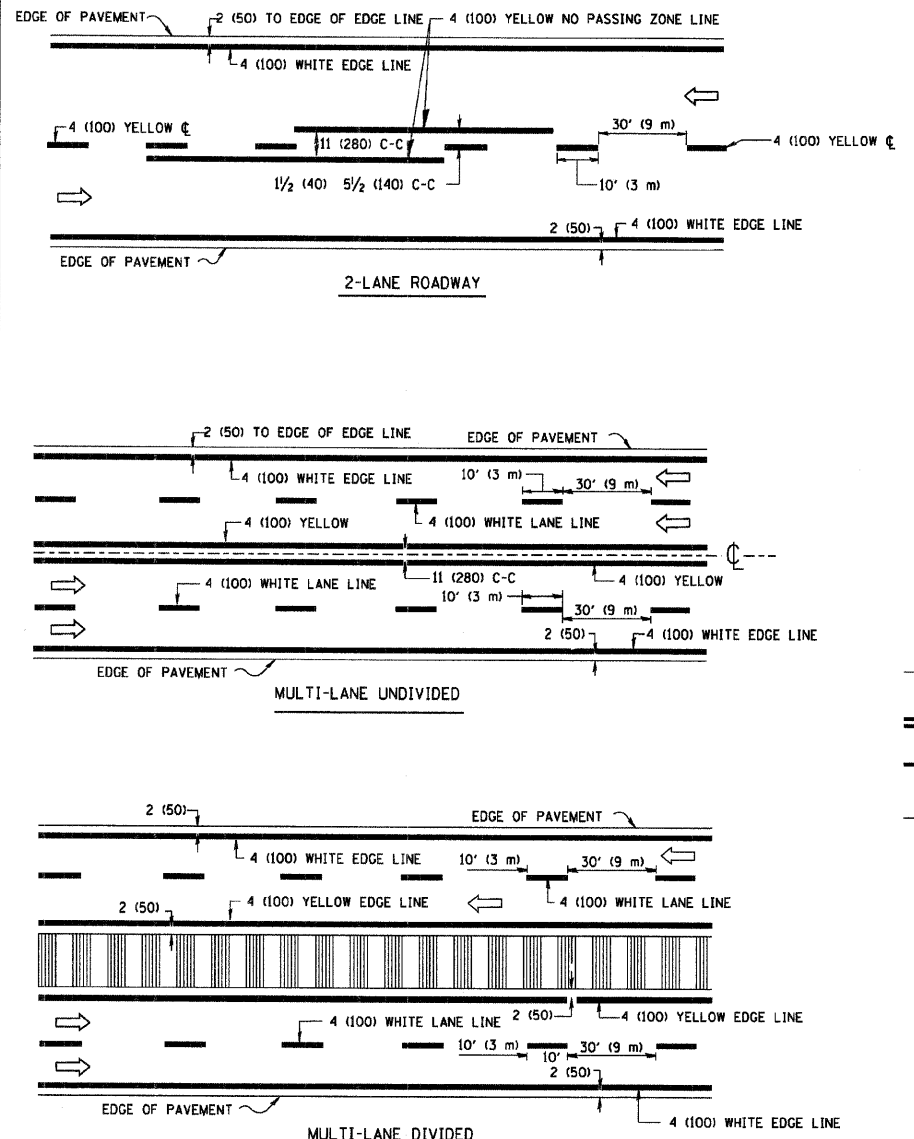

TYPICAL LANE AND EDGE LINE MARKING

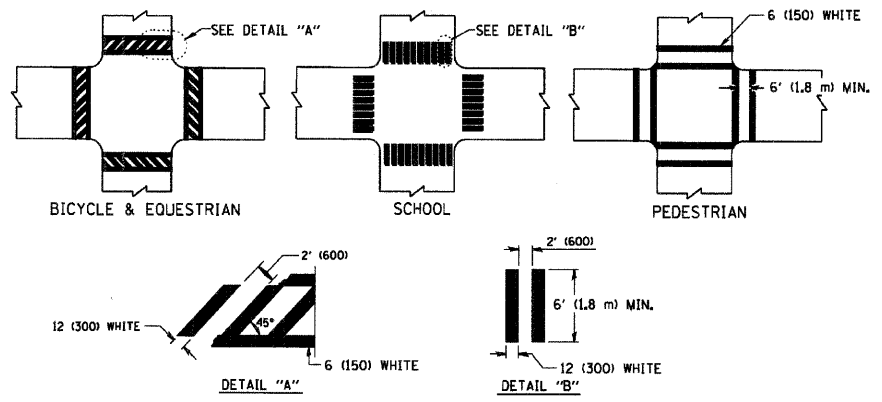

TYPICAL CROSSWALK MARKING

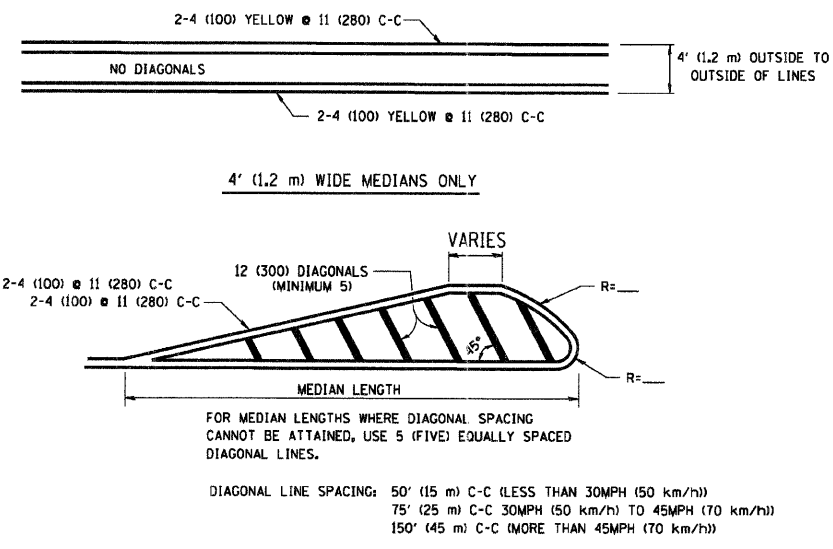

MEDIANS OVER 4' (1.2 m) WIDE

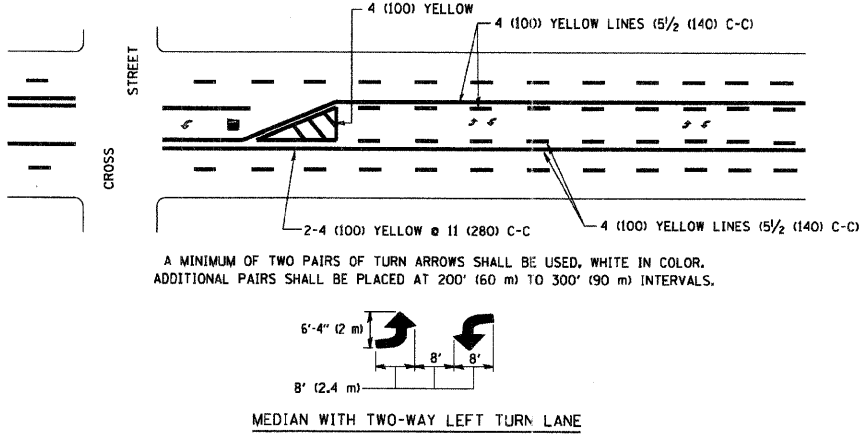

TYPICAL PAINTED MEDIAN MARKING

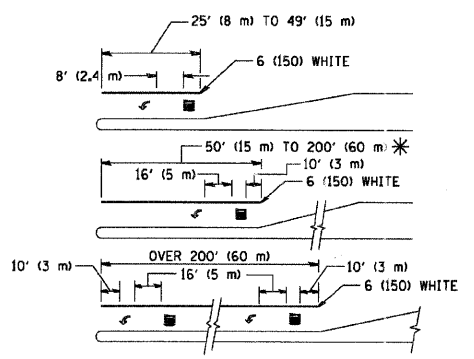

TYPICAL LEFT (OR RIGHT) TURN LANE

FULL SIZE LETTERS 8" (2.4 m) AND ARROWS SHALL BE USED.
 * TURN LANES IN EXCESS OF 400' (120 m) IN LENGTH MAY HAVE AN ADDITIONAL SET OF ARROW - "ONLY" INSTALLED MIDWAY BETWEEN THE OTHER TWO SETS OF ARROW - "ONLY".

TYPICAL TURN LANE MARKING

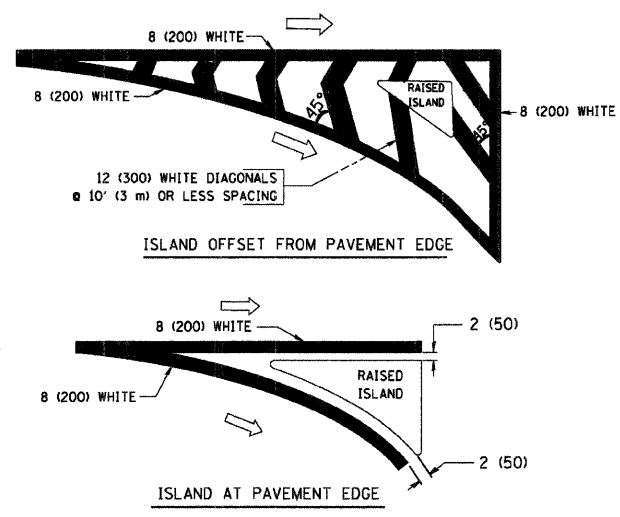

TYPICAL ISLAND MARKING

TYPE OF MARKING	WIDTH OF LINE	PATTERN	COLOR	SPACING / REMARKS
CENTERLINE ON 2 LANE PAVEMENT	4 (100)	SKIP-DASH	YELLOW	10' (3 m) LINE WITH 30' (9 m) SPACE
CENTERLINE ON MULTI-LANE UNDIVIDED PAVEMENT	2 @ 4 (100)	SOLID	YELLOW	11 (280) C-C
NO PASSING ZONE LINES: FOR ONE DIRECTION FOR BOTH DIRECTIONS	4 (100) 2 @ 4 (100)	SOLID SOLID	YELLOW YELLOW	5 1/2 (140) C-C FROM SKIP-DASH CENTERLINE 11 (280) C-C OMIT SKIP-DASH CENTERLINE BETWEEN
LANE LINES	4 (100) 5 (125) ON FREEWAYS	SKIP-DASH SKIP-DASH	WHITE WHITE	10' (3 m) LINE WITH 30' (9 m) SPACE
DOTTED LINES (EXTENSIONS OF CENTER, LANE OR TURN LANE MARKINGS)	SAME AS LINE BEING EXTENDED	SKIP-DASH	SAME AS LINE BEING EXTENDED	2' (600) LINE WITH 6' (1.8 m) SPACE
EDGE LINES	4 (100)	SOLID	YELLOW-LEFT WHITE-RIGHT	OUTLINE MOUNTABLE MEDIANS IN YELLOW; EDGE LINES ARE NOT USED NEXT TO BARRIER CURB
TURN LANE MARKINGS	6 (150) LINE; FULL SIZE LETTERS & SYMBOLS (8" (2.4m))	SOLID	WHITE	SEE TYPICAL TURN LANE MARKING DETAIL
TWO WAY LEFT TURN MARKING	2 @ 4 (100) EACH DIRECTION 8' (2.4m) LEFT ARROW	SKIP-DASH AND SOLID IN PAIRS	YELLOW WHITE	10' (3 m) LINE WITH 30' (9 m) SPACE FOR SKIP-DASH; 5 1/2 (140) C-C BETWEEN SOLID LINE AND SKIP-DASH LINE SEE TYPICAL TWO-WAY LEFT TURN MARKING DETAIL
CROSSWALK LINES (PEDESTRIAN) A. DIAGONALS (BIKE & EQUESTRIAN) B. LONGITUDINAL BARS (SCHOOL)	2 @ 6 (150) 12 (300) @ 45° 12 (300) @ 90°	SOLID SOLID SOLID	WHITE WHITE WHITE	NOT LESS THAN 6' (1.8 m) APART 2' (600) APART 2' (600) APART SEE TYPICAL CROSSWALK MARKING DETAILS.
STOP LINES	24 (600)	SOLID	WHITE	PLACE 4' (1.2 m) IN ADVANCE OF AND PARALLEL TO CROSSWALK, IF PRESENT. OTHERWISE, PLACE AT DESIRED STOPPING POINT, PARALLEL TO CROSSROAD CENTERLINE, WHERE POSSIBLE
PAINTED MEDIANS	2 @ 4 (100) WITH 12 (300) DIAGONALS @ 45° NO DIAGONALS USED FOR 4' (1.2 m) WIDE MEDIANS	SOLID	YELLOW; TWO WAY TRAFFIC WHITE; ONE WAY TRAFFIC	11 (280) C-C FOR THE DOUBLE LINE SEE TYPICAL PAINTED MEDIAN MARKING.
GORE MARKING AND CHANNELIZING LINES	8 (200) WITH 12 (300) DIAGONALS @ 45°	SOLID	WHITE	DIAGONALS: 15' (4.5 m) C-C (LESS THAN 30MPH (50 km/h)) 20' (6 m) C-C (30MPH (50 km/h) TO 45MPH (70 km/h)) 30' (9 m) C-C (OVER 45MPH (70 km/h))
RAILROAD CROSSING	24 (600) TRANSVERSE LINES; "RR" IS 6' (1.8 m) LINE FOR "X"	SOLID	WHITE	SEE STATE STANDARD 780001 AREA OF: "R"=3.6 SQ. FT. (0.33 m ²) EACH "X"=54.0 SQ. FT. (5.0 m ²)
SHOULDER DIAGONALS	12 (300) @ 45°	SOLID	WHITE - RIGHT YELLOW - LEFT	50' (15 m) C-C (LESS THAN 30MPH (50 km/h)) 75' (25 m) C-C (30 MPH (50 km/h) TO 45MPH (70 km/h)) 150' (45 m) C-C (OVER 45MPH (70 km/h))

FOR FURTHER DETAILS ON PAVEMENT MARKING REFER TO STANDARD SPECIFICATIONS FOR ROAD AND BRIDGE CONSTRUCTION AND STATE STANDARD 780001.

All dimensions are in inches (millimeters) unless otherwise shown.

REVISIONS	
NAME	DATE
EVERS	03-19-90
T. RAMMACHER	10-27-94
ALEX HOUSEH	10-09-96
ALEX HOUSEH	10-17-96
T. RAMMACHER	01-06-00

ILLINOIS DEPARTMENT OF TRANSPORTATION
 DISTRICT ONE
 TYPICAL PAVEMENT MARKINGS

SCALE: NONE
 07/25/05
 DRAWN BY CADD
 CHECKED BY

F.A. RTE.	SECTION	COUNTY	TOTAL SHEETS	SHEET NO.
---	08-00067-00-RS	COOK	15	15
STA.	TO STA.		---	
FED. ROAD DIST. NO.	ILLINOIS	FED. AID PROJECT		

CONTRACT NO. 63103

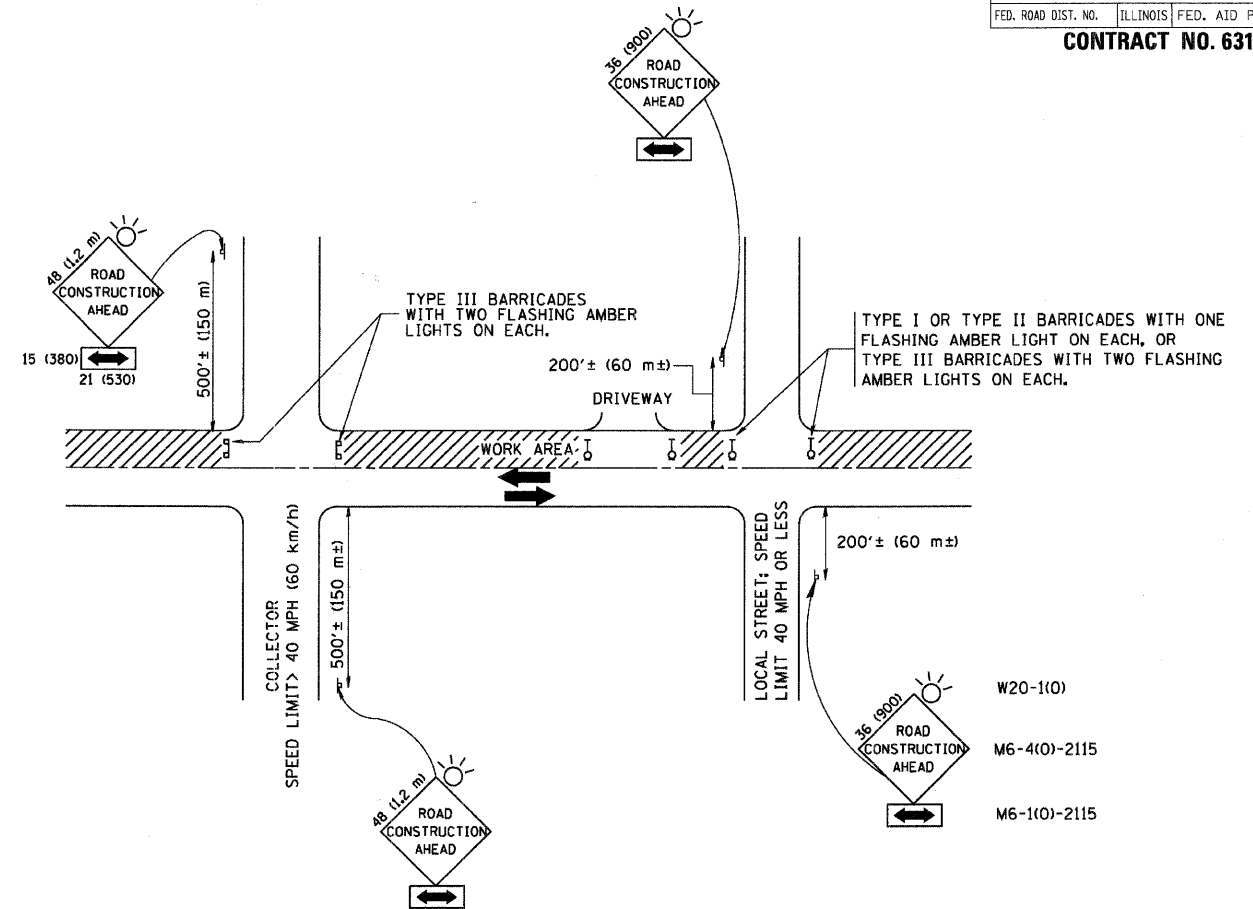

TRAFFIC CONTROL AND PROTECTION FOR SIDE ROADS, INTERSECTIONS, AND DRIVEWAYS

NOTES:

A. FOR NO LANE RESTRICTION ON THE SIDE ROAD OR DRIVEWAYS

- SIDE ROAD WITH A SPEED LIMIT OF 40 MPH (60 km/h) OR LESS AS SHOWN ON THE DRAWING AND AS DIRECTED BY THE ENGINEER:
 - ONE ROAD CONSTRUCTION AHEAD SIGN 36 x 36 (900x900) WITH A FLASHER AND FLAG MOUNTED ON IT APPROXIMATELY 200' (60 m) IN ADVANCE OF THE MAIN ROUTE.
 - THE CLOSED PORTION OF THE MAIN ROUTE SHALL BE PROTECTED BY BLOCKING WITH TYPE I, TYPE II OR TYPE III BARRICADES, 1/3 OF THE CROSS SECTION OF THE CLOSED PORTION.
- SIDE ROAD WITH A SPEED LIMIT GREATER THAN 40 MPH (60 km/h) AS SHOWN ON THE DRAWING AND AS DIRECTED BY THE ENGINEER:
 - ONE ROAD CONSTRUCTION AHEAD SIGN 48 x 48 (1.2 m x 1.2 m) WITH A FLASHER MOUNTED ON IT APPROXIMATELY 500' (150 m) IN ADVANCE OF THE MAIN ROUTE.
 - THE CLOSED PORTION OF THE MAIN ROUTE SHALL BE PROTECTED BY BLOCKING WITH TYPE III BARRICADES, 1/2 OF THE CROSS SECTION OF THE CLOSED PORTION.
- WHEN THE SIDE ROAD LIES BETWEEN THE BEGINNING OF THE MAINLINE SIGNING AND THE WORK ZONE, A SINGLE HEADED ARROW (M6-1) SHALL BE USED IN LIEU OF THE DOUBLE HEADED ARROW (M6-4).

B. FOR A LANE CLOSURE ON A SIDE ROAD OR DRIVEWAY:

USE APPLICABLE PORTIONS OF THE TYPICAL APPLICATION OF TRAFFIC CONTROL DEVICES (STD. 701501, STD. 701606 OR THE APPROPRIATE STANDARD). THE SPACING OF SIGNS AND BARRICADES SHALL BE ADJUSTED FOR FIELD CONDITIONS AS DIRECTED BY THE ENGINEER. THE DIRECTIONAL ARROW SHALL BE COVERED OR REMOVED WHEN NO LONGER CONSISTENT WITH THE SIDE ROAD LANE CLOSURE.

C. ADVANCE WARNING SIGNS ARE TO BE OMITTED ON DRIVEWAY UNLESS OTHERWISE NOTED.

D. THE TRAFFIC CONTROL AND PROTECTION FOR SIDE ROADS, INTERSECTIONS, AND DRIVEWAYS SHALL BE INCIDENTAL TO THE COST OF SPECIFIED TRAFFIC CONTROL STANDARDS OR ITEMS.

All dimensions are in millimeters (inches) unless otherwise shown.

REVISIONS	
NAME	DATE
LHA	6/89
T. RAMMACHER	09/08/94
J. OBERLE	10/18/95
A. HOUSEH	03/06/96
A. HOUSEH	10/15/96
T. RAMMACHER	01/06/00

ILLINOIS DEPARTMENT OF TRANSPORTATION
TRAFFIC CONTROL AND PROTECTION
FOR
SIDE ROADS, INTERSECTIONS, AND
DRIVEWAYS

SCALE: NONE

07/25/05

DRAWN BY

CHECKED BY

TC-10

DATE	BY
SURVEYED	
ALIGNMENT CHECKED	
PLAN FILE NAME	N:\NORTHLAKE\940032\hr193\civil\hr193_std2.dwt
PLAN NO.	

CHRISTOPHER B. BURKE ENGINEERING LTD.
9575 West Higgins Road, Suite 600
Rosemont, Illinois 60018
(847) 823-0500

DATE	BY
PROFILES	
GRADES CHECKED	
NOTE BOOK	
STRUCTURE	NOTATION CHFD
NO.	