

ROUTE NO.	SECTION	COUNTY	TOTAL SHEETS	SHEET NO.
FAU 1694	07-00122-00-PV	COOK	55	29
ILLINOIS PROJECT M-9003 (125)				
VILLAGE SECTION				
CONTRACT NO. 63101				

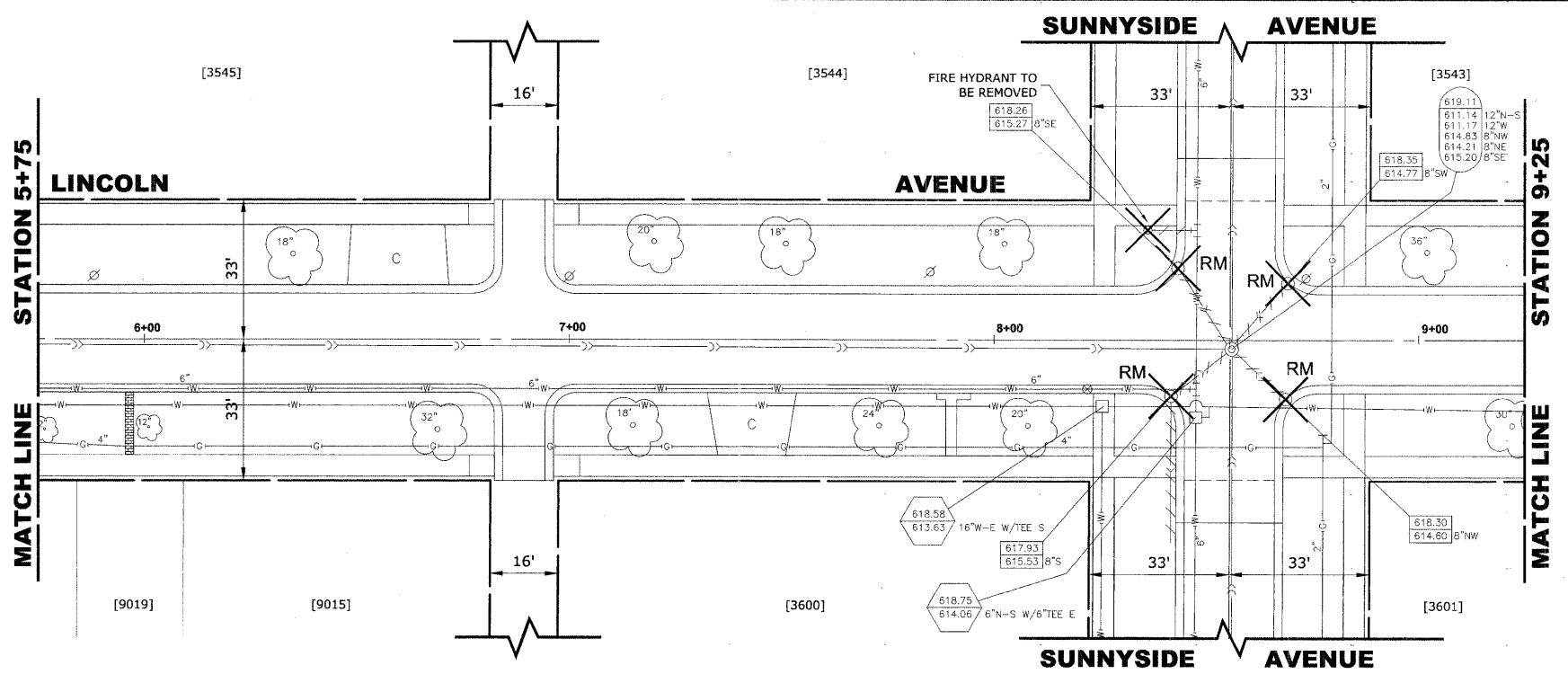

STRUC. NO.	STA	OFFSET	TYPE	RIM ELEV.	INVERT ELEV.
42	8+33	5' LT	R.D. STORM SEWER MANHOLE, 5' DIA., TYPE 1 FRAME, CLOSED LID	618.85	614.70 NE 614.60 SE 609.50 W 605.90 E
43	8+37	17' LT	R.D. CATCH BASIN, 4' DIA., TYPE 1 FRAME, OPEN LID	618.35	614.85 SW
44	8+37	17' RT	R.D. CATCH BASIN, 4' DIA., TYPE 1 FRAME, OPEN LID	618.35	614.85 NW
45	8+66	5' LT	R.D. STORM SEWER MANHOLE, 5' DIA., TYPE 1 FRAME, CLOSED LID	618.90	614.65 NE 614.55 SE 609.40 E 605.60 W
46	8+75	17' LT	R.D. CATCH BASIN, 4' DIA., TYPE 1 FRAME, OPEN LID	618.30	614.80 SW
47	8+75	17' RT	R.D. CATCH BASIN, 4' DIA., TYPE 1 FRAME, OPEN LID	618.30	614.80 NW

EXISTING TOPOGRAPHY

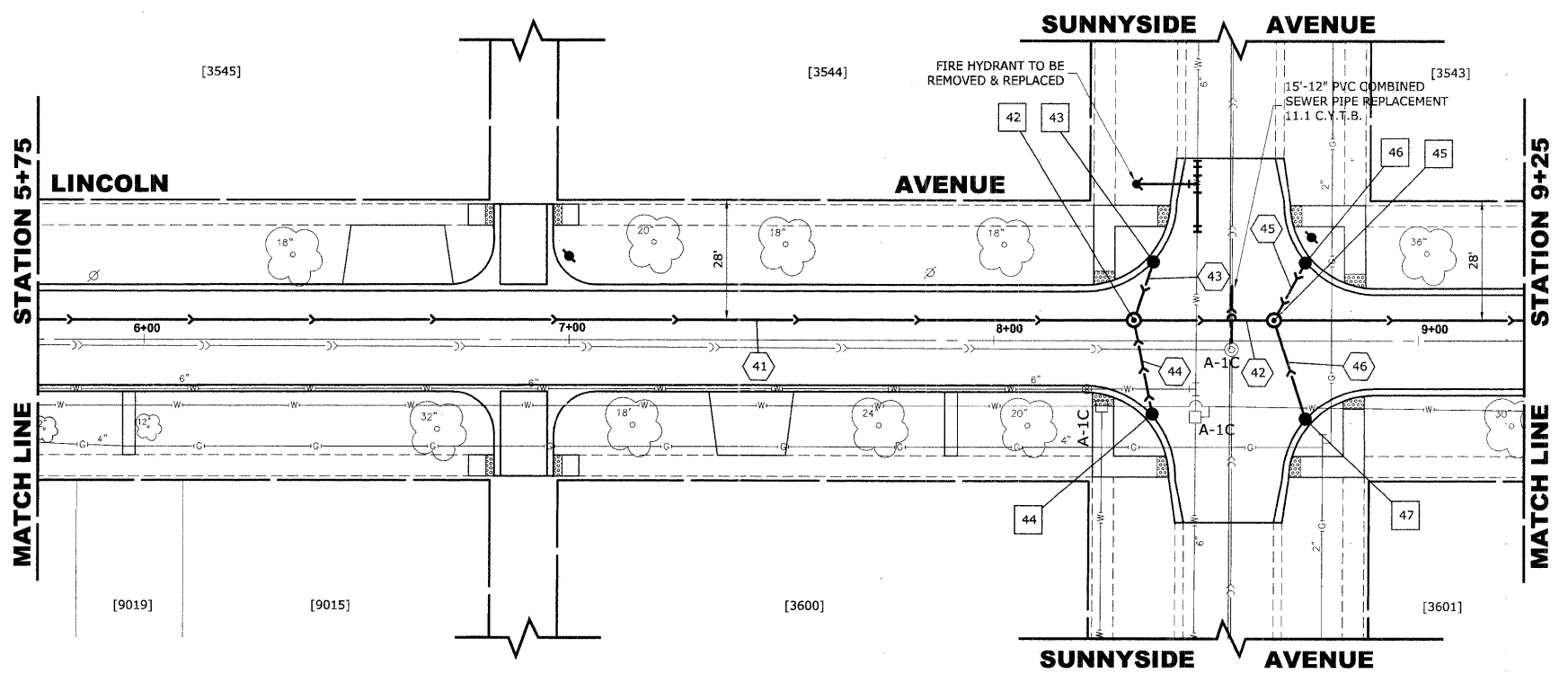

PIPE NO	LENGTH	DIA.	TYPE	SLOPE	C.Y.T.B.
41	300'	42"	SS, TY-2, RCCP, CL-III	0.09%	500.7
42	30'	42"	SS, TY-2, RCCP, CL-III	1.00%	80.6
43	12'	10"	SS, PVC, SDR 26	1.25%	0.8
44	25'	10"	SS, PVC, SDR 26	1.00%	1.8
45	12'	10"	SS, PVC, SDR 26	1.25%	0.9
46	25'	10"	SS, PVC, SDR 26	1.00%	2.0

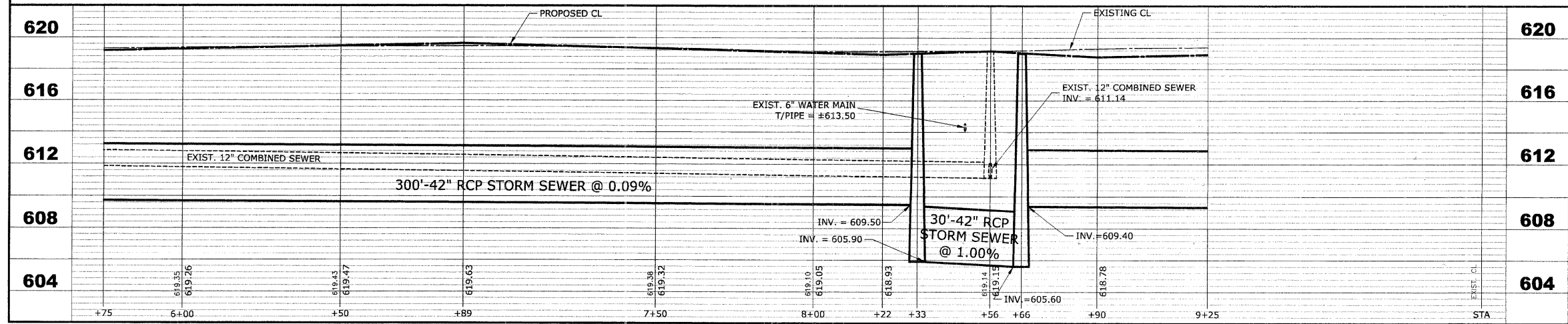

PROPOSED IMPROVEMENTS

HANCOCK ENGINEERING ♦ Civil Engineers ♦ Municipal Consultants ♦ Established 1911

BROOKFIELD GRAND BOULEVARD IMPROVEMENTS LINCOLN AVENUE PAVING PLAN AND PROFILE

DRAWN BY: LEVEC/WMK
CHECKED BY: JCG
DATE: 01-09-09

SCALE: 1"=20'H. & 1"=4'V.

Drawing file: W:\Projects\12508135 - Grand Blvd Grant to Veterans\Grand Blvd\Grand Blvd.dwg Jan 09, 2009 - 10:52am