

ROUTE NO.	SECTION	COUNTY	TOTAL SHEETS	SHEET NO.
FAU 1684	07-00122-00-PV	COOK	55	11
ILLINOIS PROJECT M-9003 (125)				
VILLAGE SECTION				
CONTRACT NO. 63101				

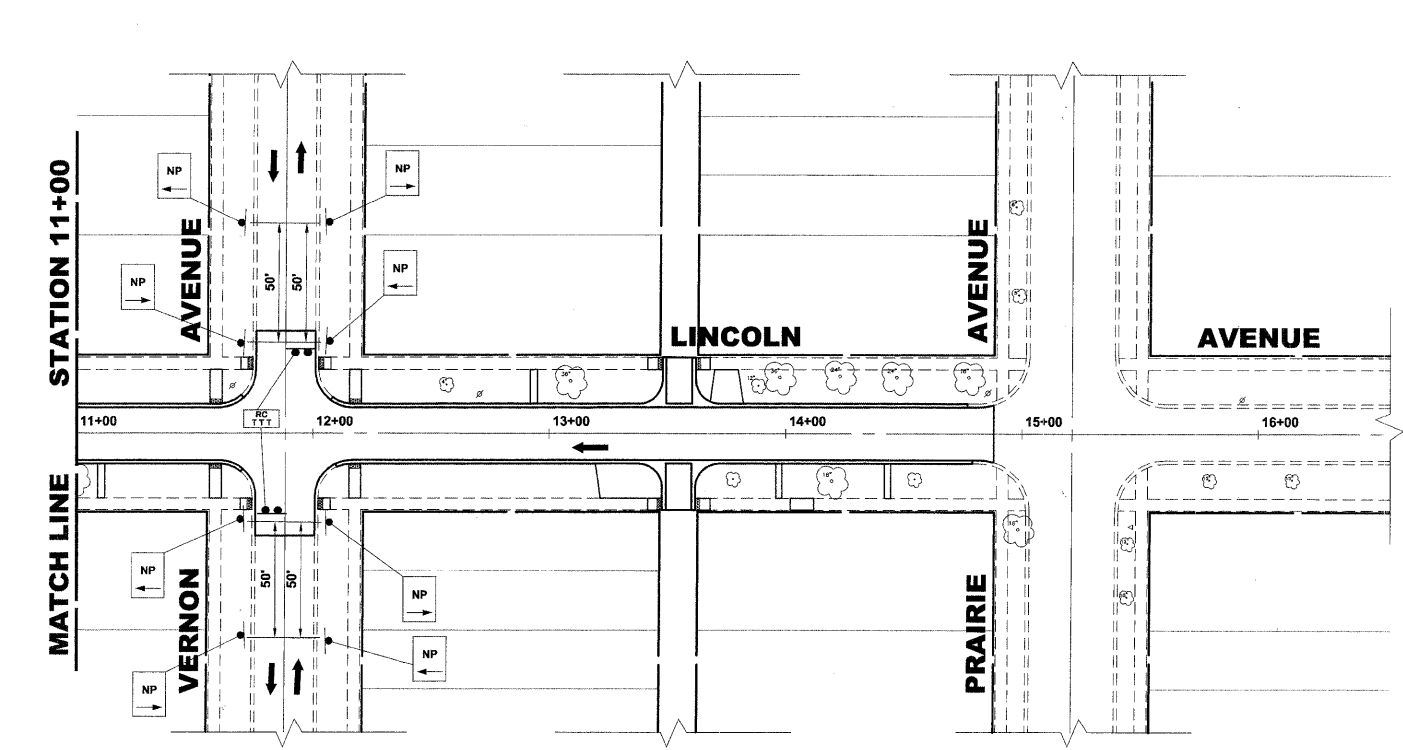
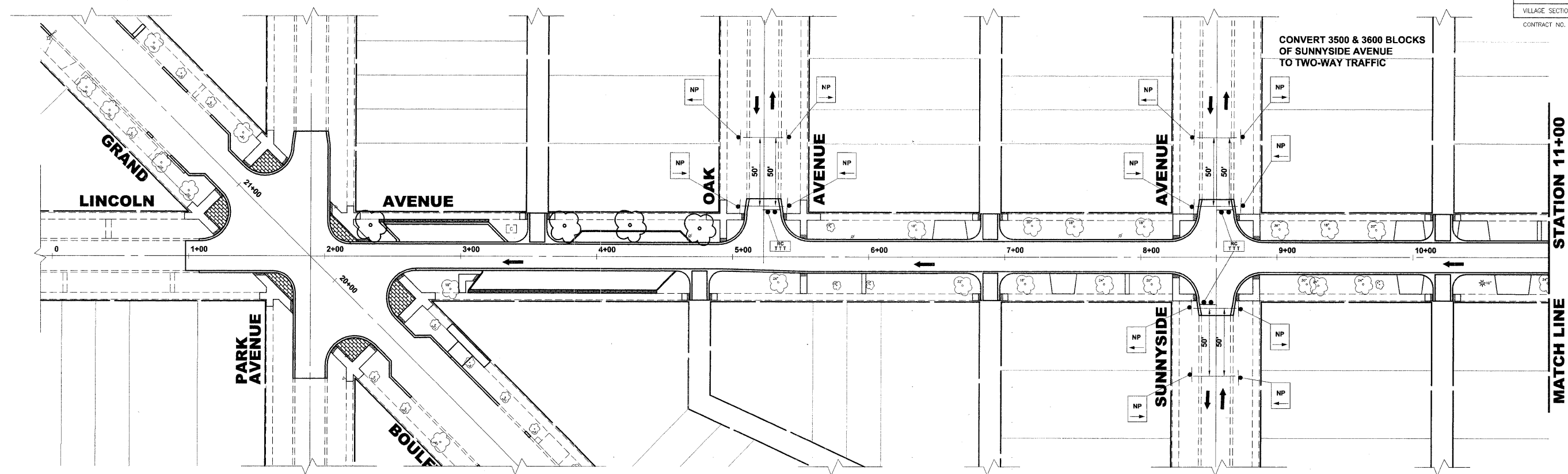

PROJECT STAGING AND LOCAL ACCESS

1. ONCE WORK HAS BEGUN ON THE STORM SEWER ON LINCOLN AVENUE, LINCOLN AVENUE WILL BE CLOSED TO THROUGH TRAFFIC FROM PRAIRIE AVENUE TO GRAND BOULEVARD.
2. ONCE WORK HAS BEGUN ON THE STORM SEWER ON GRAND BOULEVARD, GRAND BOULEVARD WILL BE CLOSED TO THROUGH TRAFFIC FROM GRANT AVENUE TO VETERAN'S CIRCLE.
3. THE PAVEMENT ON THE SOUTH SIDE OF LINCOLN AVENUE WILL BE LEFT IN PLACE WHILE THE STORM SEWER AND CONCRETE ITEMS ARE INSTALLED TO PROVIDE A HARD SURFACE FOR LOCAL ACCESS. ONLY THE NORTH HALF OF THE PAVEMENT ON LINCOLN AVENUE WILL BE REMOVED WHILE THE STORM SEWER IS BEING INSTALLED. THE PAVEMENT WILL BE SAW-CUT ALONG THE CENTER-LINE AND AT ALL INTERSECTIONS TO ALLOW FOR THE NEAT REMOVAL OF THE EXISTING PAVEMENT. THE PAVEMENT SHALL ALSO BE SAW-CUT AND NEATLY REMOVED FOR ALL TRENCHES THAT CROSS THE SOUTH HALF OF THE PAVEMENT.
4. THE EXCAVATION FOR THE PROPOSED PAVEMENT ON LINCOLN AVENUE SHALL BEGIN AFTER THE INSTALLATION OF THE PROPOSED CONCRETE CURB AND GUTTER, SIDEWALK, AND DRIVEWAY APRONS.
5. ACCESS MUST BE MAINTAINED AT ALL TIMES TO AT LEAST ONE OF THE FOLLOWING PARKING LOCATIONS FOR THE PUBLIC LIBRARY.
 - A. DIAGONAL PARKING ON THE SOUTH SIDE OF LINCOLN AVENUE.
 - B. PARALLEL PARKING ALONG THE LIBRARY FRONTAGE ON THE EAST SIDE OF GRAND BOULEVARD.
6. WHILE THE STORM SEWER AND CONCRETE WORK IS BEING PERFORMED, ON-STREET PARKING WILL BE ALLOWED ON THE EAST SIDE OF GRAND BOULEVARD AND 2 THROUGH LANES WILL BE MAINTAINED TO PERMIT LOCAL ACCESS DURING NON-WORKING HOURS.
7. THE TRENCHES FOR THE STORM SEWER LATERALS SHALL BE BACKFILLED TO THE TOP OF THE EXISTING PAVEMENT TO PROVIDE LOCAL ACCESS.
8. THE TRENCH BACKFILL FOR THE PROPOSED STORM SEWER ON THE WEST SIDE OF GRAND BOULEVARD WILL EXTEND TO THE TOP OF THE EXISTING SUBGRADE. TEMPORARY STONE RAMPS SHALL BE PROVIDED TO ALL DRIVEWAYS ON THE WEST SIDE OF GRAND BOULEVARD.
9. THE 3500 BLOCK OF PARK, THE 3500 & 3600 BLOCK OF SUNNYSIDE, THE 9000 BLOCK OF GRANT, AND THE 9100 BLOCK OF LINCOLN TO BE CONVERTED TO TWO-WAY TRAFFIC.
10. THE CONTRACTOR SHALL BE RESPONSIBLE FOR BAGGING ALL REGULATORY SIGNS THAT ARE NOT APPLICABLE DURING CONSTRUCTION.

REVISION:	

HANCOCK ENGINEERING ♦ Civil Engineers ♦ Municipal Consultants ♦ Established 1911

9313 Roosevelt Road
Woodstock, Illinois 60093-2786
Phone: 708/665-0300
Fax: 708/665-1212

BROOKFIELD
GRAND BOULEVARD IMPROVEMENTS
MAINTENANCE OF TRAFFIC
LOCAL ACCESS
SIGNING PLAN

DRAWN BY: LEVCEW/MK
CHECKED BY: JCG
DATE: 01-09-09

SCALE: 1" = 40'

E.H.E. PROJECT NO. : 125-08-13501

Drawing file: W:\Projects\12508135 - Grand Blvd Grant to Veterans\Grand Blvd 40_Signing.dwg Jun 09, 2009 - 10:58am