

SECTION NO.	COUNTY HIGHWAY	COUNTY	SHEET OF SHEETS
06-00092-02-PV	22	ST. CLAIR	61 OF 63
FHWA REG. NO. 7	ILLINOIS	ARA-5011 (297)	
FEDERAL AID PROJECT	CONTRACT # 97415		

CROSS SECTIONS

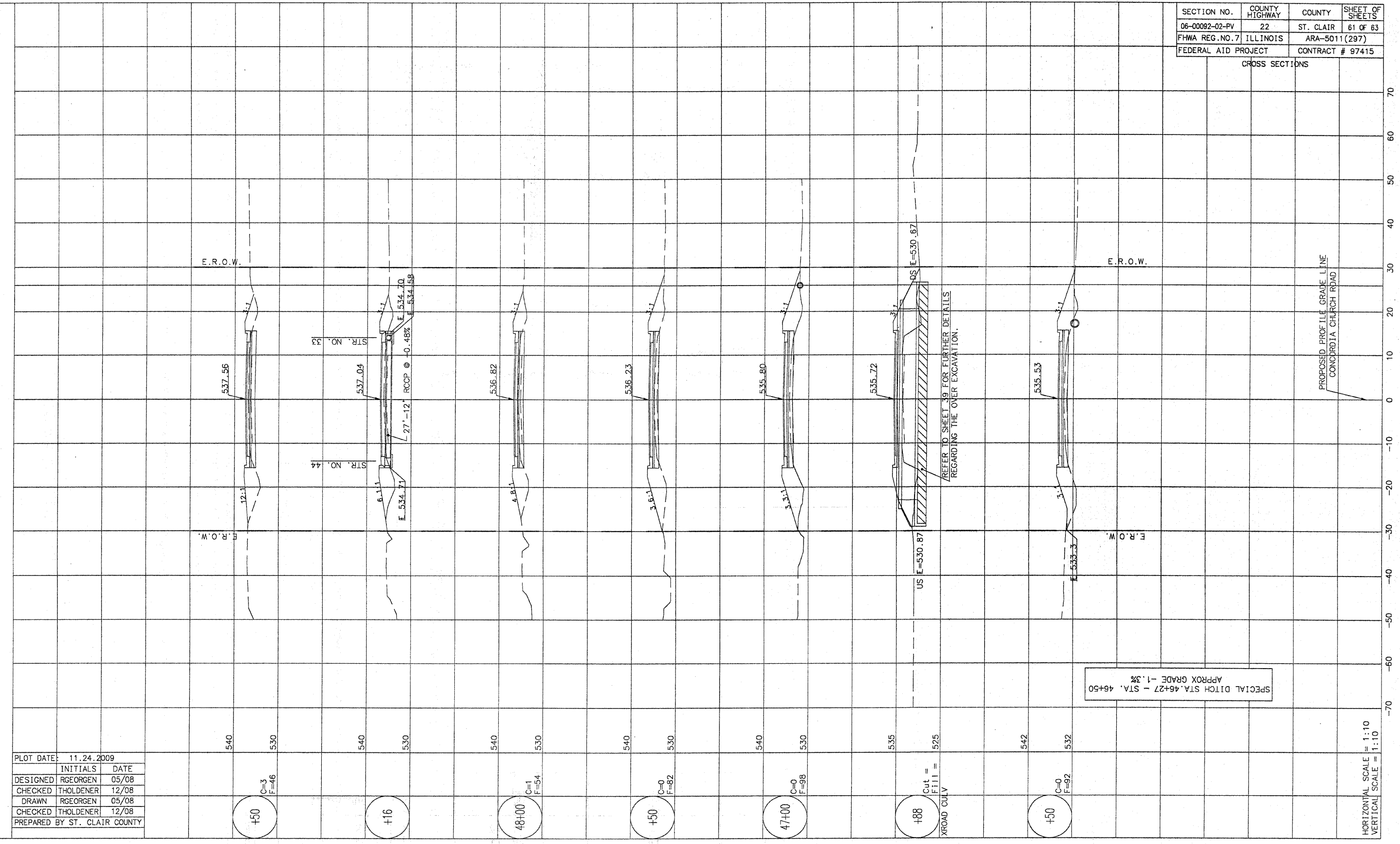

PROPOSED PROFILE GRADE LINE  
CONCORDIA CHURCH ROAD

SPECIAL DITCH STA. 46+27 - STA. 46+50  
APPROX GRADE -1.3%

PLOT DATE: 11.24.2009	
INITIALS	DATE
DESIGNED RGEORGEN	05/08
CHECKED THOLDENER	12/08
DRAWN RGEORGEN	05/08
CHECKED THOLDENER	12/08
PREPARED BY ST. CLAIR COUNTY	

+50  
C=3  
F=46

+16

48+00  
C=1  
F=54

+50  
C=0  
F=82

47+00  
C=0  
F=98

+88  
Cut =  
Fill =

+50  
C=0  
F=92

HORIZONTAL SCALE = 1:10  
VERTICAL SCALE = 1:10