

PLOT DATE: 04.28.2009 DRAWING FILE: 00092-02-PV XSEC 0-3450.dwg

SECTION NO.	COUNTY HIGHWAY	COUNTY	SHEET OF SHEETS
06-00092-02-PV	22	ST. CLAIR	50 OF 63
FHWA REG.NO.7	ILLINOIS	ARA-5011(297)	
FEDERAL AID PROJECT		CONTRACT # 97415	

CROSS SECTIONS

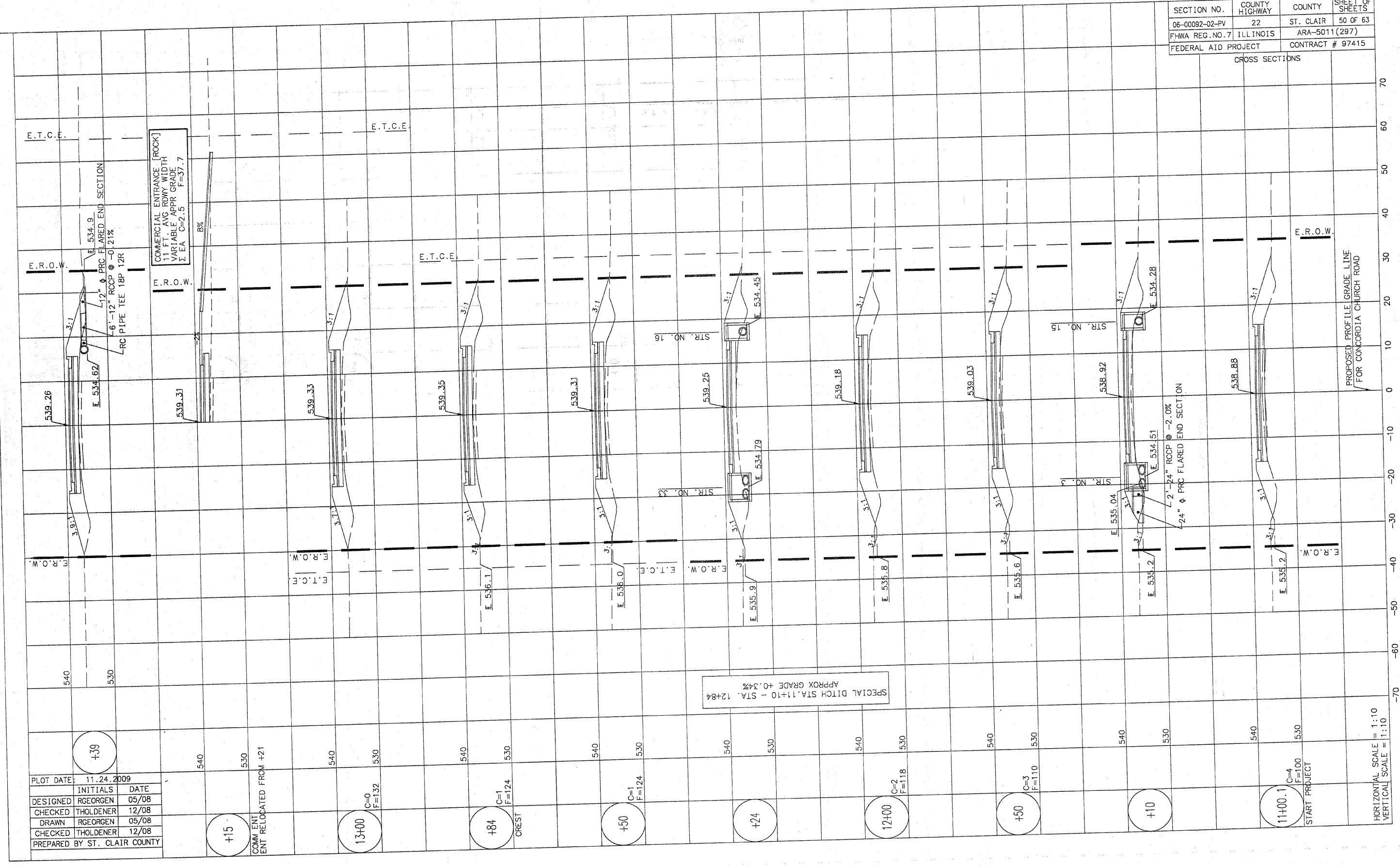

PLOT DATE:	11.24.2009
INITIALS	DATE
DESIGNED RGEORGEN	05/08
CHECKED THOLDNER	12/08
DRAWN RGEORGEN	05/08
CHECKED THOLDNER	12/08
PREPARED BY	ST. CLAIR COUNTY

+15
COMMENT
MENT RELOCATED FROM +21

+13+00
C=0
F=132

+84
C=1
F=124
CREST

+50
C=1
F=124

+24

12+00
C=2
F=118

+50
C=3
F=110

+10

11+00.1
C=4
F=100
START PROJECT

HORIZONTAL SCALE = 1:10
VERTICAL SCALE = 1:10