

SECTION NO.	COUNTY HIGHWAY	COUNTY	SHEET OF SHEETS
06-00092-02-PV	22	ST. CLAIR	41 OF 63
FHWA REG. NO. 7	ILLINOIS	ARA-5011(297)	
FEDERAL AID PROJECT		CONTRACT # 97415	

TRAFFIC CONTROL PLAN

GENERAL NOTES

1. THE CONTRACTOR MUST MAINTAIN ACCESS TO ALL ENTRANCES AT ALL TIMES.
2. ALL WARNING SIGNS SHALL BE A MINIMUM OF 48 INCHES BY 48 INCHES AND HAVE A BLACK LEGEND ON AN ORANGE REFLECTORIZED BACKGROUND.
3. 12V FLASHING WARNING LIGHTS SHALL BE USED IN ADVANCE OF THE WORK DURING HOURS OF DARKNESS AND BE INSTALLED ABOVE THE FIRST TWO SIGNS.
4. THE NUMBER OF TYPE III BARRICADES AT EACH LOCATION SHALL BE DETERMINED BY THE ENGINEER DURING CONSTRUCTION.
5. DISTANCES BETWEEN SIGNS MAY BE ADJUSTED BY THE ENGINEER TO FIT ACTUAL FIELD CONDITIONS.
6. ALL TYPE III BARRICADES UTILIZED FOR ROAD CLOSURES SHALL HAVE TWO 6V FLASHING LIGHTS MOUNTED ON TOP OF THE BARRICADES.
7. THE CONTRACTOR WILL NOT BE ALLOWED TO CONDUCT OPERATIONS IN MORE THAN ONE STAGE AT A TIME WITHOUT THE WRITTEN APPROVAL OF THE ENGINEER.
8. REFER TO THE SPECIAL PROVISIONS FOR ADDITIONAL INFORMATION REGARDING COMPLETION OF THE WORK IN A SPECIFIC STAGE.
9. STAGE I CONSTRUCTION LIMITS: STA. 10+99.5 TO STA. 34+31.
10. STAGE II CONSTRUCTION LIMITS: STA. 34+31 TO STA. 54+79.5.
11. THE TEMPORARY TRANSITION PAVEMENT, AS SHOWN, SHALL BE CONSTRUCTED AFTER STAGE I IS COMPLETED AND PRIOR TO COMMENCING CONSTRUCTION IN STAGE II.
12. THE STAGGERED BARRICADES SHOWN ON THE EAST LEG MAY BE PLACED AT STA. 10+59.5 WHILE STAGE I IS UNDER CONSTRUCTION. ONCE STAGE I CONSTRUCTION IS COMPLETED AND PRIOR TO CONSTRUCTING THE TEMPORARY TRANSITION PAVEMENT THEN THE BARRICADES SHALL BE RELOCATED TO THE LOCATIONS AS SHOWN.

LEGEND

- ① : ROAD CONSTRUCTION AHEAD
- ② : ROAD CLOSED AHEAD
- ③ : BARRICADES AHEAD
- ➡ : RIGHT TURN ARROW
- ⬅ : LEFT TURN ARROW
- ➡ : STRAIGHT ARROW
- ⌚ : ROAD CLOSED TO THROUGH TRAFFIC
- ⌚ : "CONCORDIA CHURCH ROAD"
- ± : TYPE III BARRICADE WITH FLASHING AMBER LIGHTS MOUNTED ON TOP RAIL

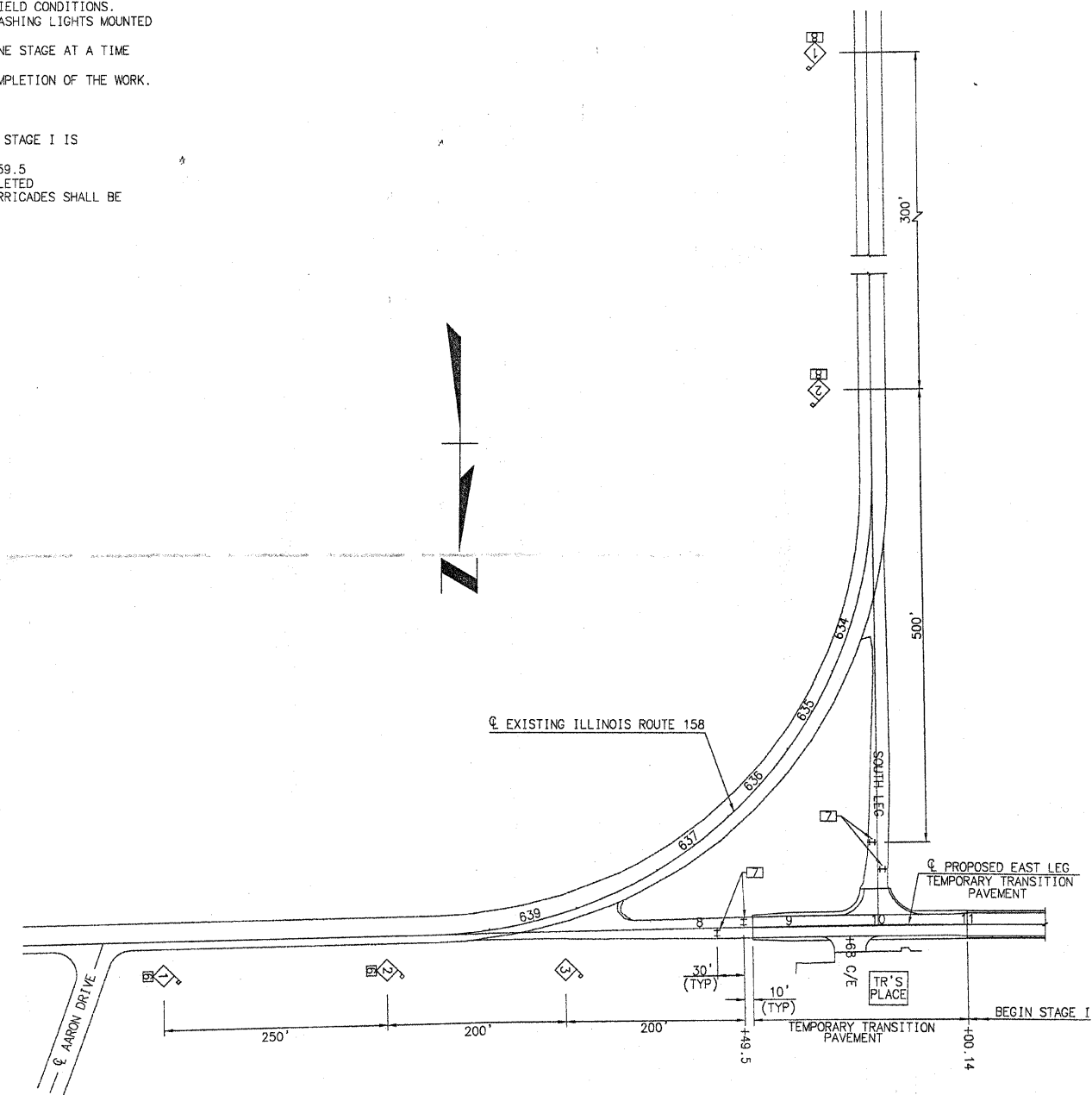

PLOT DATE: 11.24.2009

	INITIALS	DATE
DESIGNED	RGEORGEN	10/08
CHECKED	THOLDENER	12/08
DRAWN	RGEORGEN	10/08
CHECKED	THOLDENER	12/08

PREPARED BY ST. CLAIR COUNTY HIGHWAY DEPARTMENT

FILE NAME: 00092-02-PV TCP PLN.dwg