

SECTION NO.	COUNTY HIGHWAY	COUNTY	SHEET OF SHEETS
06-00092-02-PV	22	ST. CLAIR	40 OF 63
FHWA REG. NO. 7	ILLINOIS	ARA-5011 (297)	
FEDERAL AID PROJECT	CONTRACT # 97415		

PAVEMENT MARKING DETAIL

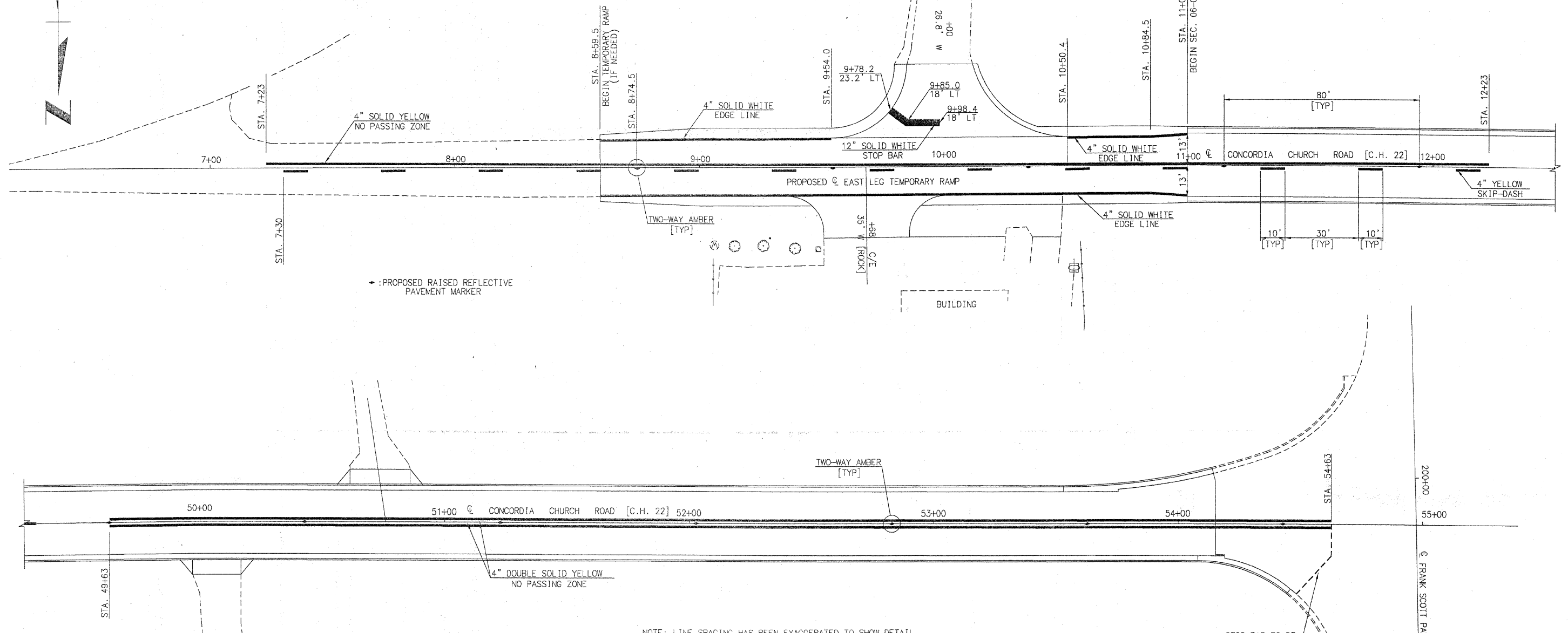
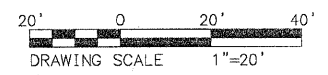

NOTE: LINE SPACING HAS BEEN EXAGGERATED TO SHOW DETAIL.

STOP BAR TO BE PLACED BY OTHERS

PAINT PAVEMENT MARKING SCHEDULE

LOCATION	DESCRIPTION	WIDTH (INCHES)	COLOR	LENGTH (FEET)
STA. 8+59.5 - STA. 9+54	EDGE LINE	4	WHITE	94.5
STA. 10+50.4 - STA. 11+00.1	EDGE LINE	4	WHITE	49.7
STA. 8+59.5 - STA. 11+00.1	EDGE LINE	4	WHITE	240.6
STA. 9+78.2 - STA. 9+98.4	STOP BAR	12	WHITE	22.0
STA. 7+30 - STA. 49+63	CENTERLINE (SKIP/DASH)	4	YELLOW	1058.3
STA. 7+23 - STA. 12+23	NO PASSING (EASTBOUND)	4	YELLOW	500.0
STA. 49+63 - STA. 54+63	NO PASSING (WESTBOUND)	4	YELLOW	500.0
STA. 49+63 - STA. 54+63	NO PASSING (EASTBOUND)	4	YELLOW	500.0

BILL OF MATERIALS

SHORT-TERM PAVEMENT MARKING	928 FOOT
WORK ZONE PAVEMENT MARKING REMOVAL	1312 SQ FT
TEMPORARY PAVEMENT MARKING - LINE 4"	2943 FOOT
TEMPORARY PAVEMENT MARKING - LINE 12"	22 FOOT
PAINT PAVEMENT MARKING - LINE 4"	2943 FOOT
PAINT PAVEMENT MARKING - LINE 12"	22 FOOT
RAISED REFLECTIVE PAVEMENT MARKERS	58 EACH

NOTE: SHORT-TERM PAVEMENT MARKING QUANTITIES BASED ON TWO APPLICATIONS.

RAISED REFLECTIVE PAVEMENT MARKERS

LOCATION	DESCRIPTION	QUANTITY
STA. 8+59.5 - STA. 54+63	TWO-WAY AMBER	58

PLOT DATE: 11.24.2009

	INITIALS	DATE
DESIGNED	R GEORGEN	SEPT 2008
CHECKED	T HOLDENER	DEC 2008
DRAWN	R GEORGEN	SEPT 2008
CHECKED	T HOLDENER	DEC 2008

PREPARED BY ST. CLAIR COUNTY HIGHWAY DEPARTMENT

FILE NAME: 00092-02-PV PVT STRIPING.dwg