

SCALE:
 1" = 20' HORIZ.
 1" = 1' VERT.

SECTION NO.	COUNTY HIGHWAY	COUNTY	SHEET OF SHEETS
06-00092-02-PV	22	ST. CLAIR	19 OF 63
FHWA REG.NO.7	ILLINOIS	ARA-5011(297)	
FEDERAL AID PROJECT		CONTRACT # 97415	

PROFILE VIEW - RIGHT SIDE

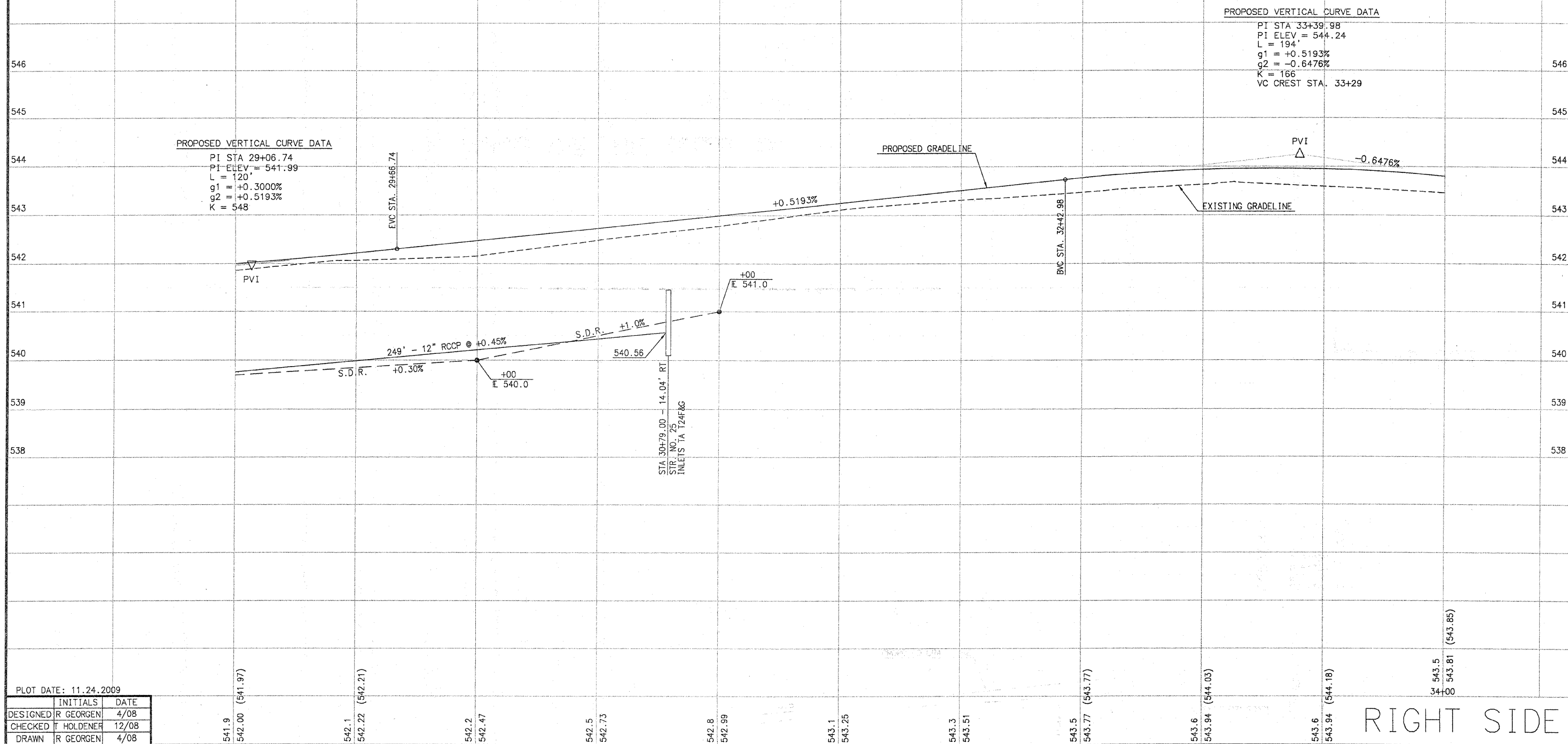

PROPOSED VERTICAL CURVE DATA

PI STA 29+06.74
 PI ELEV = 541.99
 L = 120'
 g1 = +0.3000%
 g2 = +0.5193%
 K = 548

PROPOSED VERTICAL CURVE DATA

PI STA 33+39.98
 PI ELEV = 544.24
 L = 194'
 g1 = +0.5193%
 g2 = -0.6476%
 K = 166
 VC CREST STA. 33+29

PLOT DATE: 11.24.2009

	INITIALS	DATE
DESIGNED	R GEORGEN	4/08
CHECKED	T HOLDENER	12/08
DRAWN	R GEORGEN	4/08
CHECKED	T HOLDENER	12/08

PREPARED BY ST. CLAIR COUNTY
 HIGHWAY DEPARTMENT

RIGHT SIDE