

FAU. ROUTE NO.	SECTION	ILLINOIS PROJECT	CONTRACT NO.	COUNTY	TOTAL SHEETS	SHEET NUMBER
VARIES	09-00161-00-SW	SRTS-4008(108)	87408	LASALLE	15	1

**STATE OF ILLINOIS**  
**DEPARTMENT OF TRANSPORTATION**  
 PLANS FOR  
**PROPOSED SAFE ROUTES TO SCHOOL SIDEWALK IMPROVEMENTS**

FUNDED BY  
**SAFE ROUTES TO SCHOOL PROGRAM**  
**CITY OF OTTAWA - VARIOUS LOCATIONS**  
 LASALLE COUNTY  
 SEC. NO. 09-00161-00-SW  
 PROJECT SRTS-4008(108)  
 JOB NO. C-40-028-08  
 IN COOPERATION WITH OTTAWA ELEMENTARY SCHOOL DISTRICT 141

**INDEX OF SHEETS**

- 1 COVER SHEET
- 2 SUMMARY OF QUANTITIES & DETAILS
- 3 SCHEDULES
- 4 PLAN & PROFILE - VIEW STREET (MCKINLEY SCHOOL)
- 5-6 PLAN & PROFILE - STATE STREET (MCKINLEY SCHOOL)
- 7 PLAN - SHEPHERD (E MCKINLEY RD) & CENTRAL (WOODWARD MEM DR) SCHOOLS
- 8 PLAN - MCKINLEY SCHOOL (W MCKINLEY RD)
- 9 PLAN - MCKINLEY (MCKINLEY RD) & LINCOLN (MADISON ST) SCHOOLS
- 10 PLAN - JEFFERSON SCHOOL (DELEON ST)
- 11-12 CROSS SECTIONS - VIEW STREET (MCKINLEY SCHOOL)
- 13-15 CROSS SECTIONS - STATE STREET (MCKINLEY SCHOOL)

**HIGHWAY STANDARDS**

- 424001-05 CURB RAMPS FOR SIDEWALKS
- 606001-04 CONCRETE CURB TYPE B AND COMBINATION CONCRETE CURB AND GUTTER
- 701301-03 LANE CLOSURE, 2L, 2W, SHORT TIME OPERATIONS
- 701501-05 URBAN LANE CLOSURE, 2L, 2W, UNDIVIDED
- 701901-01 TRAFFIC CONTROL DEVICES

**VICINITY MAP KEY**

- A - SHEPHERD SCHOOL
- B - MCKINLEY SCHOOL
- C - CENTRAL SCHOOL
- D - LINCOLN SCHOOL
- E - JEFFERSON SCHOOL

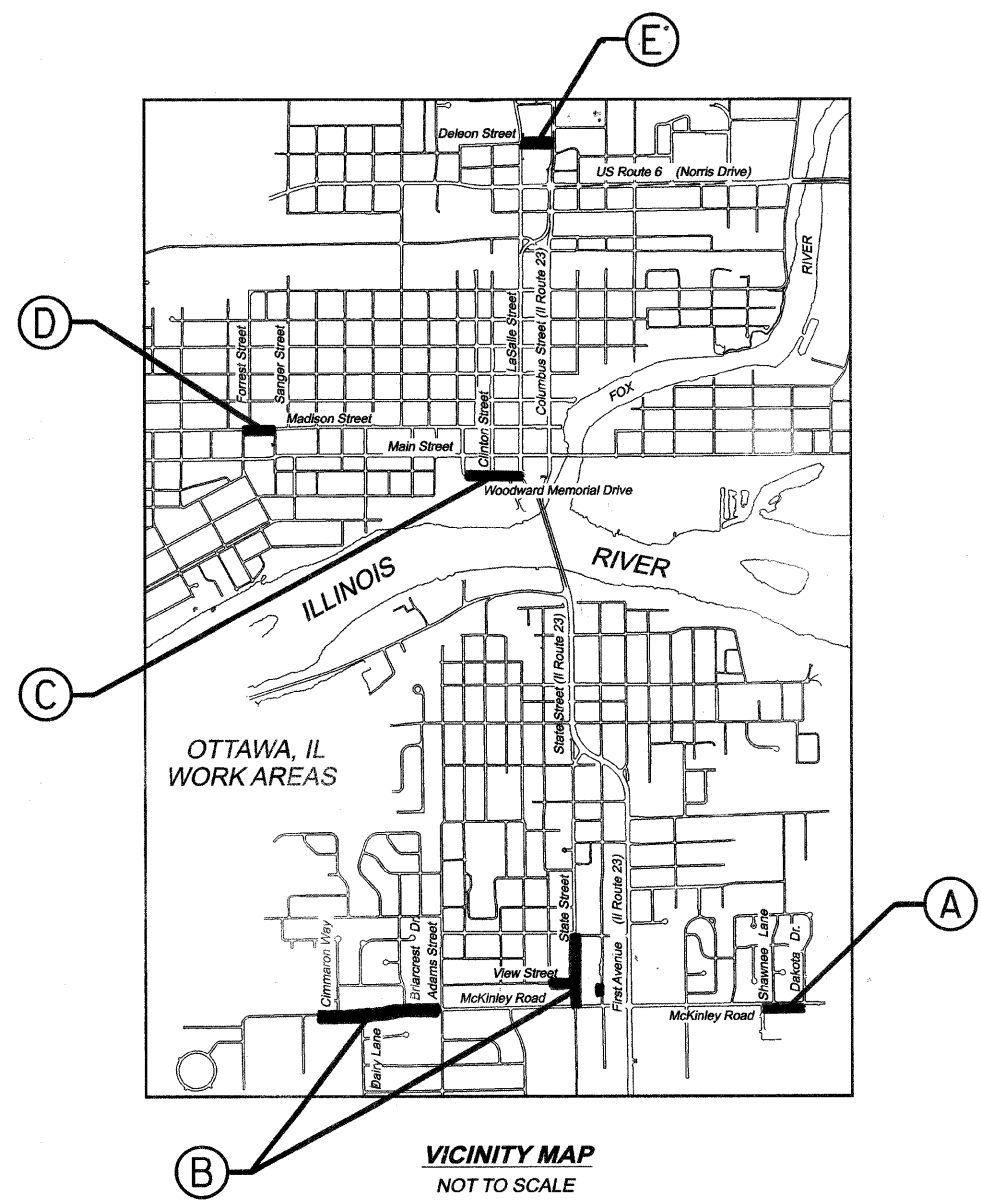
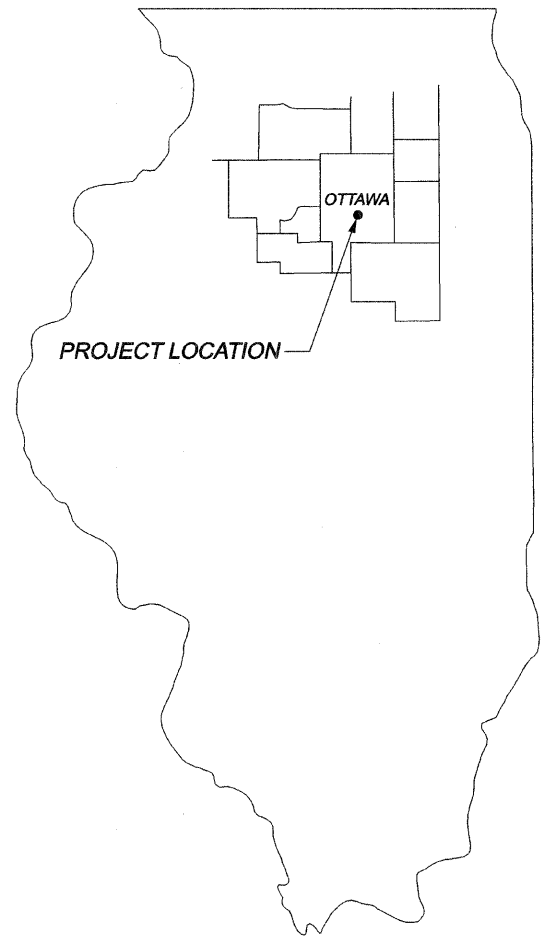

**SCALES**  
 VICINITY MAP: NOT TO SCALE  
 TYPICAL SECTIONS: NOT TO SCALE  
 PLAN SHEETS: 1" = 20' & 1" = 40'  
 PLAN / PROFILE SHEETS: HORIZ.: 1" = 20'  
 VERT.: 1" = 5'  
 CROSS SECTIONS: HORIZ.: 1" = 5'  
 VERT.: 1" = 2'

PREPARED BY:   
 DARRELL A. POUNDSTONE, P.E.  
 PROFESSIONAL ENGINEER NO. 62-052938  
 EXPIRES NOVEMBER, 2011  
 DATE: Dec. 21, 2009

**J.U.L.I.E. SYSTEM**  
 THE TOLL FREE TELEPHONE  
 NUMBER FOR JOINT UTILITY INFORMATION  
 FOR EXCAVATORS IS 1-800-892-0123

<b>RENWICK &amp; ASSOCIATES, INC.</b>  228 West Main Street Ottawa, Illinois 61350 TEL: 815-434-3200 FAX: 815-434-3968	APPROVED: Dec 21, 2009  MAYOR, CITY OF OTTAWA
	APPROVED: Dec 29, 2009  DISTRICT ENGINEER OF LOCAL ROADS & STREETS
PROFESSIONAL DESIGN FIRM # 184-004957 FILE NO. 09.2.1 DRAWN BY: RTF   CHECKED BY: DAP   DATE PLOTTED: DECEMBER 21, 2009 FILE PATH: C:/CITY OF OTTAWA/09.2.1-MCKINLEY SCHOOL/V8_09.2.3/COVER_09_2_1.DGN	APPROVED: Dec 29, 2009  DISTRICT ENGINEER

F.A.U. ROUTE NO.	SECTION	ILLINOIS PROJECT	CONTRACT NO.	COUNTY	TOTAL SHEETS	SHEET NUMBER
VARIES	09-00161-00-SW	SRTS-4008(108)	87408	LASALLE	16	2

**COMBINATION CONCRETE CURB & GUTTER REMOVAL & REPLACEMENT DETAIL**

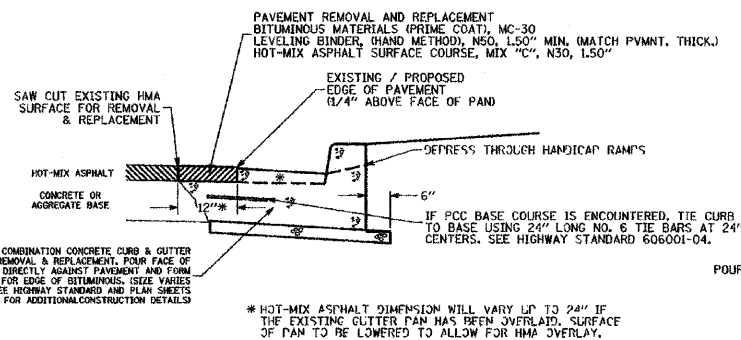

**ADJACENT TO HOT-MIX ASPHALT PAVEMENT SURFACE**  
NO SCALE

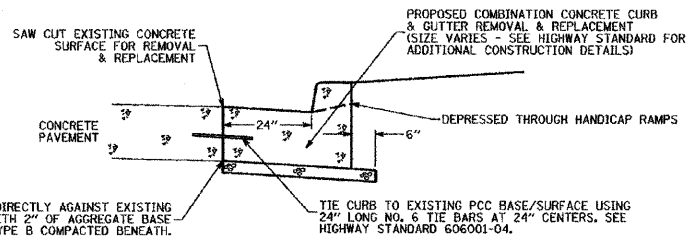

**ADJACENT TO PC CONCRETE SURFACE/BASE**  
NO SCALE

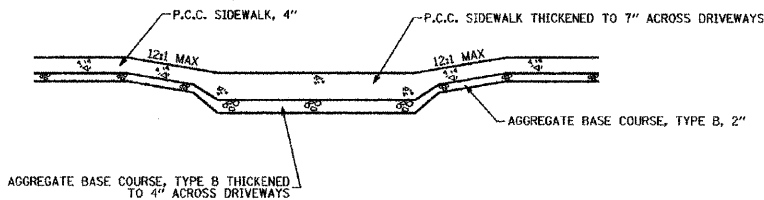

**TYPICAL DRIVEWAY SECTION**  
NO SCALE

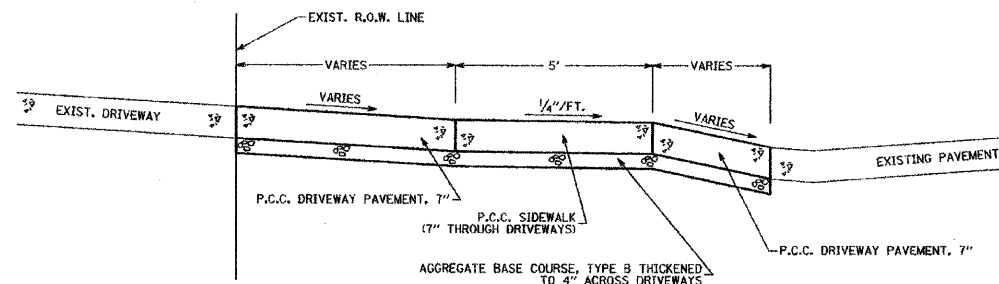

**TYPICAL DRIVEWAY SECTION**  
NO SCALE

**SUMMARY OF QUANTITIES**

PAY ITEM NUMBER	PAY ITEM	UNIT	QUANTITY
20100110	TREE REMOVAL (6 TO 15 UNITS DIAMETER)	UNIT	12
* 20100210	TREE REMOVAL (OVER 15 UNITS DIAMETER)	UNIT	18
* 21101505	TOPSOIL EXCAVATION AND PLACEMENT	CUBIC YARD	420
25000110	SEEDING, CLASS 1A	ACRE	0.18
25000400	NITROGEN FERTILIZER NUTRIENT	POUND	16
25000500	PHOSPHORUS FERTILIZER NUTRIENT	POUND	16
25000600	POTASSIUM FERTILIZER NUTRIENT	POUND	16
25100630	EROSION CONTROL BLANKET	SQUARE YARD	897
35101400	AGGREGATE BASE COURSE, TYPE B	TON	348
42300300	PORTLAND CEMENT CONCRETE DRIVEWAY PAVEMENT, 7 INCH	SQUARE YARD	255
* 42400100	PORTLAND CEMENT CONCRETE SIDEWALK 4 IN	SQUARE FOOT	21,893
* 42400600	DETECTABLE WARNINGS	SQUARE FOOT	144
* 44000200	DRIVEWAY PAVEMENT REMOVAL	SQUARE YARD	255
* 44000600	SIDEWALK REMOVAL	SQUARE FOOT	6,398
* 50900500	ALUMINUM RAILING	FOOT	43
67100100	MOBILIZATION	LUMP SUM	1
70102640	TRAFFIC CONTROL AND PROTECTION, STANDARD 701001	LUMP SUM	1
* 20826300	PAVEMENT REMOVAL AND REPLACEMENT	SQUARE YARD	16
44001700	COMBINATION CONCRETE CURB AND GUTTER REMOVAL AND REPLACEMENT	FOOT	274

\* SEE SPECIAL PROVISIONS

**HMA MIX DESIGN**

	HMA LEVEL BINDER	HMA SURFACE < 5,000 ADT
PG Grade	PG64-22	PG56-22
Design Air Voids	4.0% @ NSO	3.0% @ NSO
Mixture Composition	IL 9.5	IL 9.5L
Friction Aggregate		Mixture C
Density Test Method	Satisfaction of Engineer	Nuclear/ Cores

**LEGEND**

- ROAD CENTERLINE
- R.O.W. LINE
- WATER VALVE
- FIRE HYDRANT
- MARHOLE
- CONCRETE SURFACE
- GRAVEL SURFACE
- DECIDUOUS TREE
- EVERGREEN TREE
- SGH
- POWER POLE
- GUIDE WIRE
- BENCHMARK IDENTIFICATION

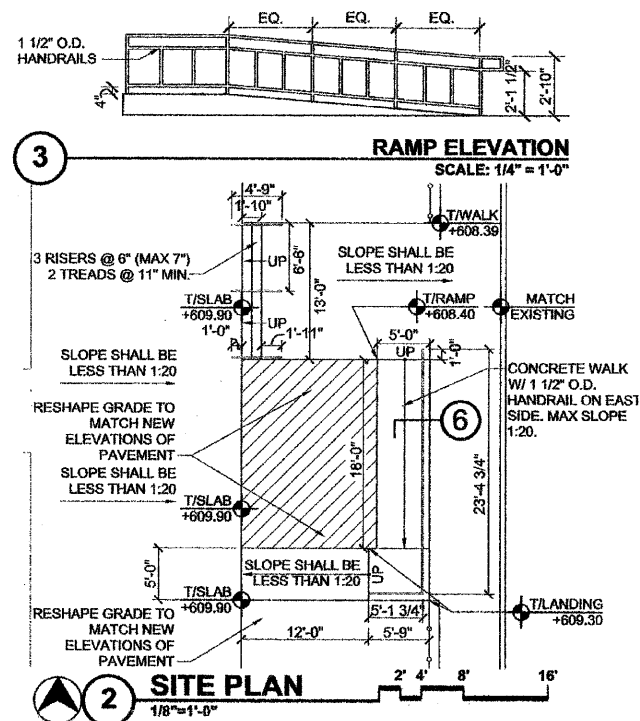
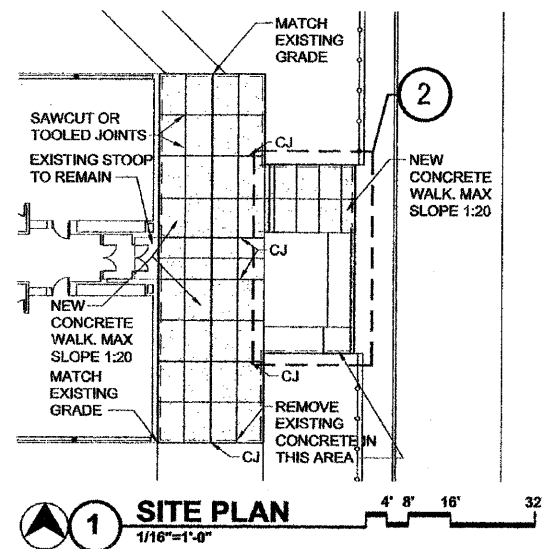

**REINFORCING AND WWF**

ASTM A706  
ASTM A185 WWF  
REINFORCING AND WWF TO BE EPOXY COATED ASTM A775

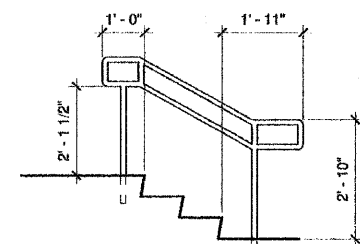

**5**

**HANDRAIL ELEVATION**  
1/2" = 1'-0"

**4**

**STAIR DETAIL**  
1/2" = 1'-0"

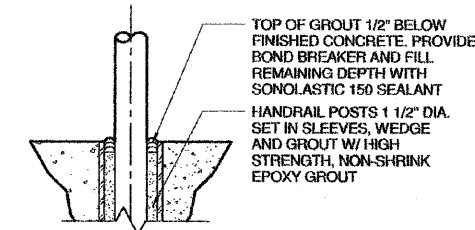

**7**

**HANDRAIL DETAIL**  
3" = 1'-0"

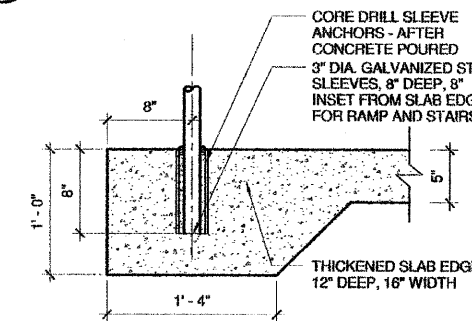

**6**

**HANDRAIL DETAIL**  
1 1/2" = 1'-0"

**MCKINLEY SCHOOL - EAST ENTRANCE IMPROVEMENT DETAILS**

THE ABOVE DETAILS PROVIDED BY GREEN ASSOCIATES PER THE DIRECTION OF THE OTTAWA ELEMENTARY SCHOOL BOARD.

**SUMMARY OF QUANTITIES AND DETAILS**  
SAFE ROUTES TO SCHOOLS SIDEWALK IMPROVEMENTS

**RENWICK & ASSOCIATES, INC.**

228 West Main Street  
Ottawa, Illinois 61350  
TEL: 815-434-3200  
FAX: 815-434-3968

PROFESSIONAL DESIGN FIRM # 184-004957 FILE NO. 09.2.1  
DRAWN BY: RTF CHECKED BY: DAF DATE PLOTTED: DECEMBER 21, 2009  
FILE PATH: C:\CITY OF OTTAWA\09.2.1-MCKIN SCHOOL\DETAIL SHEET.DGN

FAU. ROUTE NO.	SECTION	ILLINOIS PROJECT	CONTRACT NO.	COUNTY	TOTAL SHEETS	SHEET NUMBER
VARIES	09-00161-00-SW	SRTS-4008(108)	87408	LASALLE	15	3

	CURB & GUTTER REMOVAL & REPLACEMENT (FOOT)	SIDEWALK REMOVAL (SQUARE FOOT)	DRIVEWAY PAVEMENT REMOVAL (SQUARE YARD)	TOPSOIL EXCAVATION & PLACEMENT (CUBIC YARD)	AGGREGATE BASE COURSE, TYPE B, 2" (TON)	AGGREGATE BASE COURSE, TYPE B, 4" (TON)	PCC SIDEWALK, 4" (SQUARE FOOT)	ALUMINUM RAILING (FOOT)	PCC DRIVEWAY PAVEMENT, 7" (SQUARE YARD)	PAVEMENT REMOVAL & REPLACEMENT (SQUARE YARD)	DETECTABLE WARNING (SQUARE FOOT)	SEEDING, FERTILIZER & EROSION CONTROL BLANKET (SQUARE YARD)	TREE REMOVAL (6-15 UNIT DIAMETER) (UNIT)	TREE REMOVAL (OVER 15 UNIT DIAMETER) (UNIT)
<b>MCKINLEY SCHOOL (STATE STREET)</b> STA. 5+57 - LT. STA. 5+92 TO STA. 10+00 - LT. STA. 5+98 - LT. STA. 6+39 - LT. STA. 7+10 - LT. STA. 7+71 - LT. STA. 8+50 - LT. STA. 9+47 - LT. STA. 10+00 TO STA. 12+04 - LT. STA. 10+12 - LT. STA. 10+30 - LT. STA. 10+87 - LT. STA. 11+61 - LT.	13.0 13.0	36.0 74.0	13.6 21.1 25.4 34.5	4.0 6.0 6.0 4.0 31.0 4.0 3.0 2.0 2.0	26.0 13.0		2035.0 9.0 1020.0		13.6 21.1 25.4 34.5 22.7 16.8 10.1 12.3		6 6	1.8 226.7 4.0 1.3 4.9 92.7 3.1 0.9		
<b>MCKINLEY SCHOOL (VIEW STREET)</b> STA. 20+50 TO STA. 23+37 - LT. STA. 20+50 TO STA. 22+13 - RT. STA. 20+53 - RT. STA. 20+53 - LT. STA. 21+21 - RT. STA. 21+23 - LT. STA. 21+67 - LT. STA. 22+10 - RT. STA. 22+43 TO STA. 23+44 - RT. STA. 22+46 - RT. STA. 22+50 - LT. STA. 22+96 - LT.	10.0 10.0 11.0 12.0		29.9 20.9 44.7	33.0 19.0 9.0 3.0 14.0 12.0	18.0 4.0 6.0		1455.0 834.0 504.0		29.9 20.9 44.7		6 6 6 6	80.6 47.5 12.0 3.0 10.3	12 18	
<b>MCKINLEY SCHOOL (W. MCKINLEY RD.)</b> STA. 10+88.5 TO STA. 16+11.5 - LT. STA. 16+05 - LT. STA. 16+61 - LT. STA. 16+53 TO STA. 18+18 - LT. STA. 18+42 TO STA. 19+00 - LT. STA. 19+23 TO STA. 19+75 - LT. STA. 20+10 TO STA. 20+55 - LT. STA. 20+91 TO STA. 21+36 - LT. STA. 21+71 TO STA. 22+16 - LT. STA. 22+54 TO STA. 22+97 - LT. STA. 23+34 TO STA. 23+77 - LT. STA. 24+11 TO STA. 24+74 - LT. STA. 25+04 TO STA. 25+49 - LT. STA. 25+43 - LT. STA. 25+95 TO STA. 26+53 - LT. STA. 25+99 - LT. STA. 26+78 TO STA. 28+09 - LT. STA. 28+34 TO STA. 30+77 - LT. STA. 30+72 - LT.				50.0 15.0 5.0 5.0 4.0 4.0 4.0 4.0 4.0 4.0 6.0 4.0 12.0 12.0 24.0	34.0 10.0 4.0 3.0 3.0 3.0 3.0 3.0 3.0 3.0 4.0 3.0 8.0 8.0 17.0		2673.0 804.0 279.0 246.0 209.0 213.0 212.0 206.0 204.0 308.0 209.0 638.0 642.0 1310.0				12 6 6 6 6 6 6 6 6 6 6 6 6 6 6 6 6			
<b>MCKINLEY SCHOOL (STATE &amp; CATHERINE)</b> M1 M2 M3 M4 M5	60.0 15.0	23.0 23.0 45.0 75.0			0.3 0.3 0.6 0.9		23.0 23.0 45.0 75.0			1.7	6	1.0 1.0 2.0		
<b>MCKINLEY SCHOOL (East Entrance)</b>		2069.0		16.0	40.0		1839.0	43.0				71.0		
<b>LINCOLN SCHOOL</b> L1 L2 L3 L4 L5 L6 L7		295.0 265.0 631.0 495.0 70.0 200.0	3.3	3.7 3.4 8.0 6.3 0.9 2.5		0.8	295.0 265.0 631.0 495.0 70.0 200.0		3.3			23.6 40.0 35.1 6.2 8.9		
<b>SHEPHERD SCHOOL</b> S1 S2 S3 S4 S5 S6 S7 S8	10.0 10.0 20.0 10.0 10.0 10.0	160.0 29.0 41.0		8.0 22.0	5.4 2.0 15.1		430.0 160.0 1195.0 29.0 41.0		1.1 1.1 2.2 1.1 1.1 1.1		6 6 6 6 6 6	35.6 2.2 93.3 3.1 3.1		
<b>CENTRAL SCHOOL</b> C1 C2 C3 C4 C5 C6 C7 C8 C9 C10 C11		30.0 30.0 48.0 72.0 72.0 30.0 144.0 72.0 72.0 30.0 30.0		0.4 0.4 0.6 0.9 0.9 0.4 1.8 0.9 0.9 0.4 0.4			30.0 30.0 48.0 72.0 72.0 30.0 144.0 72.0 72.0 30.0 30.0					1.1 1.1 1.8 2.7 2.7 1.1 5.3 2.7 2.7 1.1 1.1		
<b>JEFFERSON SCHOOL</b> J1 J2 J3 J4 J5 J6 J7 J8 J9	9.0 13.0 10.0 18.0 10.0	550.0 50.0 108.0 126.0 50.0 50.0 261.0 42.0		7.0 0.6 1.4 1.6 0.6 0.6 3.3 0.5			550.0 50.0 108.0 126.0 50.0 50.0 261.0 42.0		2.8 1.4 1.1 1.1		6 6 6 6 6 6 6 6	45.3 4.4 1.3 1.3 4.4 2.2		
<b>TOTALS</b>	<b>274</b>	<b>6398</b>	<b>255</b>	<b>420</b>	<b>286.9</b>	<b>59</b>	<b>21693</b>	<b>43</b>	<b>255.3</b>	<b>15.9</b>	<b>144</b>	<b>897.3</b>	<b>12</b>	<b>18</b>

**SUMMARY OF QUANTITIES AND DETAILS**  
SAFE ROUTES TO SCHOOLS SIDEWALK IMPROVEMENTS

**RENWICK & ASSOCIATES, INC.**

228 West Main Street  
Ottawa, Illinois 61350  
TEL: 815-434-3200  
FAX: 815-434-3968



PROFESSIONAL DESIGN FIRM # 184-004857 | FILE NO. 09.2.1  
DRAWN BY: RTF | CHECKED BY: DAP | DATE PLOTTED: DECEMBER 21, 2009  
FILE PATH: C:\CITY OF OTTAWA\09.2.1-MCKIN SCHOOL\DETAIL SHEET.DGN

FAU. ROUTE NO.	SECTION	ILLINOIS PROJECT	CONTRACT NO.	COUNTY	TOTAL SHEETS	SHEET NUMBER
VARIES	09-00161-00-SW	SRTS-4008(108)	87408	LASALLE	15	4

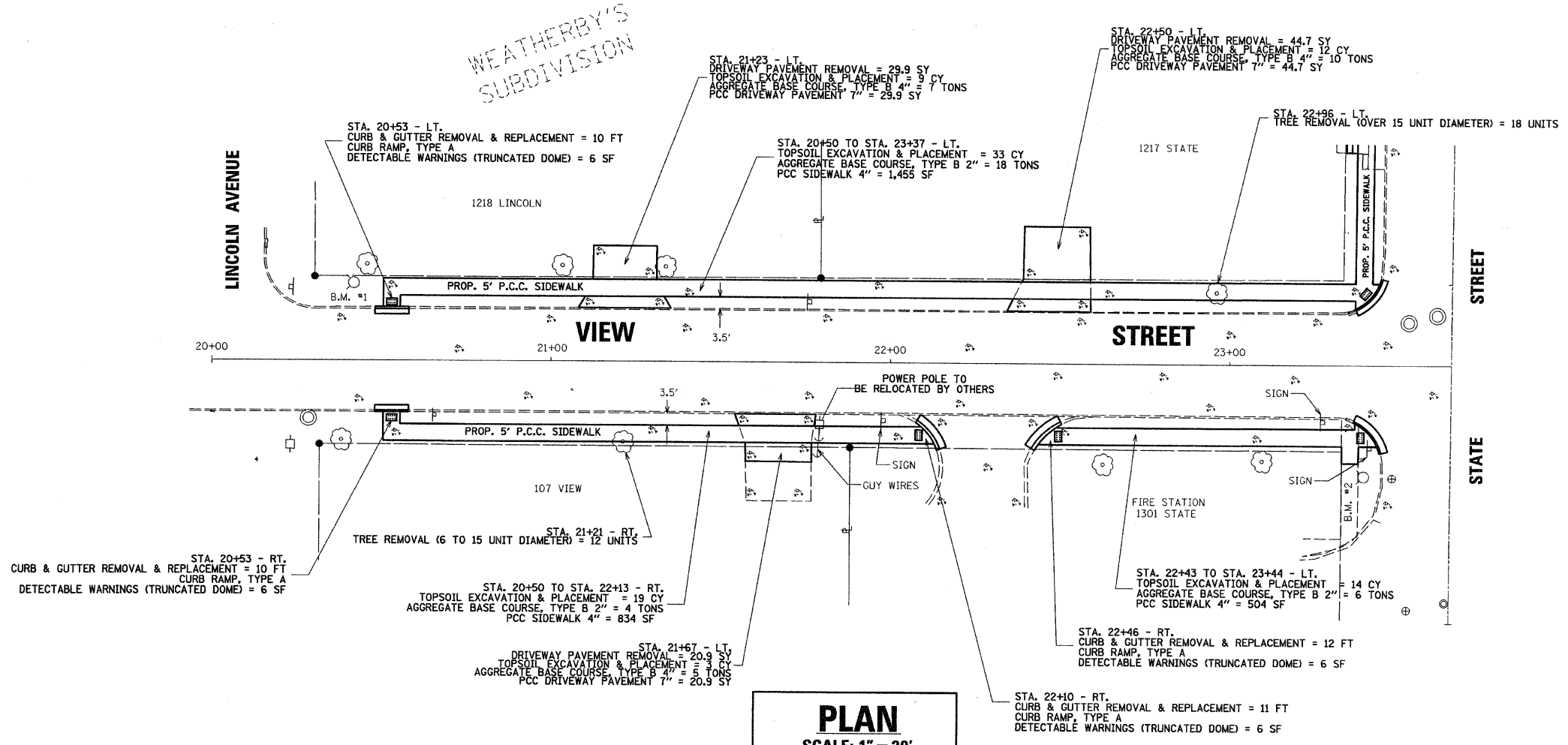

**PLAN**  
SCALE: 1" = 20'

**PROFILE**  
SCALES: HORIZ: 1" = 20'  
VERT: 1" = 2'



**BENCHMARK INFORMATION**

B.M. #1 - "M" IN MUELLER ON F.H. NE COR. LINCOLN & VIEW STA. 20+42 - 22.7' LT. ELEV. = 611.61

B.M. #2 - "O" IN OPEN ON F.H. SW COR. STATE & VIEW STA. 23+40 - 32.9' RT. ELEV. = 610.61

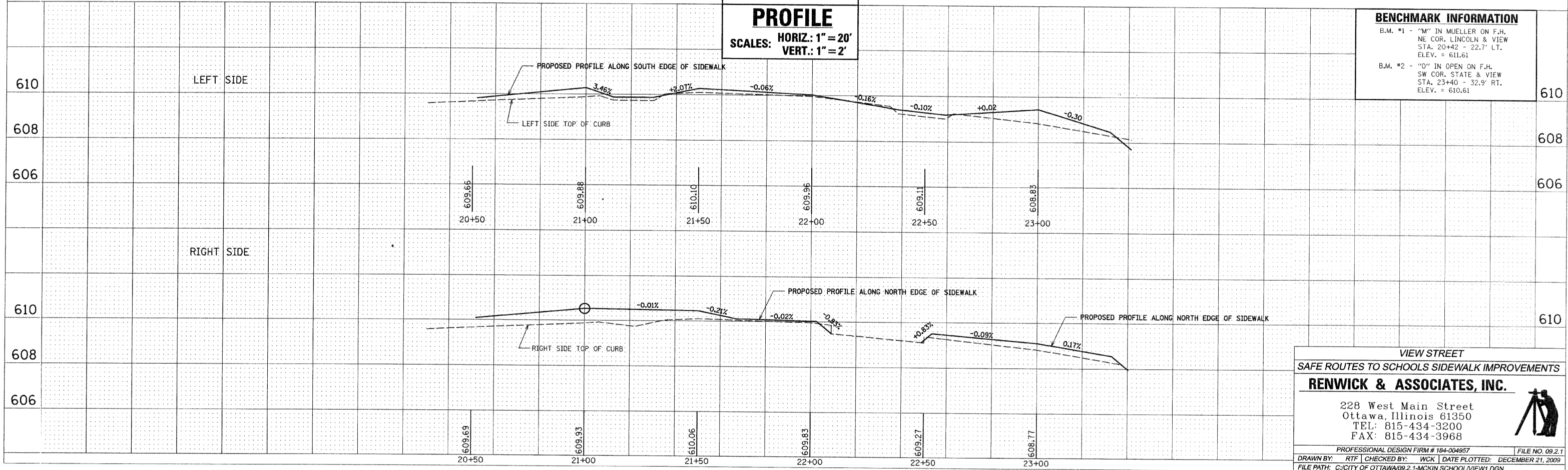

VIEW STREET  
SAFE ROUTES TO SCHOOLS SIDEWALK IMPROVEMENTS

**RENWICK & ASSOCIATES, INC.**

228 West Main Street  
Ottawa, Illinois 61350  
TEL: 815-434-3200  
FAX: 815-434-3968

PROFESSIONAL DESIGN FIRM # 184-004957 FILE NO. 09.2.1  
DRAWN BY: RTF CHECKED BY: WCK DATE PLOTTED: DECEMBER 21, 2009  
FILE PATH: C:\CITY OF OTTAWA\09.2.1-MCKIN SCHOOL\VIEW1.DGN

FA.U. ROUTE NO.	SECTION	ILLINOIS PROJECT	CONTRACT NO.	COUNTY	TOTAL SHEETS	SHEET NUMBER
VARIES	09-00161-00-SW	SRTS-4008(108)	87408	LASALLE	15	5

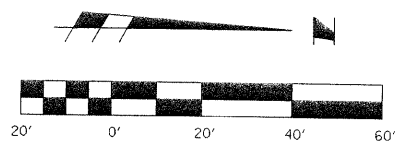
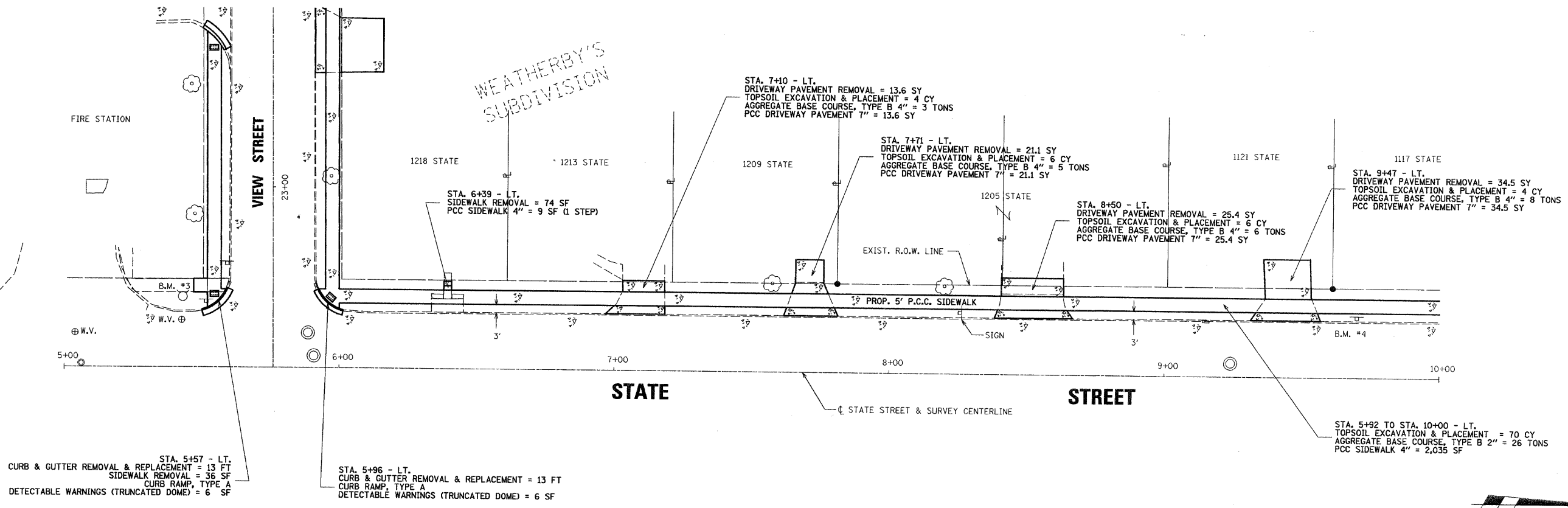

**PLAN**  
SCALE: 1" = 20'

**PROFILE**  
SCALES: HORIZ.: 1" = 20'  
VERT.: 1" = 2'

**BENCHMARK INFORMATION**

B.M. #3 - "0" IN OPEN ON F.H.  
SW COR. STATE & VIEW  
STA. 23+40 - 32.9' RT.  
ELEV. = 610.61

B.M. #4 - R.R.S. IN POWER POLE  
STA. 9+70 - 21.7' LT.  
ELEV. = 606.23

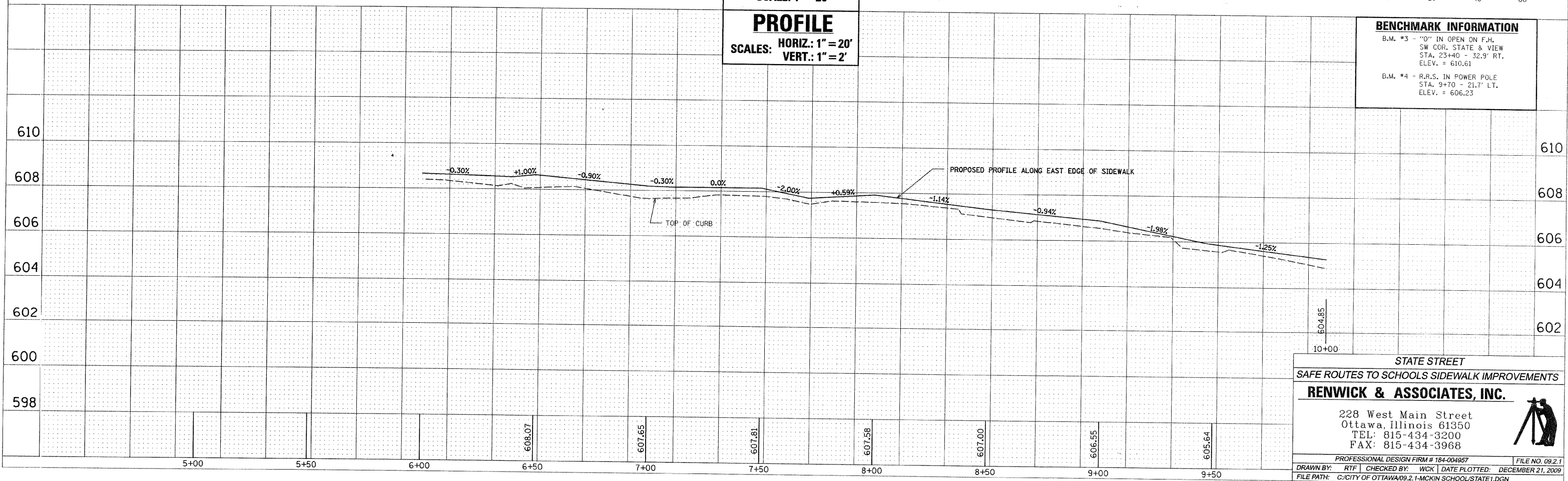

STATE STREET  
SAFE ROUTES TO SCHOOLS SIDEWALK IMPROVEMENTS

**RENWICK & ASSOCIATES, INC.**

228 West Main Street  
Ottawa, Illinois 61350  
TEL: 815-434-3200  
FAX: 815-434-3968

PROFESSIONAL DESIGN FIRM # 184-004957 FILE NO. 09.2.1  
DRAWN BY: RTF CHECKED BY: WCK DATE PLOTTED: DECEMBER 21, 2009  
FILE PATH: C:\CITY OF OTTAWA\09.2.1-MCKIN SCHOOLS\STATE1.DGN

FA.U. ROUTE NO.	SECTION	ILLINOIS PROJECT	CONTRACT NO.	COUNTY	TOTAL SHEETS	SHEET NUMBER
VARIES	09-00161-00-SW	SRTS-4008(108)	87408	LASALLE	15	6

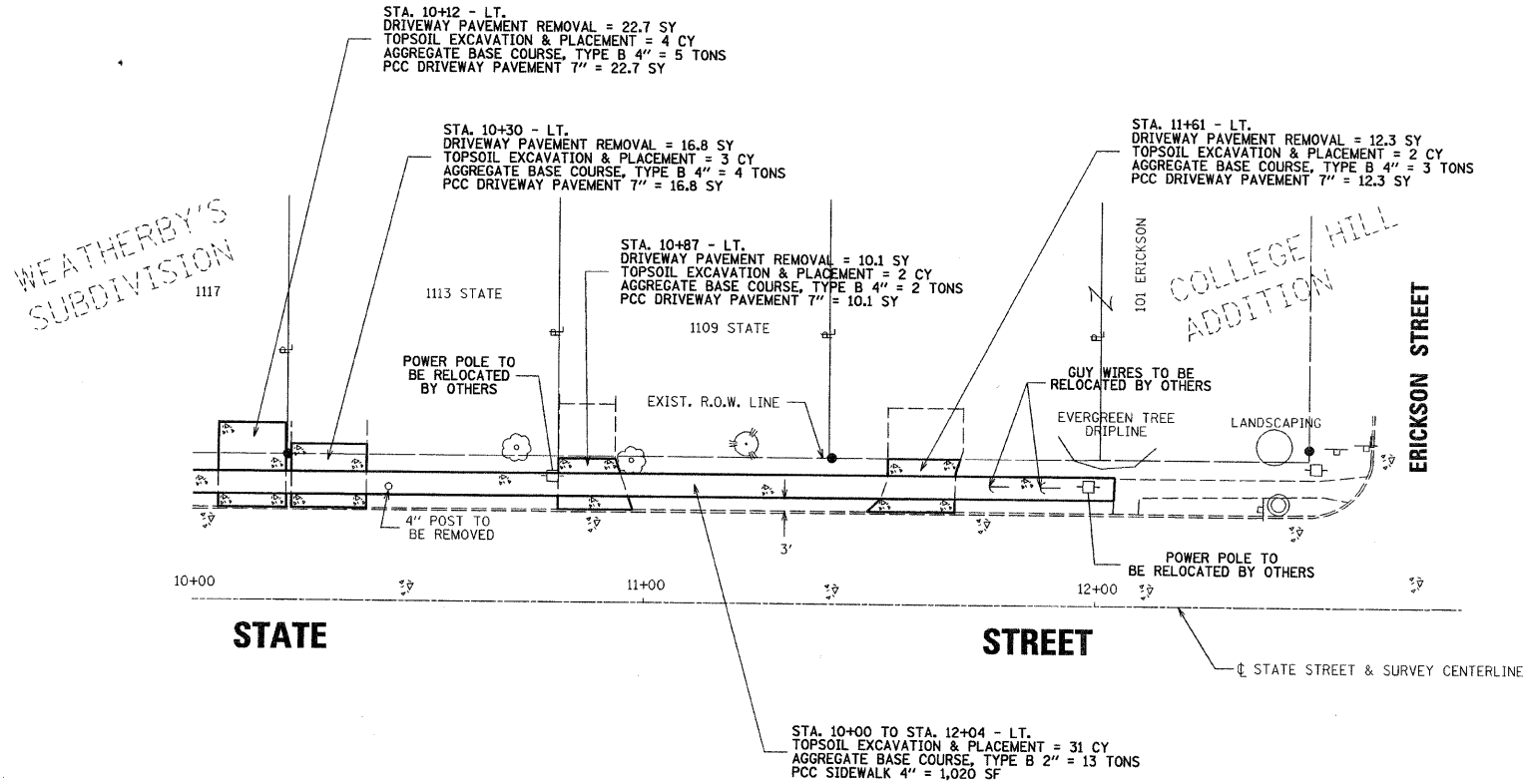

**PLAN**  
SCALE: 1" = 20'

**PROFILE**  
SCALES: HORIZ.: 1" = 20'  
VERT.: 1" = 2'

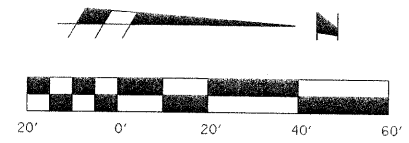

**BENCHMARK INFORMATION**  
B.M. #5 - "M" IN MUELLER ON F.H.  
NE COR. STATE & ERICKSON  
ELEV. = 603.19

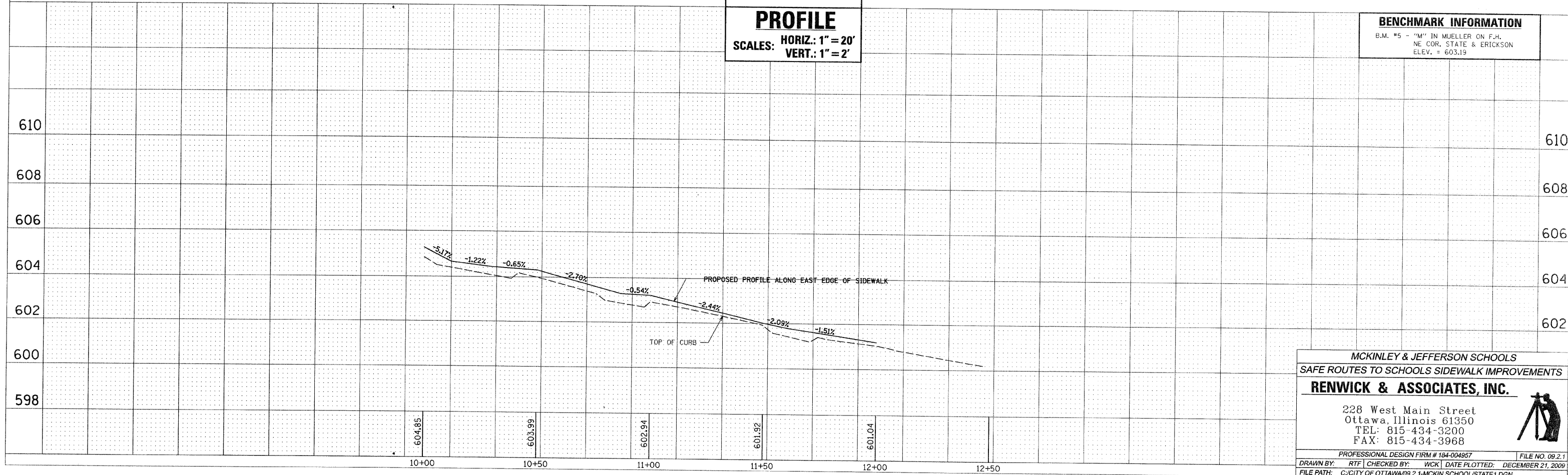

MCKINLEY & JEFFERSON SCHOOLS  
SAFE ROUTES TO SCHOOLS SIDEWALK IMPROVEMENTS  
**RENWICK & ASSOCIATES, INC.**

228 West Main Street  
Ottawa, Illinois 61350  
TEL: 815-434-3200  
FAX: 815-434-3968

F.A.U. ROUTE NO.	SECTION	ILLINOIS PROJECT	CONTRACT NO.	COUNTY	TOTAL SHEETS	SHEET NUMBER
VARIES	09-00161-00-SW	SRTS-4008(108)	87408	LASALLE	15	7

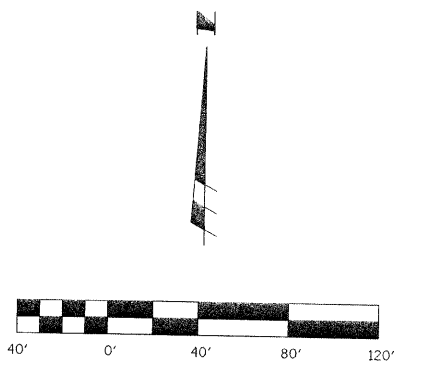
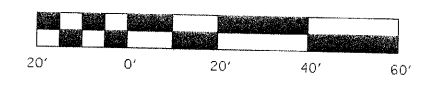
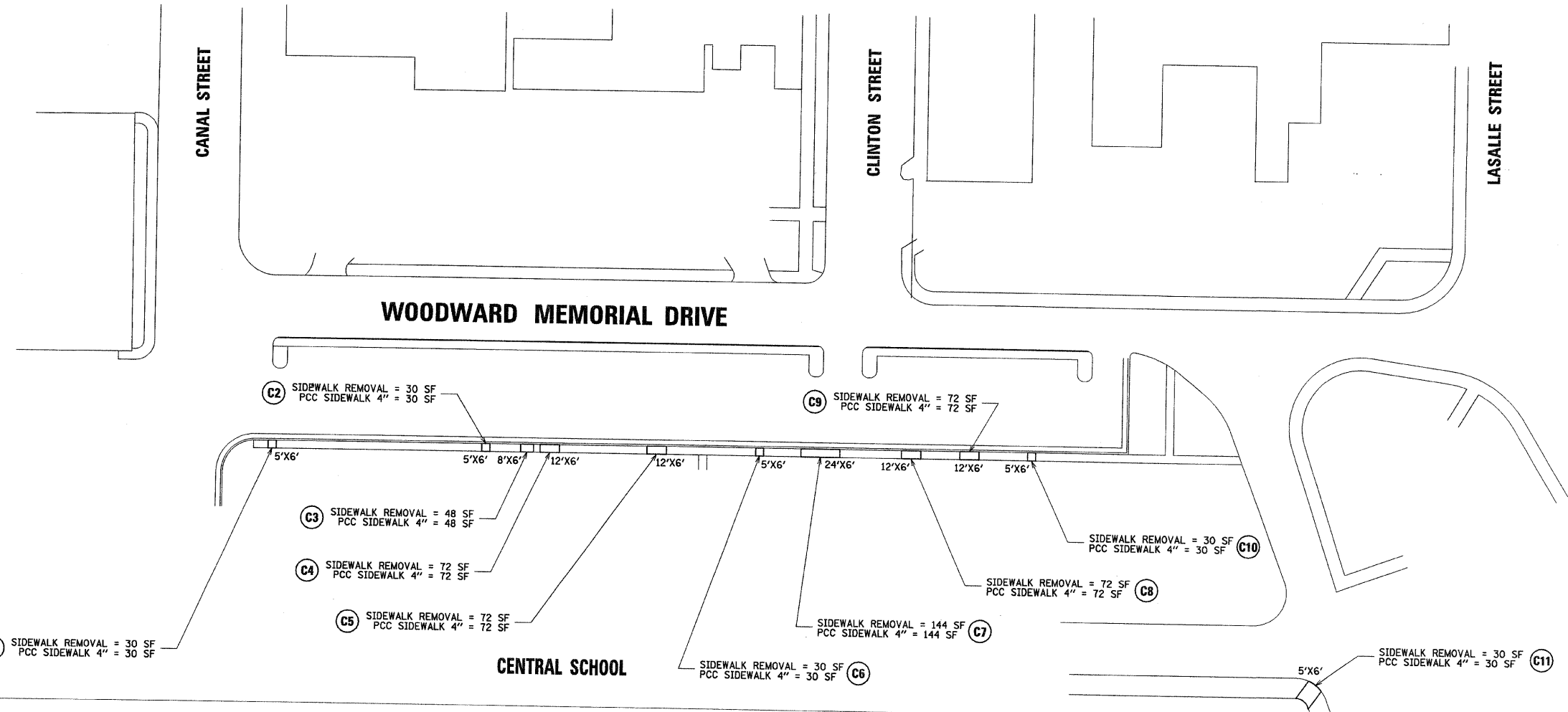
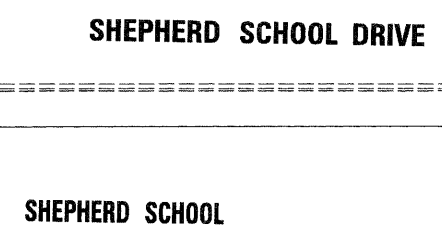
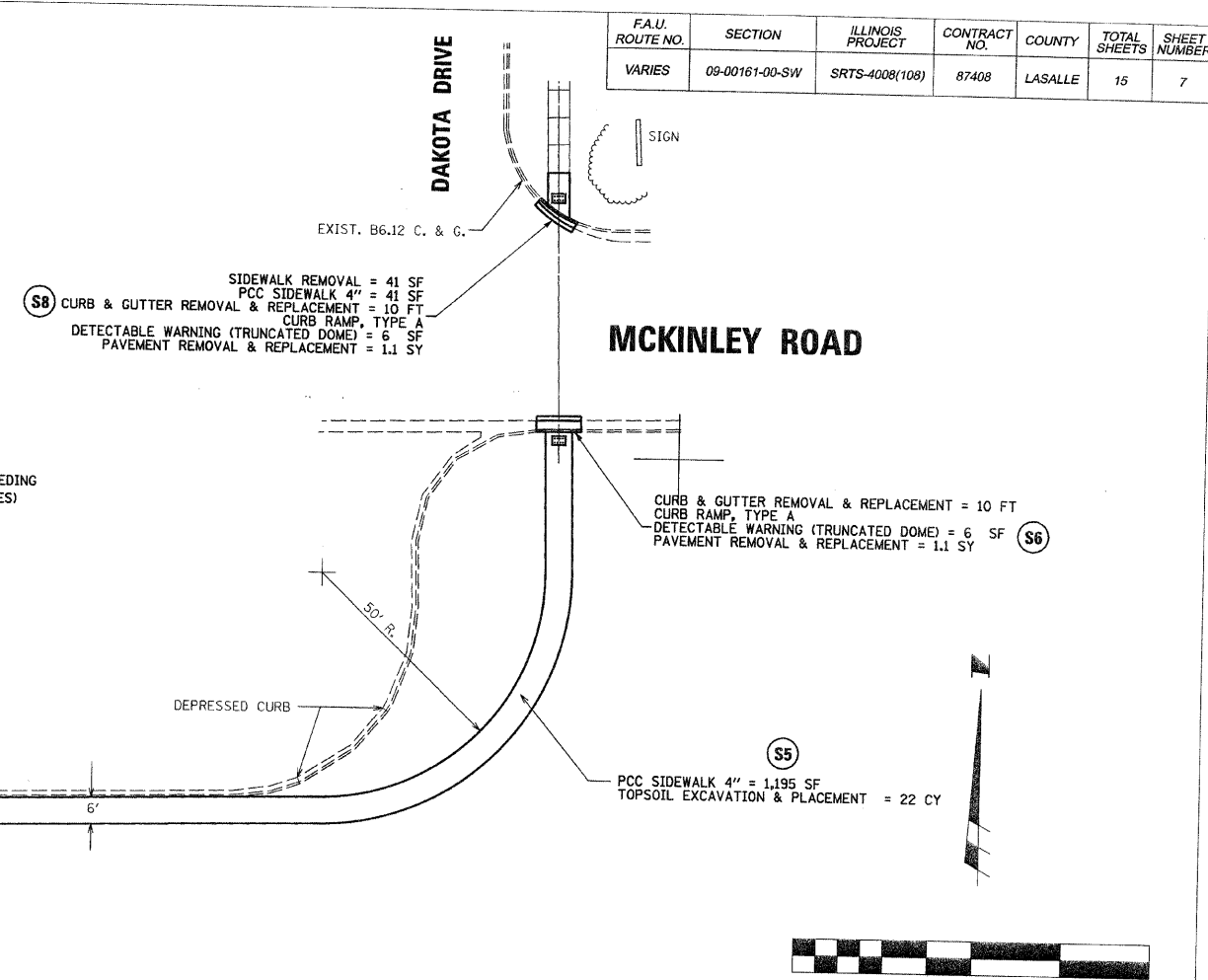
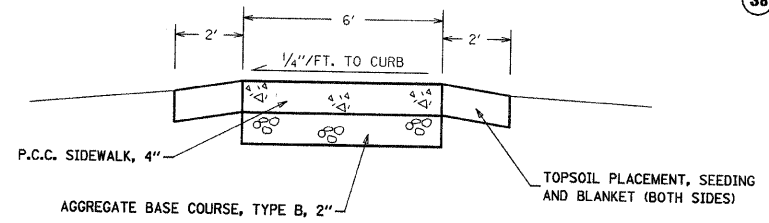
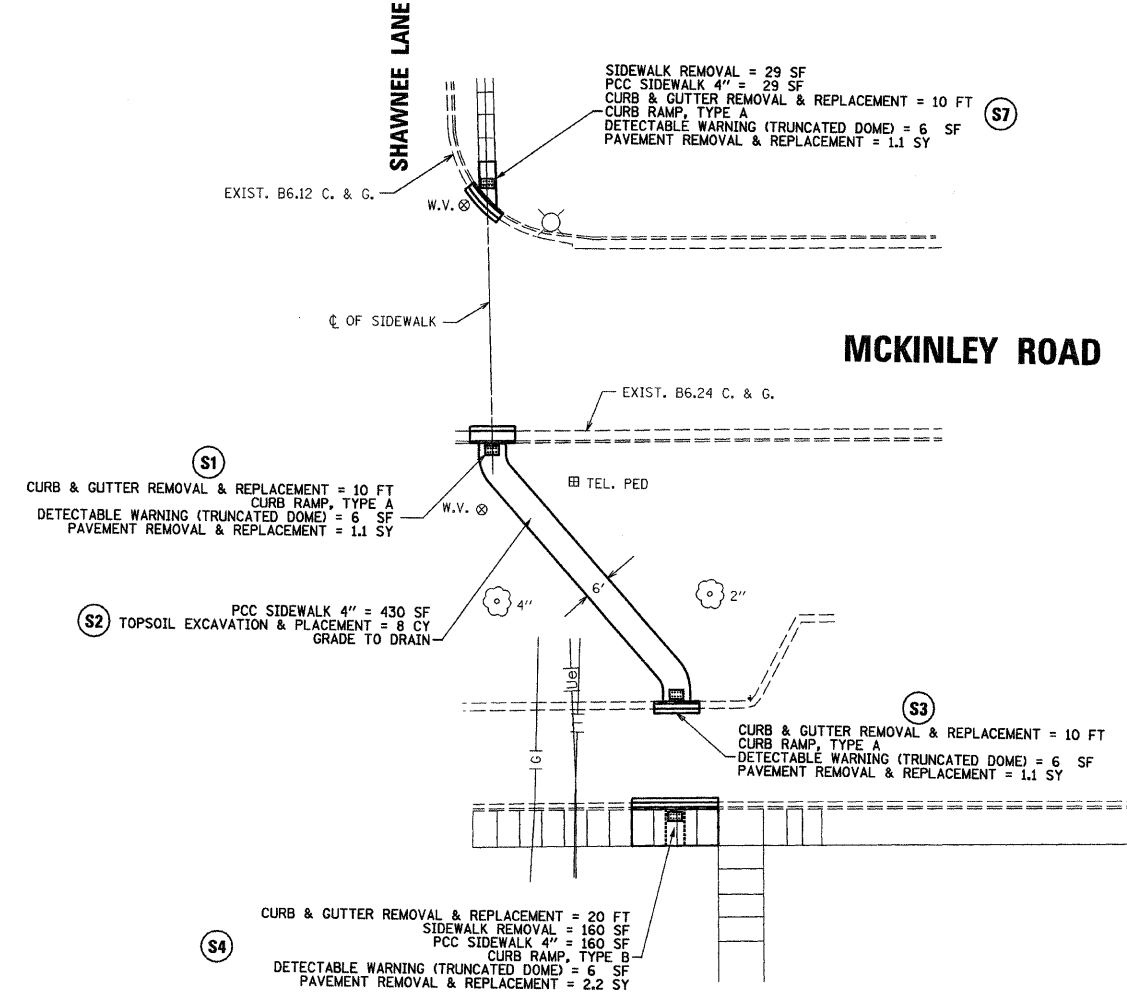

**SHEPHERD & CENTRAL SCHOOLS**  
**SAFE ROUTES TO SCHOOLS SIDEWALK IMPROVEMENTS**

**RENWICK & ASSOCIATES, INC.**

228 West Main Street  
Ottawa, Illinois 61350  
TEL: 815-434-3200  
FAX: 815-434-3968

PROFESSIONAL DESIGN FIRM # 184-004957 FILE NO. 09.2.1  
DRAWN BY: RTF | CHECKED BY: DAP | DATE PLOTTED: DECEMBER 21, 2009  
FILE PATH: C:\CITY OF OTTAWA\09.2.1-MCKIN SCHOOL\09.2.1-SHEP\_PLAN.DGN

FAU. ROUTE NO.	SECTION	ILLINOIS PROJECT	CONTRACT NO.	COUNTY	TOTAL SHEETS	SHEET NUMBER
VARIES	09-00161-00-SW	SRTS-4008(108)	87408	LASALLE	15	8

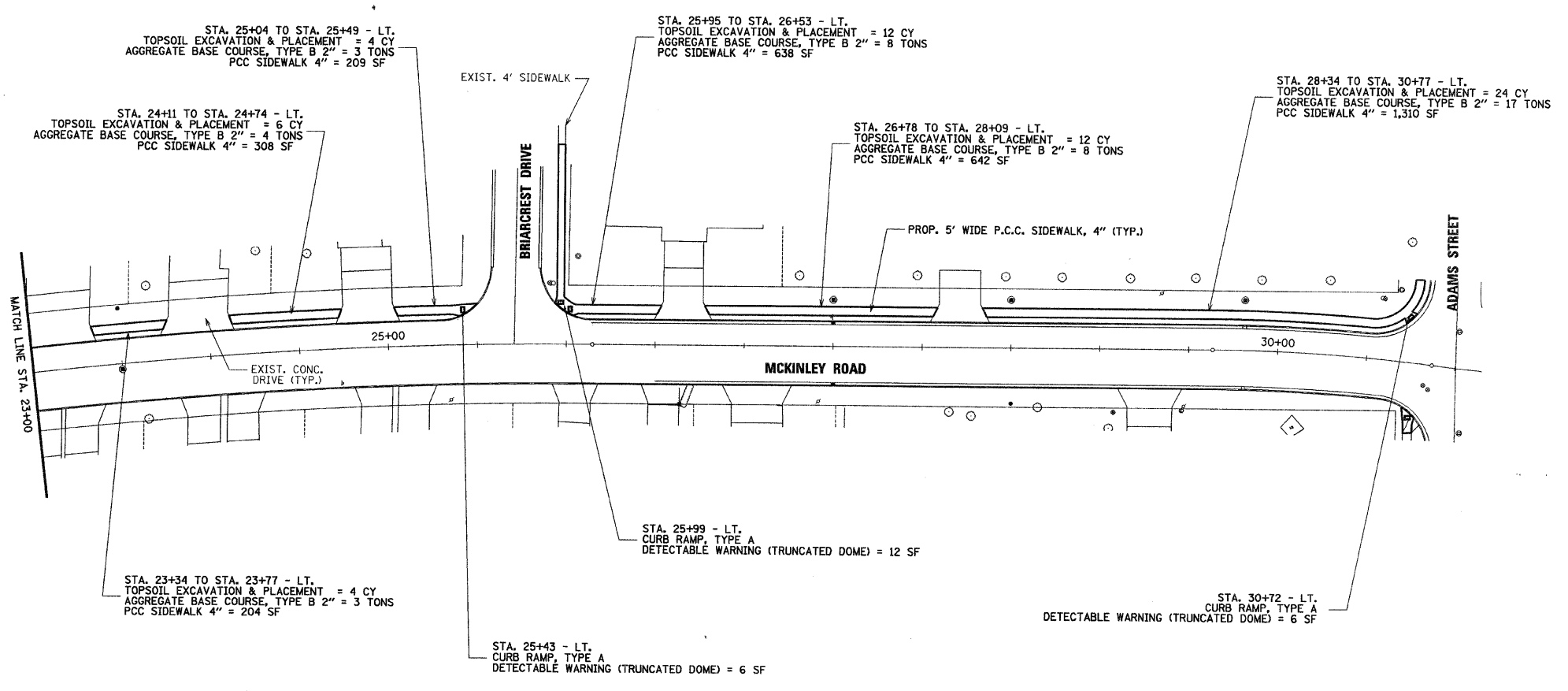
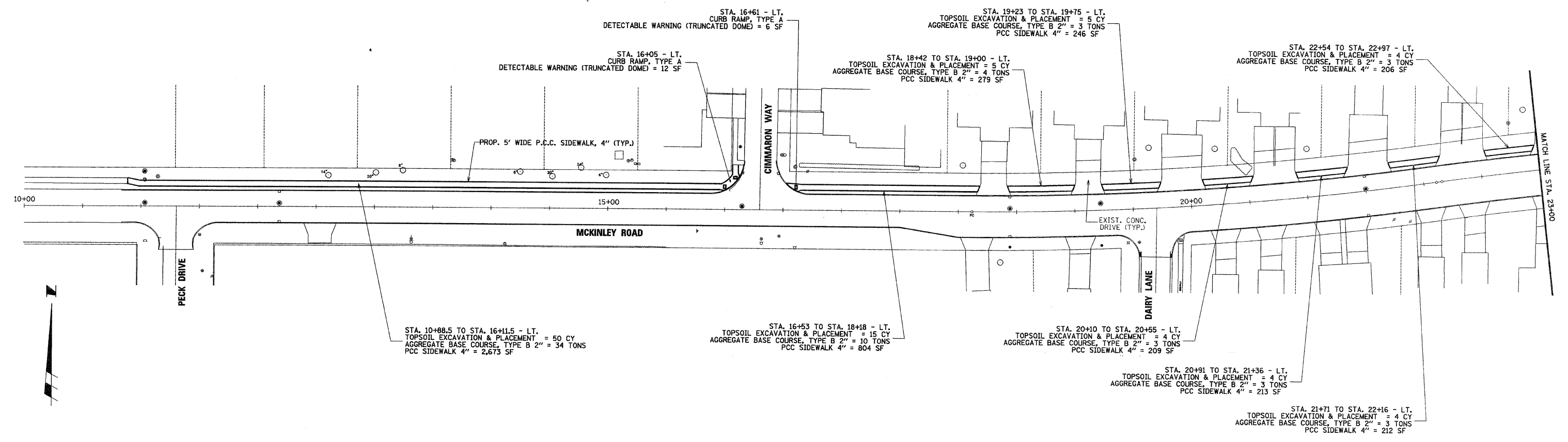

**WEST MCKINLEY ROAD**  
**SAFE ROUTES TO SCHOOLS SIDEWALK IMPROVEMENTS**  
**RENWICK & ASSOCIATES, INC.**

228 West Main Street  
Ottawa, Illinois 61350  
TEL: 815-434-3200  
FAX: 815-434-3968

PROFESSIONAL DESIGN FIRM # 184-004957 | FILE NO. 09.2.1  
DRAWN BY: RTF | CHECKED BY: WCK | DATE PLOTTED: DECEMBER 21, 2009  
FILE PATH: C:\CITY OF OTTAWA\09.2.1-MCKIN SCHOOL\09.2.1\_MCKIN\_SHT.DGN





FAU. ROUTE NO.	SECTION	ILLINOIS PROJECT	CONTRACT NO.	COUNTY	TOTAL SHEETS	SHEET NUMBER
VARIES	09-00161-00-SW	SRTS-4008(107)	87408	LASALLE	15	9

**STATE STREET**

MCKINLEY ROAD

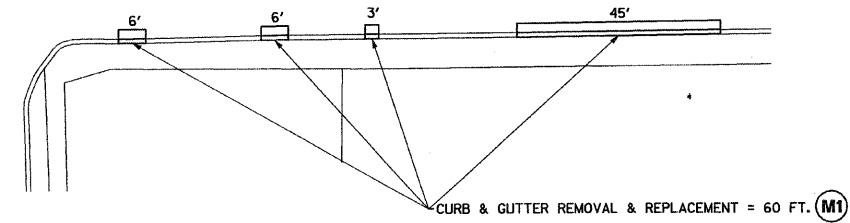

MCKINLEY SCHOOL

MCKINLEY ROAD

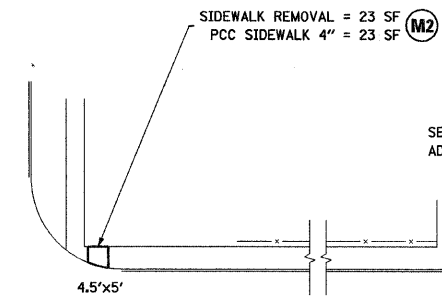

SEE DETAIL SHEET 2 FOR ADDITIONAL INFORMATION

CATHERINE STREET

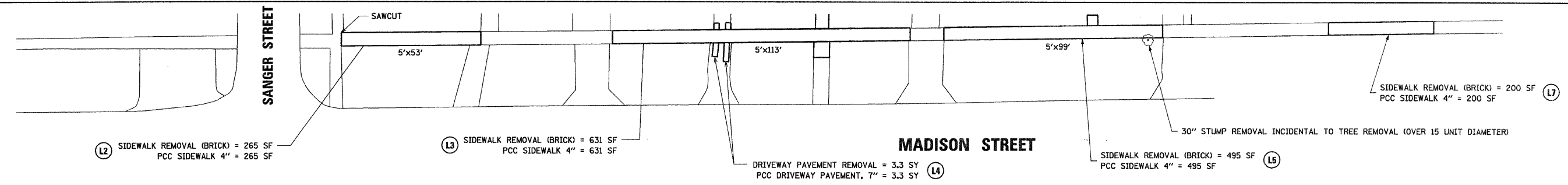
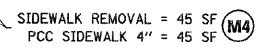
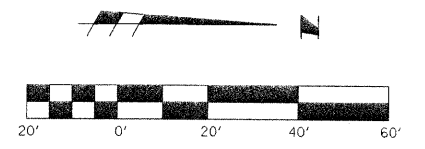
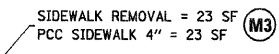
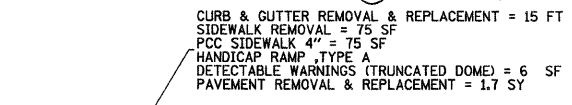

(L2) SIDEWALK REMOVAL (BRICK) = 265 SF  
PCC SIDEWALK 4" = 265 SF

(L3) SIDEWALK REMOVAL (BRICK) = 631 SF  
PCC SIDEWALK 4" = 631 SF

DRIVEWAY PAVEMENT REMOVAL = 3.3 SY  
PCC DRIVEWAY PAVEMENT, 7" = 3.3 SY (L4)

SIDEWALK REMOVAL (BRICK) = 495 SF  
PCC SIDEWALK 4" = 495 SF (L5)

SIDEWALK REMOVAL (BRICK) = 200 SF  
PCC SIDEWALK 4" = 200 SF (L7)

(L1) SIDEWALK REMOVAL = 295 SF  
PCC SIDEWALK 4" = 295 SF

LELAND STREET

LINCOLN SCHOOL

HARDIN STREET

(L6) SIDEWALK REMOVAL = 70 SF  
PCC SIDEWALK 4" = 70 SF

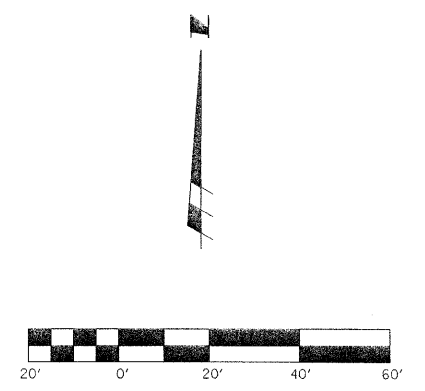

**MCKINLEY & LINCOLN SCHOOLS**  
SAFE ROUTES TO SCHOOLS SIDEWALK IMPROVEMENTS

**RENWICK & ASSOCIATES, INC.**

228 West Main Street  
Ottawa, Illinois 61350  
TEL: 815-434-3200  
FAX: 815-434-3968

PROFESSIONAL DESIGN FIRM # 184-004957 FILE NO. 09.2.1  
DRAWN BY: RTF CHECKED BY: WCK DATE PLOTTED: DECEMBER 21, 2009  
FILE PATH: C:\CITY OF OTTAWA\09.2.1-MCKIN SCHOOL\09\_2\_1\_STATE\_MCKIN.DGN

FA.U. ROUTE NO.	SECTION	ILLINOIS PROJECT	CONTRACT NO.	COUNTY	TOTAL SHEETS	SHEET NUMBER
VARIES	09-00161-00-SW	SRTS-4008(108)	87408	LASALLE	15	10

**J1**  
 SIDEWALK REMOVAL (BRICK) = 550 SF  
 PCC SIDEWALK 4" = 550 SF  
 HANDICAP RAMP, TYPE A  
 DETECTABLE WARNINGS (TRUNCATED DOME) = 6 SF  
 CURB & GUTTER REMOVAL & REPLACEMENT = 9 FT  
 PAVEMENT REMOVAL & REPLACEMENT = 2.8 SY

**J9**  
 SIDEWALK REMOVAL = 42 SF  
 PCC SIDEWALK 4" = 42 SF  
 HANDICAP RAMP, TYPE A  
 DETECTABLE WARNINGS (TRUNCATED DOME) = 6 SF  
 CURB & GUTTER REMOVAL & REPLACEMENT = 10 FT  
 PAVEMENT REMOVAL & REPLACEMENT = 1.1 SY

SIDEWALK REMOVAL = 126 SF  
 PCC SIDEWALK 4" = 126 SF **J4**

**J7**  
 SIDEWALK REMOVAL = 50 SF  
 PCC SIDEWALK 4" = 50 SF  
 HANDICAP RAMP, TYPE A  
 DETECTABLE WARNINGS (TRUNCATED DOME) = 6 SF  
 CURB & GUTTER REMOVAL & REPLACEMENT = 10 FT  
 PAVEMENT REMOVAL & REPLACEMENT = 1.1 SY  
 (CHAIN LINK FENCE TO REMAIN IN PLACE)

**J5**  
 CURB & GUTTER REMOVAL & REPLACEMENT = 13 FT.  
 PAVEMENT REMOVAL & REPLACEMENT = 1.4 SY

**J8**  
 CURB & GUTTER REMOVAL & REPLACEMENT = 18 FT  
 SIDEWALK REMOVAL = 261 SF  
 PCC SIDEWALK 4" = 261 SF  
 HANDICAP RAMP, TYPE A (2)  
 DETECTABLE WARNINGS (TRUNCATED DOME) = 12 SF

SIDEWALK REMOVAL = 50 SF  
 PCC SIDEWALK, 4" = 50 SF **J2**

**J6**  
 SIDEWALK REMOVAL = 50 SF  
 PCC SIDEWALK 4" = 50 SF

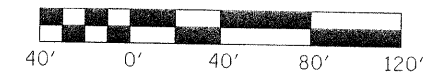
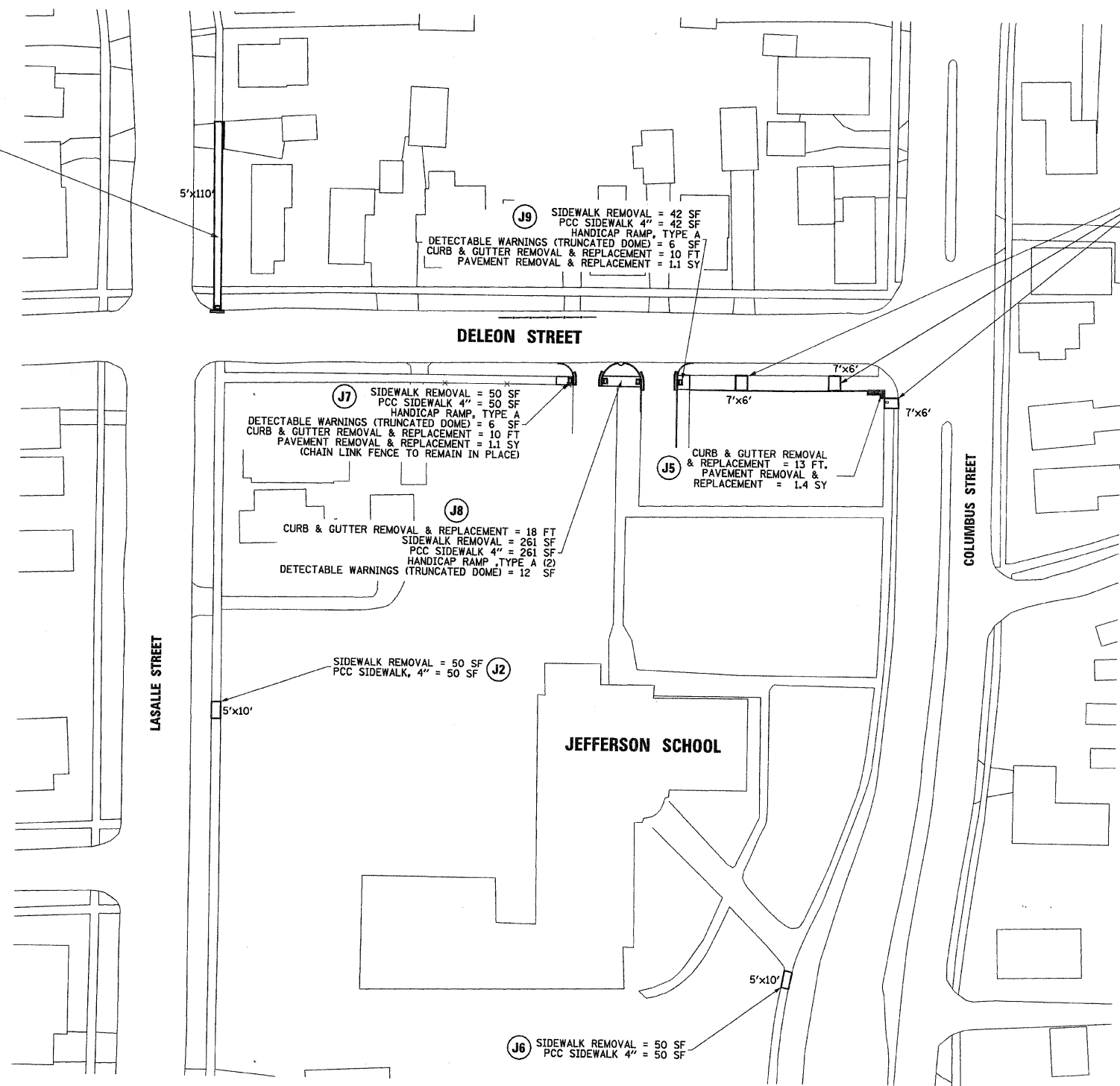

**JEFFERSON SCHOOL**  
**SAFE ROUTES TO SCHOOLS SIDEWALK IMPROVEMENTS**

**RENWICK & ASSOCIATES, INC.**

228 West Main Street  
 Ottawa, Illinois 61350  
 TEL: 815-434-3200  
 FAX: 815-434-3968

PROFESSIONAL DESIGN FIRM # 184-004957

DRAWN BY: RTF | CHECKED BY: WCK | DATE PLOTTED: DECEMBER 21, 2009  
 FILE PATH: C:\CITY OF OTTAWA\09.2.1-MCKIN SCHOOL\09\_2\_1\_JEFF.DGN



SLOPES RIGHT AND LEFT OF PROPOSED SIDEWALK ARE EQUAL AT EACH CROSS SECTION

SLOPES RIGHT AND LEFT OF PROPOSED SIDEWALK ARE EQUAL AT EACH CROSS SECTION

SCALE: HORIZ.: 1" = 5'  
VERT.: 1" = 2'

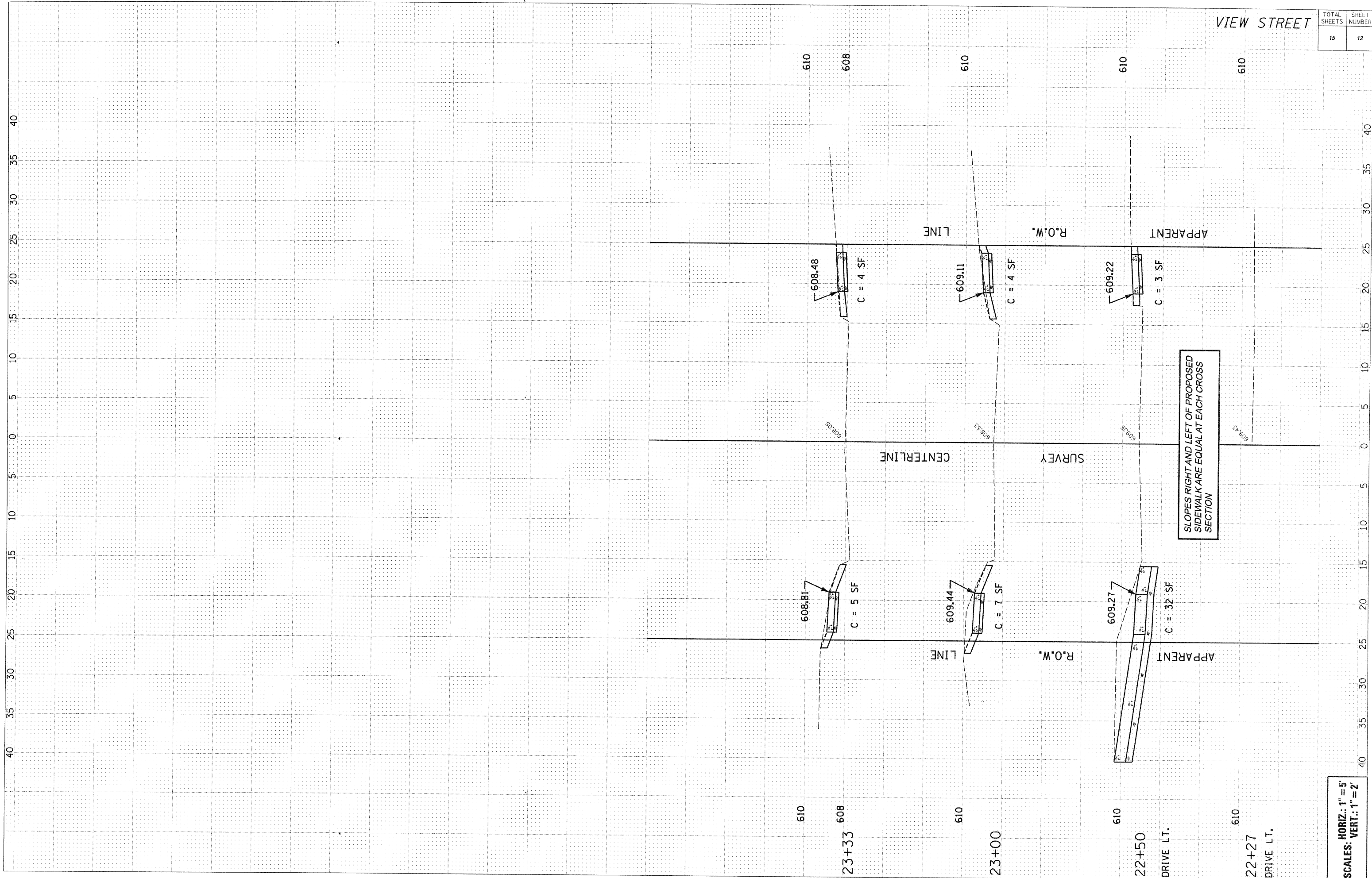

SLOPES RIGHT AND LEFT OF PROPOSED SIDEWALK ARE EQUAL AT EACH CROSS SECTION

SCALES: HORIZ.: 1" = 5'  
VERT.: 1" = 2'

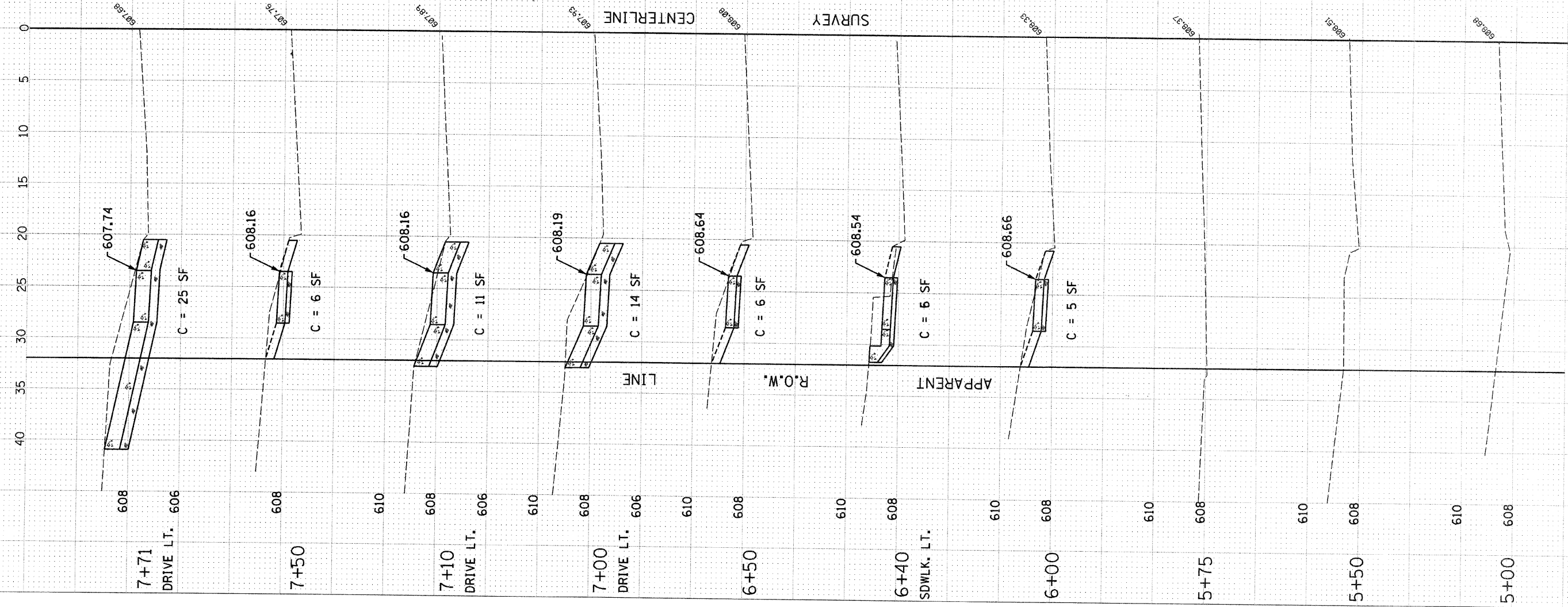

SLOPES RIGHT AND LEFT OF PROPOSED SIDEWALK ARE EQUAL AT EACH CROSS SECTION

HORIZ.: 1" = 5'  
SCALE: VERT.: 1" = 2'

SLOPES RIGHT AND LEFT OF PROPOSED SIDEWALK ARE EQUAL AT EACH CROSS SECTION

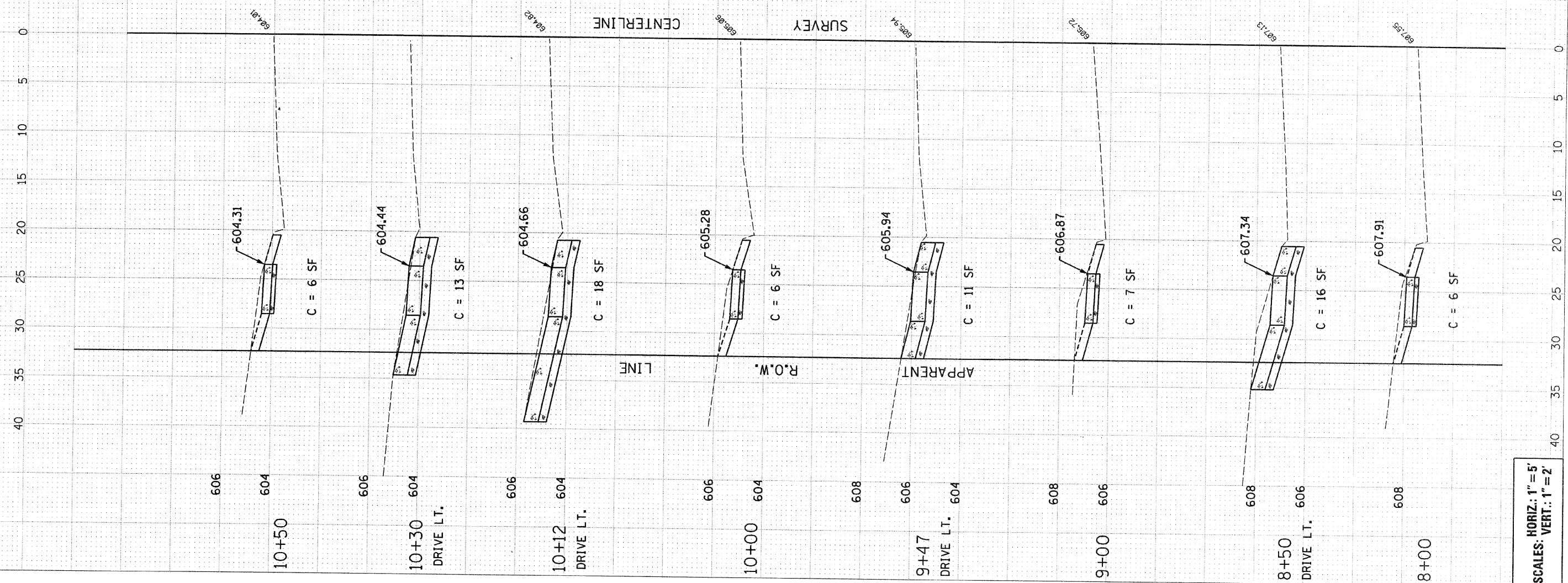

HORIZ.: 1" = 5'  
SCALES: VERT.: 1" = 2'

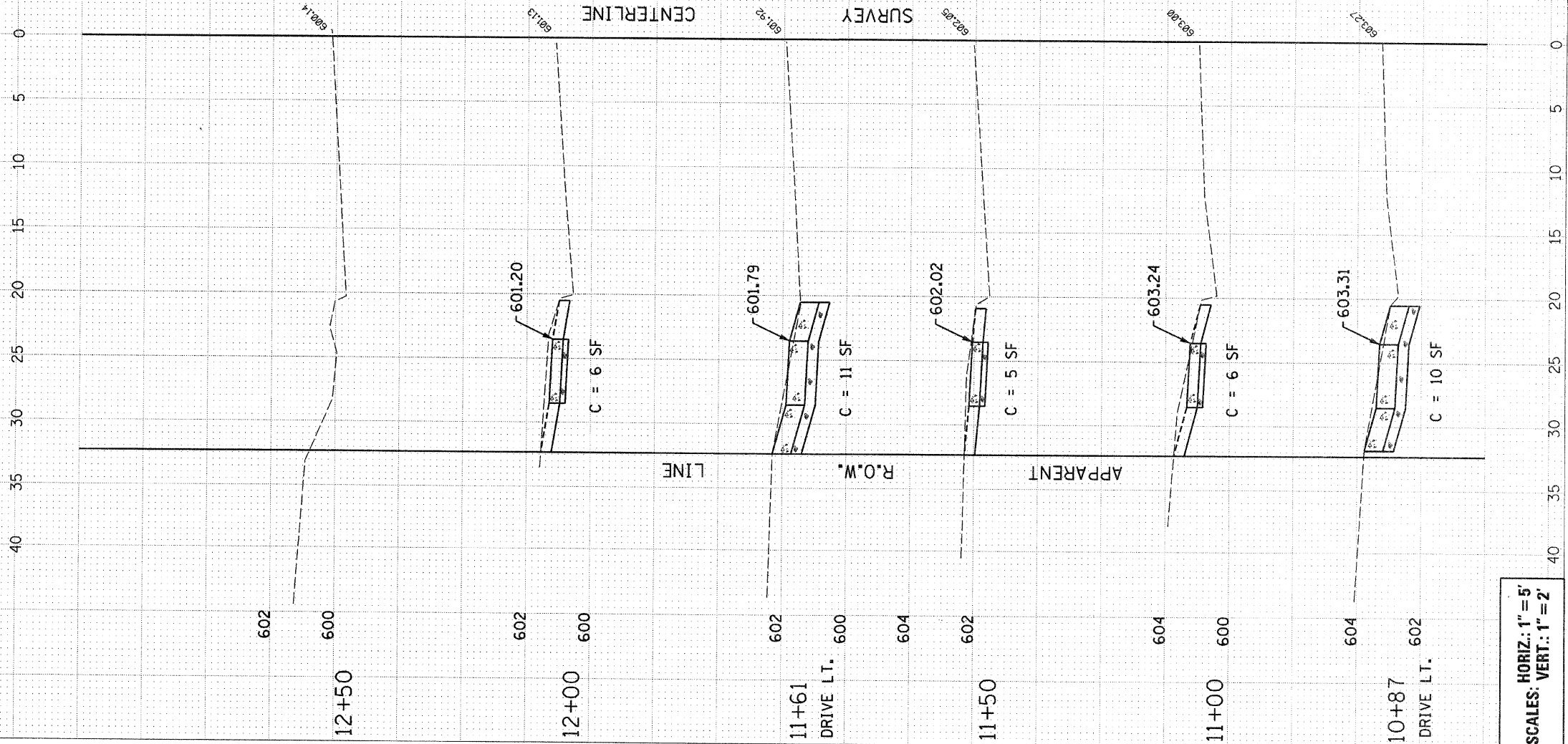

SLOPES RIGHT AND LEFT OF PROPOSED SIDEWALK ARE EQUAL AT EACH CROSS SECTION

HORIZ.: 1" = 5'  
SCALES: VERT.: 1" = 2'