

SECTIONS AT JOINTS

All Sections Looking North

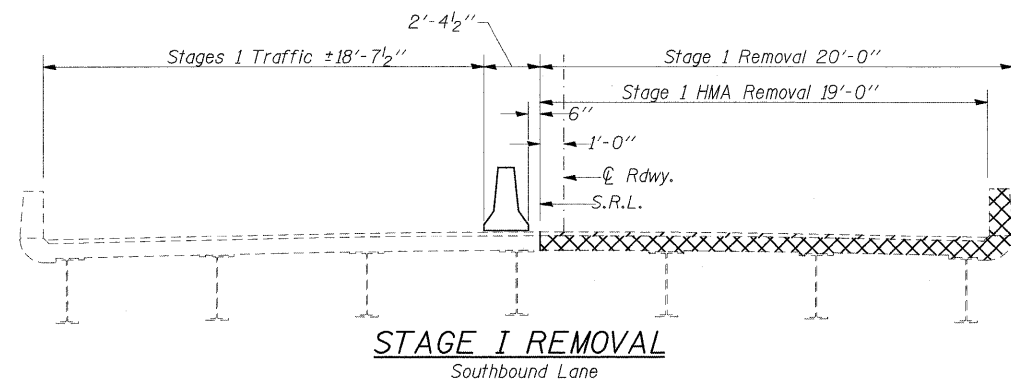

STAGE I REMOVAL
Southbound Lane

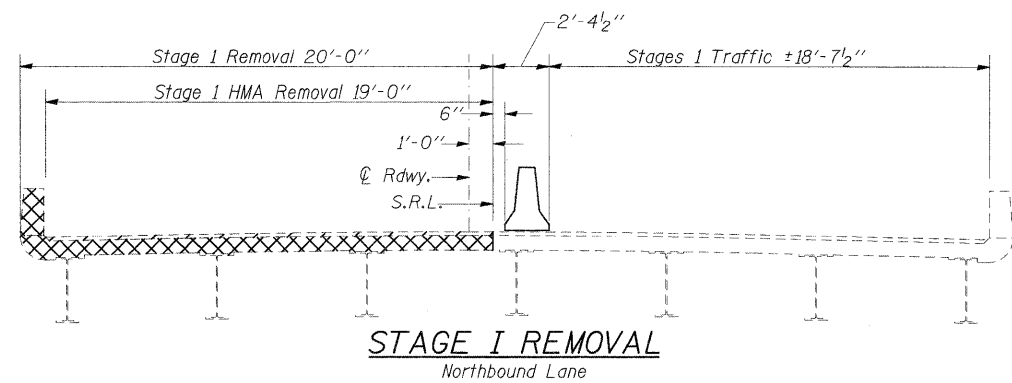

STAGE I REMOVAL
Northbound Lane

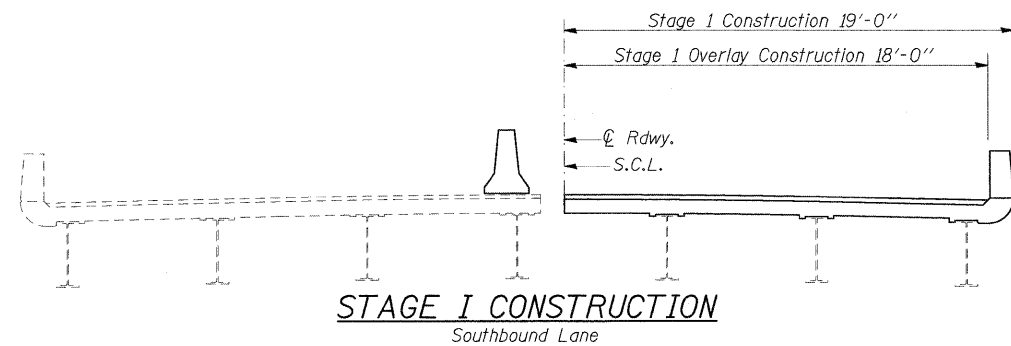

STAGE I CONSTRUCTION
Southbound Lane

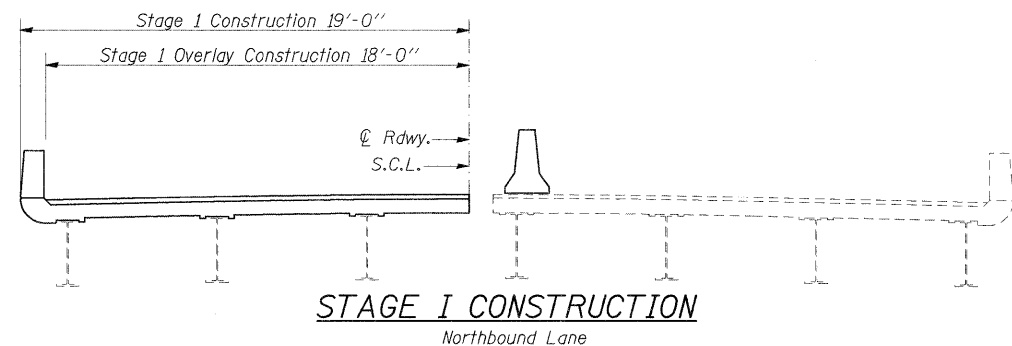

STAGE I CONSTRUCTION
Northbound Lane

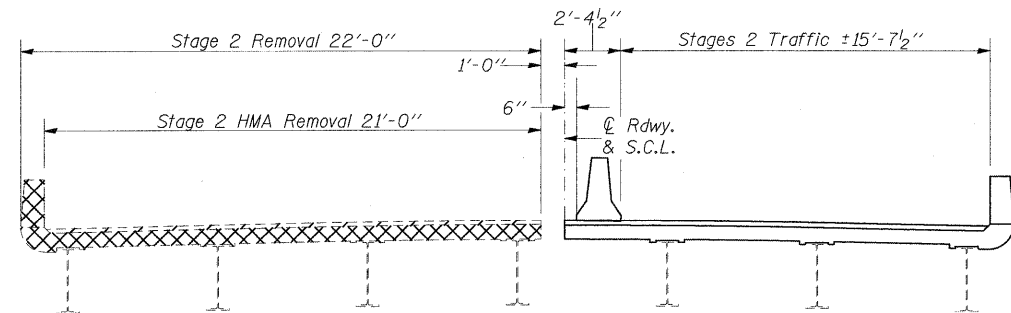

STAGE II REMOVAL
Southbound Lane

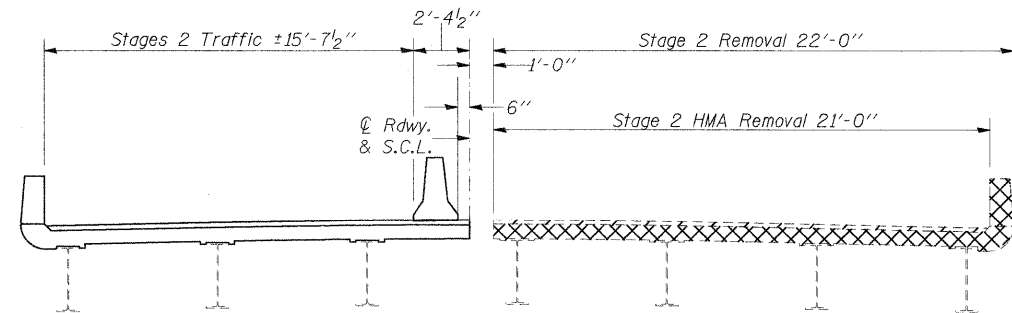

STAGE II REMOVAL
Northbound Lane

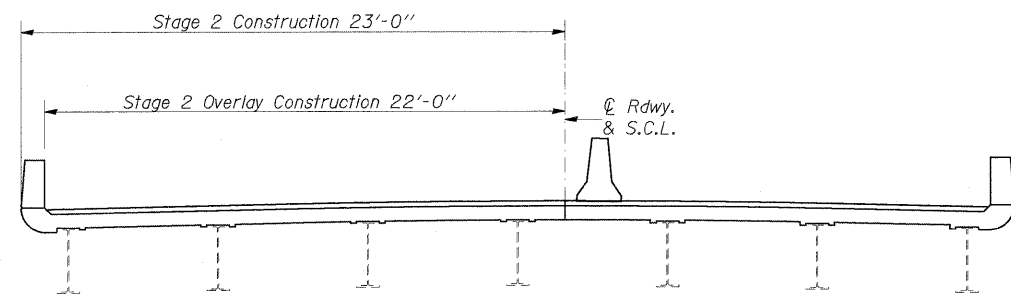

STAGE II CONSTRUCTION
Southbound Lane

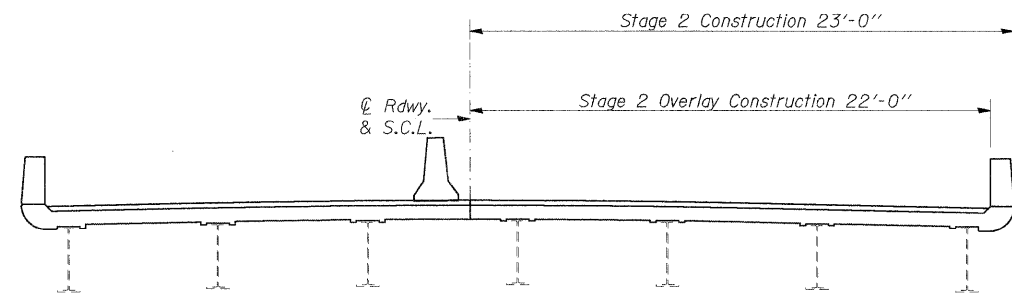

STAGE II CONSTRUCTION
Northbound Lane

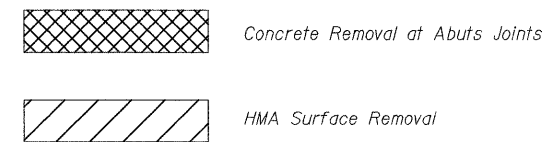

NOTES:
* The original deck portion was constructed on a 1/2" Circular Crown in 12'-0".
** The original deck portion was constructed on a slope of 1/4" per ft.

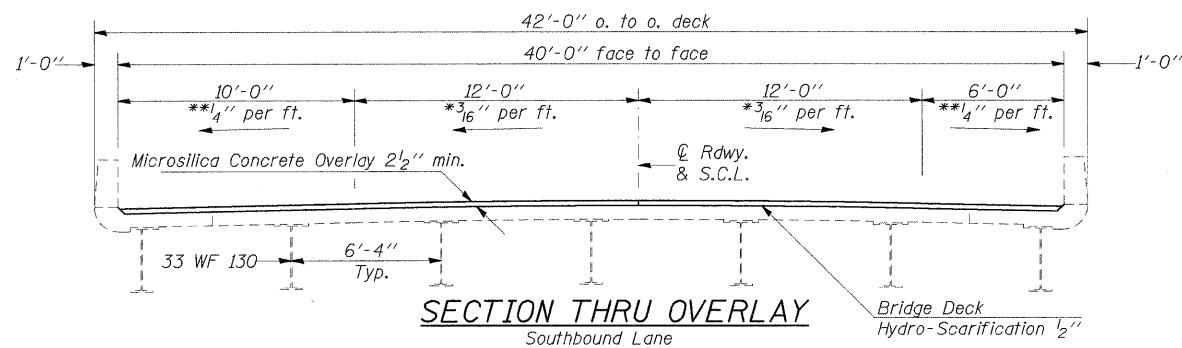

SECTION THRU OVERLAY
Southbound Lane

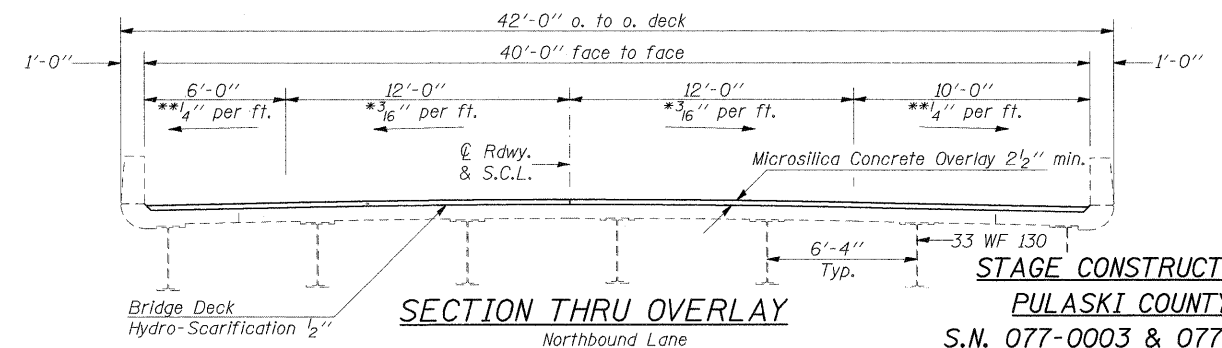

SECTION THRU OVERLAY
Northbound Lane

STAGE CONSTRUCTION
PULASKI COUNTY
S.N. 077-0003 & 077-0004

FILE NAME =	USER NAME = halsteadw	DESIGNED - TWH	REVISED -
c:\pwork\PW100T\HALSTEADT\0158817\77-0003.dgn		DRAWN - TWH	REVISED -
	PLOT SCALE = 4.0000' / IN.	CHECKED - MAS	REVISED -
	PLOT DATE = 10/19/2009	DATE - 10/15/09	REVISED -

STATE OF ILLINOIS
DEPARTMENT OF TRANSPORTATION

STAGING DETAILS

SCALE:	SHEET NO.	OF	SHEETS	STA.	TO STA.	F.A.I. RTE. 57	SECTION D9 BSMART FY10-2	COUNTY PULASKI	TOTAL SHEETS 12	SHEET NO. 6
						FED. ROAD DIST. NO. ILLINOIS FED. AID PROJECT CONTRACT NO. 78159				