

EXISTING ELEMENTS		
	LOCATION	SHEET X OF 14
RADAR DETECTION		
PSBC02.4E.11R	EB I-55/70 0.2 MILES EAST OF MARTIN LUTHER KING DRIVE	3
PSBC02.4W.25R.11D	EB I-55/70 0.2 MILES EAST OF MARTIN LUTHER KING DRIVE	3
557003.2A.23R	WB I-55/70 0.2 MILES EAST OF EXCHANGE AVE.	10
CCTV		
557003.2A.41C	WB I-55/70 0.2 MILES EAST OF EXCHANGE AVE.	10
PSBC02.4A.05C	EB I-55/70 0.2 MILES EAST OF MARTIN LUTHER KING DRIVE	3

TRAFFIC CONTROL				
TRAFFIC CONTROL AND PROTECTION STANDARDS	TOTAL	LOC.	BOWMAN YD.	LOC.
		PSBC 02.4A 11D	COMM. RM. 557003.1	5570 03.2A 23R
701001-02*	NA		X	
701006-03*	NA		X	
701101-02*	NA	X	X	X
701400-03*	NA			X
701406-05*	NA			X
701411-05*	NA			X
701456*	NA			X
701501-05*	NA		X	

\* NOT MEASURED FOR PAY, INCLUDED IN BID ITEM "TRAFFIC CONTROL AND PROTECTION"

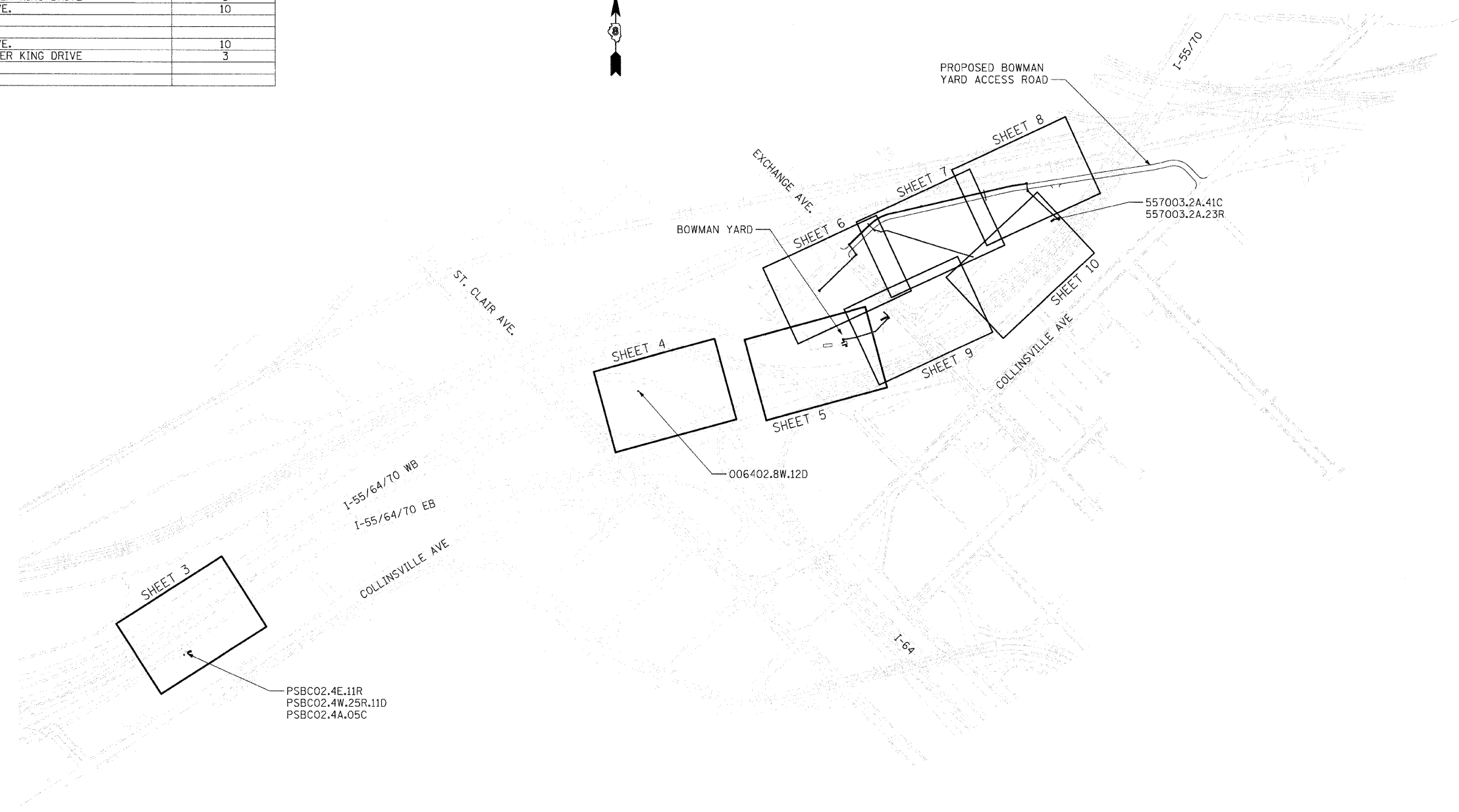

FIELD EQUIPMENT NUMBERING SYSTEM	
EXAMPLE : 557003.2A.23R	
<b>5570</b>	DESIGNATES HIGHWAY WHERE FIELD EQUIPMENT IS LOCATED.
<b>557003.2</b>	DESIGNATES MILE MARKER WHERE FIELD EQUIPMENT IS LOCATED.
<b>557003.2A</b>	DESIGNATES DIRECTION VIDEO DETECTOR IS MONITORING TRAFFIC OR DIRECTION TRAFFIC IS TRAVELING TO RECEIVE DMS MESSAGE.
<b>557003.2A.23</b>	NUMBER ASSIGNED TO THAT FIELD EQUIPMENT
<b>557003.2A.23R</b>	A = ALL DIRECTIONS D = VEHICLE DETECTION C = CAMERA (P/T/Z/ SURVEILLANCE) H = HAR SIGNAGE WITH BEACON R = RADAR DETECTION

TRAFFIC VOLUME SCHEDULE				
LOCATION	YEAR	ADT (ESTIMATED)	SUZ	MUZ
PSBC02.4A.11D	2006	141200	3.6	12.3
BOWMAN YARD COMM ROOM	2006	141200	3.6	12.3
557003.2A.23R	2006	74800	3.6	14.6

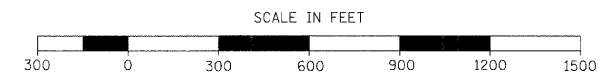

FILE NAME = DBT-r-02-sht-ITS1egout.dgn	USER NAME = asantag	DESIGNED - DS	REVISED -
		DRAWN - AS	REVISED -
		CHECKED - AC	REVISED -
		DATE - 03/15/09	REVISED -

**STATE OF ILLINOIS  
DEPARTMENT OF TRANSPORTATION**

ITS CABLE RELOCATION PLAN SHEET LAYOUT /VOLUME SCHEDULE			
SCALE: 1" = 300'	SHEET NO. 1 OF 14 SHEETS	STA.	TO STA.

F.A.I. RTE.	SECTION	COUNTY	TOTAL SHEETS	SHEET NO.
70	DIST 8 ITS 2010-2	ST. CLAIR	236	124
			CONTRACT NO. 76C55	
ILLINOIS FED. AID PROJECT				