

MATCHLINE  
SEE BELOW

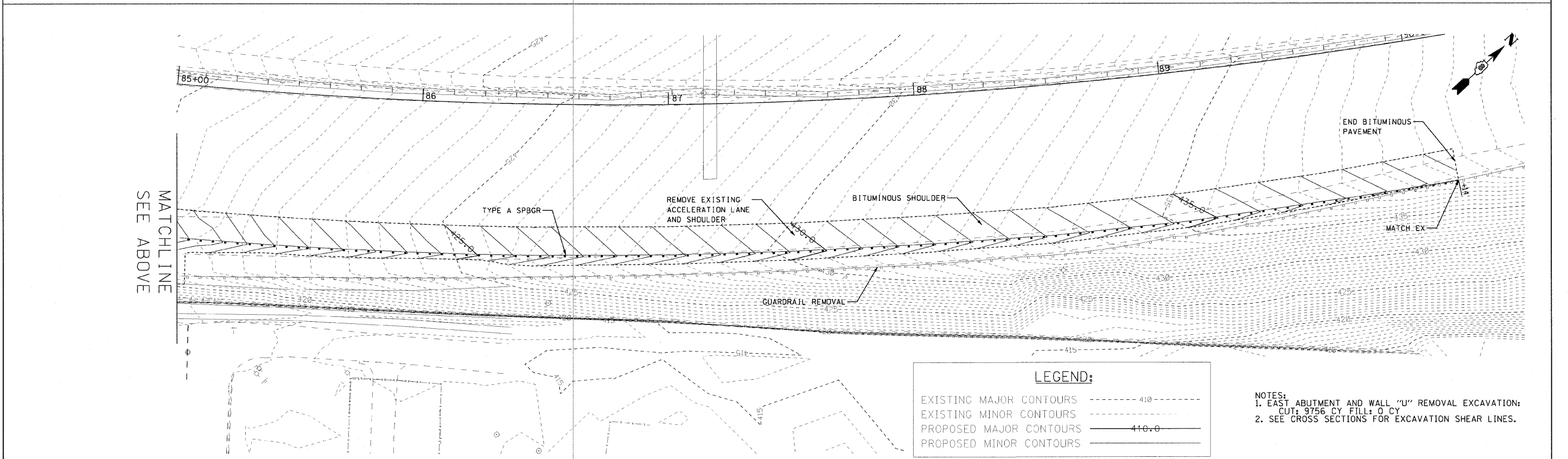

MATCHLINE  
SEE ABOVE

LEGEND:	
EXISTING MAJOR CONTOURS	----- 410 -----
EXISTING MINOR CONTOURS	----- 415 -----
PROPOSED MAJOR CONTOURS	----- 410.0 -----
PROPOSED MINOR CONTOURS	----- 415.0 -----

- NOTES:  
 1. EAST ABUTMENT AND WALL "U" REMOVAL EXCAVATION:  
 CUT: 9756 CY FILL: 0 CY  
 2. SEE CROSS SECTIONS FOR EXCAVATION SHEAR LINES.

#DATE# #TIME# #FILE#	FILE NAME =	USER NAME = #USER#	DESIGNED - RRV	REVISED -	<b>STATE OF ILLINOIS          DEPARTMENT OF TRANSPORTATION</b>	<b>RAMP "P" GRADING PLAN</b>		F.A.I. RTE. 70	SECTION 82-2-1HB	COUNTY ST. CLAIR	TOTAL SHEETS 236	SHEET NO. 114
	#FILE#		DRAWN - RRV	REVISED -		SCALE: 1" = 20'    SHEET NO. 1 OF 1 SHEETS    STA.    TO STA.			ILLINOIS FED. AID PROJECT			
PLOT SCALE = #SCALE#		CHECKED - DRH	REVISED -									
PLOT DATE = #DATE#		DATE - OCTOBER 9, 2009	REVISED -									