

PLAN	REVISIONS	DATE
NO.		
NO.		
NO.		
NO.		
NO.		
NO.		
NO.		
NO.		

PROFILE	REVISIONS	DATE
NO.		
NO.		
NO.		
NO.		
NO.		
NO.		
NO.		
NO.		

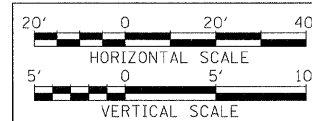
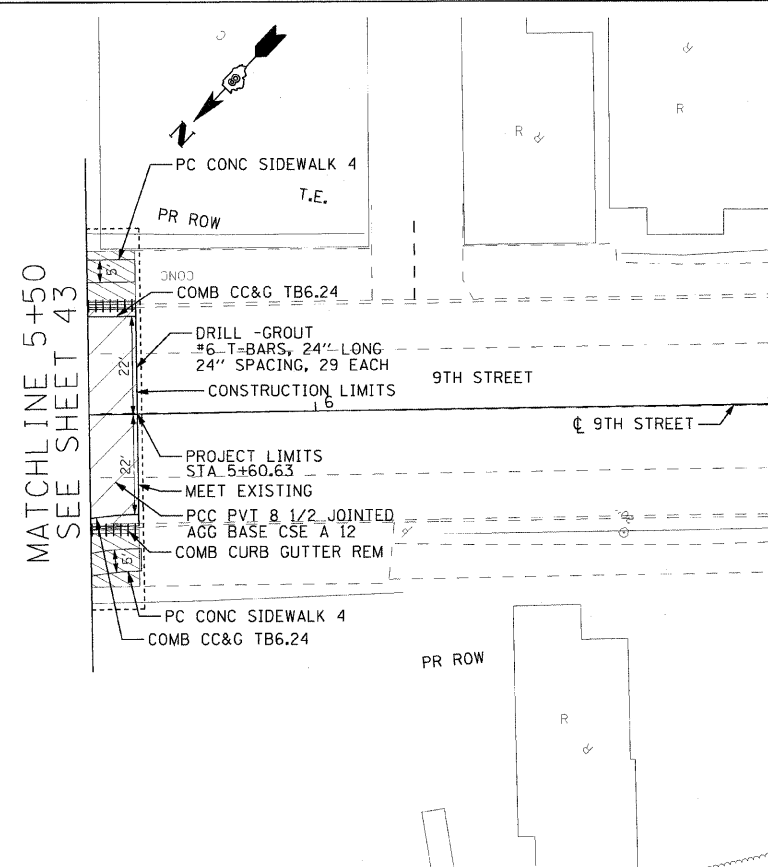
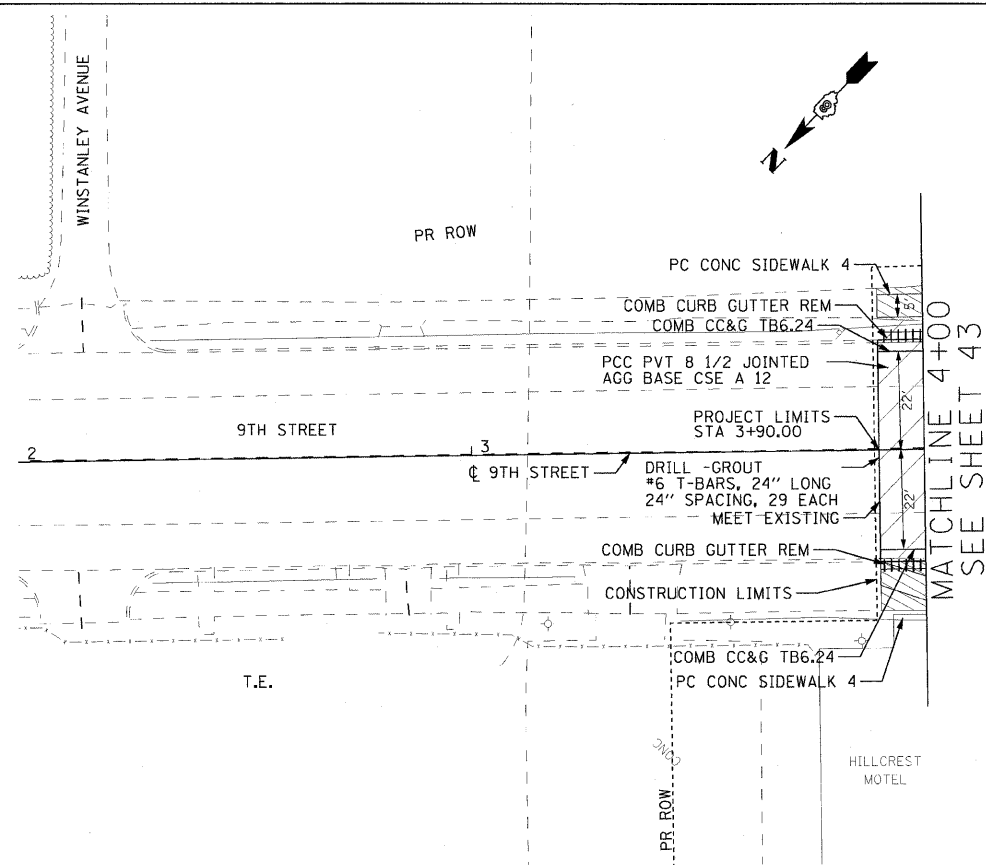

REMOVAL LEGEND:

DRIVEWAY	MEDIAN	PAVEMENT	CURB & GUTTER	TREE	TREE ACREAGE
SIDEWALK	SHOULDER	BRIDGE	FOUNDATION		

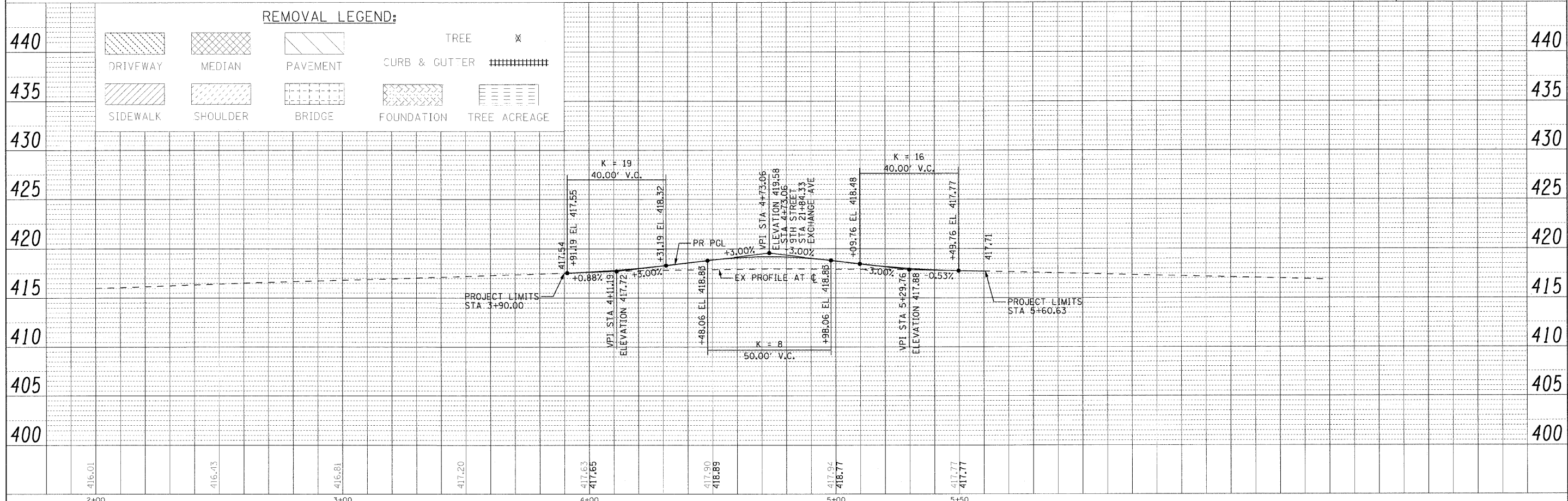

FILE NAME =	USER NAME = #USER#	DESIGNED - RRV	REVISED -	STATE OF ILLINOIS DEPARTMENT OF TRANSPORTATION	ROADWAY PLAN AND PROFILE 9TH ST.	F.A.I. RTE. 70	SECTION 82-2-1HB	COUNTY ST. CLAIR	TOTAL SHEETS 236	SHEET NO. 56	
#FILE#		DRAWN - KNW	REVISED -			SCALE: 1"=20'	SHEET NO. 16 OF 17 SHEETS	STA. 3+91.19 TO STA. 5+60.00	CONTRACT NO. 76C55		
DATE#		CHECKED - DRH	REVISED -			FED. ROAD DIST. NO. ILLINOIS FED. AID PROJECT					
#DATE#		DATE - OCTOBER 9, 2009	REVISED -								