

Project Begins, US 51 (MP 14.74)
Sta. 76+02.00

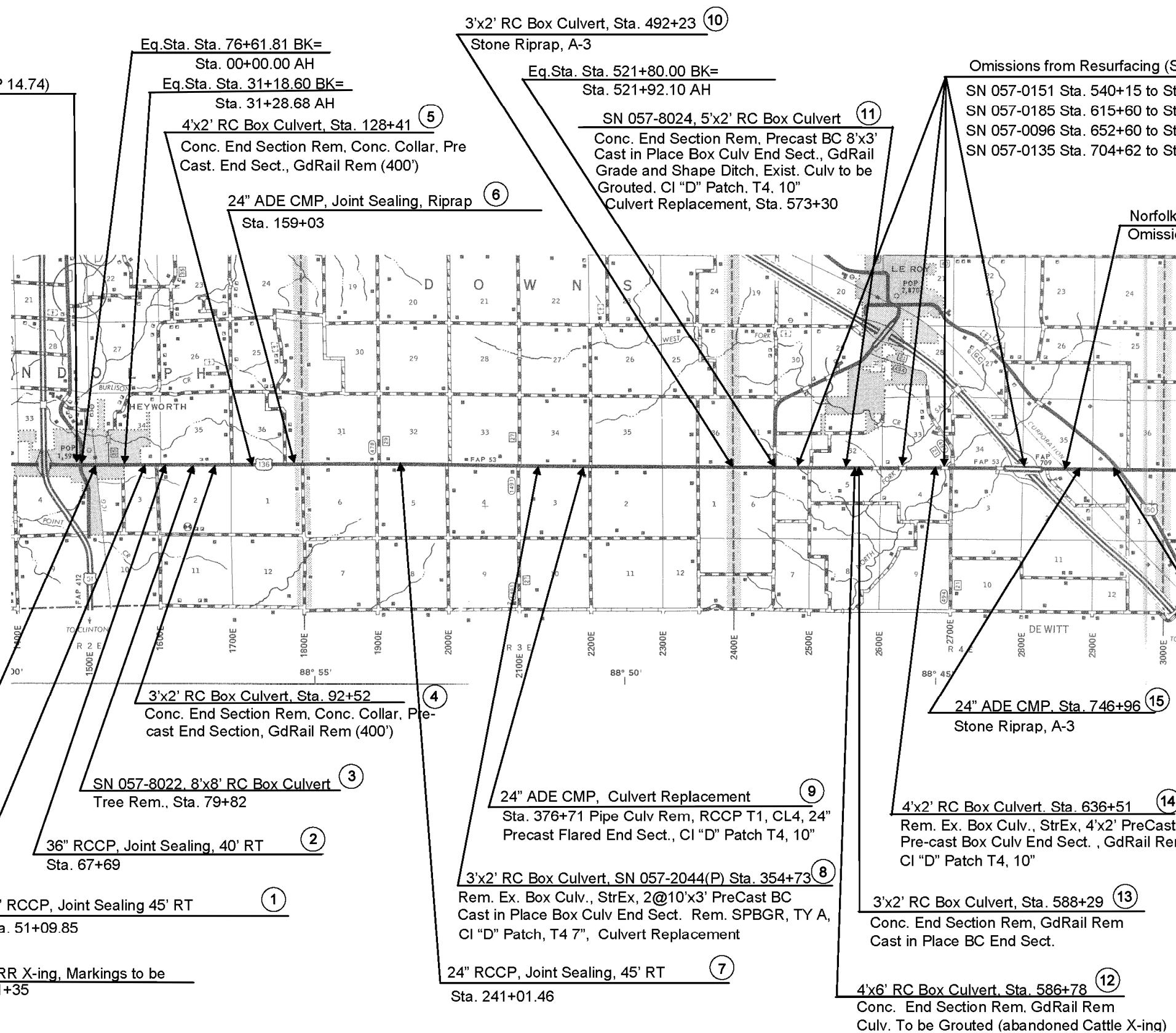

Eq.Sta. Sta. 76+61.81 BK=
Sta. 00+00.00 AH

Eq.Sta. Sta. 31+18.60 BK=
Sta. 31+28.68 AH

4'x2' RC Box Culvert, Sta. 128+41 (5)
Conc. End Section Rem, Conc. Collar, Pre
Cast. End Sect., GdRail Rem (400')

24" ADE CMP, Joint Sealing, Riprap (6)
Sta. 159+03

3'x2' RC Box Culvert, Sta. 492+23 (10)
Stone Riprap, A-3

Eq.Sta. Sta. 521+80.00 BK=
Sta. 521+92.10 AH

SN 057-8024, 5'x2' RC Box Culvert (11)
Conc. End Section Rem, Precast BC 8'x3'
Cast in Place Box Culv End Sect., GdRail
Grade and Shape Ditch, Exist. Culv to be
Grouted, CI "D" Patch, T4, 10"
Culvert Replacement, Sta. 573+30

Omissions from Resurfacing (Structures)
SN 057-0151 Sta. 540+15 to Sta. 540+27
SN 057-0185 Sta. 615+60 to Sta. 618+30
SN 057-0096 Sta. 652+60 to Sta. 652+90
SN 057-0135 Sta. 704+62 to Sta. 707+80

Norfolk and Southern Railroad crossing
Omission from resurfacing, Sta. 739+00 to
Sta. 739+11

Project Ends, US 150 (MP 29.01)
Sta. 774+37.9

3'x2' RC Box Culvert, Sta. 92+52 (4)
Conc. End Section Rem, Conc. Collar, Pre-
cast End Section, GdRail Rem (400')

SN 057-8022, 8'x8' RC Box Culvert (3)
Tree Rem., Sta. 79+82

36" RCCP, Joint Sealing, 40' RT (2)
Sta. 67+69

24" RCCP, Joint Sealing 45' RT (1)
Sta. 51+09.85

Abandoned ICG RR X-ing, Markings to be
Removed, Sta. 11+35

24" ADE CMP, Culvert Replacement (9)
Sta. 376+71 Pipe Culv Rem, RCCP T1, CL4, 24"
Precast Flared End Sect., CI "D" Patch T4, 10"

3'x2' RC Box Culvert, SN 057-2044(P) Sta. 354+73 (8)
Rem. Ex. Box Culv., StrEx, 2@10'x3' PreCast BC
Cast in Place Box Culv End Sect. Rem. SPBGR, TY A,
CI "D" Patch, T4 7", Culvert Replacement

24" RCCP, Joint Sealing, 45' RT (7)
Sta. 241+01.46

24" ADE CMP, Sta. 746+96 (15)
Stone Riprap, A-3

4'x2' RC Box Culvert, Sta. 636+51 (14)
Rem. Ex. Box Culv., StrEx, 4'x2' PreCast BC
Pre-cast Box Culv End Sect., GdRail Rem
CI "D" Patch T4, 10"

3'x2' RC Box Culvert, Sta. 588+29 (13)
Conc. End Section Rem, GdRail Rem
Cast in Place BC End Sect.

4'x6' RC Box Culvert, Sta. 586+78 (12)
Conc. End Section Rem, GdRail Rem
Culv. To be Grouted (abandoned Cattle X-ing)

FILE NAME =	USER NAME = bucklesjj	DESIGNED -	REVISED -
ct:\pw\work\PWIDOT\BUCKLESJJ\d0170848.D	70507-sht:gennote.dgn	DRAWN -	REVISED -
PLOT SCALE = 40.0000' / IN.		CHECKED -	REVISED -
PLOT DATE = 12/10/2009		DATE -	REVISED -

**STATE OF ILLINOIS
DEPARTMENT OF TRANSPORTATION**

BOX CULVERT SCOPE OF WORKLOCATION MAP

SCALE:	SHEET NO.	OF SHEETS	STA.	TO STA.
--------	-----------	-----------	------	---------

F.A.P. RTE.	SECTION	COUNTY	TOTAL SHEETS	SHEET NO.
315	*	McLean	115	12
* (101,102)R,RS-2 & 55RS-PRK LN			CONTRACT NO. 70507	
ILLINOIS FED. AID PROJECT				