

F.A.P. RTE.	SECTION	COUNTY	TOTAL SHEETS	SHEET NO.
**	*	McLean	115	1
		ILLINOIS	CONTRACT NO. 70507	

** FAP 315/FAP 709 *101,102X)R,RS-2 & 55RS-PRK LN

D-95-027-06

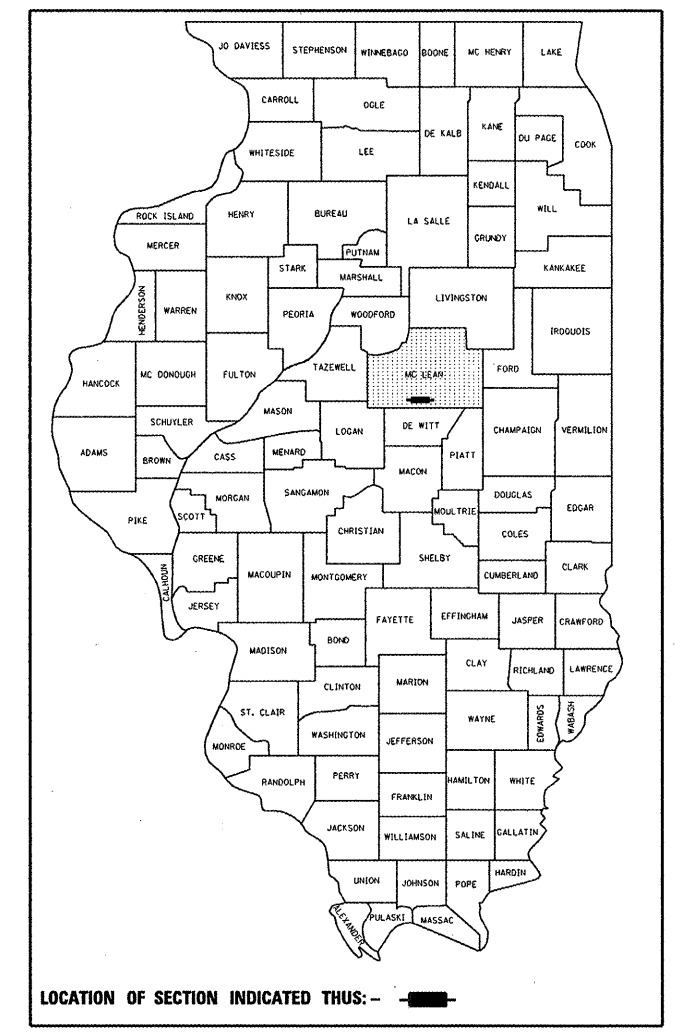

LOCATION OF SECTION INDICATED THUS: - [Symbol]

STATE OF ILLINOIS
DEPARTMENT OF TRANSPORTATION

DIVISION OF HIGHWAYS

**PROPOSED
HIGHWAY PLANS**

F.A.P. ROUTE 315 & 709 (US 136)
SECTION (101,102X)R,RS-2 & 55RS-PRK LN
PROJECT ACF-0005(801)
RESURFACING (3P) & CULVERT REPLACEMENTS
OLD US 51 IN HEYWORTH TO US 150
MCLEAN COUNTY

C-95-028-06

FOR INDEX OF SHEETS, SEE SHEET NO. 2
FOR SUMMARY OF QUANTITIES, SEE SHEET NO. 5 - 8

CURRENT ADT: (2009)

LEG "A"	- 4350	6.1% MU
LEG "B"	- 1950	21.2% MU
LEG "C"	- 1550	24.0% MU
LEG "D"	- 1250	28.6% MU
LEG "E"	- 1400	19.9% MU

CULVERT REPLACEMENTS:
SN 057-8024 (E); SN 057-8210 (P)
SLD MILE STA. 21-72; 057-2044 (P)

RESURFACING OMISSIONS:
SN 057-0096
SN 057-0135
SN 057-0151
SN 057-0185

H.M.A. RESURFACING:
SN 057-8020
SN 057-8022
SN 057-8023
SN 057-8211
SN 057-2001

DESIGN DESIGNATION
HEYWORTH TO I-74: OTHER PRINCIPAL ARTERIAL
I-74 TO US 150: MINOR ARTERIAL

EO. STA. 76+61.81 (BK)=
STA. 0+00.00 (AH)

EO. STA. 31+18.60 (BK)=
STA. 31+28.68 (AH)

OMISSION FROM RESURFACING, SN 057-0151
STA. 540+15 TO STA. 540+27 POSTED
LEGAL LOADS ONLY

OMISSION FROM RESURFACING, SN 057-0135
STA. 704+62 TO STA. 707+80
(END FAP 315, BEGIN FAP 709)

OMISSION FROM RESURFACING, SN 057-0096
STA. 652+60 TO STA. 652+90 POSTED
LEGAL LOADS ONLY

EO. STA. 521+80.00 (BK)=
STA. 521+92.10 (AH)

PROJECT BEGINS, STATION 76+02.00
FAP 315, SEC (101)

PROJECT ENDS, STATION 774+37.60,
FAP 709, SEC (102X)

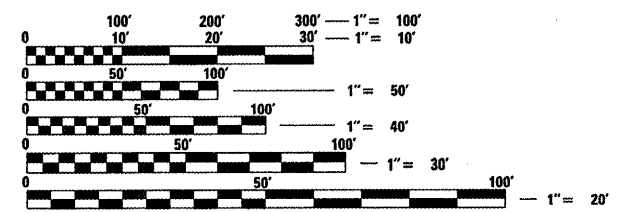

11" x 17" PLANS HAVE BEEN PREPARED USING STANDARD
ENGINEERING SCALES. REDUCED SIZED PLANS WILL NOT
CONFORM TO STANDARD SCALES. IN MAKING MEASUREMENTS
ON REDUCED PLANS, THE ABOVE SCALES MAY BE USED.

J.U.L.I.E.
JOINT UTILITY LOCATION INFORMATION FOR EXCAVATION
1-800-892-0123
OR 811

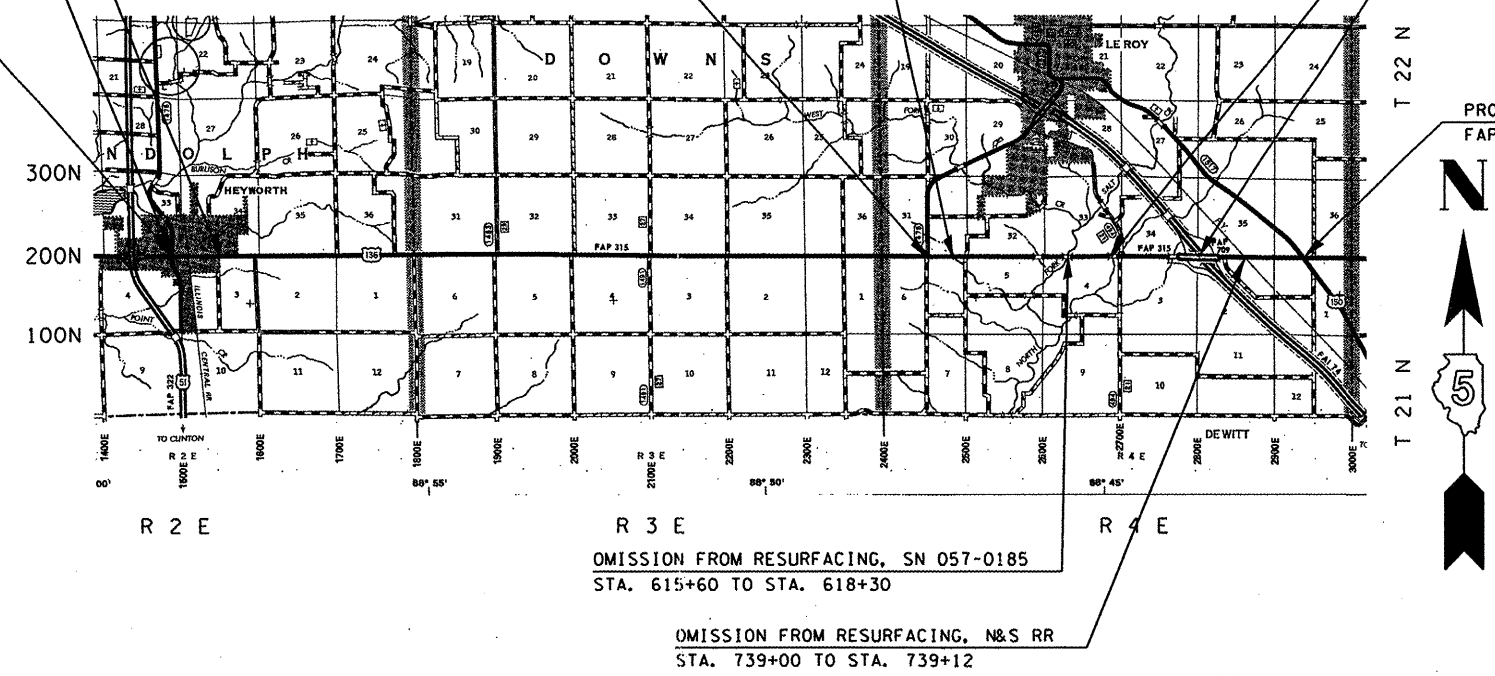

OMISSION FROM RESURFACING, SN 057-0185
STA. 615+60 TO STA. 618+30

OMISSION FROM RESURFACING, N&S RR
STA. 739+00 TO STA. 739+12

GROSS LENGTH = 77,475.23 FT. = 14.673 MILE
NET LENGTH = 76,833.23 FT. = 14.552 MILE

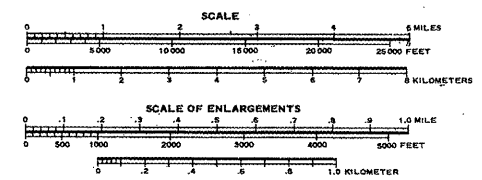

STATE OF ILLINOIS
DEPARTMENT OF TRANSPORTATION
DIVISION OF HIGHWAYS

SUBMITTED 12/9 20 09

Joseph L. Cooney
DEPUTY DIRECTOR OF HIGHWAYS, REGION ENGINEER

January 29, 20 10
Scott E. Still, P.E.
Acting ENGINEER OF DESIGN AND ENVIRONMENT

January 29, 20 10
Christine M. Reed
DIRECTOR OF HIGHWAYS, CHIEF ENGINEER

**PRINTED BY THE AUTHORITY
OF THE STATE OF ILLINOIS**

PROJECT ENGINEER: KEVIN TRAPP
PROJECT MANAGER: MICHAEL LEROY
PHONE 217-465-4181
CONTRACT NO. 70507