

STATE OF ILLINOIS  
DEPARTMENT OF TRANSPORTATION

Notes:  
See sheet 12 of 24 for Detail A.  
Approach slab concrete shall be paid for as Concrete Superstructure.  
Approach footing concrete shall be paid for as Concrete Structures.  
Reinforcement shall be paid for as Reinforcement Bars, Epoxy Coated.  
For  $v_{20}(E)$  bar details, see sheet 19 of 24.  
The approach footing maximum applied service bearing pressure ( $Q_{max}$ ) = 2.0 ksf.  
For bar splicer details, see sheet 22 of 24.  
Cost of excavation for approach footing included with Concrete Structures.  
For Porous Granular Embankment (Special) and drainage treatment details, see sheet 2 of 24.

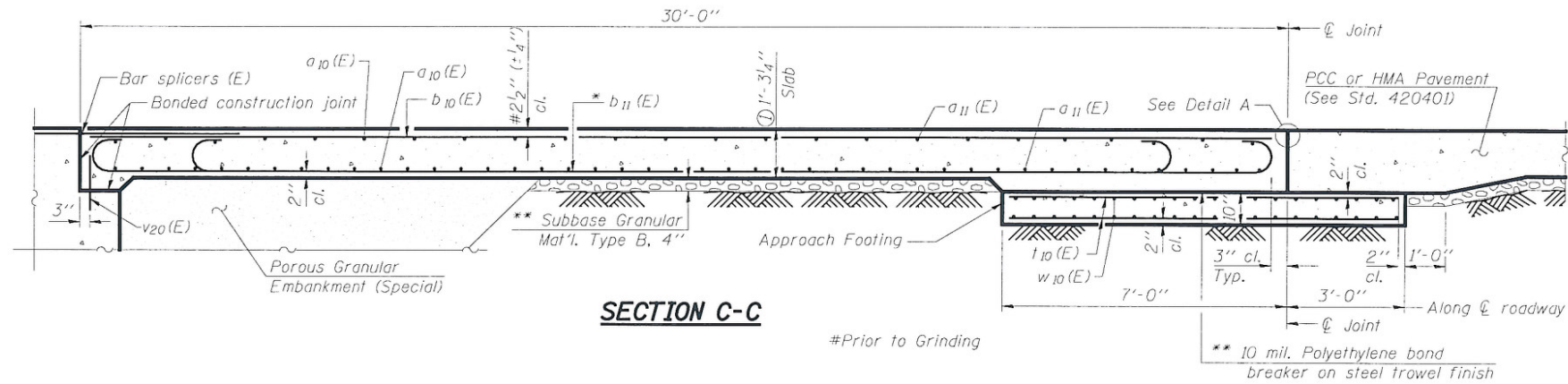

SECTION C-C

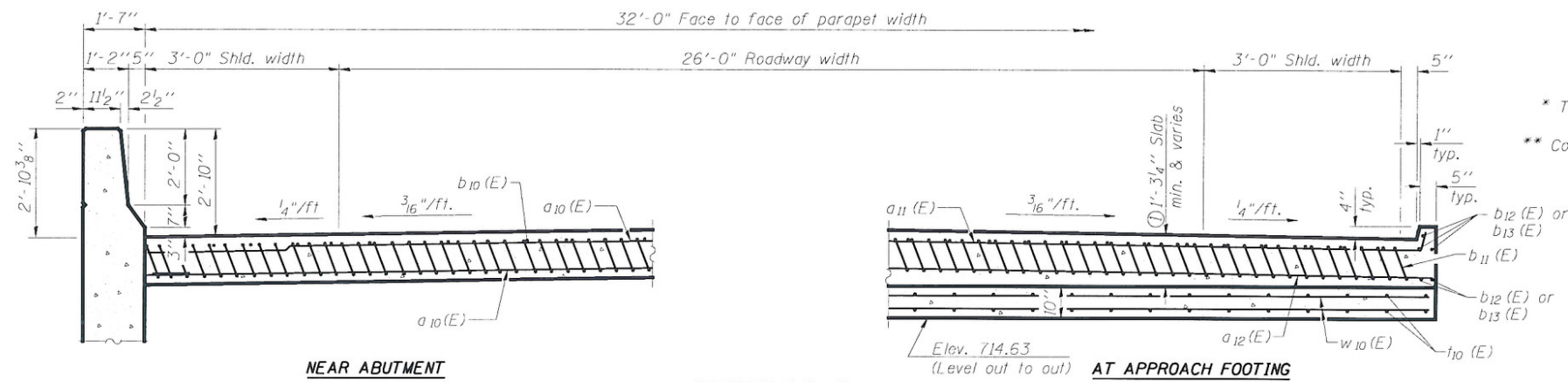

NEAR ABUTMENT

SECTION D-D

(See Plan for dimensions not shown)

AT APPROACH FOOTING

① Prior to Grinding

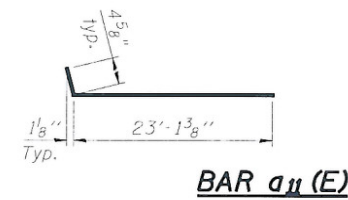

BAR a<sub>11</sub>(E)

\* Tilt #9 b<sub>11</sub>(E) bars as required to maintain clearance.  
\*\* Cost included with Concrete Superstructure.

BILL OF MATERIAL  
(TWO APPROACHES)

Bar	No.	Size	Length	Shape	
a <sub>10</sub> (E)	146	#5	22'-3"	—	
a <sub>11</sub> (E)	138	#5	23'-6"	—	
b <sub>10</sub> (E)	66	#5	29'-8"	—	
b <sub>11</sub> (E)	154	#9	29'-10"	—	
b <sub>12</sub> (E)	10	#4	20'-0"	—	
b <sub>13</sub> (E)	10	#4	15'-0"	—	
i <sub>10</sub> (E)	136	#4	9'-8"	—	
w <sub>10</sub> (E)	160	#5	23'-7"	—	
Concrete Superstructure				Cu. Yd.	66.4
Concrete Structures				Cu. Yd.	29.5
* Reinforcement Bars, Epoxy Coated				Pound	29,490

Note: Bill of Material is for two approach pavements.

\*Reinforcement Bars, Epoxy Coated  
Superstructure = 24,670 lbs  
Substructure = 4,820 lbs

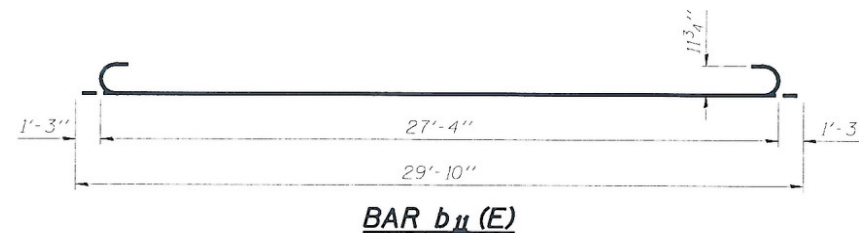

BAR b<sub>11</sub>(E)

DESIGNED	JLG
CHECKED	JSP
DRAWN	UJ
CHECKED	JLG



BRIDGE APPROACH SLAB DETAILS  
STRUCTURE NO. 010-0283

SHEET NO. 13 24 SHEETS	F.A.P. RTE.	SECTION	COUNTY	TOTAL SHEETS	SHEET NO.
	709	(105BR)BR	CHAMPAIGN	55	25
	SN 010-0283		CONTRACT NO. 70427		
FED. ROAD DIST. NO. 5 ILLINOIS FED. AID PROJECT					