

STATE OF ILLINOIS
DEPARTMENT OF TRANSPORTATION

Notes:
See sheet 13 of 24 for Sections C-C & D-D.
 $a_{10}(E)$, $a_{11}(E)$, and $w_{10}(E)$ bar spacings measured parallel to C Rdwy.

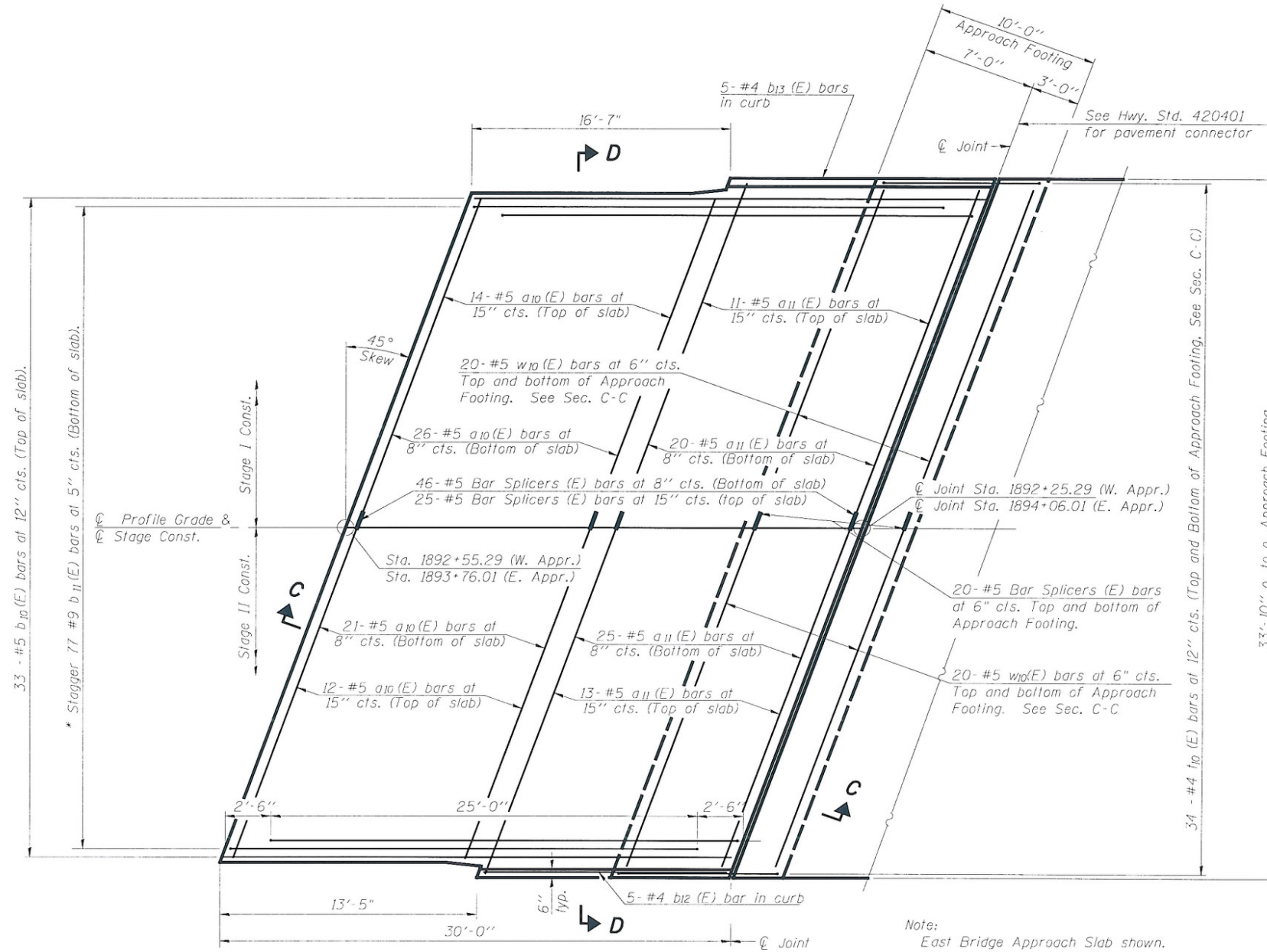

PLAN

* Tilt #9 $b_{11}(E)$ bars as required to maintain clearance.

Note:
East Bridge Approach Slab shown.
West Approach rotated 180°.

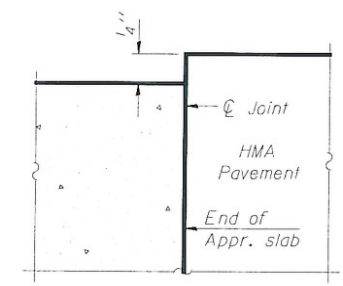

FLEXIBLE PAVEMENT

DETAIL A

Note:
Approach Roadway consists of 6 1/2" of asphalt pavement over concrete pavement.

DESIGNED	JLG
CHECKED	JSP
DRAWN	UJ
CHECKED	JLG

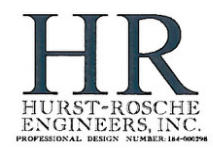

BRIDGE APPROACH SLAB DETAILS
STRUCTURE NO. 010-0283

SHEET NO. 12 24 SHEETS	F.A.P. RTE.	SECTION	COUNTY	TOTAL SHEETS	SHEET NO.
	709	(105BR)BR	CHAMPAIGN	55	24
SN 010-0283			CONTRACT NO. 70427		
FED. ROAD DIST. NO. 5 ILLINOIS FED. AID PROJECT					