

F.A.P. RTE.	SECTION	COUNTY	TOTAL SHEETS	SHEET NO.
698 649	123RS-4;(122,124)RS-5;2RS-3,3RS-4	MARSHALL PUTNAM	40	1
		ILLINOIS	CONTRACT NO. 68915	

STATE OF ILLINOIS  
DEPARTMENT OF TRANSPORTATION  
DIVISION OF HIGHWAYS

# PROPOSED HIGHWAY PLANS

F.A.P. ROUTE 649 (IL 17) & 698 (IL 89)  
SECTION 123RS-4; (122, 124)RS-5; 2RS-3 ETC  
PROJECT ESP-HSIP-000S(802)  
SURFACE MAINTENANCE /SAFETY  
MARSHALL & PUTNAM COUNTIES

C-94-131-09

D-94-082-09

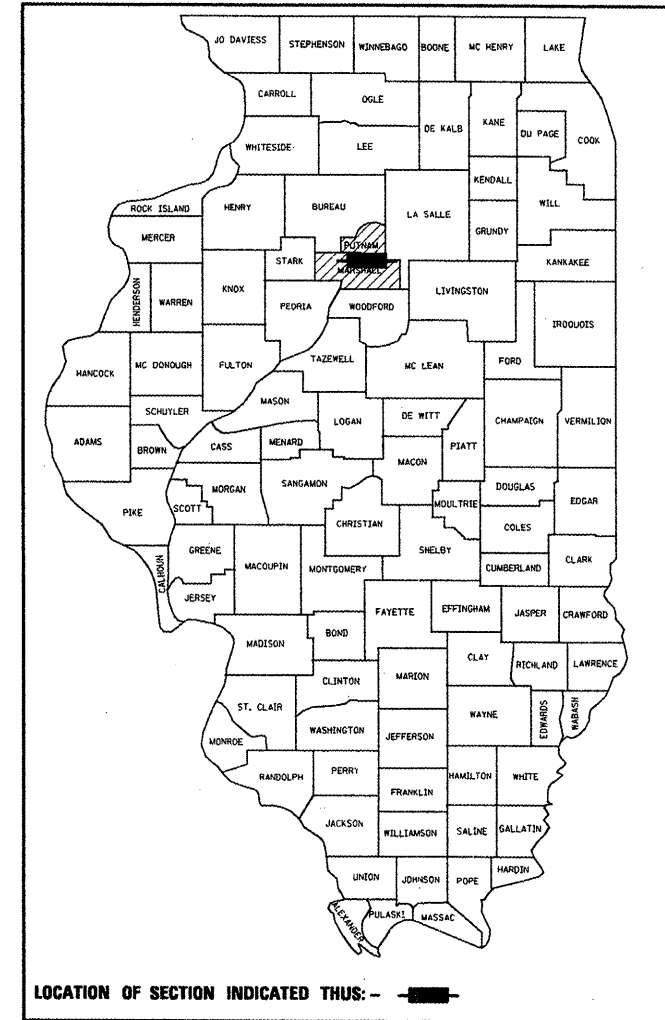

### INDEX OF SHEETS

1. COVER SHEET
2. COMMITMENTS AND GENERAL NOTES
3. JOB SPECIFIC NOTES
- 4.-6. SUMMARY OF QUANTITIES
- 7.-10. TYPICAL SECTIONS
- 11.-18. SCHEDULE OF QUANTITIES
19. LINE DIAGRAM
- 20.-21. INTERSECTION DETAILS
22. COLLAR FOR BOX CULVERTS DETAIL
23. SIDEROAD TREATMENT DETAIL
24. RUMBLE STRIP DETAIL
- 25.-28. GUARDRAIL INSTALLATION DETAIL
- 29.-40. DISTRICT STANDARDS  
HIGHWAY STANDARDS

### HIGHWAY STANDARDS

442201-03	701006-03	701326-03
482001-02	701011-02	701336-05
542311-01	701201-03	701901-01
630001-08	701301-03	781001-03
635006-03	701306-02	
642001-01	701311-03	

### DISTRICT STANDARDS

406101-D4	667101-D4
440001-D4	780001-D4
630101-D4	

### DESIGN DESIGNATION

RURAL MINOR ARTERIAL	
IL 17	IL 89
ADT: 3650 (2007)	2200 (2007)
MU: 12.3%	15.9%
SU: 4.8%	5.7%

### PROJECT DESCRIPTION

THE WORK CONSISTS OF PATCHING, RESURFACING, CONSTRUCTION OF HMA SHOULDER, INSTALLATION OF SAFETY GRATES AND OTHER COLLATERAL WORK.

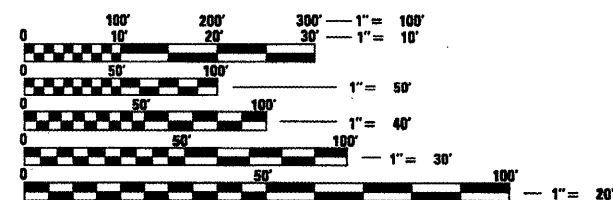

FULL SIZE PLANS HAVE BEEN PREPARED USING STANDARD ENGINEERING SCALES. REDUCED SIZED PLANS WILL NOT CONFORM TO STANDARD SCALES. IN MAKING MEASUREMENTS ON REDUCED PLANS, THE ABOVE SCALES MAY BE USED.

J.U.L.I.E.  
JOINT UTILITY LOCATION INFORMATION FOR EXCAVATION  
1-800-892-0123  
OR 811

PROJECT ENGINEER: CHRISTOPHER MAUSHARD (309) 671-3453  
PROJECT MANAGER: MIKE MOHAMED (309) 671-3462  
CATALOG NO. 034286-00D  
CONTRACT NO. 68915

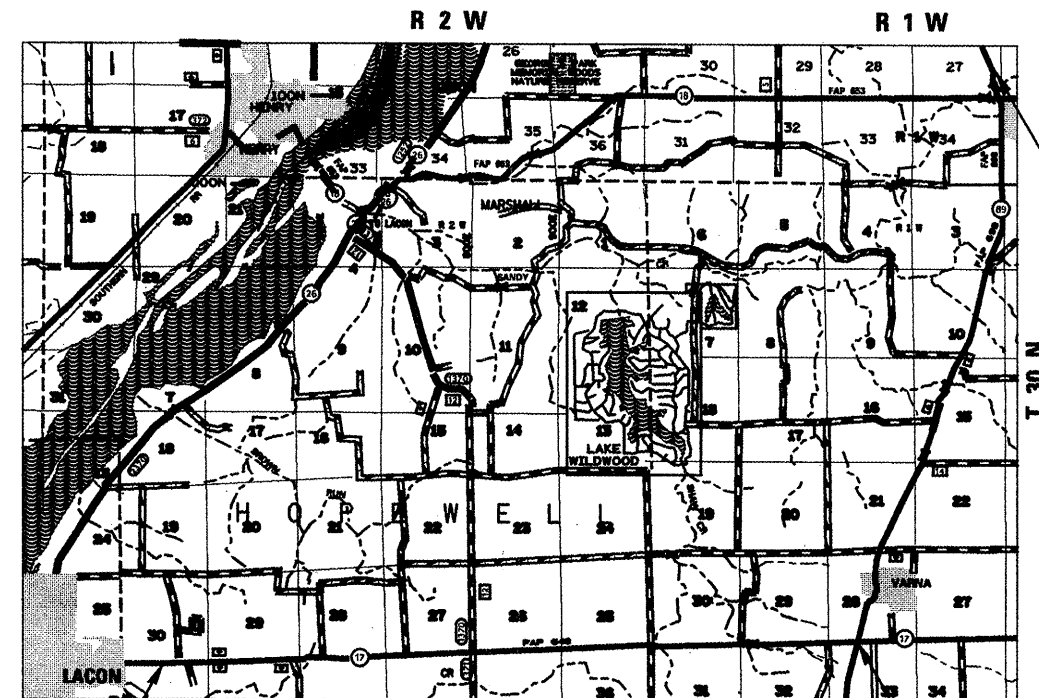

PROJECT BEGINS  
STA. 65 + 59.00 (IL 17)

PROJECT ENDS  
STA. 460 + 11.00 (IL 17)  
STA. 45 + 08.40 (IL 89)

PROJECT ENDS  
STA. 562 + 00.00 (IL 89)

GROSS LENGTH = 81,102.00 FT. = 15.36 MILES  
NET LENGTH = 80,633.86 FT. = 15.27 MILES

STATE OF ILLINOIS  
DEPARTMENT OF TRANSPORTATION  
DIVISION OF HIGHWAYS

SUBMITTED *Dec 10 09*

*Scott E. Stett P.E.*  
DEPUTY DIRECTOR OF HIGHWAYS, REGION ENGINEER

*Christine M. Reed*  
ENGINEER OF DESIGN AND ENVIRONMENT

*Christine M. Reed*  
DIRECTOR OF HIGHWAYS, CHIEF ENGINEER

PRINTED BY THE AUTHORITY  
OF THE STATE OF ILLINOIS