

FINAL SURVEY	SURVEYED	BY	DATE
NOTE BOOK NO.	PLOTTED		
	TEMPLATE AREAS CHECKED		

ORIGINAL SURVEY	SURVEYED	BY	DATE
NOTE BOOK NO.	PLOTTED		
	TEMPLATE AREAS CHECKED		

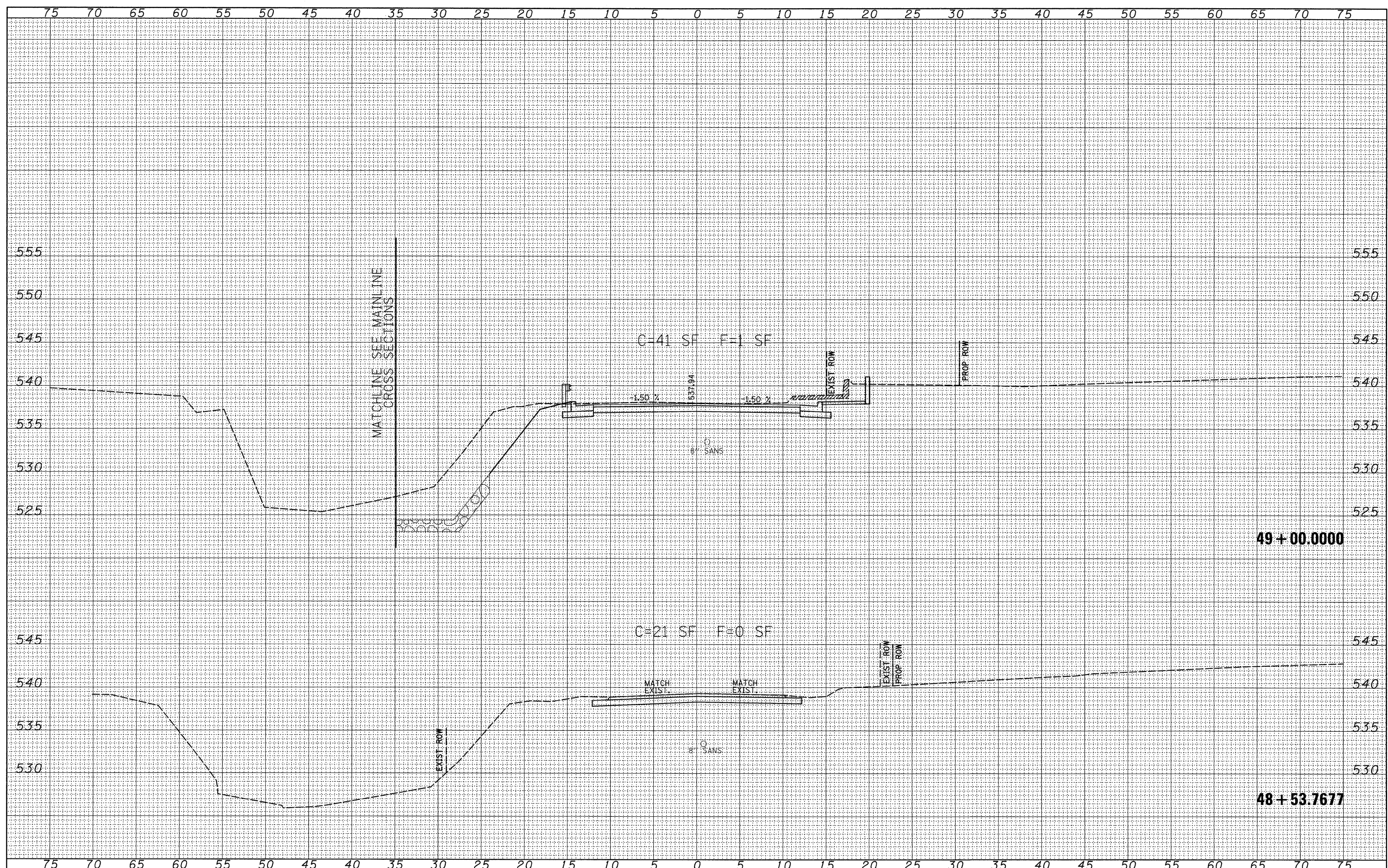

FILE NAME = #FILE#	USER NAME = #USER#	DESIGNED -	REVISED -	STATE OF ILLINOIS DEPARTMENT OF TRANSPORTATION	SOUTH ELM STREET - CROSS SECTIONS SCALE: 1"=5' SHEET NO. 1 OF 2 SHEETS STA. 48+53.7677 TO STA. 49+00.0000	F.A.P. RTE. 522	SECTION (6G-WPS)IBR	COUNTY HANCOCK	TOTAL SHEETS 41	SHEET NO. 40	
	DESIGNED -	REVISED -				FED. ROAD DIST. NO.	ILLINOIS FED. AID PROJECT				
	DRAWN -	REVISED -									
	CHECKED -	REVISED -									
	DATE -	REVISED -									