

F.A.P. RTE.	SECTION	COUNTY	TOTAL SHEETS	SHEET NO.
301	43T&M	JoDaviess	80	39
STA. 99+27		TO STA. 114+33		
FED. ROAD DIST. NO.		ILLINOIS FED. AID PROJECT		

STORM SEWER
 STM 4
 11 LF STORM SEWERS,
 CLASS A, TYPE 2, 12"
 @ 0.40%

STM 5
 8 LF STORM SEWERS,
 CLASS A, TYPE 2, 18"
 @ 0.40%

STORM STRUCTURES

④ PRECAST R.C. FLARED
 END SECTION 12"
 STA 110+20.6
 49.6' RT TO INVERT
 INVERT = 607.96

⑤ PRECAST R.C. FLARED
 END SECTION 18"
 WITH GRATING
 STA 112+72.2
 46.0' RT TO INVERT
 INVERT = 606.01

PLAN	SURVEYED	BY	DATE
NO.	NO.		
NO.	NO.		

PROFILE	SURVEYED	BY	DATE
NO.	NO.		
NO.	NO.		

PLT DATE = 12/1/2009
 FILE NAME = G:\ENR\64C68\13_TASK\7\CAMILLUS\0114666_SHT039.dwg
 PLOT SCALE = #SCALE#
 USER NAME = #USER#

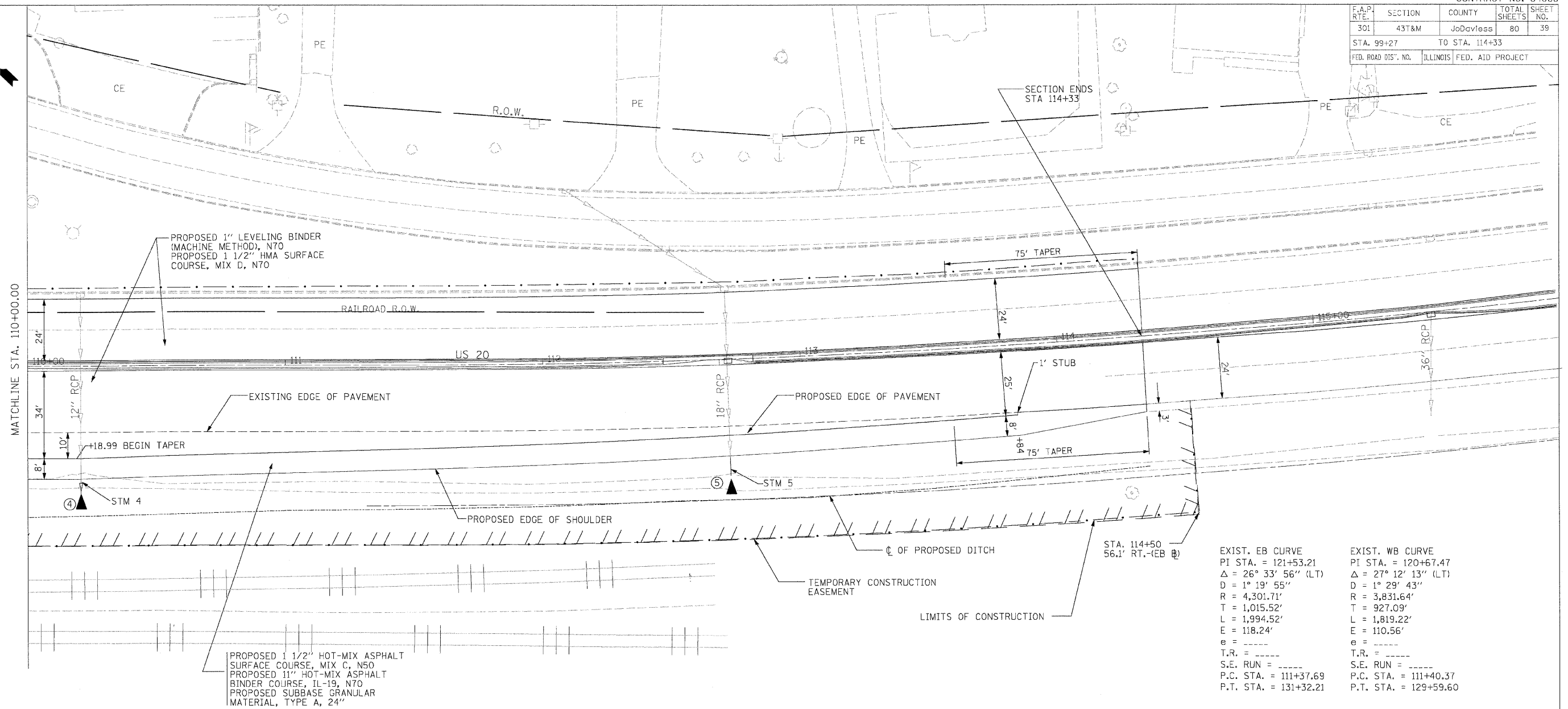

EXIST. EB CURVE	EXIST. WB CURVE
PI STA. = 121+53.21	PI STA. = 120+67.47
Δ = 26° 33' 56" (LT)	Δ = 27° 12' 13" (LT)
D = 1° 19' 55"	D = 1° 29' 43"
R = 4,301.71'	R = 3,831.64'
T = 1,015.52'	T = 927.09'
L = 1,994.52'	L = 1,819.22'
E = 118.24'	E = 110.56'
e = -----	e = -----
T.R. = -----	T.R. = -----
S.E. RUN = -----	S.E. RUN = -----
P.C. STA. = 111+37.69	P.C. STA. = 111+40.37
P.T. STA. = 131+32.21	P.T. STA. = 129+59.60

PROPOSED 1 1/2" HOT-MIX ASPHALT
 SURFACE COURSE, MIX C, N50
 PROPOSED 11" HOT-MIX ASPHALT
 BINDER COURSE, IL-19, N70
 PROPOSED SUBBASE GRANULAR
 MATERIAL, TYPE A, 24"

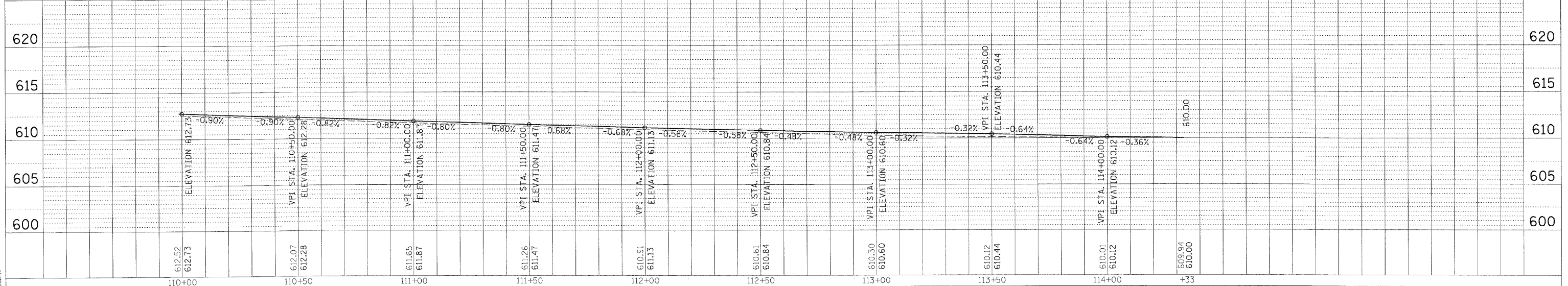

USER NAME = #USER#	DESIGNED KAC	REVISED -
PLOT SCALE = #SCALE#	DRAWN BY: CKL/TMF	REVISED -
PLOT DATE = 12/1/2009	CHECKED BY: KAC	REVISED -
	DATE: 11/13/2009	REVISED -

STATE OF ILLINOIS
DEPARTMENT OF TRANSPORTATION

US-20 /CAMILLUS DRIVE PROPOSED PLAN & PROFILE	
SCALE: 1" = 20'	SHEET NO. 39 OF 80 SHEETS
STA. 99+27	TO STA. 114+33

F.A.P. RTE.	SECTION	COUNTY	TOTAL SHEETS	SHEET NO.
301	43T&M	JODAVIESS	80	39
FED. ROAD DIST. NO.		ILLINOIS FED. AID PROJECT		