

STRUCTURES							
NO.	STATION	OFFSET	TYPE	EX. FRAME	PR. FRAME	RIM / EP	INVERT
S-71	228+57.9	28.4' RT	-	TY 11	TY 1 OL	-	-
S-72	228+77	32' RT	-	TY 1 CL	TY 1 CL	-	-
S-73	228+97	32' RT	-	TY 1 CL	TY 1 CL	-	-
S-74	229+02	39' RT	INLET, TYPE A	TY 11	TY 11	-	-
S-75	229+51	35.8' RT	-	TY 1 OL	TY 1 OL	-	-
S-76	228+76	31' LT	-	TY 1 CL	TY 1 CL	-	-
S-77	228+84	31' LT	-	TY 1 CL	TY 1 CL	-	-

WATER MAIN FITTINGS (RJT)							
WM-F91	STA. 229+58, 40' LT	8" X 6" HYDRANT TEE					
WM-F92	STA. 231+91.5, 41.7' LT	8" X 6" HYDRANT TEE					
WM-F93	STA. 232+04, 43' LT	8" - 45' BEND					
WM-F94	STA. 232+08.5, 39' LT	8" - 45' BEND					
WM-F95	NOT USED						
WM-F96	STA. 232+12.5, 40' LT	8" SLEEVE					
WM-F97	STA. 228+91, 48' LT	8" - 45' BEND					
WM-F98	STA. 228+85.5, 53.5' LT	8" - 45' BEND					
WM-F99	STA. 228+85.5, 57' LT	8" SLEEVE					
WM-F100	NOT USED						
WM-F101	STA. 229+68, 34' LT	6" - 45' BEND					
WM-F102	STA. 229+62.5, 28.5' LT	6" - 45' BEND					
WM-F103A	STA. 229+63.5, 41' RT	6" X 4" REDUCER					
WM-F103B	STA. 229+63.5, 43' RT	4" SLEEVE					

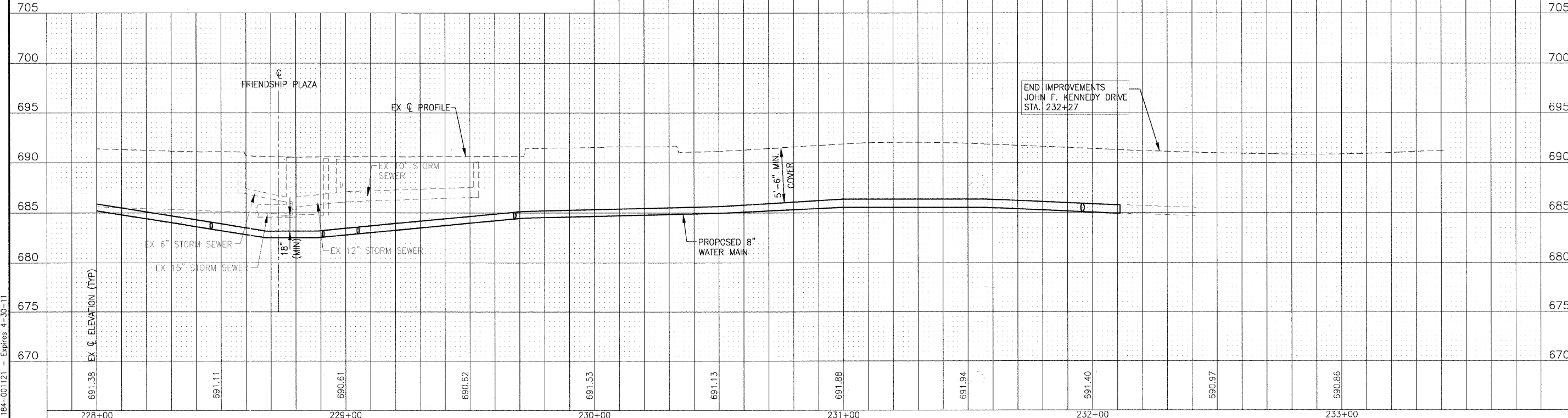

	DESIGNED - JWS	REVISED - VILLAGE REVIEW 9-08-09	VILLAGE OF ADDISON, ILLINOIS MILL ROAD AND ARMY TRAIL BOULEVARD STP IMPROVEMENTS	DRAINAGE AND UTILITY JOHN F KENNEDY DRIVE	*3884 ARMY TRAIL BLVD. *2625 MILL ROAD	F.A.U. RITE.	SECTION	COUNTY	TOTAL SHEETS	SHEET NO.
	DRAWN - UKB	REVISED - VILLAGE REVIEW 11-05-09				C-91-056-10	09-00098-00-RS	DuPage	69	42
CHECKED - SMV	REVISED - IDOT REVIEW 11-17-09	SCALE: HORIZ. 1"=20' / VERT. 1"=5'		PROJECT NO: 070142 STA. 228+00 TO STA. 233+34		CONTRACT NO. 63427		ILLINOIS FED. AID PROJECT M-9003 (474)		
DATE - 8-19-09	REVISED -									

I:\ADDON\070142-ARMY TRAIL-MILL LAPP & WATER MAIN\CADD-SURVEY\DRAWINGS\DWGS\070142-ARMY-TR-WM-PRE.DWG PP42
 Plotted: 11/23/2009 9:51 PM By: 231UKB
 Copyright © 2009, By Baxter & Woodman, Inc.
 State of Illinois - Professional Design Firm
 License No. - 184-001121 - Expires 4-30-11