

WATER MAIN PIPES

- WM-P21
125 L.F. OF 10" WATER MAIN (RJT)
- WM-P22
50 L.F. OF 8" WATER MAIN (RJT)
- WM-P23
390 L.F. OF 8" WATER MAIN

WATER MAIN FITTINGS (RJT)

- WM-F3
SEE MILL RD. FOR INFO
- WM-F4
SEE MILL RD FOR INFO.
- WM-F40
STA. 198+95, 26' RT
8" SLEEVE
- WM-F41
STA. 198+97, 26' RT
10" X 8" REDUCER
- WM-F42
STA. 199+90, 24' RT
10" - 22 1/2" BEND
- WM-F43
STA. 199+97, 21' RT
10" - 45" BEND
- WM-F44
STA. 200+07, 8' RT
8" - 22 1/2" BEND
- WM-F45
NOT USED
- WM-F46
STA. 200+18, 13' RT
8 X 6" TEE

FIRE HYDRANTS

- WM-FH9
STA. 202+18, 36' RT
FIRE HYDRANT WITH 18 L.F. OF
6" LEADER PIPE (RJT)
- WM-FH10
NOT USED

WATER MAIN VALVES

- WM-V16
STA. 199+83, 25' RT
10" GATE VALVE WITH 5' DIA
VALVE VAULT
- WM-V17
STA. 200+20, 8' RT
8" GATE VALVE WITH 5' DIA
VALVE VAULT

BEGIN IMPROVEMENTS
ARMY TRAIL BOULEVARD
STA. 198+90

ARMY TRAIL BLVD. STA. 200+00
MILL ROAD STA. 100+00

CONNECTIONS TO EXISTING
WATER MAINS
(NON-PRESSURE) - 8"

BCM#10 DUPAGE COUNTY

TRAFFIC SIGNAL TO
BE SUPPORTED/
BRACED (BY
CONTRACTOR)

STRUCTURES							
NO.	STATION	OFFSET	TYPE	EX. FRAME	PR. FRAME	RIM / EP	INVERT
S-26A	199+43.9	32.6' RT	-	TY 3	TY 3	-	-
S-27	199+95.4	28.4' LT	-	TY 1 CL	TY 1 CL	-	-
S-28	200+19.8	33.3' LT	-	TY 1 CL	TY 1 CL	-	-
S-29	200+12	37.5' RT	INLET, TYPE A	TY 3	TY 3	-	-
S-30	200+11.8	33.4' RT	-	TY 1 CL	TY 1 CL	-	-
S-30A	200+14	40' RT	-	TY 1 CL	TY 1 CL	-	-

STRUCTURES							
NO.	STATION	OFFSET	TYPE	EX. FRAME	PR. FRAME	RIM / EP	INVERT
S-31	NOT USED	-	-	-	-	-	-
S-32	200+79.4	0.0' RT	-	TY 11	TY 11	-	-
S-33	201+14	1.06' RT	-	TY 11	TY 11	-	-
S-34	201+13	27.7' RT	INLET, TYPE A	TY 3	TY 3	-	-
S-35	202+54	0.4' RT	-	TY 11	TY 11	-	-
S-36	202+59.6	2.3' LT	-	TY 1 CL	TY 1 CL	-	-
S-37	202+59.5	29.7' RT	-	TY 3	TY 3	-	-
S-38	202+72.9	26.5' RT	-	TY 1 CL	TY 1 CL	-	-
S-39	203+21.6	29.6' RT	-	TY 1 CL	TY 1 CL	-	-

PIPES					
NO.	TYPE	LENGTH (LF)	DIA (IN)	SLOPE	TBF (CY)
P-15	STORM SEWER (WATER MAIN REQUIREMENTS)	20	12	MATCH EX	13
P-16	STORM SEWER (WATER MAIN REQUIREMENTS)	27	10	MATCH EX	9
P-17	STORM SEWER (WATER MAIN REQUIREMENTS)	30	10	MATCH EX	6

ARMY TRAIL BOULEVARD

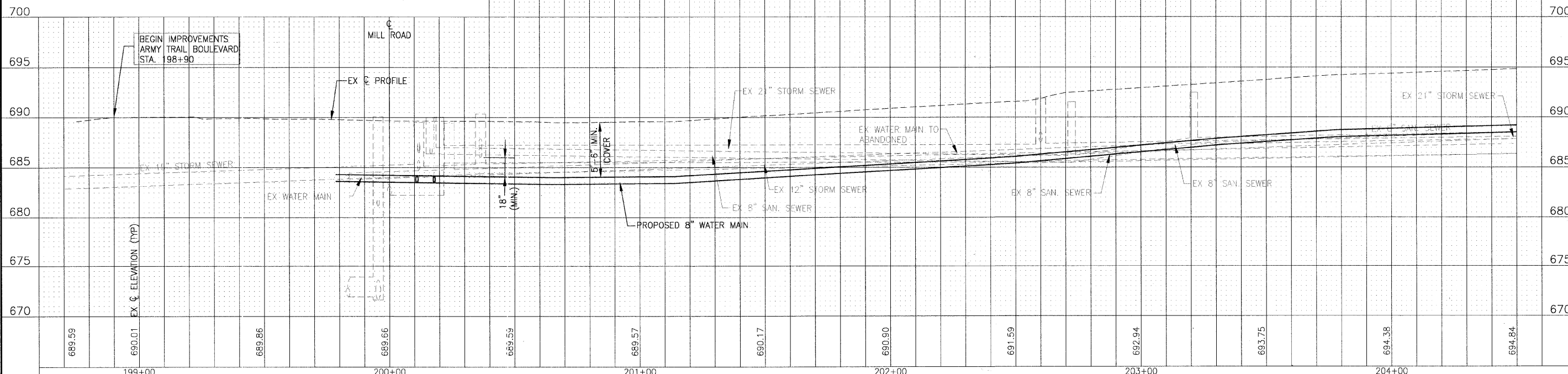

DESIGNED - JJS	REVISED - VILLAGE REVIEW 9-08-09
DRAWN - UKB	REVISED - VILLAGE REVIEW 11-05-09
CHECKED - SMV	REVISED - IDOT REVIEW 11-17-09
DATE - 8-19-09	REVISED - VILLAGE REVIEW 12-07-09

**VILLAGE OF ADDISON, ILLINOIS
MILL ROAD AND ARMY TRAIL BOULEVARD
STP IMPROVEMENTS**

DRAINAGE AND UTILITY
ARMY TRAIL BOULEVARD
*3884 ARMY TRAIL BLVD.
*2625 MILL ROAD
SCALE: HORIZ. 1"=20' / VERT. 1"=5'
PROJECT NO: 070142 STA. 198+50 TO STA. 204+50

F.A.U. RITE	SECTION	COUNTY	TOTAL SHEETS	SHEET NO.
*	09-00098-00-RS	DuPage	69	36
C-91-056-10		CONTRACT NO. 63427		
FED. ROAD DIST. NO. 1		ILLINOIS FED. AID PROJECT M-9003 (474)		

I:\ADDON\070142-ARMY TRAIL-MILL LAPP & WATER MAIN\CADD-SURVEY\DRAWINGS\DWGS\070142-ARMY-TR-WM-PRF.DWG PP36
 Printed: 12/18/2009 1:57 PM By: 231UKB
 Contract: © 2009 By: Baxter & Woodman, Inc.
 State of Illinois - Professional Design Firm
 License No. - 184-001121 - Expires 4-30-11

