

STRUCTURES							
NO.	STATION	OFFSET	TYPE	EX. FRAME	PR. FRAME	RIM / EP	INVERT
S-26	123+91.6	11.9' RT	-	TY 1 CL	TY 1 CL	-	-
S-26A	123+63	34' LT	-	TY 1 CL	TY 1 CL	-	-

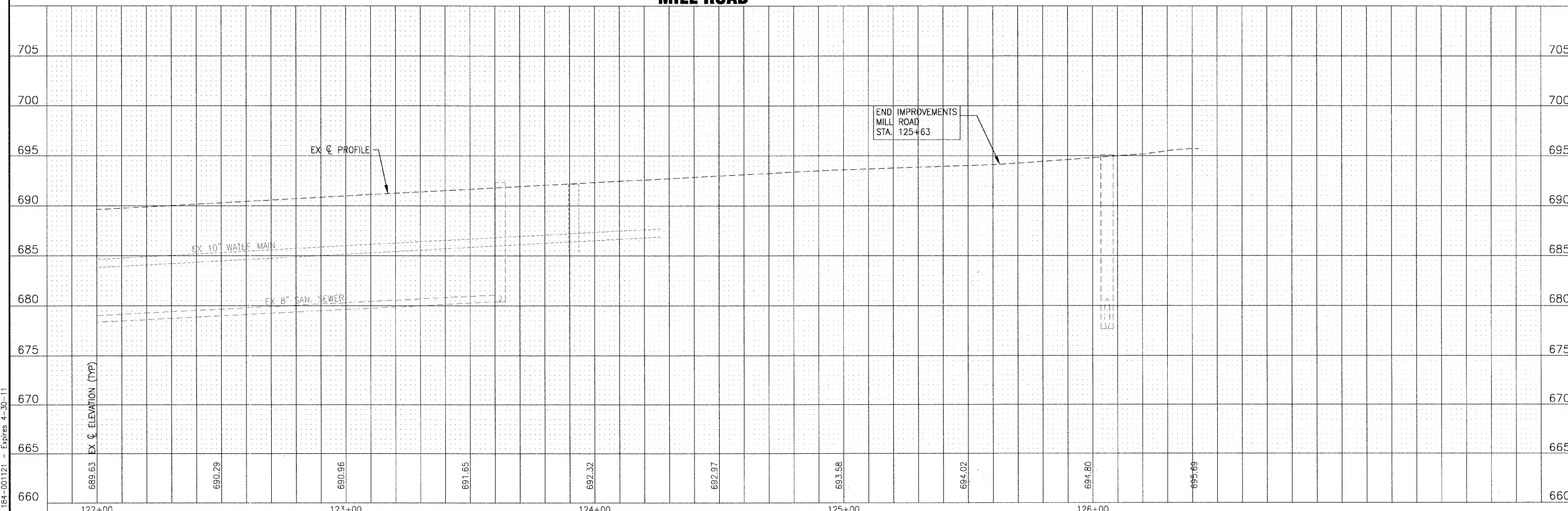

I:\ADDN\070142-ARMY TRAIL-MILL LAPP & WATER MAIN\CADD-SURVEY\DRAWINGS\DWGS\070142-MILL-WM-PRE DWG PP35
 Plotted: 11/18/2009 12:44 PM By: 231UKB
 Copyright © 2009, By: Baxter & Woodman, Inc.
 State of Illinois - Professional Design Firm
 License No. - 184-001121 - Expires 4-30-11

	DESIGNED - JJS	REVISED - VILLAGE REVIEW 9-08-09
	DRAWN - UKB	REVISED - VILLAGE REVIEW 11-05-09
	CHECKED - SMV	REVISED - IDOT REVIEW 11-17-09
	DATE - 8-19-09	REVISED -

VILLAGE OF ADDISON, ILLINOIS
MILL ROAD AND ARMY TRAIL BOULEVARD
STP IMPROVEMENTS

DRAINAGE AND UTILITY
MILL ROAD
 SCALE: HORIZ. 1"=20' / VERT. 1"=5'
 PROJECT NO: 070142 STA. 122+00 TO STA. 125+63

F.A.U. RTE.	SECTION	COUNTY	TOTAL SHEETS	SHEET NO.
*	09-00098-00-RS	DuPage	69	35
C-91-056-10		CONTRACT NO. 63427		
FED. ROAD DIST. NO. 1 ILLINOIS FED. AID PROJECT M-9003 (474)				