

GENERAL NOTES

EMERGENCY SERVICES NOTIFICATION.

EMERGENCY ACCESS SHALL BE MAINTAINED AT ALL TIMES.

THE CONTRACTOR SHALL ADVISE ALL EMERGENCY RESPONDERS A MINIMUM OF 3 DAYS IN ADVANCE OF CONSTRUCTION ACTIVITIES WHICH IMPACT ALL EMERGENCY SERVICES. THIS WILL INCLUDE, BUT IS NOT LIMITED TO, THE ADDISON FIRE DEPARTMENT.

1. THE CONTRACTOR SHALL MAINTAIN EXISTING LANE WIDTHS FOR TRAFFIC FLOW THROUGHOUT THE DURATION OF THE CONTRACT UNLESS OTHERWISE DETERMINED BY THE ENGINEER.
2. ALL SIDE STREETS SHALL BE OPEN TO TRAFFIC THROUGHOUT THE DURATION OF THE CONTRACT UNLESS OTHERWISE NOTED IN THE SUGGESTED SEQUENCE OF CONSTRUCTION.
3. DURING MILL ROAD AND ARMY TRAIL BOULEVARD STAGE I AND II WATER MAIN WORK, THE VILLAGE WILL OPERATE THE MILL/ARMY TRAIL BOULEVARD AND LINCOLN/ARMY TRAIL BOULEVARD TRAFFIC SIGNALS IN FLASHING RED/STOP CONTROL MODE. (SEE BELOW)
4. THE CONTRACTOR SHALL NOTIFY THE VILLAGE A MINIMUM OF 72 HOURS PRIOR TO CONSTRUCTION OPERATIONS INVOLVING THE TEMPORARY CLOSING OF DRIVES OR THE ROADWAY. THE CONTRACTOR SHALL PROVIDE A 48-HOUR NOTICE TO AFFECTED PARTIES BY DISTRIBUTING WRITTEN NOTICES AND/OR POSTING SIGNS.
5. BUSINESSES SHALL HAVE ACCESS TO THEIR DRIVES. THE SHELL GAS STATION ARMY TRAIL BOULEVARD DRIVEWAY SHALL BE CLOSED.
6. THE ENGINEER SHALL BE INFORMED 72-HOURS IN ADVANCE OF ANY CHANGE IN CONSTRUCTION STAGING.
7. TYPE I BARRICADES, BARRELS AND VERTICAL PANELS SHALL BE EQUIPPED WITH MONO-DIRECTIONAL STEADY BURN LIGHTS AND SHALL BE PLACED AT EITHER 25-FOOT OR 50-FOOT INTERVALS ALONG THE PROPOSED CONSTRUCTION ZONE PENDING LOCATION AND 20-FOOT INTERVALS WITHIN TAPER SECTIONS OR AS DETERMINED BY THE ENGINEER.
8. UTILIZE TEMPORARY PAVEMENT MARKINGS ON MILL ROAD AND ARMY TRAIL BOULEVARD. TEMPORARY PAVEMENT MARKINGS SHALL NOT DAMAGE EXISTING PAVEMENT MARKINGS TO REMAIN. ANY AND ALL REPLACEMENT OF EXISTING PAVEMENT MARKINGS, AS DETERMINED BY THE ENGINEER, SHALL BE INCLUDED IN THE COST FOR TRAFFIC CONTROL DETOUR.
9. ALL TEMPORARY PAVEMENT MARKINGS SHOWING DETERIORATION SHALL BE REPLACED BY THE CONTRACTOR AS DETERMINED BY THE ENGINEER. ALL MARKINGS REQUIRING REPLACEMENT SHALL BE REPLACED BY THE CONTRACTOR AT THEIR OWN EXPENSE.
10. THE FURNISHING, INSTALLING AND RELOCATION OF ALL TRAFFIC SIGNS SHALL BE INCLUDED IN THE COST FOR TRAFFIC CONTROL AND PROTECTION. ALL CONFLICTING TRAFFIC SIGNS AND TRAFFIC DETOUR SIGNS WHEN NOT IN USE ON MILL ROAD OR ARMY TRAIL BOULEVARD SHALL BE COVERED AS DETERMINED BY THE ENGINEER. THIS SHALL BE INCLUDED IN THE COST FOR TRAFFIC CONTROL DETOUR.
11. CONTRACTOR SHALL INSTALL AND MAINTAIN SIGNAGE TO ESTABLISH A 20 MPH SPEED LIMIT THROUGHOUT THE CONSTRUCTION ZONE. SIGNAGE SHALL BE INCLUDED IN THE COST OF THE TRAFFIC CONTROL DETOUR. NUMBER AND PLACEMENT OF SIGNS SHALL BE AS DETERMINED BY THE ENGINEER AND VILLAGE.
12. ARMY TRAIL BOULEVARD IS DESIGNATED A "NO TRUCK ROUTE" FROM ROHLWING ROAD TO LAKE STREET. MILL ROAD AND ARMY TRAIL BOULEVARD ARE OFF LIMITS TO CONSTRUCTION TRUCK TRAFFIC EXCEPT WHERE THE WORK IS BEING PERFORMED. TRUCK TRAFFIC SHALL ONLY ACCESS THE JOBSITE THROUGH THE TWO INTERSECTIONS OF MILL ROAD AND JOHN F. KENNEDY DRIVE WITH LAKE STREET.

SUGGESTED SEQUENCE OF CONSTRUCTION

- STAGE I:
1. STAGE I CAN BEGIN ON OR AFTER JUNE 1, 2010. INSTALL TRAFFIC CONTROL SIGNAGE AND CHANGEABLE MESSAGE SIGNS. SET UP LANE CLOSURES AND SIGNAGE FOR ONE-WAY SOUTH BOUND MILL ROAD. REMOVE MEDIAN IN JOHN F. KENNEDY DRIVE AND REPLACE WITH TEMPORARY PAVEMENT AS SHOWN ON THE PLANS.
 2. ONE DAY PRIOR TO BEGINNING WATER MAIN AND STORM SEWER CONSTRUCTION, SHIFT ALL ARMY TRAIL BLVD. TRAFFIC TO THE EXISTING WESTBOUND PAVEMENT USING LANE CLOSURES IN THE HIGHWAY STANDARDS. ALLOW TRAFFIC TO TRAVEL IN ONE LANE IN EACH DIRECTION PER THE STAGE I TYPICAL SECTION. SET MILL ROAD AND ARMY TRAIL BOULEVARD AND LINCOLN AVENUE AND ARMY TRAIL BOULEVARD INTERSECTION TRAFFIC SIGNALS TO FLASHING RED/STOP CONTROL MODE.
 3. WATER MAIN AND STORM SEWER CONSTRUCTION SHALL NOT BEGIN UNTIL AFTER SCHOOL DISTRICT 4'S 2009/10 YEAR ENDS (JUNE 4, 2010, WINTER WEATHER PERMITTING).
 4. INSTALL WATER MAINS ALONG MILL ROAD AND ARMY TRAIL BOULEVARD. CONSTRUCT STORM SEWER ACROSS PORTIONS OF ROADWAYS CLOSED TO TRAFFIC ONLY. TEMPORARILY PLUG LATERALS TO BE EXTENDED IN FUTURE STAGE II. PROVIDE TEMPORARY PAVEMENT ON WATER MAIN AND STORM SEWER TRENCHES AT LOCATIONS OPEN TO TRAFFIC AND INTERSECTIONS AT THE END OF EACH DAY OR AS DETERMINED BY THE ENGINEER.
 5. ACTIVATE INSTALLED WATER MAIN. THE CONTRACTOR SHALL NOTIFY THE VILLAGE AND ENGINEER THREE (3) WEEKS PRIOR TO CLOSING THE MILL ROAD AND ARMY TRAIL BOULEVARD INTERSECTION FOR STAGE II.
 6. ONE WEEK PRIOR TO CLOSING THE MILL ROAD AND ARMY TRAIL BOULEVARD INTERSECTION (FOR STAGE II), BEGIN INSTALLING STAGE II DETOUR SIGNAGE AND COVER STAGE II SIGNS.
- STAGE II:
1. AFTER MONDAY EVENING RUSH HOUR TRAFFIC (OR AFTER 7:30 P.M. WHICH EVER IS LATER), CLOSE THE MILL ROAD AND ARMY TRAIL BOULEVARD INTERSECTION. UNCOVER STAGE II SIGNS AND COVER APPROPRIATE STAGE I SIGNS. TURN MILL ROAD AND ARMY TRAIL BOULEVARD INTERSECTION TRAFFIC SIGNALS OFF. MAINTAIN FLASHING RED/STOP CONTROL MODE AT ARMY TRAIL BOULEVARD AND LINCOLN AVENUE.
INSTALL REMAINING WATER MAIN AND STORM SEWER ON TUESDAY, WEDNESDAY AND THURSDAY. PROVIDE TEMPORARY PAVEMENT ON WATER MAIN AND STORM SEWER TRENCHES AT LOCATIONS OPEN TO TRAFFIC AND INTERSECTIONS AT THE END OF EACH DAY OR AS DETERMINED BY THE ENGINEER.
AFTER THURSDAY EVENING RUSH HOUR TRAFFIC (OR AFTER 7:30 P.M. WHICH EVER IS LATER), RETURN MILL ROAD AND ARMY TRAIL BOULEVARD TO STAGE I. COVER/REMOVE STAGE II SIGNS AND UNCOVER STAGE I SIGNS. SET MILL ROAD AND ARMY TRAIL BOULEVARD INTERSECTION TRAFFIC SIGNALS TO FLASHING RED/STOP CONTROL MODE.
(IF WATER MAIN TESTING FAILS, REPEAT STAGE I AND II AS NECESSARY AFTER COORDINATION WITH THE VILLAGE AND ENGINEER).
 2. ACTIVATE REMAINING WATER MAIN.
COMPLETION DATE AUGUST 20, 2010 (67 CALENDAR DAYS IF CONSTRUCTION BEGINS JUNE 14, 2010).
ACTIVATION OF REMAINING WATER MAIN SHALL BE COMPLETED BEFORE SCHOOL DISTRICT 4'S 2010/11 YEAR BEGINS (THE WEEK OF AUGUST 23, 2010).
 3. COMPLETE MILLING, PATCHING, AND CURB AND GUTTER REMOVAL AND REPLACEMENT.
 4. REMOVE LANE CLOSURES AND SIGNAGE. RESTORE MILL ROAD AND ARMY TRAIL BOULEVARD AND LINCOLN AVENUE AND ARMY TRAIL BOULEVARD INTERSECTION TRAFFIC SIGNALS TO NORMAL OPERATION.
OPEN ROADWAYS TO NORMAL LANE CONFIGURATIONS.

- PROJECT COMPLETION:
1. COMPLETE RESURFACING AND PAVEMENT MARKINGS UNDER TRAFFIC.
 2. SUBSTANTIAL COMPLETION.
 3. CONDUCT WALK THROUGH INSPECTION WITH VILLAGE AND ENGINEER.
 4. COMPLETE PUNCH LIST ITEMS.
 5. REMOVE CHANGEABLE MESSAGE SIGNS.
 6. FINAL COMPLETION DATE IS OCTOBER 28, 2010 WHICH IS 136 CALENDAR DAYS AFTER JUNE 14, 2010.

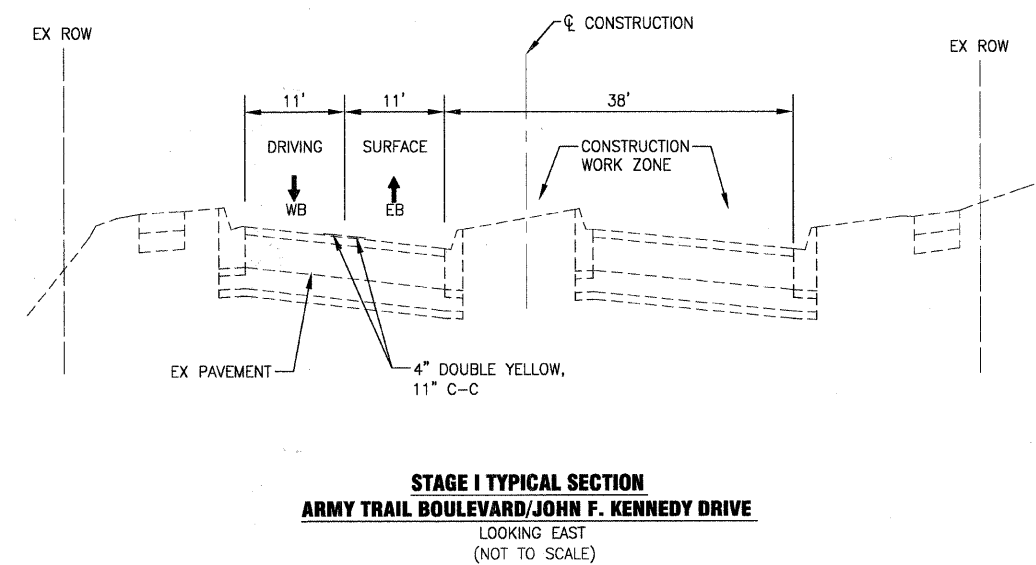
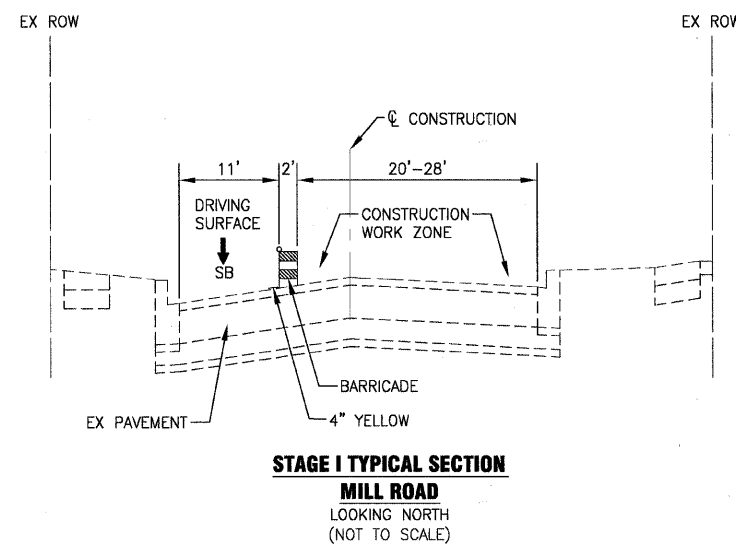

I:\ADDN\070142-ARMY TRAIL-MILL LAPP & WATER MAIN\CADD-SURVEY\DRAWINGS\DWG\070142-MAINT-TRFC-STG-NTES.DWG 25
 Plotted: 12/9/2009 6:23 PM By: 2310RB
 Copyright © 2009, by Baxter & Woodman, Inc.
 State of Illinois Professional Engineer License No. 184-001121 - Expires 4-30-11



DESIGNED - MWP	REVISED - VILLAGE REVIEW 9-08-09
DRAWN - UKB	REVISED - VILLAGE REVIEW 11-05-09
CHECKED - RWL	REVISED - IDOT REVIEW 11-17-09
DATE - 8-19-09	REVISED - VILLAGE REVIEW 12-07-09

**VILLAGE OF ADDISON, ILLINOIS
MILL ROAD AND ARMY TRAIL BOULEVARD
STP IMPROVEMENTS**

CONSTRUCTION STAGING	
SCALE:	PROJECT NO: 070142 STA. TO STA.

*3884 ARMY TRAIL BLVD. *2625 MILL ROAD		F.A.U. RTE.	SECTION	COUNTY	TOTAL SHEETS	SHEET NO.
		*	09-00098-00-RS	DuPage	69	25
		C-91-056-10		CONTRACT NO. 63427		
		FED. ROAD DIST. NO. 1	ILLINOIS	FED. AID PROJECT M-9003 (474)		