

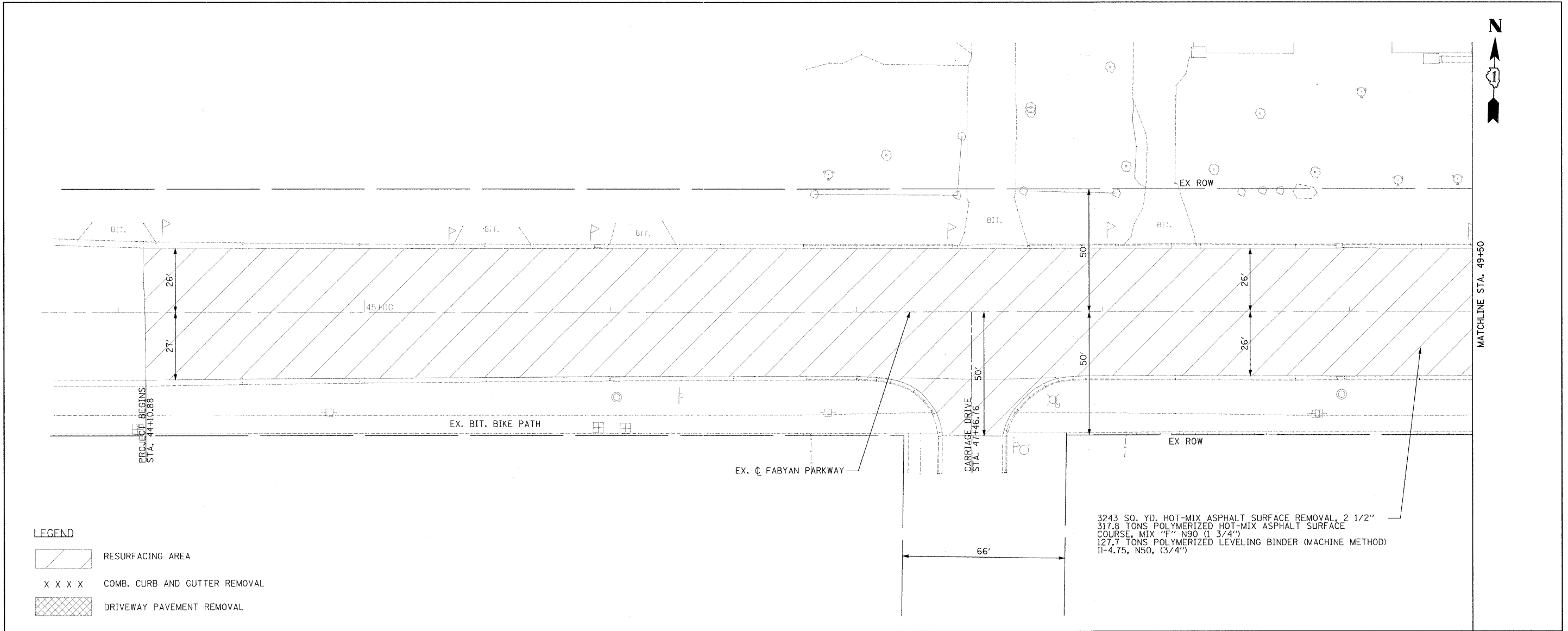



PLAN SURVEYED BY DATE  
 ALIGNED CHECKED BY  
 NOTE BOOK NO. FILE MAP NO.

PROFILE SURVEYED BY DATE  
 PLOTTED CHECKED BY  
 NOTE BOOK NO. FILE MAP NO.  
 STRUCTURE NOTATIONS CHFD



LEGEND

-  RESURFACING AREA
-  COMB. CURB AND GUTTER REMOVAL
-  DRIVEWAY PAVEMENT REMOVAL

3243 SQ. YD. HOT-MIX ASPHALT SURFACE REMOVAL, 2 1/2"  
 317.8 TONS POLYMERIZED HOT-MIX ASPHALT SURFACE  
 COURSE, MIX "F" N90 (1 3/4")  
 127.7 TONS POLYMERIZED LEVELING BINDER (MACHINE METHOD)  
 II-4.75, N50, (3/4")

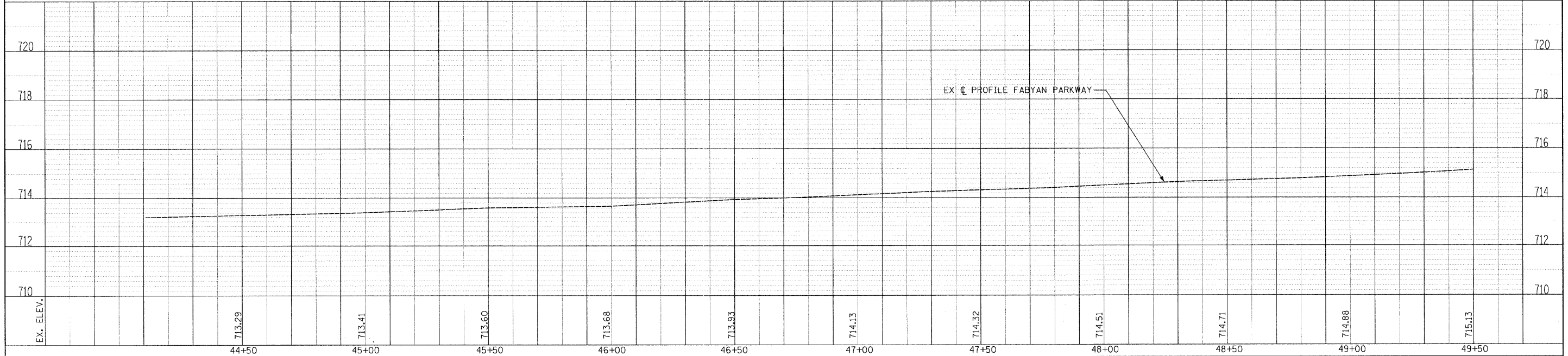

FILE NAME -	USER NAME - \$USER\$	DESIGNED - RDT	REVISED -	<b>STATE OF ILLINOIS DEPARTMENT OF TRANSPORTATION</b>	<b>FABYAN PARKWAY PLAN AND PROFILE</b>	F.A.P. RTE. 363	SECTION 08-00370-00-SP	COUNTY KANE	TOTAL SHEETS 32	SHEET NO. 12
\$FILE\$	PLOT SCALE - \$SCALE\$	DRAWN - RDT	REVISED -			C-91-510-08	CONTRACT NO. 63416			
	PLOT DATE - \$DATE\$	CHECKED - JAC	REVISED -			ILLINOIS FED. AID PROJECT HSIP-9003 (056)				
		DATE 12-08-09	REVISED			SCALE: H:1"=20'; V:1"=2'				