

HYDRANT TEE PAVEMENT MARKINGS NOT SHOWN FOR CLARITY. SEE DETAIL SHEET 26 OF 30. SEE SCHEDULE OF QUANTITIES FOR ALL PAVEMENT MARKING LOCATIONS AND INFORMATION.

ALL CROSSWALK AND STOP BAR PAVEMENT MARKINGS SHALL IN ACCORDANCE WITH THE LATEST IDOT STANDARDS AND THE MUTCD. STOP BARS NEAR CROSSWALKS SHALL BE LOCATED 4 FEET OFF THE CROSSWALK MARKINGS.

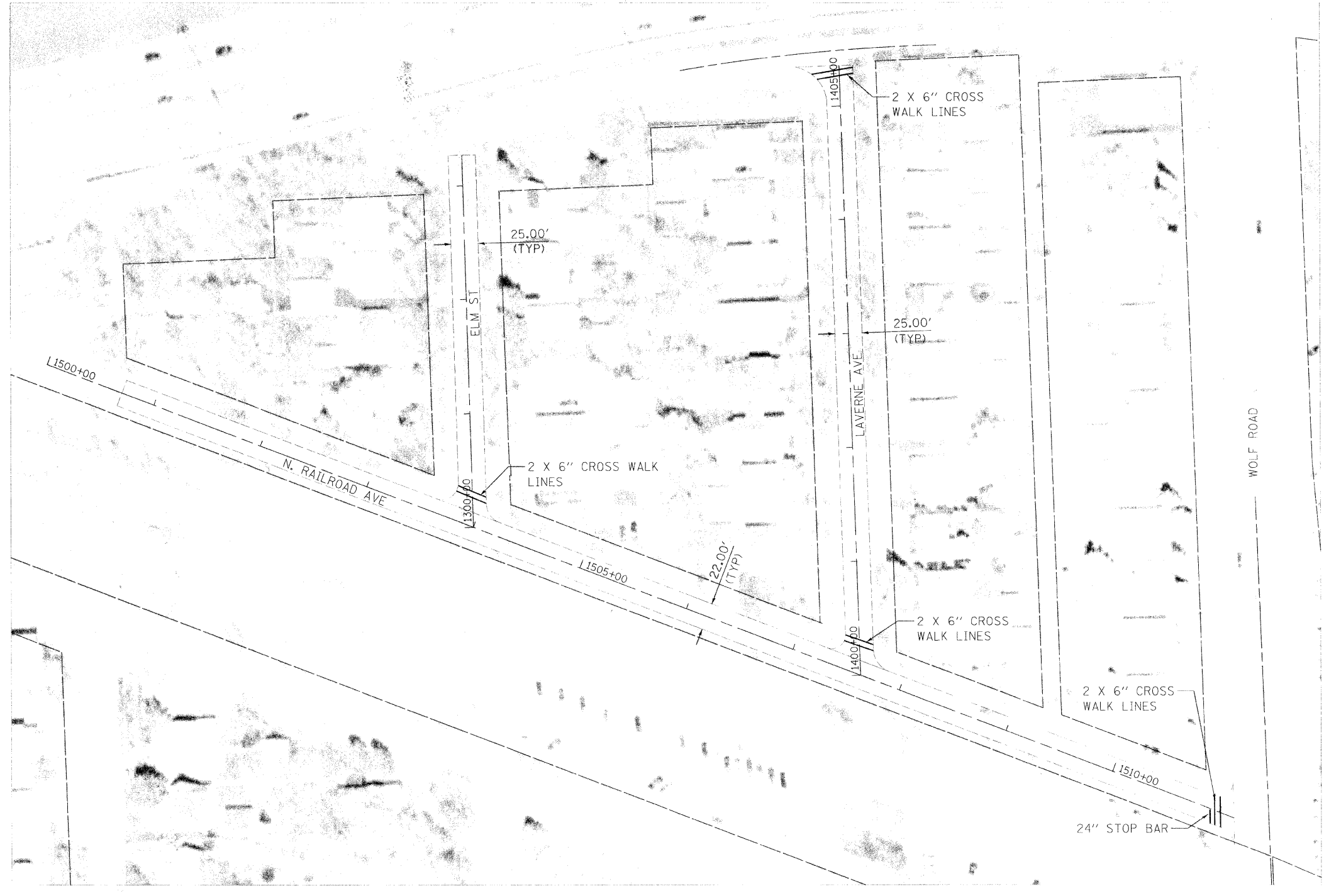

NORTH RAILROAD AVENUE, ELM STREET, & LAVERNE AVENUE

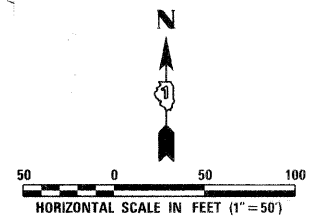

DESIGNED	DWP
DRAWN	DWP
CHECKED	SJM
DATE	11/30/09

REVISED	_____
REVISED	_____
REVISED	_____
REVISED	_____

STATE OF ILLINOIS
DEPARTMENT OF TRANSPORTATION

**NORTH RAILROAD AVENUE, ELM STREET,
& LAVERNE AVENUE**
PAVMENT MARKING PLAN SHEET

SCALE: 1" = 50' SHEET NO. 25 OF 30 SHEETS STA. _____ TO STA. _____

F.A. RTE.	SECTION	COUNTY	TOTAL SHEETS	SHEET NO.
	09-00046-00-RS	COOK	30	25
CONTRACT NO. 63414				
ILLINOIS FED. AID PROJECT				