

SECTION 36, TOWNSHIP 36, RANGE 12
SECTION 31, TOWNSHIP 36, RANGE 13

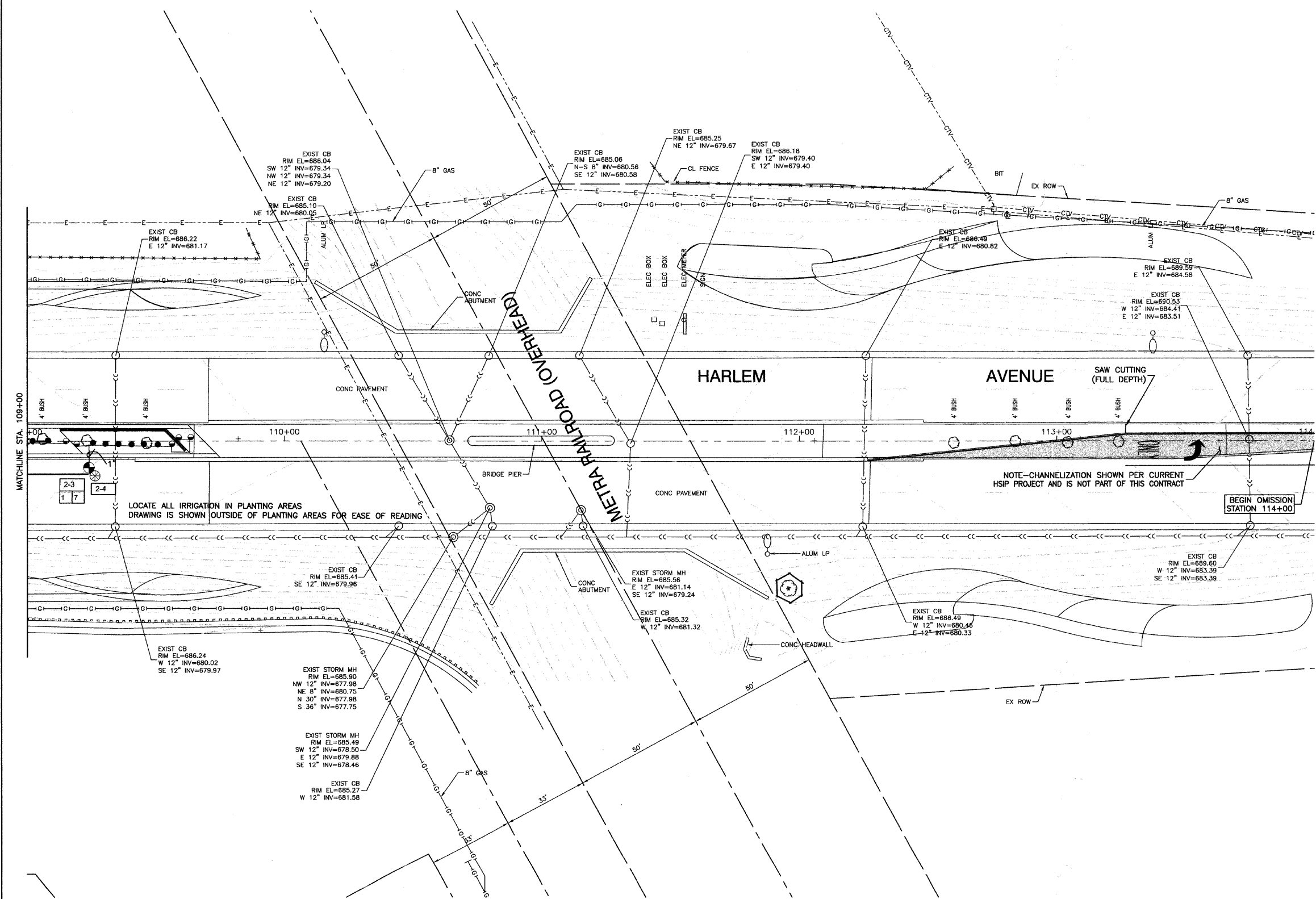
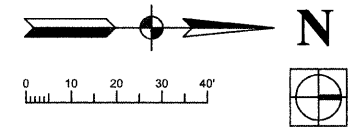

LEGEND

1 HUNTER XCH XC HYBRID CONTROLLER - BATTERY OPERATED OUTDOOR CONTROLLER WITH RAIN CLICK *OR ENGINEER APPROVED EQUAL. COORDINATE WITH ENGINEER FOR MOUNTING LOCATION, INSTALL AND GROUND TO MANUFACTURER'S RECOMMENDATIONS AND DETAILS. CONTROLLER IS TO BE LOCATED IN A KS-M2 ENCLOSURE BY BPOI *OR ENGINEER APPROVED EQUAL. COLOR TO BE DARK GREEN. INSTALL ENCLOSURE PER MANUFACTURER'S RECOMMENDATIONS. CONTRACTOR TO VERIFY ENCLOSURE SIZE

CL 160 PVC PIPE - MAINLINE, SEE PLAN FOR SIZES

1" & 1.5" PE HD100 PIPE

HUNTER INSTITUTIONAL SPRAY WITH CHECK VALVE

12" PRO SPRAY NOZZLES FULL CIRCLE *OR ENGINEER APPROVED EQUAL - NOZZLE RADIUS VARIES

HUNTER INSTITUTIONAL SPRAY WITH CHECK VALVE

12" PRO SPRAY NOZZLES PART CIRCLE *OR ENGINEER APPROVED EQUAL - NOZZLE RADIUS VARIES

HUNTER HQ-44RC SERIES QUICK COUPLER *OR ENGINEER APPROVED EQUAL

EXTRA WIRE DROP, LABEL AND LOCATE IN ADJACENT VALVE BOX.

ISOLATION GATE VALVE - SIZE TO PIPE

HUNTER PGV ELECTRIC VALVES *OR ENGINEER APPROVED EQUAL - SIZE PER PLAN VALVES TO HAVE DC LATCHING SOLENOID.

BLOW OUT TAP WITH PLUG

RPZ BACKFLOW PREVENTER AND METER - PROVIDED BY THIS CONTRACTOR RPZ TO BE LOCATED IN A ARTIFICIAL ROCK ENCLOSURE. COLOR AND STYLE TO BE APPROVED. CONTRACTOR IS RESPONSIBLE TO ENSURE THAT THE BACKFLOW FITS IN THE ENCLOSURE. INSTALL PER MANUFACTURER'S RECOMMENDATIONS. METER TO BE INSTALLED IN VILLAGE APPROVED VAULT.

POINT OF CONNECTION - COORDINATE WITH ENGINEER & GENERAL CONTRACTOR IRRIGATION TAPS VARY. FOLLOW STATE AND LOCAL CODES FROM TAP THROUGH BACKFLOW PREVENTOR, METER AND SYSTEM.

1-24 CONTROLLER NUMBER
1135 STATION NUMBER
1 MEDIAN LOCATION
1135 ZONE GPM
1 VALVE SIZE
50 SYSTEM STATIC PRESSURE (NOTIFY OWNER IF PRESSURE IS LESS)

CONTROLLER SIZING:

1	8 STATION
2	4 STATION
3	12 STATION
4	12 STATION
5	8 STATION

PULSE WIRE COLOR CODE #16 GA:

VALVE #	COLOR
1	RED
2	YELLOW
3	ORANGE
4	BLUE
5	WHITE - COMMON #16 GA.

NOTES:
PROPOSED PLANTINGS NOT SHOWN FOR CLARITY.
SEE LANDSCAPING PLANS.

BENCH MARK: 172

SQUARE CUT ON W. FACE OF CONC BASE OF ALP, 2ND POLE
S. OF I-80 EXIT RAMP TO NORTHBOUND HARLEM AVENUE
ELEVATION=704.09

FILE NAME = 09493-PLAN-01 - IR13	USER NAME =	DESIGNED - SDG	REVISED -
		CHECKED - JSP	REVISED -
	PLOT SCALE =	DRAWN - PS	REVISED -
	PLOT DATE = 11-30-09	CHECKED - AG	REVISED -

STATE OF ILLINOIS
DEPARTMENT OF TRANSPORTATION

HARLEM AVENUE BEAUTIFICATION - STREETSCAPING IRRIGATION PLAN	
SCALE: 1"=20'	SHEET NO. 26 OF 38 SHEETS
STA.	TO STA.

F.A.P. RTE.	SECTION	COUNTY	TOTAL SHEETS	SHEET NO.
348	09-00108-00-LS	COOK	38	28
CONTRACT NO. 63412				
FED. ROAD DIST. NO. 1 ILLINOIS FED. AID PROJECT ARA-00D1(809)				