

SECTION 36, TOWNSHIP 36, RANGE 12
SECTION 31, TOWNSHIP 36, RANGE 13

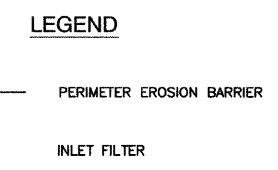
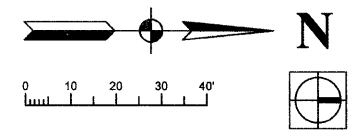
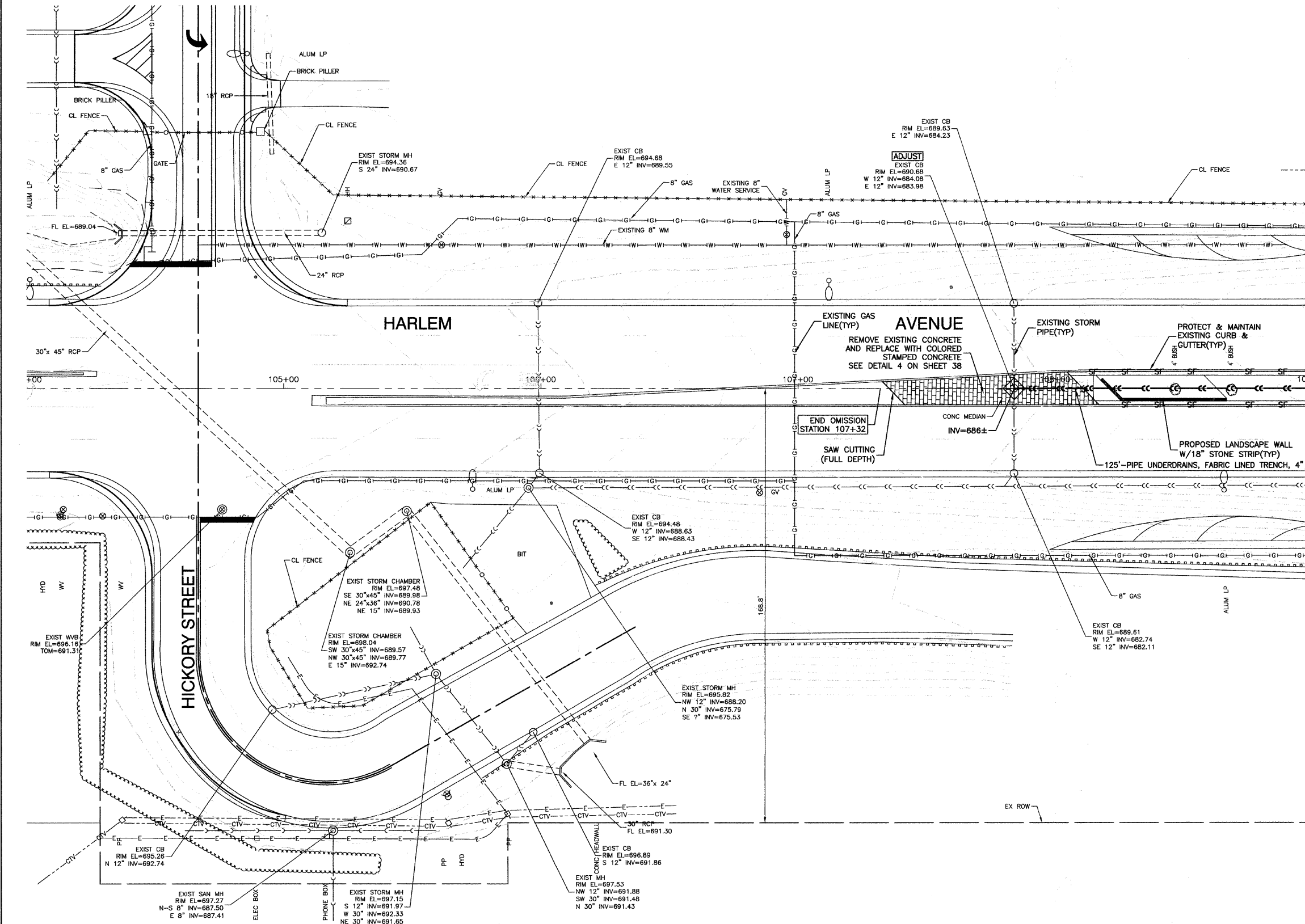

NOTES:
PROPOSED PLANTINGS NOT SHOWN FOR CLARITY.
SEE LANDSCAPING PLANS.

BENCH MARK: 172
SQUARE CUT ON W. FACE OF CONC BASE OF ALP, 2ND POLE
S. OF I-80 EXIT RAMP TO NORTHBOUND HARLEM AVENUE
ELEVATION=704.09

FILE NAME = 09493-PLAN-01 - D12	USER NAME =	DESIGNED — SDG	REVISED —
		CHECKED — JSP	REVISED —
	PLOT SCALE =	DRAWN — PS	REVISED —
	PLOT DATE = 11-30-09	CHECKED — AG	REVISED —

STATE OF ILLINOIS
DEPARTMENT OF TRANSPORTATION

HARLEM AVENUE BEAUTIFICATION - STREETSCAPING DRAINAGE AND EROSION CONTROL PLAN		F.A.P. RTE. 348	SECTION 09-00108-00-LS	COUNTY COOK	TOTAL SHEETS 38	SHEET NO. 17
SCALE: 1"=20'		SHEET NO. 17 OF 38 SHEETS		STA. TO STA.		FED. ROAD DIST. NO. 1 ILLINOIS FED. AID PROJECT ARA-00D1(809)

CONTRACT NO. 63412