

QUANTITY
 4 (100) LINE = 64.1 ft. (19.7 m)
 21.1 sq. ft. (1.97 sq. m)

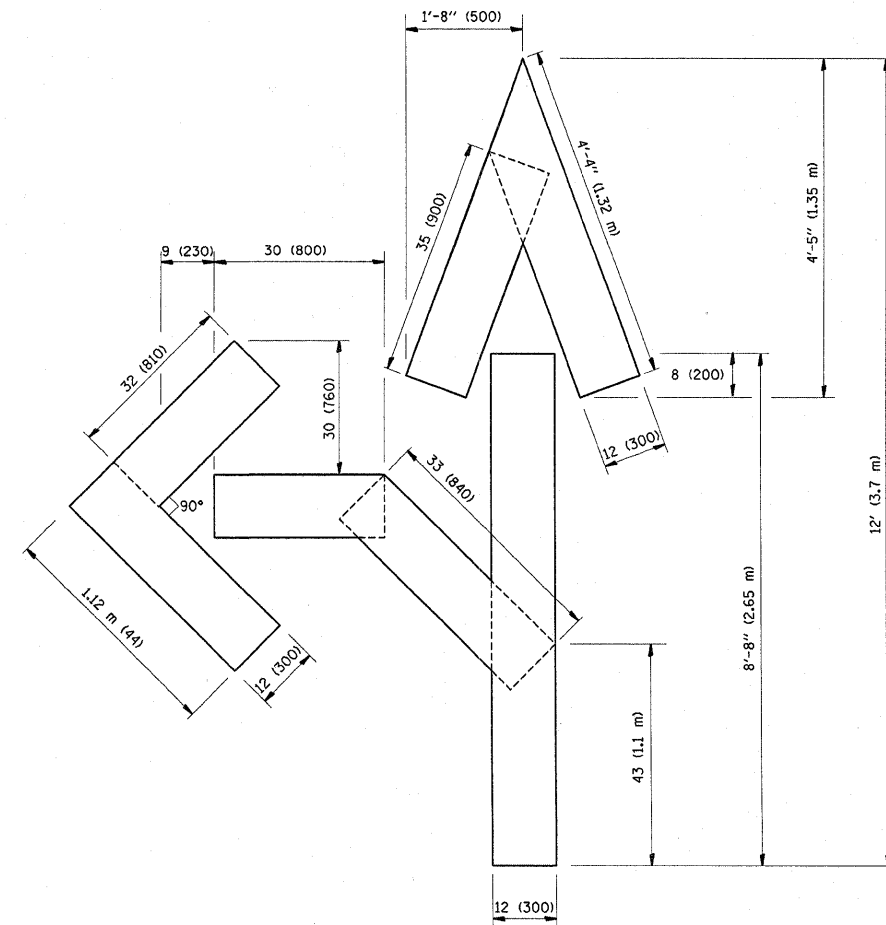

QUANTITY
 4 (100) LINE = 82.5 ft. (25.3 m)
 27.5 sq. ft. (2.53 sq. m)

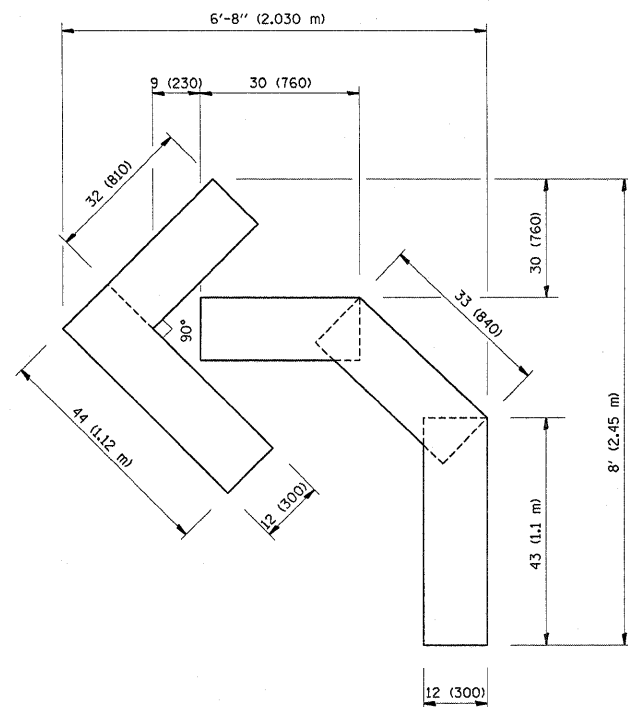

QUANTITY
 4 (100) LINE = 45.5 ft. (13.9 m)
 15.2 sq. ft. (1.39 sq. m)

All dimensions are in Inches (millimeters) unless otherwise shown.

| | | | |
|---|---------------------|-----------------------------|---------------------------------|
| FILE NAME = | USER NAME = kellers | DESIGNED - | REVISED -T. RAMMACHER 06-05-96 |
| g:\pwork\p\WIDOT\KELLERS\ad\158566\Q1st\d.dgn | | DRAWN - | REVISED -T. RAMMACHER 11-04-97 |
| | | PLOT SCALE = 50.0000' / IN. | REVISIED -T. RAMMACHER 03-02-98 |
| | | PLOT DATE = 12/18/2009 | REVISIED -E. GOMEZ 08-28-00 |
| | | DATE - 09-18-94 | |

STATE OF ILLINOIS
 DEPARTMENT OF TRANSPORTATION

PAVEMENT MARKING LETTERS AND SYMBOLS
 FOR TRAFFIC STAGING

SCALE: NONE SHEET NO. 1 OF 1 SHEETS STA. TO STA.

| | | | | |
|---|--------------------|--------|--------------------|-----------|
| F.A.P. RTE. | SECTION | COUNTY | TOTAL SHEETS | SHEET NO. |
| 334 | (106-2 & 117) RS-1 | LAKE | 27 | 24 |
| TC-16 | | | CONTRACT NO. 60150 | |
| FED. ROAD DIST. NO. 1 ILLINOIS FED. AID PROJECT | | | | |