

NOTES:

ALL HMA SHOULDER SHALL BE MILLED AND RESURFACED.

LIMIT OF RESURFACING ON SIDE-STREETS SHALL BE AS SHOWN ON THE PLANS OR AS DIRECTED BY THE ENGINEER.

ALL FINAL PAVEMENT MARKINGS SHALL BE THERMOPLASTIC (OF THE EXTRUDED TYPE) AND SHOULD BE PLACED IN ACCORDANCE WITH "DISTRICT ONE TYPICAL PAVEMENT MARKINGS" DETAIL, (TC-13).

ALL RAISED REFLECTIVE PAVEMENT MARKERS SHALL BE PLACED IN ACCORDANCE WITH THE DISTRICT ONE "TYPICAL APPLICATIONS RAISED REFLECTIVE PAVEMENT MARKER DETAIL", (TC-11).

NOTES:

ALL HMA SHOULDER SHALL BE MILLED AND RESURFACED.

LIMIT OF RESURFACING ON SIDE-STREETS SHALL BE AS SHOWN ON THE PLANS OR AS DIRECTED BY THE ENGINEER.

ALL FINAL PAVEMENT MARKINGS SHALL BE THERMOPLASTIC (OF THE EXTRUDED TYPE) AND SHOULD BE PLACED IN ACCORDANCE WITH "DISTRICT ONE TYPICAL PAVEMENT MARKINGS" DETAIL, (TC-13).

ALL RAISED REFLECTIVE PAVEMENT MARKERS SHALL BE PLACED IN ACCORDANCE WITH THE DISTRICT ONE "TYPICAL APPLICATIONS RAISED REFLECTIVE PAVEMENT MARKER DETAIL", (TC-11).

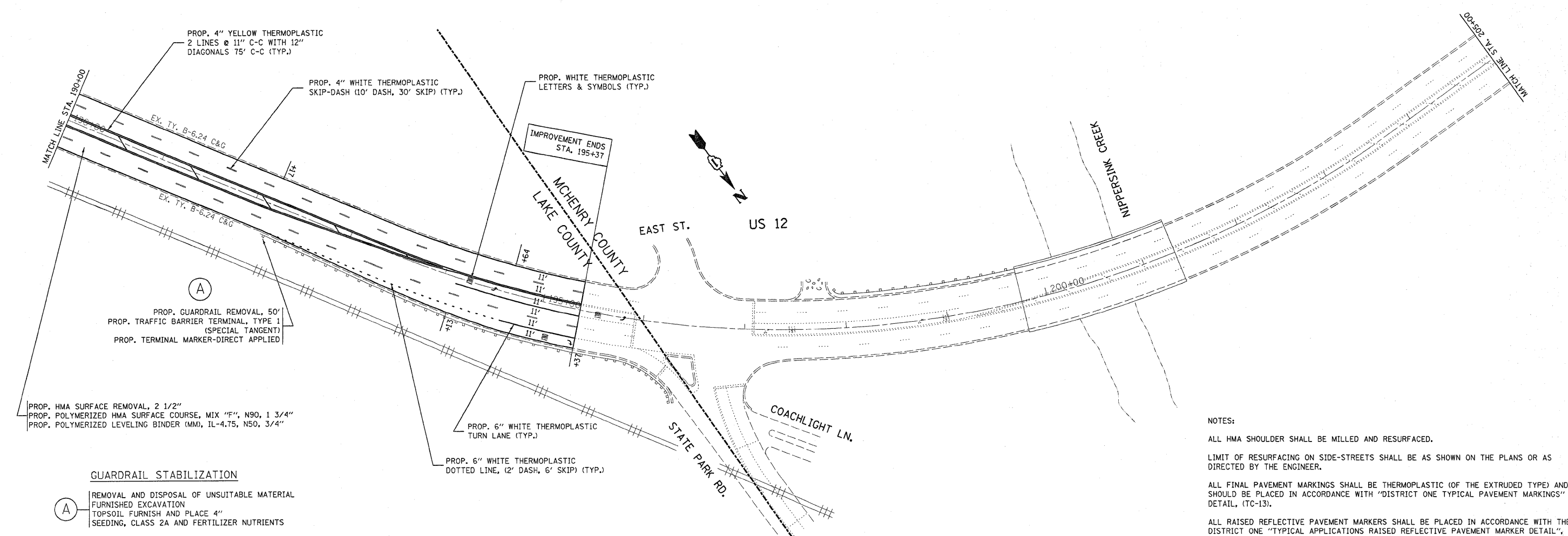
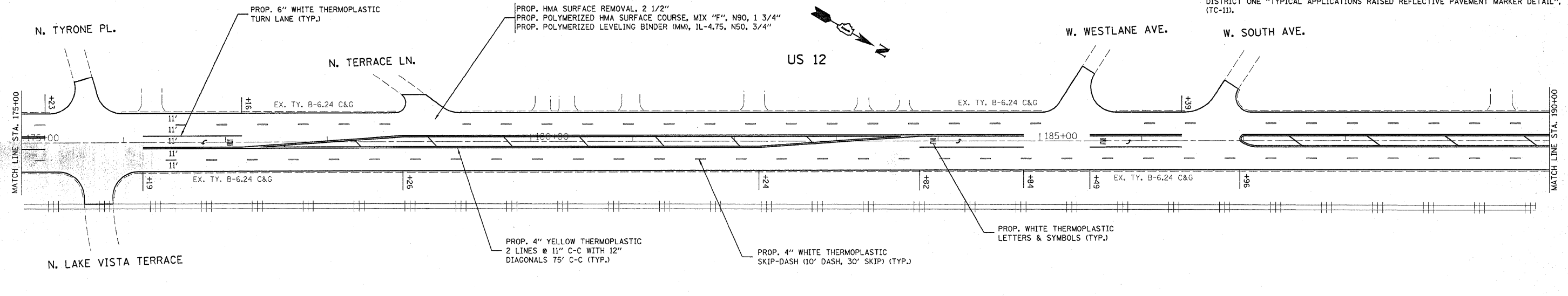

GUARDRAIL STABILIZATION

(A)

REMOVAL AND DISPOSAL OF UNSUITABLE MATERIAL
FURNISHED EXCAVATION
TOPSOIL FURNISH AND PLACE 4"
SEEDING, CLASS 2A AND FERTILIZER NUTRIENTS

FILE NAME =	USER NAME = kellers	DESIGNED -	REVISED -	STATE OF ILLINOIS DEPARTMENT OF TRANSPORTATION	US 12 /IL RTE. 59 (IL RTE. 59 TO EAST ST.) EXISTING AND PROPOSED ROADWAY PLANS			F.A.P. RTE.	SECTION	COUNTY	TOTAL SHEETS	SHEET NO.
ca:\pwork\p\DOT\KELLERS\0158556\0104	110-shit-plan.dgn	DRAWN -	REVISED -					334	(106-2 & 117) RS-1	LAKE	27	11
	PLOT SCALE = 50.0000 ' / IN.	CHECKED -	REVISED -		SCALE: 1" = 50'			SHEET NO. OF SHEETS STA. TO STA.		CONTRACT NO. 60150		
	PLOT DATE = 12/18/2009	DATE -	REVISED -		ILLINOIS FED. AID PROJECT							