

**TRAFFIC SIGNAL LEGEND**

	PROPOSED	EXISTING
DETECTOR LOOP		
SIGNAL HEAD		
G.S. CONDUIT IN TRENCH OR PUSHED		
SIGNAL HEAD WITH BACKPLATE		
RACEWAY FOR MAGNETIC DETECTOR, TYPE I OR II		
VEHICLE DETECTOR, NON-COMPENSATED MAGNETIC TYPE		

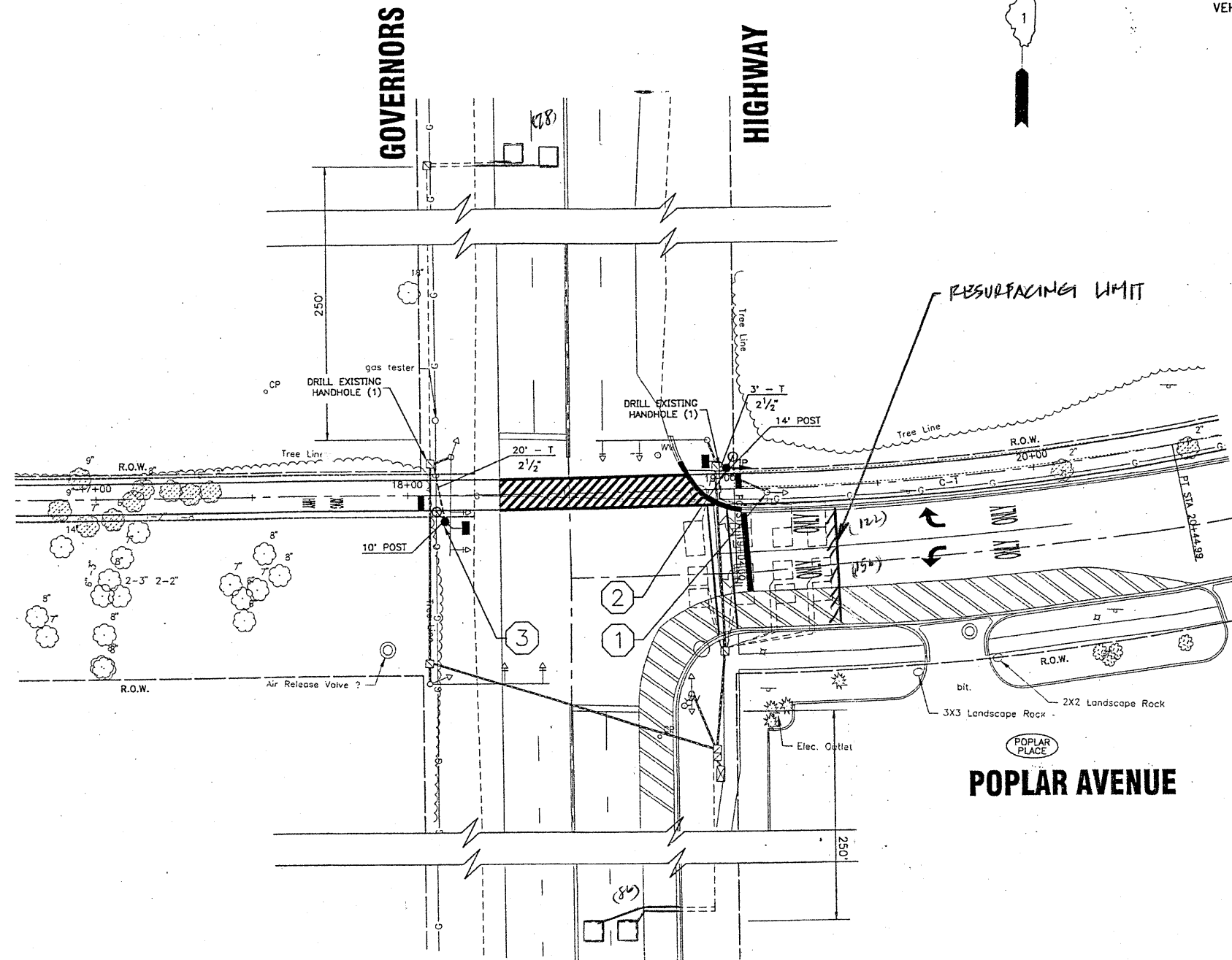
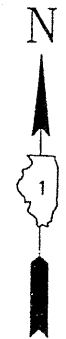

THIS PLAN IS FOR THE SOLE PURPOSE OF DETECTOR LOOP REPLACEMENTS ONLY

REPLACE ALL DETECTOR LOOPS AS SHOWN (WITHIN THE RESURFACING LIMITS)

CODE	QUANTITY	UNIT	ITEM
86600600	442	FOOT	DETECTOR LOOP, REPLACEMENT

FILE NAME =	USER NAME = konthaphixaybo	DESIGNED - BCK	REVISED -
at\pwork\PWIDOT\KANTHAPHIXAYBO\01126	4\traffic.legend.v7.dgn	DRAWN - BCK	REVISED -
PLOT SCALE = 3/4" = 1' IN.	CHECKED - DAD	REVISED -	REVISED -
PLOT DATE = 4/3/2009	DATE	REVISED -	REVISED -

**STATE OF ILLINOIS  
DEPARTMENT OF TRANSPORTATION**

**DISTRICT ONE - DETECTOR LOOP REPLACEMENT**  
*Governor's Hwy. @ Poplar Av.*

F.A.V. RTE.	SECTION	COUNTY	TOTAL SHEETS	SHEET NO.
3718	144 RS-5	COOK	37	19
SCALE: NONE		SHEET NO. OF SHEETS		STA. TO STA.
FED. ROAD DIST. NO.		ILLINOIS FED. AID PROJECT		CONTRACT NO. 60493