

STATE OF ILLINOIS  
DEPARTMENT OF TRANSPORTATION  
DIVISION OF HIGHWAYS

**PROPOSED  
HIGHWAY PLANS**

FAP ROUTE 781 (ILL RT 33)  
SECTION 3RS-3  
PROJECT: ACF-0781 (032)  
3P RESURFACING  
JASPER & CRAWFORD COUNTIES

C-97-007-13

F.A.P. RTE.	SECTION	COUNTY	TOTAL SHEETS	SHE. NO.
781	3 RS-3	ILLINOIS	18	1

\* CRAWFORD & JASPER  
CONTRACT NO. 74603

\*18+1=19 TOTAL SHEETS  
D-97-002-13

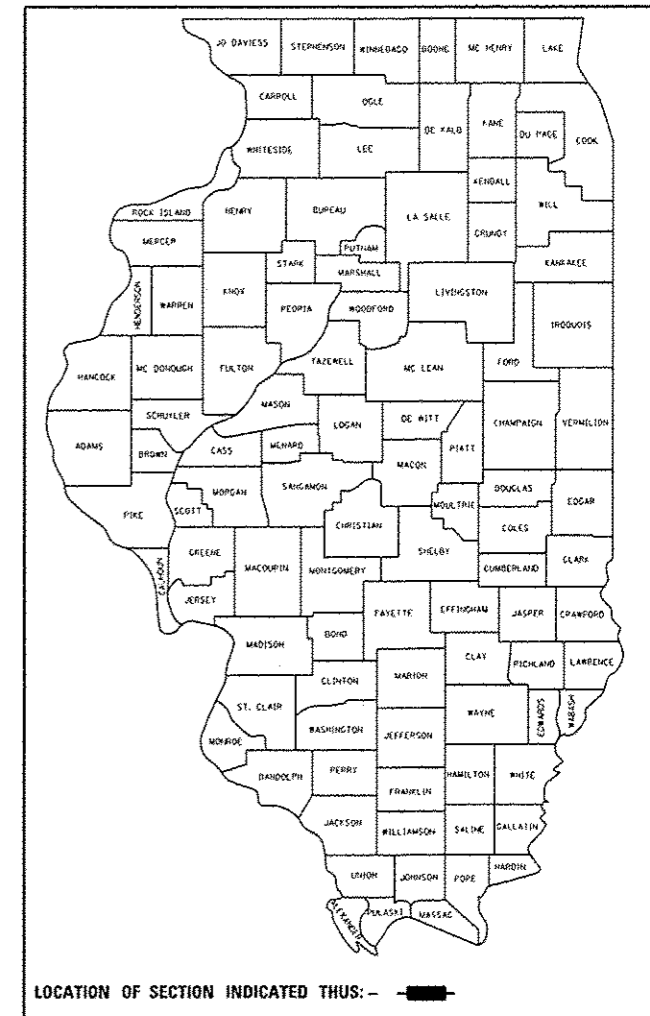

FOR INDEX OF SHEETS, SEE SHEET NO. 2

STATION EQUATION  
STA 689+95.9 BK =  
STA 690+58.9 AH

ADT = 2950 (2011)

SECTION 3RS-3  
BEGINS STA 444+74

SECTION 3RS-3  
ENDS STA 691+13

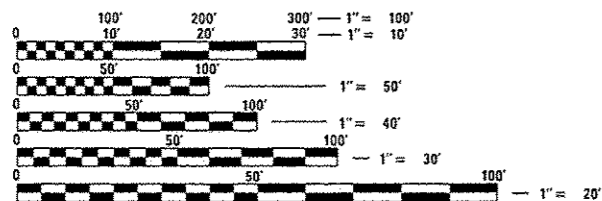

FULL SIZE PLANS HAVE BEEN PREPARED USING STANDARD ENGINEERING SCALES. REDUCED SIZED PLANS WILL NOT CONFORM TO STANDARD SCALES. IN MAKING MEASUREMENTS ON REDUCED PLANS, THE ABOVE SCALES MAY BE USED.

J.U.L.I.E.  
JOINT UTILITY LOCATION INFORMATION FOR EXCAVATION  
1-800-892-0123  
OR 811

PROJECT ENGINEER: MARK DAUGHERTY  
PROJECT MANAGER: SOLOMON DZAKUMA

CONTRACT NO. 74603

BRIDGE OMISSION  
STA 537+95 TO  
STA 539+35

GROSS LENGTH = 24,576 FT. = 4.655 MILE  
NET LENGTH = 23,988 FT. = 4.543 MILE

BRIDGE OMISSION  
STA 660+67 TO  
STA 665+15

STATE OF ILLINOIS  
DEPARTMENT OF TRANSPORTATION  
DIVISION OF HIGHWAYS

SUBMITTED Oct 22 20 12  
Roger L. Driskell  
DEPUTY DIRECTOR OF HIGHWAYS, REGION ENGINEER

Jan 29 20 16  
Maureen M. Addis, PE  
ENGINEER OF DESIGN AND ENVIRONMENT

Jan 29 20 16  
Omer Osman, PE  
DIRECTOR OF HIGHWAYS, CHIEF ENGINEER

PRINTED BY THE AUTHORITY  
OF THE STATE OF ILLINOIS

**GENERAL NOTES**

THIS SECTION SHALL BE CONSTRUCTED IN ACCORDANCE WITH THE PLANS; THE "STANDARD SPECIFICATIONS FOR ROAD AND BRIDGE CONSTRUCTION" ADOPTED JANUARY 1, 2012; THE SUPPLEMENTAL SPECIFICATIONS AND RECURRING SPECIAL PROVISIONS INDICATED ON THE CHECK SHEET, AND THE "SPECIAL PROVISIONS" INCLUDED IN THIS PROPOSAL.

THE PROPOSED PROJECT IS LOCATED ON IL 33 IN JASPER AND CRAWFORD COUNTIES. THE PROJECT STARTS AT AND ALSO INCLUDES THE INTERSECTION OF IL 49 AND IL 33 AND ENDS A MILE WEST OF OBLONG.

THE WORK INCLUDED IN SECTION 3 RS-3 CONSISTS OF PATCHING, HMA RESURFACING, INLAY THROUGH THE INTERSECTION, AGGREGATE SHOULDERS PLUS OTHER NECESSARY WORK TO COMPLETE THE SECTION.

THE CONTRACTOR SHALL PROVIDE INTERNET ACCESS TO THE HOT-MIX ASPHALT PLANT QUALITY CONTROL LAB, SO THAT HOT-MIX ASPHALT PLANT REPORTS CAN BE E-MAILED TO THE DISTRICT HEADQUARTERS. THIS WORK SHALL BE INCLUDED IN THE COST OF HOT-MIX ASPHALT ITEMS.

PARTIAL DEPTH PATCHING QUANTITIES ARE INCLUDED FOR REPAIR OF DETERIORATED CENTERLINE JOINT. ASSUMED DIMENSIONS OF REPAIR AREAS ARE 2 FEET WIDE AND 5 INCHES DEEP.

AGGREGATE WEDGE SHOULDERS TYPE B, SHALL BE CRUSHED STONE, CRUSHED CONCRETE, OR RAP.

AGGREGATE SURFACE COURSE SHALL BE CRUSHED STONE OR CRUSHED CONCRETE.

THE FOLLOWING MIXTURE REQUIREMENTS ARE APPLICABLE FOR THIS PROJECT:

APPLICATION	AC/PG	DESIGN AIR VOIDS	MIXTURE COMPOSITION	FRICTION AGGREGATE
LEVELING BINDER	PG 64-22	4.0% $\phi$ Ndesign=70	IL - 9.5	N/A
SURFACE COURSE	PG 64-22	4.0% $\phi$ Ndesign=70	IL - 9.5	MIXTURE C
INCIDENTAL SURFACE	PG 64-22	4.0% $\phi$ Ndesign=70	IL - 9.5	MIXTURE C
PAVEMENT PATCHING	PG 64-22	4.0% $\phi$ Ndesign=70	IL - 19.0	N/A

**INDEX OF SHEETS**

SHEET NO.	ITEM
1	COVER SHEET
2	INDEX OF SHEETS & GENERAL NOTES
3-4	SUMMARY OF QUANTITIES
5	TYPICAL SECTIONS
6	DETAILS
7	SCHEDULES
8	ENTRANCE SCHEDULE
8A	SURVEY TIES
9-14	PLAN SHEETS
15-18	PAVEMENT MARKING DETAILS

THE FOLLOWING STANDARDS ARE A PART OF THESE PLANS AND ARE INCLUDED FOLLOWING THE LAST NUMBERED SHEET OF THE PLANS.

442201-03	CLASS C AND D PATCHES
701006-05	OFF-ROAD OPERATIONS, 2L, 2W, 15' TO 24" FROM PAVEMENT EDGE
701201-04	LANE CLOSURE, 2L, 2W, DAY ONLY, FOR SPEEDS $\geq$ 45 MPH
701301-04	LANE CLOSURE, 2L, 2W, SHORT TIME OPERATIONS
701306-03	LANE CLOSURE, 2L, 2W, SLOW MOVING OPERATIONS DAY ONLY, FOR SPEEDS $\geq$ 45 MPH
701311-03	LANE CLOSURE, 2L, 2W, MOVING OPERATIONS - DAY ONLY
701901-04	TRAFFIC CONTROL DEVICES
780001-05	TYPICAL PAVEMENT MARKINGS
781001-03	TYPICAL APPLICATIONS RAISED REFLECTIVE PAVEMENT MARKERS

FILE NAME #	USER NAME = steffennk	DESIGNED -	REVISED -	<b>STATE OF ILLINOIS DEPARTMENT OF TRANSPORTATION</b>	<b>GENERAL NOTES &amp; INDEX OF SHEETS</b>	F.A.P. RTE.	SECTION	COUNTY	TOTAL SHEETS	SHEET NO.
pm\11204EBIDINTEG.illinois.gov\PI007\0	uments\DOT Offices\District 7\Projects\746	DRAWN to CAD sheets\0774623-shi-gennata	REVISED -			781	3 RS-3	*	18	2
	PLOT SCALE = 1/8" = 1' / in.	CHECKED -	REVISED -			* CRAWFORD & JASPER		CONTRACT NO. 74603		
Default	PLOT DATE = 11/19/2015	DATE -	REVISED -			ILLINOIS FED. AID PROJECT				
SCALE:		SHEET OF SHEETS		STA. TO STA.						

80% FED / 20% STATE

80% FED / 20% STATE

SUMMARY OF QUANTITIES			TOTAL QUANTITIES	CONSTRUCTION TYPE CODE	
CODE NO	ITEM	UNIT		JASPER 0005	CRAWFORD 0005
40200800	AGGREGATE SURFACE COURSE, TYPE B	TON	212	200	12
40600635	LEVELING BINDER (MACHINE METHOD), N70	TON	3055	2676	379
40600982	HOT-MIX ASPHALT SURFACE REMOVAL - BUTT JOINT	SQ YD	730	410	320
40600990	TEMPORARY RAMP	SQ YD	136	108	28
40603315	HOT-MIX ASPHALT SURFACE COURSE, MIX "C", N70	TON	6111	5353	758
40800050	INCIDENTAL HOT-MIX ASPHALT SURFACING	TON	53	53	
44000151	HOT-MIX ASPHALT SURFACE REMOVAL, 1/2"	SQ YD	67860	59007	8853
44000158	HOT-MIX ASPHALT SURFACE REMOVAL, 2 1/4"	SQ YD	4500	4500	
44201803	CLASS D PATCHES, TYPE II, 13 INCH	SQ YD	1379	1230	149
44201807	CLASS D PATCHES, TYPE III, 13 INCH	SQ YD	693	693	
44201809	CLASS D PATCHES, TYPE IV, 13 INCH	SQ YD	1263	1263	
48102100	AGGREGATE WEDGE SHOULDER, TYPE B	TON	1706	1393	313
67000500	ENGINEER'S FIELD OFFICE, TYPE B	CAL MO	4	3	1
67100100	MOBILIZATION	L SUM	1	0.88	0.12

SUMMARY OF QUANTITIES			TOTAL QUANTITIES	CONSTRUCTION TYPE CODE	
CODE NO	ITEM	UNIT		JASPER 0005	CRAWFORD 0005
70100450	TRAFFIC CONTROL AND PROTECTION, STANDARD 701201	L SUM	1	0.88	0.12
70100460	TRAFFIC CONTROL AND PROTECTION, STANDARD 701306	L SUM	1	0.88	0.12
70300100	SHORT TERM PAVEMENT MARKING	FOOT	7572	6744	828
70300220	TEMPORARY PAVEMENT MARKING - LINE 4"	FOOT	59906	52728	7178
70301000	WORK ZONE PAVEMENT MARKING REMOVAL	SQ FT	841	748	93
*78001110	PAINT PAVEMENT MARKING - LINE 4"	FOOT	59906	52728	7178
*78004280	PREFORMED PLASTIC PAVEMENT MARKING, TYPE B - INLAID - LINE 24"	FOOT	165	165	
*78100100	RAISED REFLECTIVE PAVEMENT MARKER	EACH	315	281	34
40600275	BITUMINOUS MATERIALS (PRIME COAT)	POUND	32734	28678	4056
X4401198	HOT-MIX ASPHALT SURFACE REMOVAL, VARIABLE DEPTH	SQ YD	222	222	
X4405050	LONGITUDINAL PARTIAL DEPTH REMOVAL 5"	FOOT	6000	6000	
X4420900	LONGITUDINAL PARTIAL DEPTH PATCHING	TON	373	373	

\* SPECIALTY ITEM

12

FILE NAME =	USER NAME = useffanmk	DESIGNED -	REVISED -	STATE OF ILLINOIS DEPARTMENT OF TRANSPORTATION	SUMMARY OF QUANTITIES	F.A.P. RTE.	SECTION	COUNTY	TOTAL SHEETS	SHEET NO.	
c:\pr-work\p1dot\useffanmk\p29832710	74603-ent-eoq.dgn	DRAWN -	REVISED -			781	3 RS-3		18	3	
	PLOT SCALE = 100.0000 1/1 in.	CHECKED -	REVISED -			CONTRACT NO. 74603					
Default	PLOT DATE = 5/13/2014	DATE -	REVISED -			ILLINOIS FED. AID PROJECT					

\* CRAWFORD & JASPER

80% FED / 20% STATE

### SUMMARY OF QUANTITIES

CONSTRUCTION TYPE CODE

CODE NO	ITEM	UNIT	TOTAL QUANTITIES	CONSTRUCTION TYPE CODE	
				JASPER 0005	CRAWFORD 0005
X7015005	CHANGEABLE MESSAGE SIGN	CAL DA	28	28	
Z0049799	PROTECTING OR RESETTING SURVEY MARKERS	EACH	6	6	

2

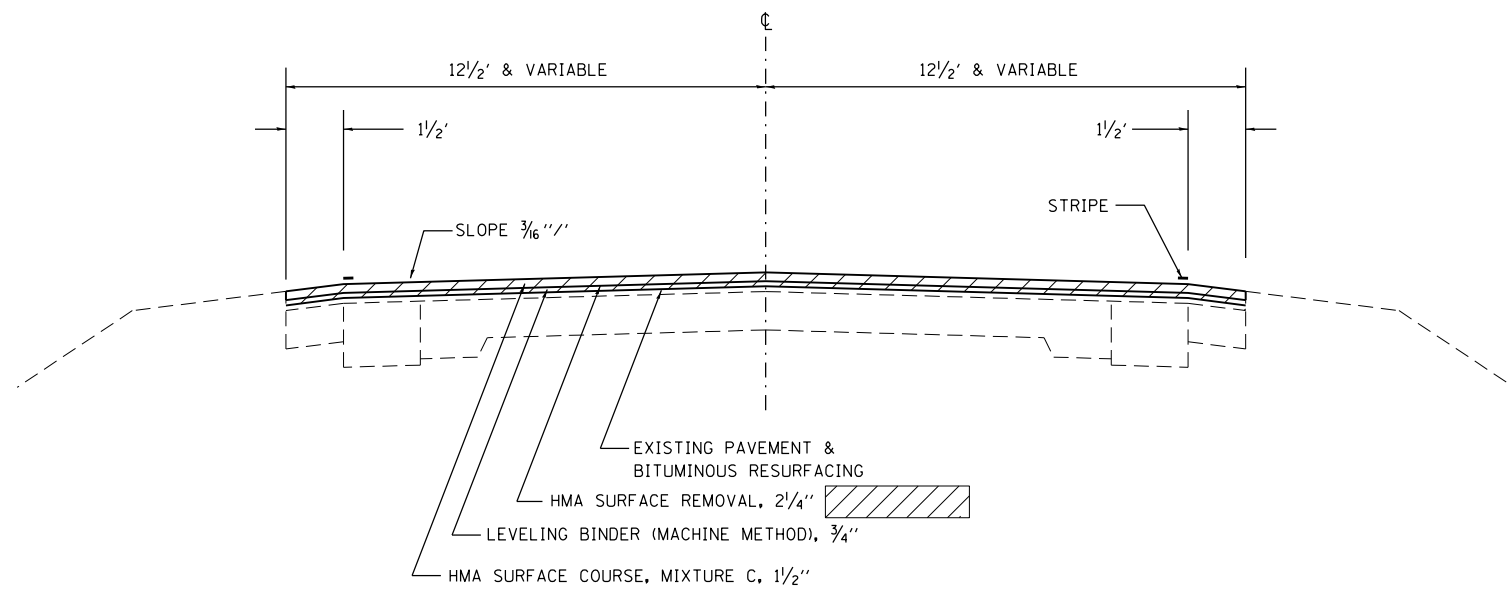

TYPICAL SECTION  
STA 444+74 TO STA 450+97

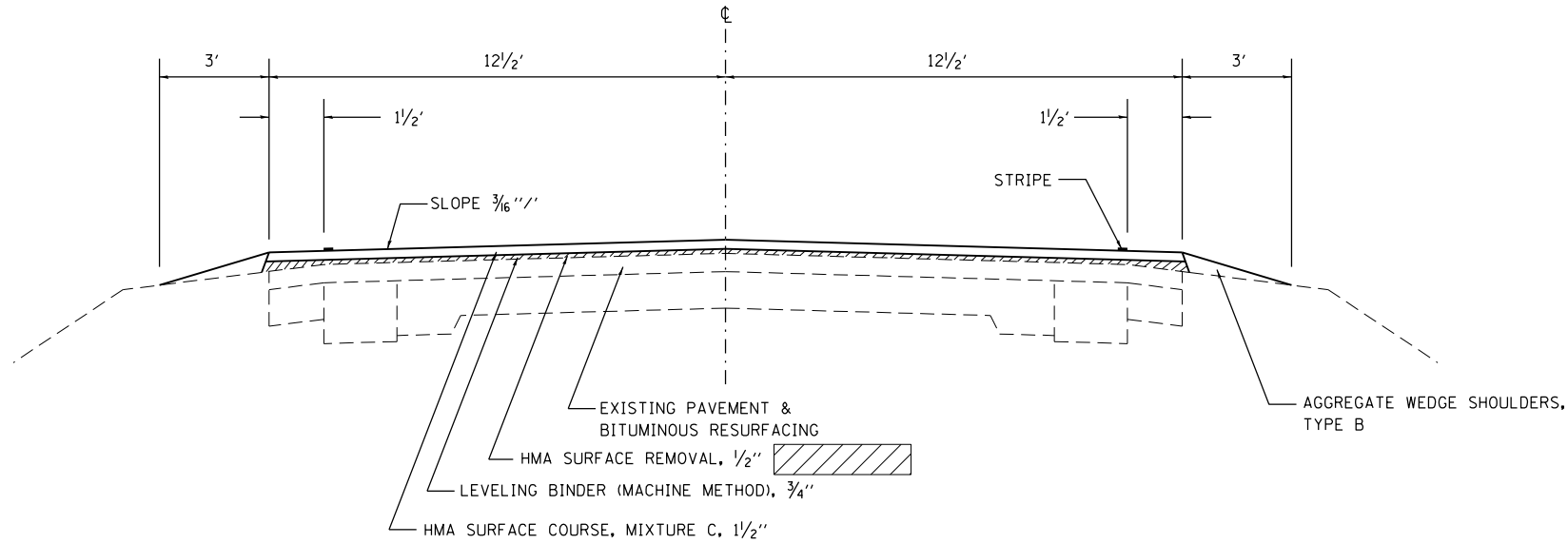

TYPICAL SECTION  
STA 450+97 TO STA 643+08

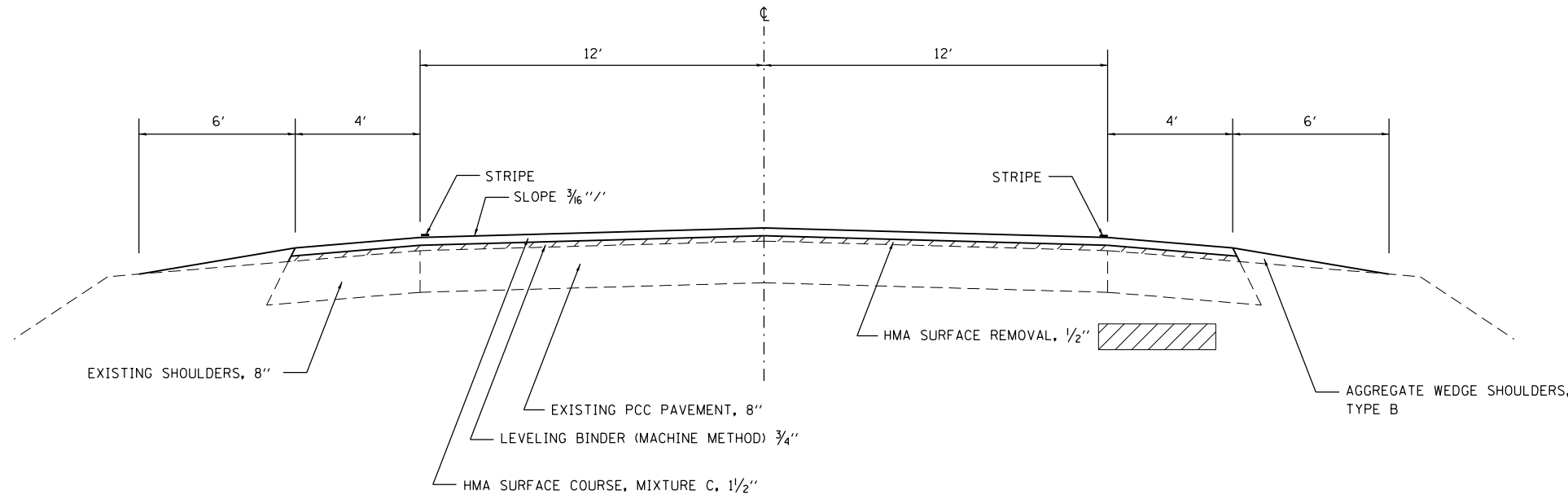

TYPICAL SECTION  
STA 643+08 TO STA 691+13

FILE NAME =	USER NAME = steffenmk	DESIGNED -	REVISED -
ct:\pw\work\p\idot\steffenmk\d0396327\074603-sht-typicals.dgn		DRAWN -	REVISED -
Default	PLOT SCALE = 100.0000' / 1in.	CHECKED -	REVISED -
	PLOT DATE = 5/13/2014	DATE -	REVISED -

STATE OF ILLINOIS  
DEPARTMENT OF TRANSPORTATION

TYPICALS			
SCALE:	SHEET	OF SHEETS	STA. TO STA.

F.A.P. RTE.	SECTION	COUNTY	TOTAL SHEETS	SHEET NO.
781	3 RS-3		18	5
CRAWFORD & JASPER			CONTRACT NO. 74603	
ILLINOIS FED. AID PROJECT				

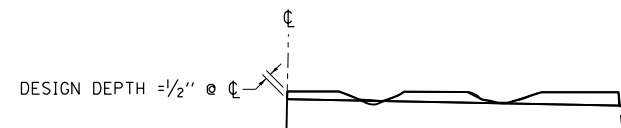

**NOTES:**

1. MILLING SHALL BE DONE TO ATTAIN A 3/16"/' SLOPE IN CROWN SECTIONS
2. EXISTING S.E. AND S.E. TRANSITIONS SHALL BE MAINTAINED UNLESS OTHERWISE SHOWN ON THE PLANS.
3. MILLING TO THE BOTTOM OF WHEEL RUTS SHALL NOT BE NECESSARY UNLESS REQUIRED TO OBTAIN SLOPE OR THE DESIGN DEPTH AT CENTERLINE.
4. THE AVERAGE DEPTH OF MILLING IS ESTIMATED TO BE 1/2" BUT MAY VARY IN ISOLATED LOCATIONS.

HMA SURFACE REMOVAL, 1/2" DETAIL

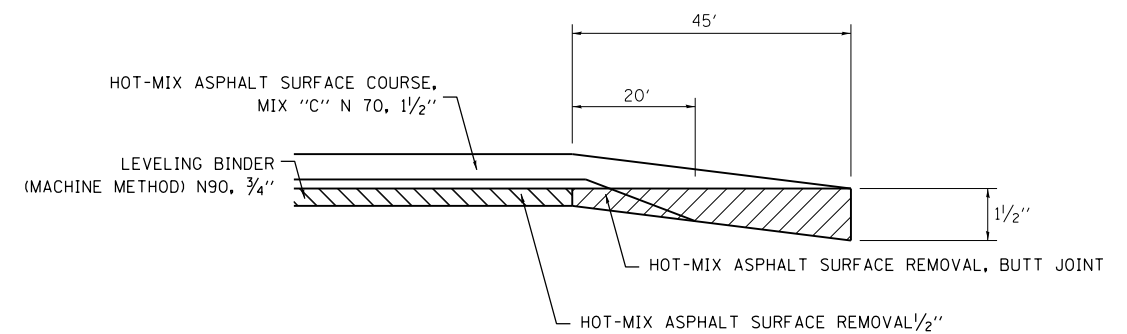

**BUTT JOINT DETAIL**

- STA 537+50 TO STA 537+95
- STA 539+35 TO STA 539+80
- STA 660+22 TO STA 660+67
- STA 665+15 TO STA 665+60
- STA 690+68 TO STA 691+13

FILE NAME =	USER NAME = steffenmk	DESIGNED -	REVISED -	<b>STATE OF ILLINOIS DEPARTMENT OF TRANSPORTATION</b>	<b>DETAILS</b>				F.A.P. RTE.	SECTION	COUNTY	TOTAL SHEETS	SHEET NO.
ci:\pw\work\p\idot\steffenmk\d0396327\074603-sht-details.dgn	74603-sht-details.dgn	DRAWN -	REVISED -						781	3 RS-3	*	18	6
Default	PLOT SCALE = 100.0000' / in.	CHECKED -	REVISED -		• CRAWFORD & JASPER				CONTRACT NO. 74603				
	PLOT DATE = 5/13/2014	DATE -	REVISED -		SCALE:	SHEET OF SHEETS	STA. TO STA.	ILLINOIS FED. AID PROJECT					

PAVEMENT MARKING SCHEDULE

STATION TO STATION	LENGTH FOOT	PAINT PAVEMENT MARKING - LINE 4" * FOOT	SHORT-TERM PAVEMENT MARKING FOOT	WORK ZONE PAVEMENT MARKING REMOVAL SQ FT	RAISED REFLECTIVE PAVEMENT MARKER EACH	PERFORMED PLASTIC PAVEMENT MARKING, TYPE B - INLAID - LINE 24" FOOT
444+74.00 TO 537+95.00	9321	21739	2796	311	117	83
537+95.00 TO 643+08.00	10513	24669	3156	351	131	0
643+08.00 TO 663+15.00	2007	5536	600	67	25	0
663+15.00 TO 691+13.00	2798	7178	840	93	35	0
50+73.00 TO 56+60.00	587	784	180	20	7	82
<b>TOTALS</b>		59906	7572	841	315	165

\* 10, 680' YELLOW, 49, 226' WHITE

RESURFACING SCHEDULE

STATION TO STATION	LENGTH FOOT	AVERAGE PAVEMENT WIDTH FOOT	AREA SQ YD	HOT-MIX ASPHALT SURFACE REMOVAL, 1/2" SQ YD	HOT-MIX ASPHALT SURFACE REMOVAL, 2 1/4" SQ YD	BITUMINOUS MATERIALS (PRIME COAT) POUND	HOT-MIX ASPHALT SURFACE COURSE, MIX "C", N70 TON	LEVELLING BINDER (MACHINE METHOD), N70 TON	AGGREGATE WEDGE SHOULDERS, TYPE B TON
450+97.00 TO 451+77.00	80	25.0	222	0	0	100	19	9	5
451+77.00 TO 537+95.00	8618	25.0	23939	23939	0	10773	2011	1005	532
537+95.00 TO 539+35.00	140	0.0	0	0	0	0	0	0	0
539+35.00 TO 643+08.00	10373	25.0	28814	28814	0	12966	2420	1210	640
643+08.00 TO 660+67.00	1759	32.0	6254	6254	0	2814	525	263	217
660+67.00 TO 663+15.00	248	0.0	0	0	0	0	0	0	0
663+15.00 TO 665+15.00	200	0.0	0	0	0	0	0	0	0
665+15.00 TO 689+95.90	2481	32.0	8821	8821	0	3969	741	371	306
690+58.90 TO 690+68.00	9	32.0	32	32	0	15	3	1	1
690+68.00 TO 691+13.00	45	32.0	160	0	0	72	13	7	6
INTERSECTION IL 33 & IL 49	623		4500	0	4500	2025	378	189	0
<b>TOTALS</b>	24576		72743	67860	4500	32734	6111	3055	1706

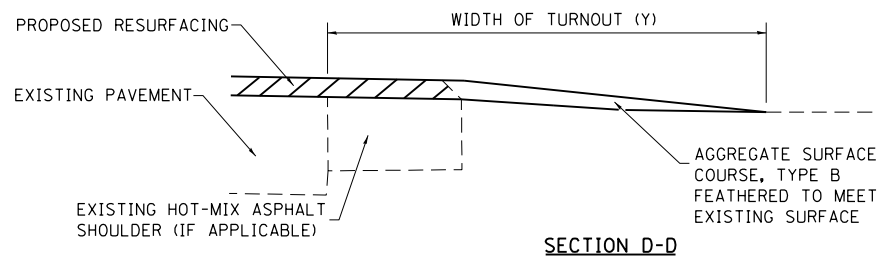
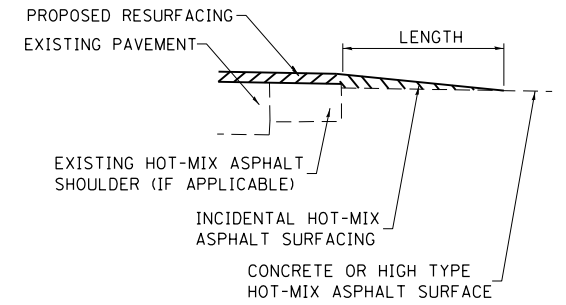
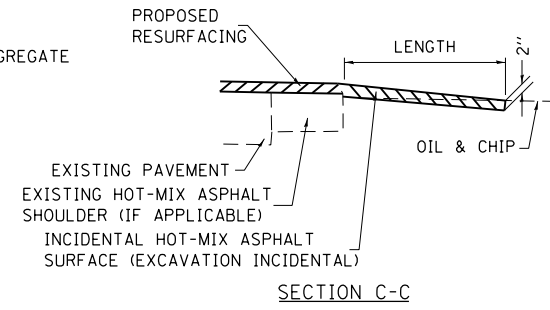
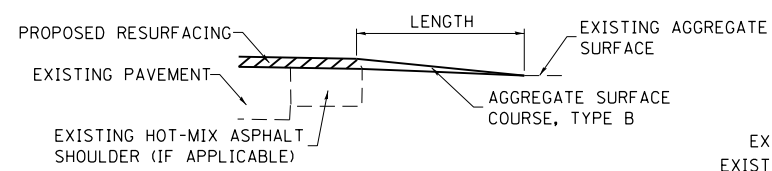
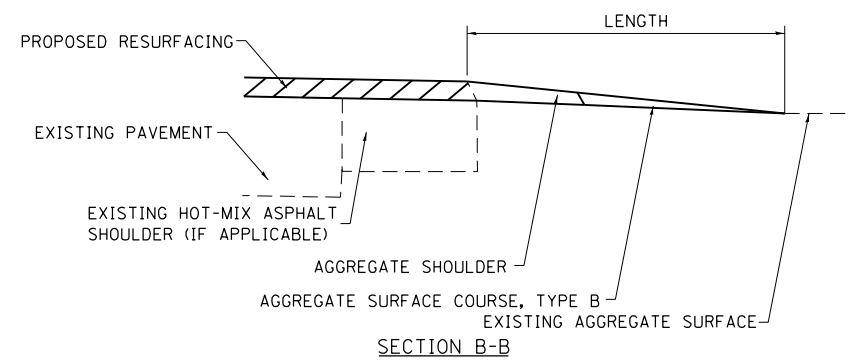
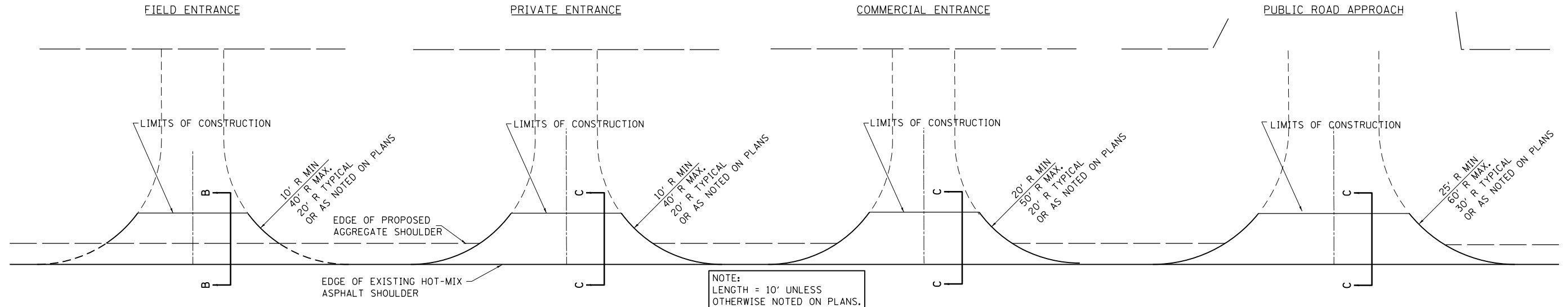

**TYPICAL SECTION AT MAILBOX TURNOUT**  
NOTE: SEE STANDARD 406201 FOR MAILBOX TURNOUT DETAILS

**NOTES**

THE COST OF THE ASPHALT MATERIALS, AND AGGREGATE (PRIME COAT) FOR ENTRANCES AND PUBLIC ROADS AND APPROACHES SHALL BE INCLUDED IN THE PAY ITEM INCIDENTAL HOT-MIX ASPHALT SURFACING.

THE COST OF EXCAVATION IS INCLUDED IN THE PAY ITEM INCIDENTAL HOT-MIX ASPHALT SURFACING.

IF THERE IS NOT EXISTING HOT-MIX ASPHALT SHOULDER THEN THE ENTRANCE TAPER STARTS AT THE EDGE OF EXISTING PAVEMENT.

THE COST OF THE BITUMINOUS MATERIALS AND AGGREGATE (PRIME COAT) FOR ENTRANCES AND PUBLIC ROAD APPROACHES SHALL BE INCLUDED IN THE PAY ITEM INCIDENTAL HOT-MIX ASPHALT SURFACING.

SIDE	STATION	TYPE	INCIDENTAL HOT-MIX ASPHALT SURFACING		AGGREGATE SURFACE COURSE, TYPE B
			TON	TON	
LT	452+72	CE		3.8	
LT	453+25	CE		4.0	
LT	454+10	CE		3.2	
LT	455+65	FE		2.5	
LT	457+95	PE		2.4	
LT	458+07	MBT		2.9	
LT	460+14	FE		2.3	
LT	465+28	PE		3.0	
LT	465+29	MBT		1.0	
RT	470+10	FE		5.0	
LT	474+17	CE		6.0	
LT	477+11	CE		6.0	
RT	484+15	FE		5.0	
LT	484+35	FE		5.0	
LT	486+72	FE		4.0	
LT	503+88	PRA	7		
RT	503+88	PRA	7		
LT	506+00	PE		4.0	
LT	510+89	FE		4.0	
RT	517+20	PE		4.0	
LT	517+45	FE		4.0	
RT	519+17	PE		4.0	
LT	523+66	FE		4.0	
RT	531+99	FE		3.0	
LT	534+83	FE		4.0	
LT	541+09	FE		4.0	
RT	544+80	FE		5.0	
LT	545+32	PE		3.0	
LT	545+34	MBT		2.0	
RT	556+56	PRA	7		
RT	556+56	PRA	7		
LT	560+30	FE		4.0	
LT	567+82	FE		4.0	
RT	571+95	FE		3.0	
LT	573+75	FE		3.0	
RT	576+75	FE		5.0	
LT	596+29	CE	4.2		
RT	596+39	FE		4.0	
LT	603+50	FE		5.0	
RT	605+17	CE		5.0	
RT	606+25	CE		15.0	
RT	608+36	FE		5.0	
LT	609+74	PRA	4.2		
RT	609+77	PRA	4.7		
LT	614+08	FE		5.0	
LT	613+80	PE		2.0	
RT	613+96	FE		3.0	
LT	615+17	PE		3.0	
RT	628+30	MBT		1.5	
RT	629+23	PE		3.0	
LT	629+26	FE		5.0	
LT	636+50	FE		5.0	
RT	636+51	FE		4.0	
LT	642+50	FE		5.0	
RT	648+62	PE		5.0	
LT	648+71	PE		4.0	
LT	649+80	PRA	6		
RT	649+93	PRA	6		
RT	670+50	FE		4.0	
LT	686+45	PE		4.0	
LT	689+70	PE		4.0	
			TOTAL	53	212

FE=FIELD ENTRANCE  
PE=PRIVATE ENTRANCE  
CE=COMMERCIAL ENTRANCE  
PRA - PUBLIC ROAD APPROACH  
MBT - MAILBOX TURNOUT

FILE NAME =	USER NAME = steffenmk	DESIGNED - 08-03-99	REVISED - 03-13-07
c:\pw\work\p\id\stevfennk\d0396327\074603-sht-details.dgn		DRAWN -	REVISED -
Default	PLOT SCALE = 100.0000' / 1" .	CHECKED -	REVISED -
	PLOT DATE = 5/13/2014	DATE -	REVISED -

STATE OF ILLINOIS  
DEPARTMENT OF TRANSPORTATION

RURAL ENTRANCE SCHEDULE AND MAILBOX TURNOUT DETAILS  
WITH SHOULDERS

SCALE: SHEET OF SHEETS STA. TO STA.

F.A.P. RTE.	SECTION	COUNTY	TOTAL SHEETS	SHEET NO.
781	3 RS-3	*	18	8
CRAWFORD & JASPER		CONTRACT NO. 74603		
ILLINOIS FED. AID PROJECT				



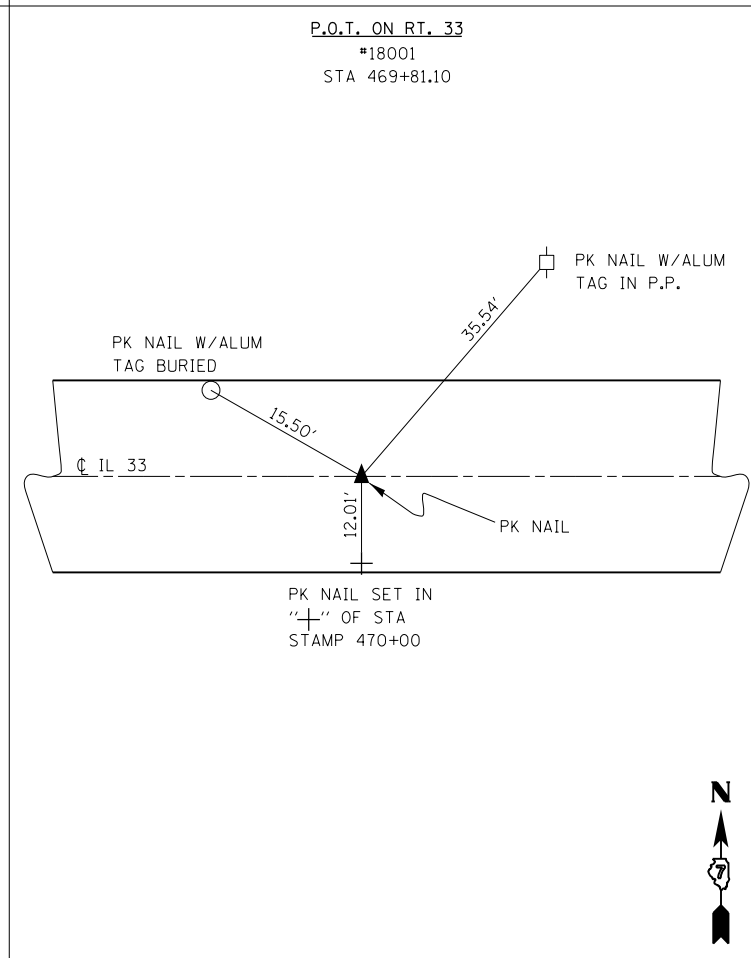
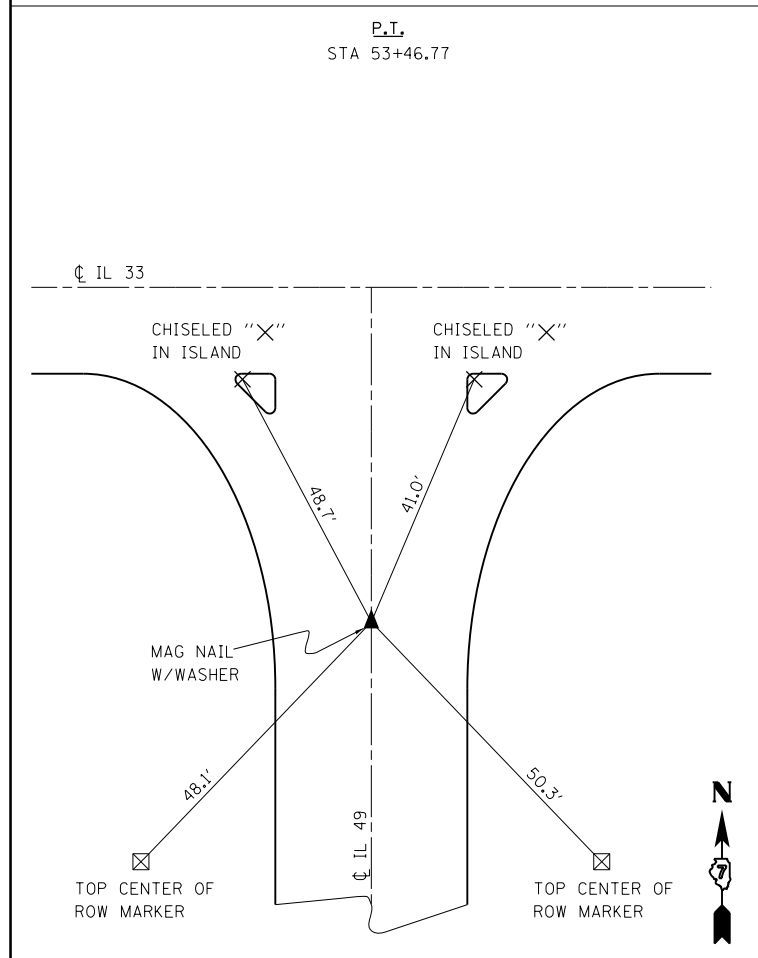
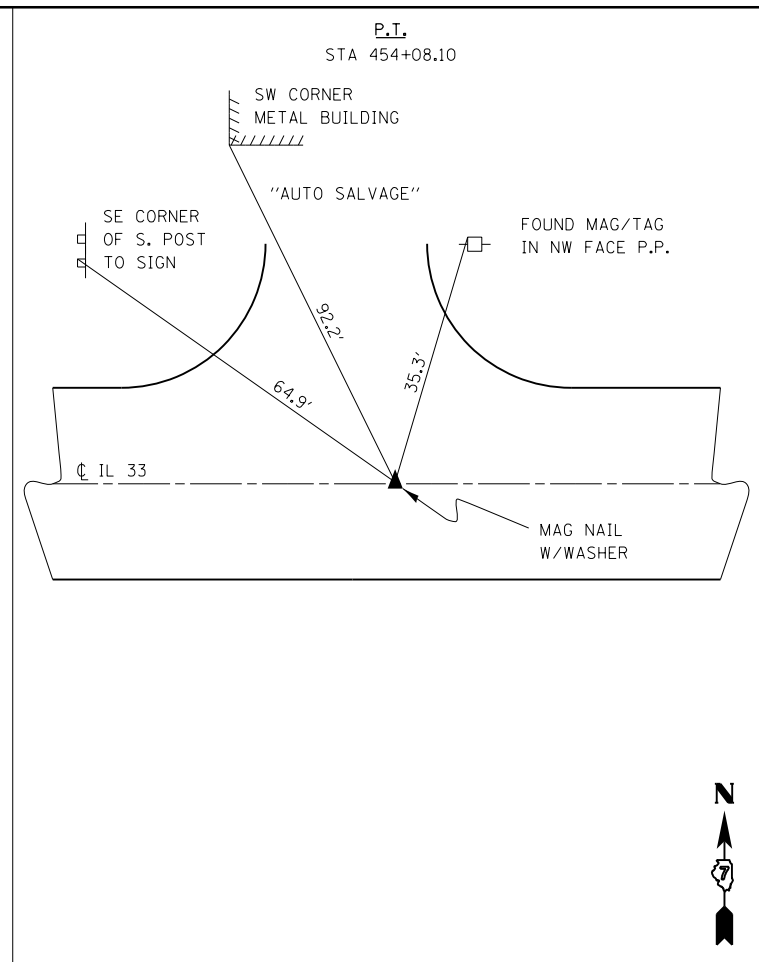
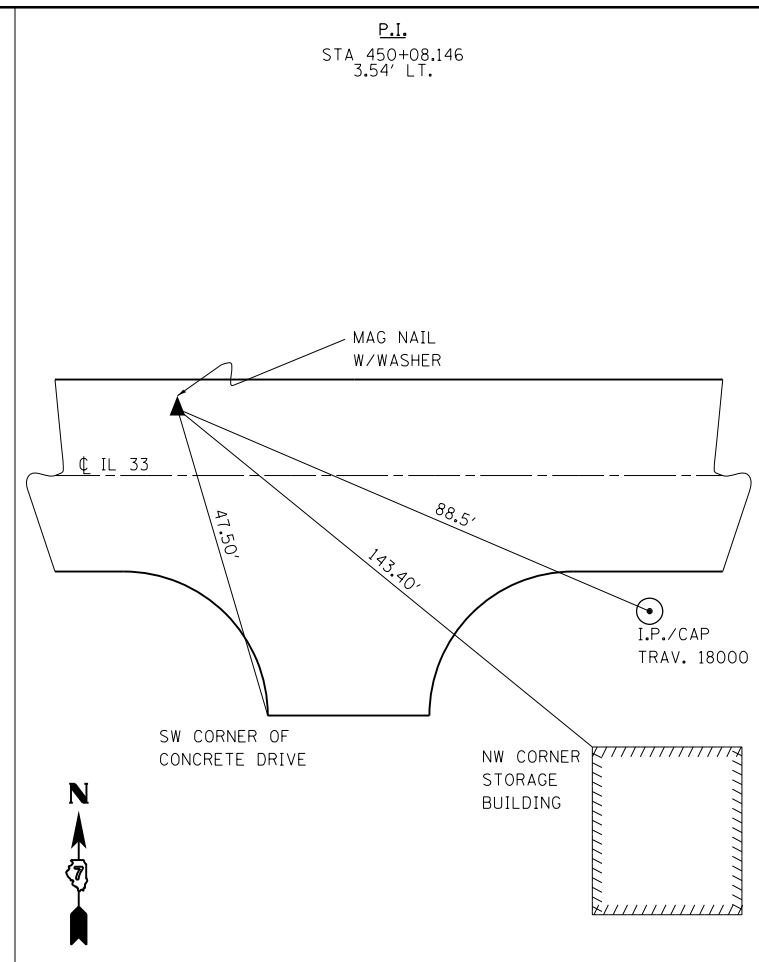
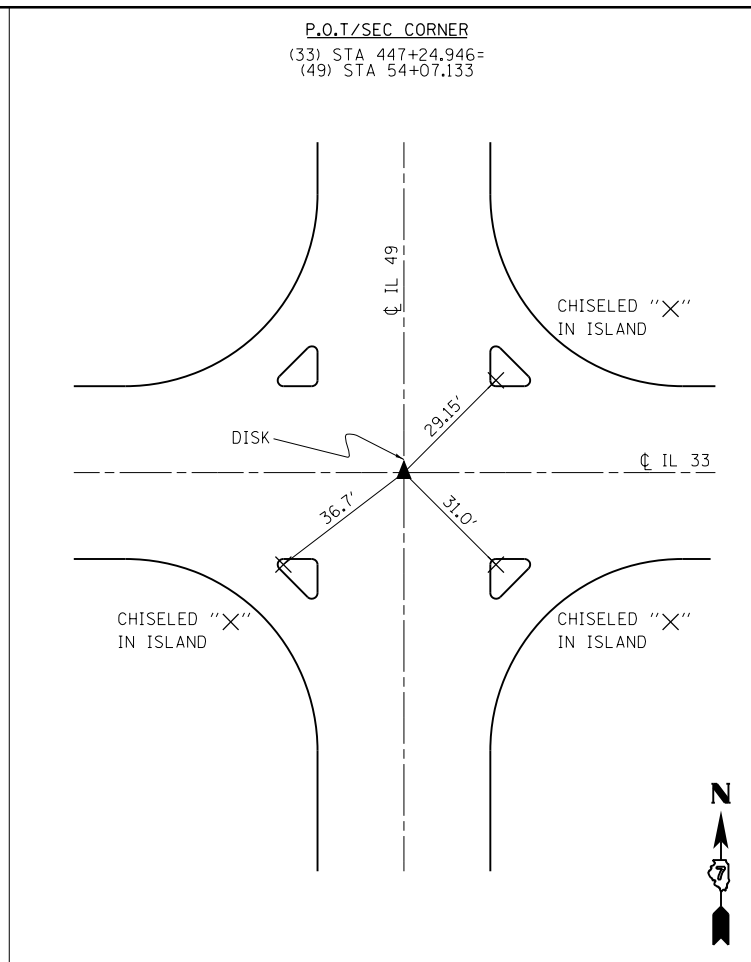
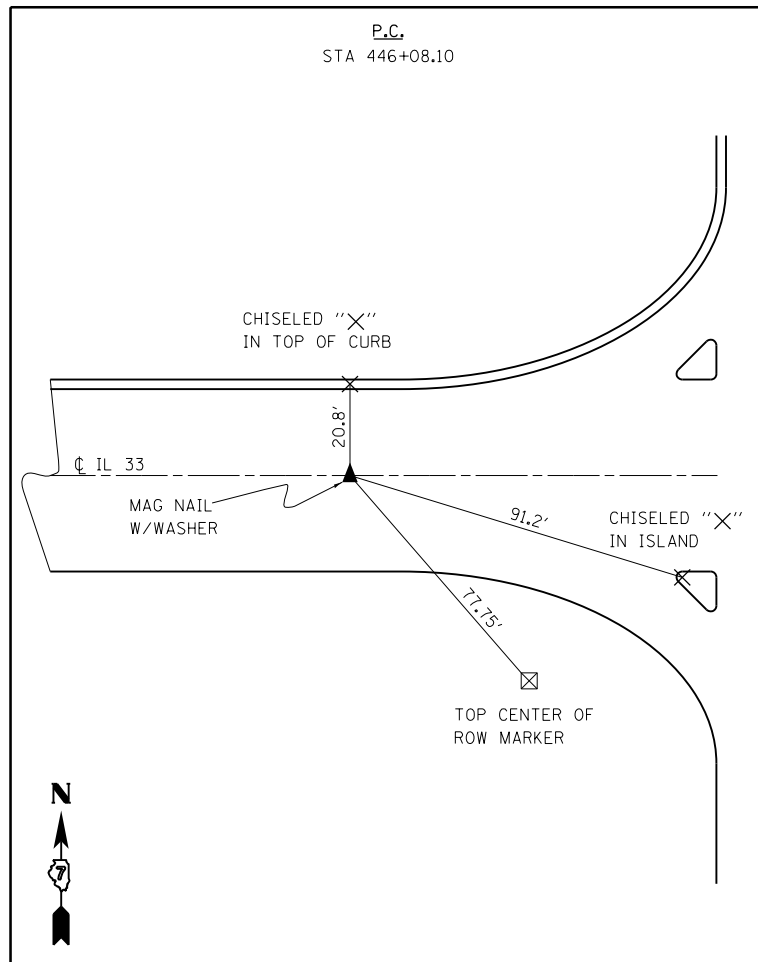

Schedule of Existing Monuments & Section Corners

Station	Offset	Description
<u>Intersection</u>		
54+07 IL 49	0	Disk in intersection of IL 49 & IL 33
447+24.95 IL 33	0	Same Disk as above.
53+46.77 IL 49	0	PT Mag/Wash
446+08.10 IL 33	0	PC Mag/Wash
450+08.14 IL 33	3.54' LT	PI Mag/Wash
<u>IL 33</u>		
454+08.10	0	PT Mag/Wash
469+81.10	0	POT Mag/Wash

FILE NAME =	USER NAME = steffennk	DESIGNED -	REVISED -
ci:\pwork\work\pwork\stefennk\d0396327\074603-sht-atb.dgn		DRAWN -	REVISED -
Default	PLOT SCALE = 100.0000' / in.	CHECKED -	REVISED -
	PLOT DATE = 5/13/2014	DATE -	REVISED -

STATE OF ILLINOIS  
DEPARTMENT OF TRANSPORTATION

SURVEY TIES

SCALE: SHEET OF SHEETS STA. TO STA.

F.A.P. RTE.	SECTION	COUNTY	TOTAL SHEETS	SHEET NO.
781	3 RS-3		18	8A
CRAWFORD & JASPER			CONTRACT NO. 74603	
ILLINOIS FED. AID PROJECT				

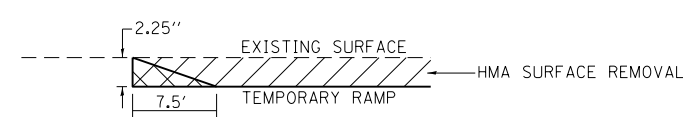
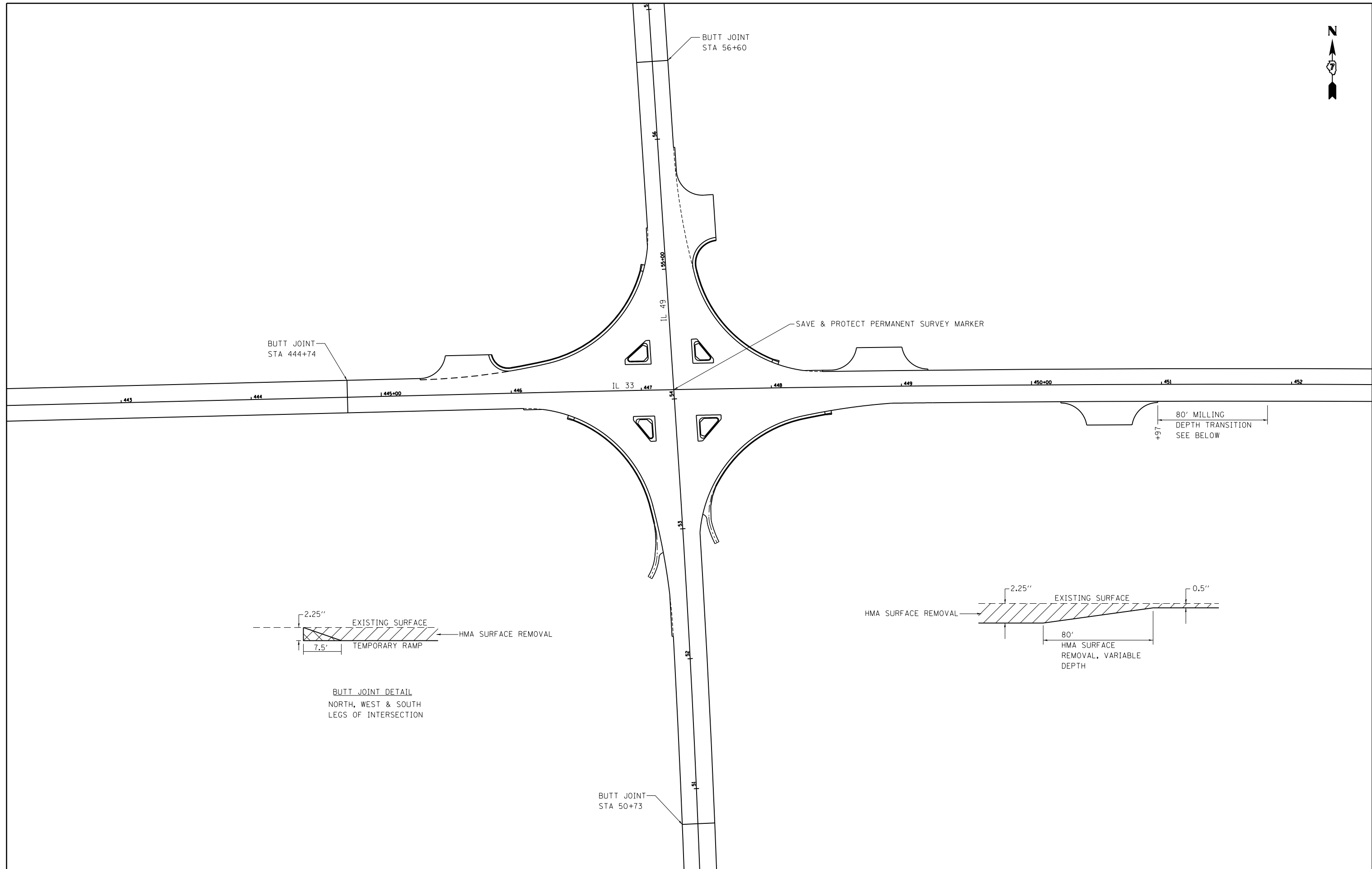

BUTT JOINT DETAIL  
NORTH, WEST & SOUTH  
LEGS OF INTERSECTION

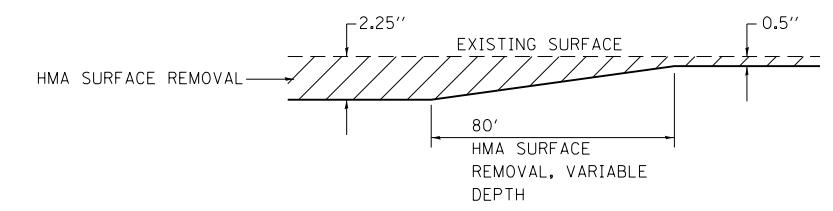

FILE NAME =	USER NAME = steffenmk	DESIGNED -	REVISED -
ci:\pw\work\p\dot\steffenmk\d0396327\074603-sht-details.dgn		DRAWN -	REVISED -
Default	PLOT SCALE = 100.0000' / in.	CHECKED -	REVISED -
	PLOT DATE = 5/13/2014	DATE -	REVISED -

**STATE OF ILLINOIS  
DEPARTMENT OF TRANSPORTATION**

<b>INTERSECTION DETAILS</b>			
SCALE:	SHEET	OF	SHEETS
	STA.	TO	STA.

F.A.P. RTE.	SECTION	COUNTY	TOTAL SHEETS	SHEET NO.
781	3 RS-3	*	18	9
CRAWFORD & JASPER			CONTRACT NO. 74603	
ILLINOIS FED. AID PROJECT				

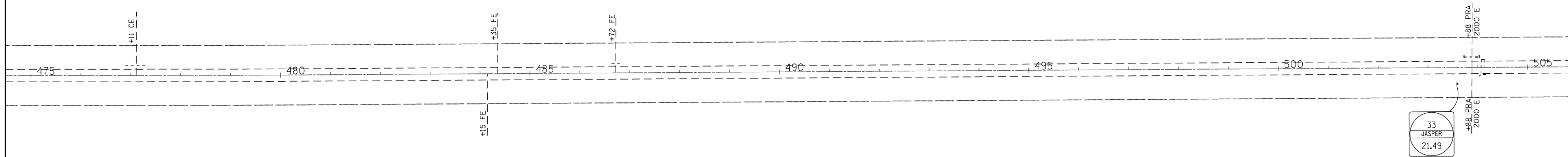
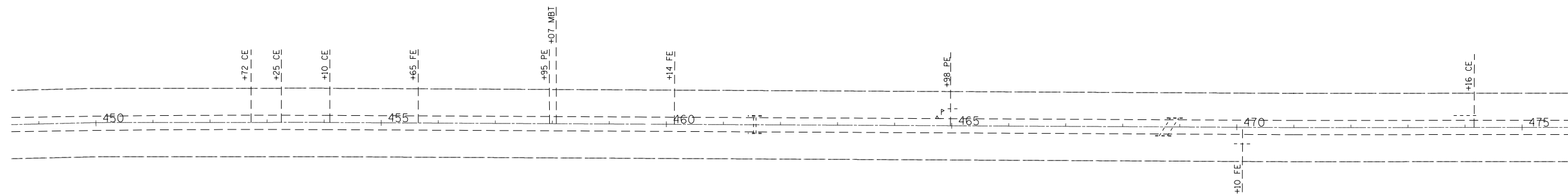

FILE NAME =	USER NAME = steffenmk	DESIGNED -	REVISED -
c:\pw\work\p\dot\stef\mk\d0396327\074603-sht-plan.dgn		DRAWN -	REVISED -
	PLOT SCALE = 200.0000' / in.	CHECKED -	REVISED -
Default	PLOT DATE = 5/13/2014	DATE -	REVISED -

**STATE OF ILLINOIS  
DEPARTMENT OF TRANSPORTATION**

**PLAN SHEET  
STA 450+00 TO STA 505+00**

SCALE: SHEET OF SHEETS STA. TO STA.

F.A.P. RTE.	SECTION	COUNTY	TOTAL SHEETS	SHEET NO.
781	3 RS-3	*	18	10
* CRAWFORD & JASPER			CONTRACT NO. 74603	
ILLINOIS FED. AID PROJECT				

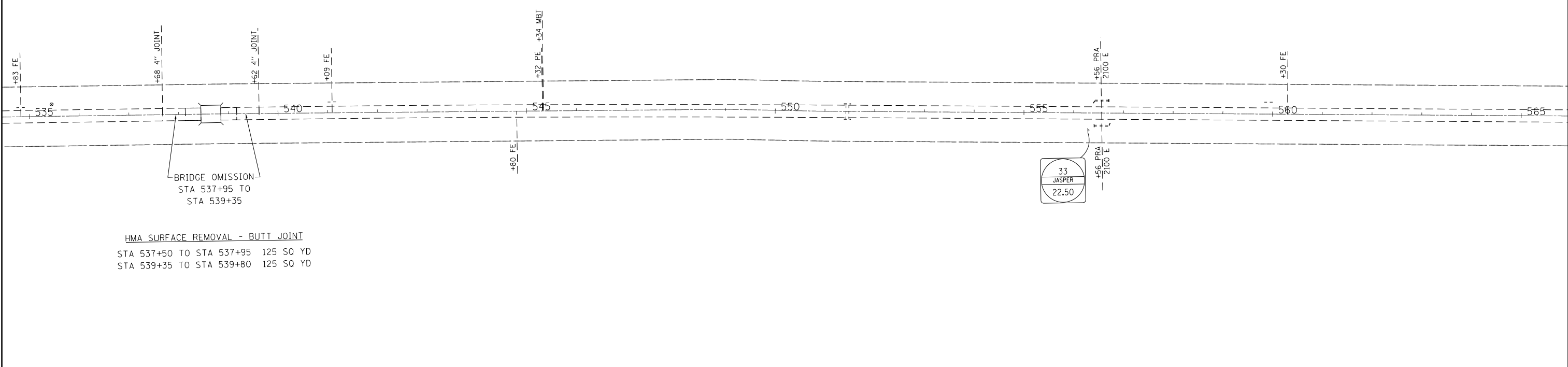
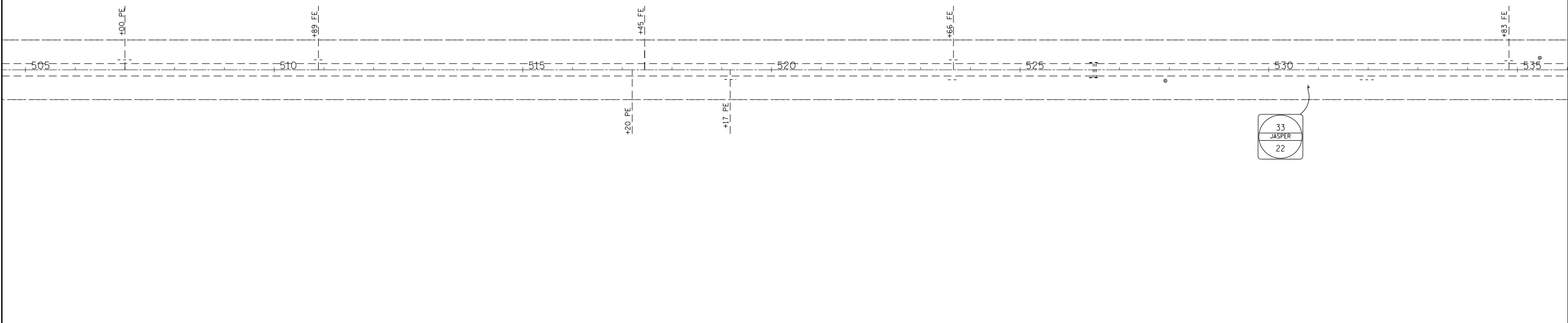

BRIDGE OMISSION  
STA 537+95 TO  
STA 539+35

HMA SURFACE REMOVAL - BUTT JOINT  
STA 537+50 TO STA 537+95 125 SQ YD  
STA 539+35 TO STA 539+80 125 SQ YD

FILE NAME =	USER NAME = steffenmk	DESIGNED -	REVISED -
ci:\pw_work\p\dot\steffenmk\d0396327\074603-sht-plan.dgn		DRAWN -	REVISED -
Default	PLOT SCALE = 200.0000' / in.	CHECKED -	REVISED -
	PLOT DATE = 5/13/2014	DATE -	REVISED -

**STATE OF ILLINOIS  
DEPARTMENT OF TRANSPORTATION**

**PLAN SHEET  
STA 505+00 TO STA 565+00**

SCALE: SHEET OF SHEETS STA. TO STA.

F.A.P. RTE.	SECTION	COUNTY	TOTAL SHEETS	SHEET NO.
781	3 RS-3	*	18	11
* CRAWFORD & JASPER			CONTRACT NO. 74603	
ILLINOIS FED. AID PROJECT				

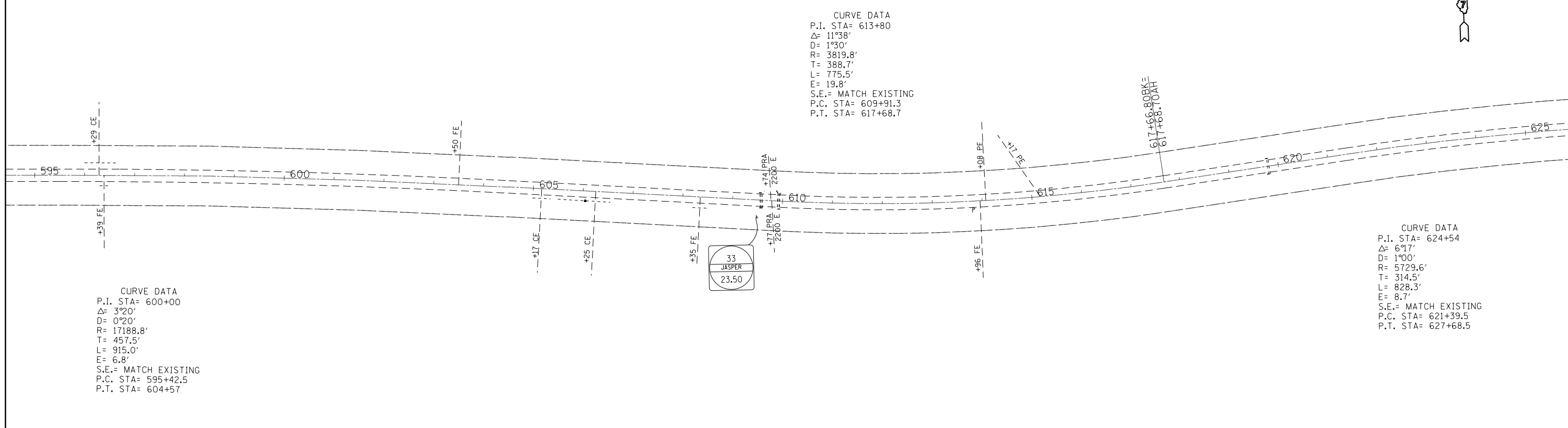
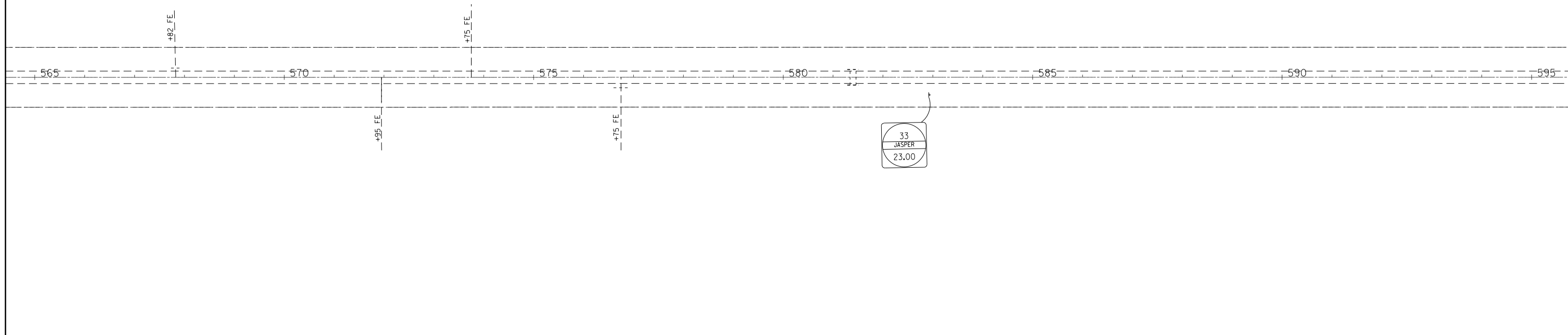

FILE NAME =	USER NAME = steffenk	DESIGNED -	REVISED -
ci:\pw\work\p\dot\stefenk\d0396327\074603-sht-plan.dgn		DRAWN -	REVISED -
Default	PLOT SCALE = 200.0000' / in.	CHECKED -	REVISED -
	PLOT DATE = 5/13/2014	DATE -	REVISED -

**STATE OF ILLINOIS  
DEPARTMENT OF TRANSPORTATION**

**PLAN SHEET  
STA 565+00 TO STA 625+00**

SCALE: SHEET OF SHEETS STA. TO STA.

F.A.P. RTE.	SECTION	COUNTY	TOTAL SHEETS	SHEET NO.
781	3 RS-3	*	18	12
* CRAWFORD & JASPER			CONTRACT NO. 74603	
ILLINOIS FED. AID PROJECT				

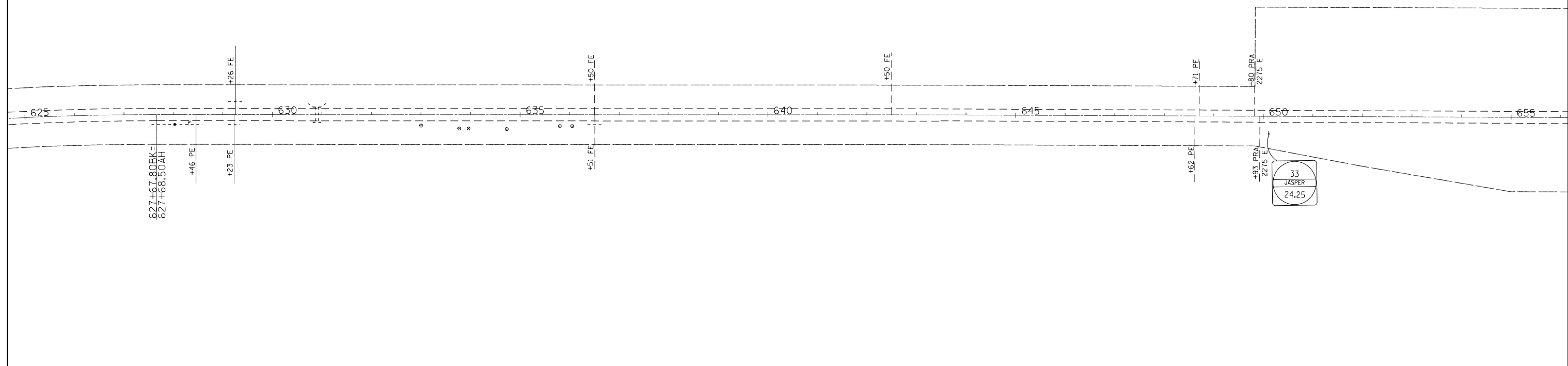

CURVE DATA  
 P.I. STA= 681+97.1  
 $\Delta$ = 42°09'  
 D= 5°40'  
 R= 1011.5'  
 T= 389.7'  
 L= 743.8'  
 E= 72.44'  
 S.E.= .0417'/'  
 P.C. STA= 678+07.4  
 P.T. STA= 685+51.2

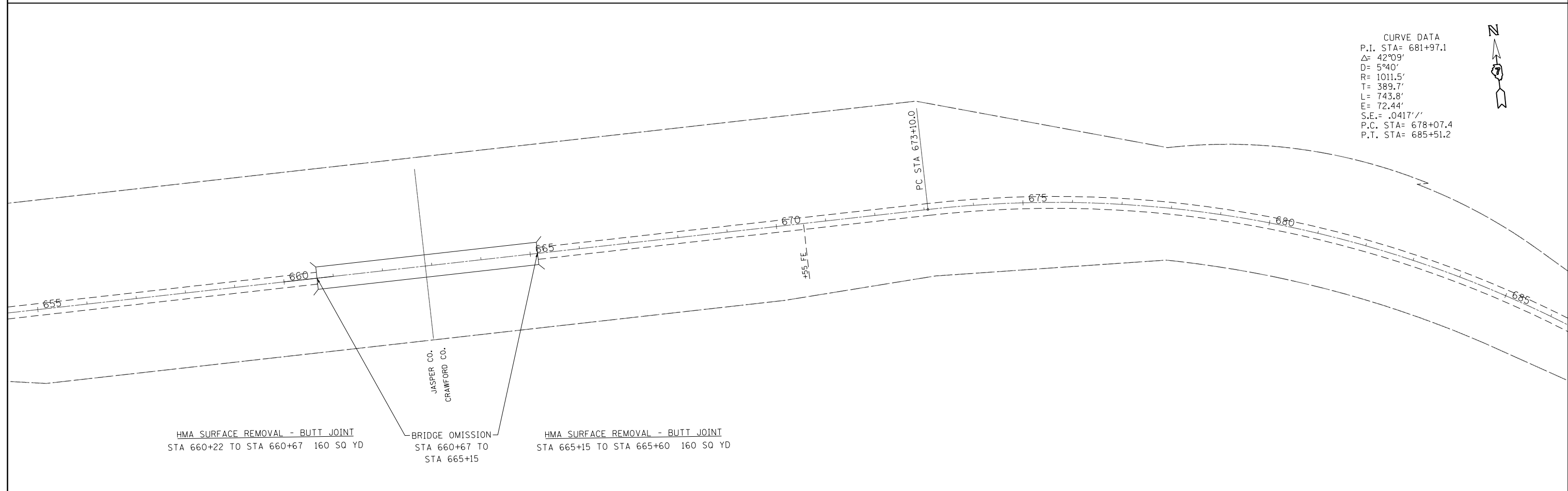

FILE NAME =	USER NAME = steffenmk	DESIGNED -	REVISED -
ci:\pw_work\pwidot\steffenmk\d0396327\074603-sht-pln.dgn		DRAWN -	REVISED -
Default	PLOT SCALE = 200.0000' / in.	CHECKED -	REVISED -
	PLOT DATE = 5/13/2014	DATE -	REVISED -

**STATE OF ILLINOIS  
 DEPARTMENT OF TRANSPORTATION**

**PLAN SHEET  
 STA 625+00 TO STA 685+00**

SCALE: SHEET OF SHEETS STA. TO STA.

F.A.P. RTE.	SECTION	COUNTY	TOTAL SHEETS	SHEET NO.
781	3 RS-3	*	18	13
* CRAWFORD & JASPER			CONTRACT NO. 74603	
ILLINOIS FED. AID PROJECT				

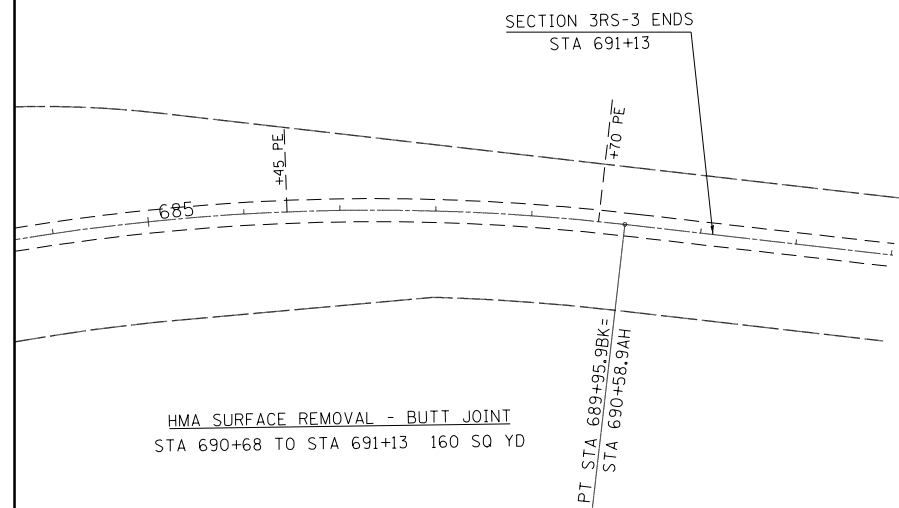
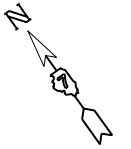

FILE NAME =	USER NAME = steffenmk	DESIGNED -	REVISED -
c:\pw\work\p\dot\steffenmk\d0396327\074603-sht-plan.dgn		DRAWN -	REVISED -
Default	PLOT SCALE = 200.0000' / in.	CHECKED -	REVISED -
	PLOT DATE = 5/13/2014	DATE -	REVISED -

**STATE OF ILLINOIS  
DEPARTMENT OF TRANSPORTATION**

**PLAN SHEET  
STA 685+00 TO STA 693+00**

SCALE: SHEET OF SHEETS STA. TO STA.

F.A.P. RTE.	SECTION	COUNTY	TOTAL SHEETS	SHEET NO.
781	3 RS-3	*	18	14
* CRAWFORD & JASPER			CONTRACT NO. 74603	
ILLINOIS FED. AID PROJECT				

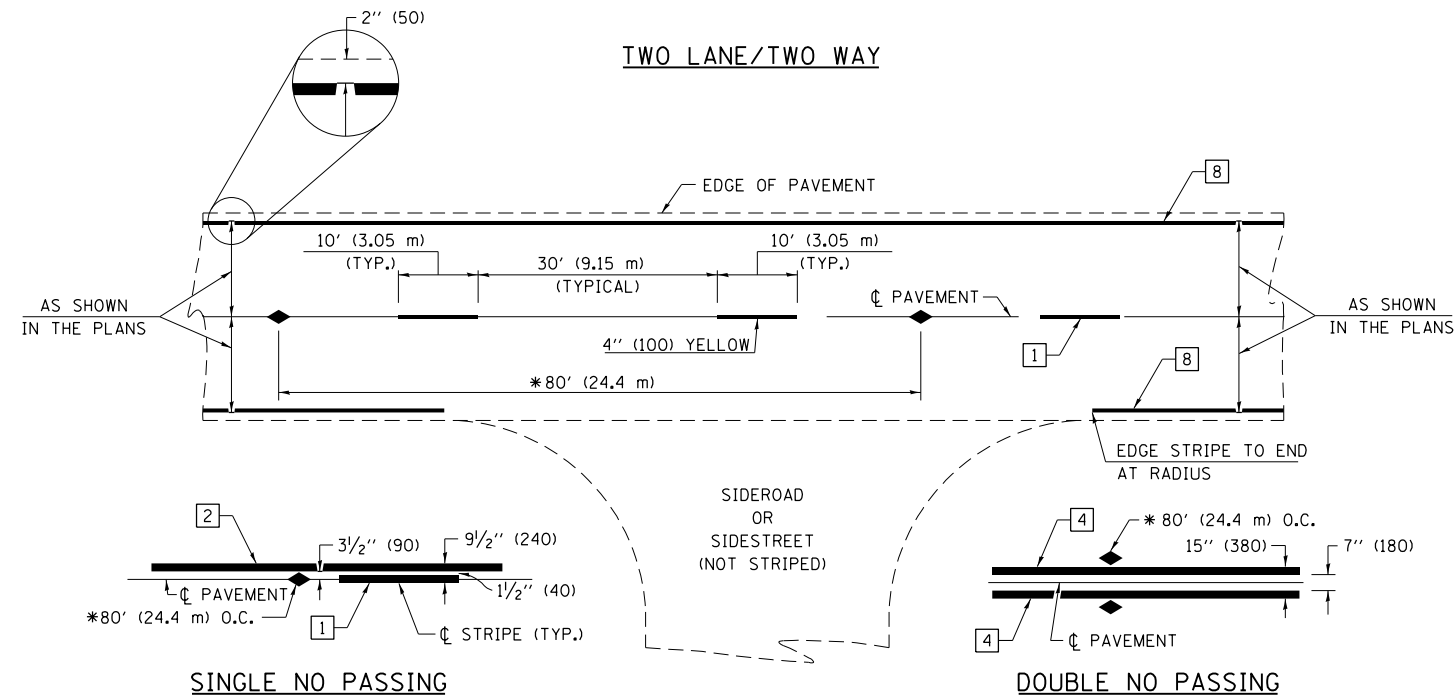

\* REDUCE TO 40' (12.2 m) O.C. ON CURVES WITH POSTED OR ADVISORY SPEEDS OF 45 mph (70 km/h) OR LESS.

PAVEMENT MARKING LEGEND

- 1 4" (100) SKIP-DASH (YELLOW)
- 2 4" (100) SOLID (YELLOW)
- 3 12" (300) DIAGONAL (YELLOW)
- 4 4" (100) DOUBLE YELLOW (NARROW)
- 5 12" (300) SOLID WHITE
- 6 RESERVED
- 7 6" (150) SKIP-DASH (WHITE)
- 8 4" (100) SOLID (WHITE)
- 9 12" (300) DIAGONAL (WHITE)
- 10 6" (150) SOLID (WHITE)
- 11 24" (600) STOP BAR (WHITE)
- 12 8" (200) SOLID (WHITE)
- 13 4" (100) PARKING WHITE

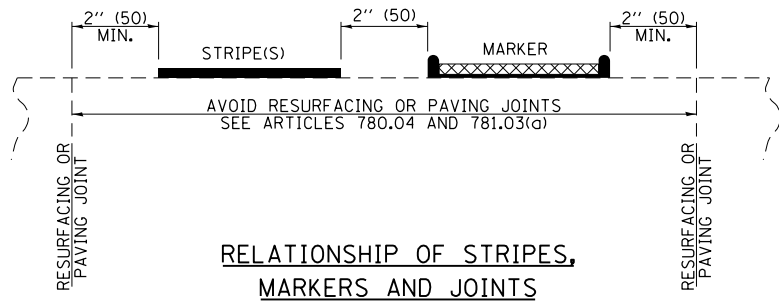

TYPICAL PAVEMENT MARKERS LEGEND

- ◆ TWO-WAY AMBER MARKER
- ▶ ONE-WAY AMBER MARKER
- ▷ ONE-WAY CRYSTAL MARKER

RAISED REFLECTIVE PAVEMENT MARKERS

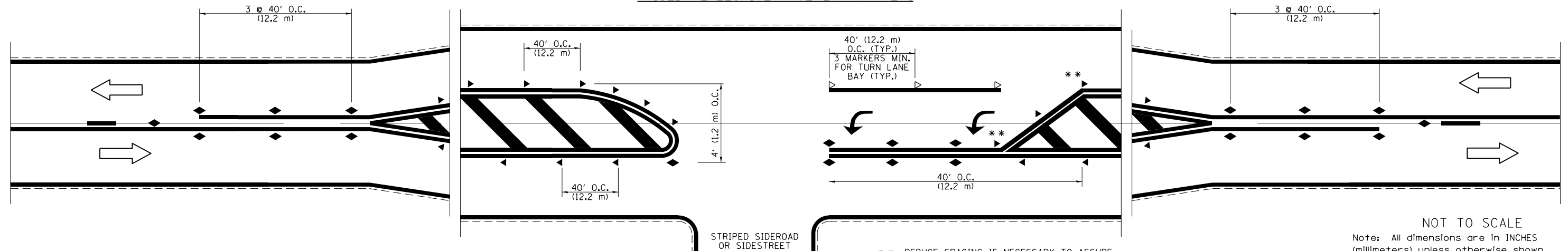

\*\* REDUCE SPACING IF NECESSARY TO ASSURE MARKERS AT CORNER POINTS.

NOT TO SCALE  
Note: All dimensions are in INCHES (millimeters) unless otherwise shown.

DISTRICT 7 DETAIL NO. 78000001

FILE NAME =	USER NAME = steffenmk	DESIGNED -	REVISED -
ei:\pw\work\p\d03\stevf\mk\d0396327\0774603-sht-details.dgn		DRAWN -	REVISED -
	PLOT SCALE = 100.0000' / 1in.	CHECKED -	REVISED -
	PLOT DATE = 5/13/2014	DATE -	REVISED -

STATE OF ILLINOIS  
DEPARTMENT OF TRANSPORTATION

PAVEMENT MARKING AND RAISED REFLECTIVE PAVEMENT MARKERS  
(RURAL & URBAN APPLICATIONS)

SCALE: SHEET NO. 1 OF 4 SHEETS STA. TO STA.

F.A.P. RTE.	SECTION	COUNTY	TOTAL SHEETS	SHEET NO.
781	3 RS-3		18	15
CRAWFORD & JASPER			CONTRACT NO. 74603	
ILLINOIS FED. AID PROJECT				



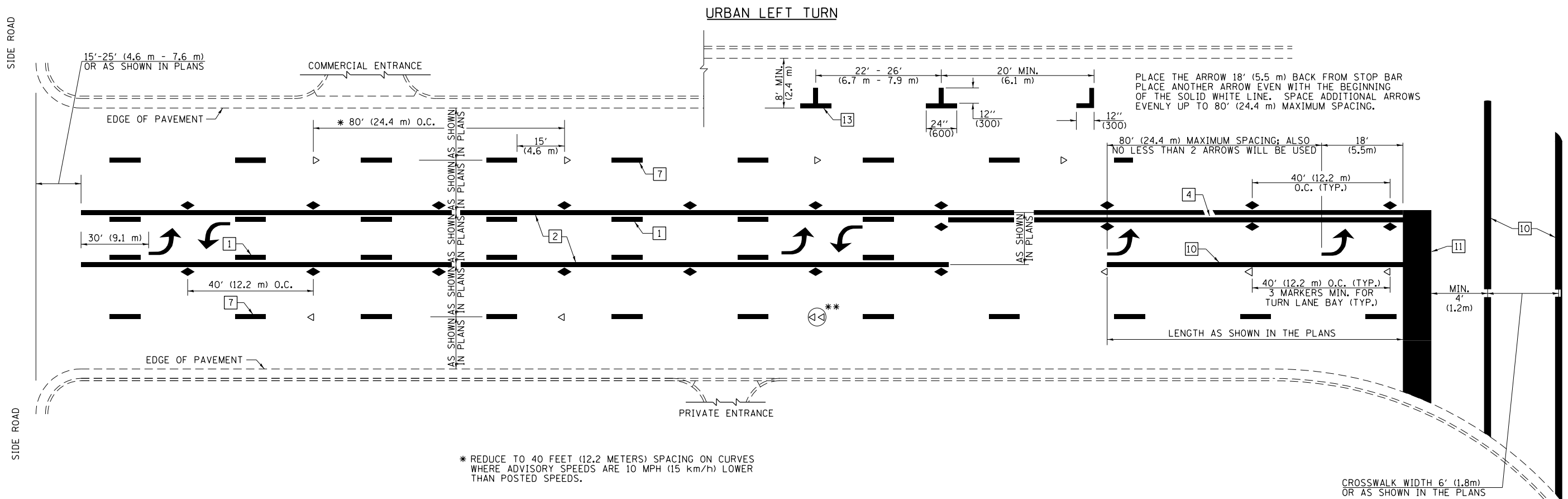

\* REDUCE TO 40 FEET (12.2 METERS) SPACING ON CURVES WHERE ADVISORY SPEEDS ARE 10 MPH (15 km/h) LOWER THAN POSTED SPEEDS.

\*\* DOUBLE LANE LINE MARKERS SHALL BE SPECIFIED AND SPACED AS SHOWN IN HIGHWAY STANDARD 781001 FOR MULTI-LANE DIVIDED AND UNDIVIDED HIGHWAYS.

**PAVEMENT MARKING LEGEND**

- 1 4" (100) SKIP-DASH (YELLOW)
- 2 4" (100) SOLID (YELLOW)
- 3 12" (300) DIAGONAL (YELLOW)
- 4 4" (100) DOUBLE YELLOW (NARROW)
- 5 12" (300) SOLID WHITE
- 6 RESERVED
- 7 6" (150) SKIP-DASH (WHITE)
- 8 4" (100) SOLID (WHITE)
- 9 12" (300) DIAGONAL (WHITE)
- 10 6" (150) SOLID (WHITE)
- 11 24" (600) STOP BAR (WHITE)
- 12 8" (200) SOLID (WHITE)
- 13 4" (100) PARKING WHITE

**GENERAL NOTES**

1. TURN ARROW PAIRS SHALL BE PLACED AT 250' (75 m) INTERVALS AND SHALL BE EVENLY SPACED BETWEEN BOTH ENDS OF THE BIDIRECTIONAL LEFT TURN LANE. USE A MINIMUM OF TWO PAIRS PER BLOCK.
2. THE SOLID YELLOW PAVEMENT MARKINGS [2] SHOULD GENERALLY START OR END NEAR THE RADIUS POINT OF EACH STREET RETURN EXCEPT WHERE ONE OR BOTH ENDS WOULD INCLUDE STOP BARS.
3. THE SKIP-DASH PAVEMENT MARKINGS [1] OR [7] SHOULD BE CENTERED BETWEEN BOTH ENDS OF EACH CITY BLOCK AND SHALL BE PLACED SO THEY LINE UP ACROSS FROM EACH OTHER.
4. USE LARGE ARROW SIZE FOR BOTH RURAL AND URBAN LOCATIONS. (SEE LAST PAGE OF SECTION 780x FOR SYMBOLS TABLE)
5. LANE LINE EXTENSIONS SHALL BE THE SAME COLOR AND WIDTH AS THE LANE LINE BEING EXTENDED.

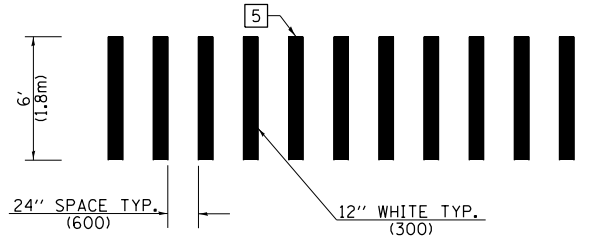

**CROSSWALK DETAIL (DECATUR CITY LIMITS ONLY)**

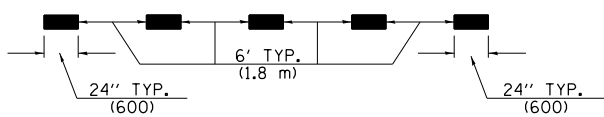

**LANE LINE EXTENSIONS**

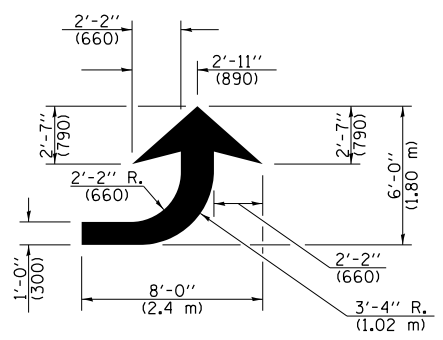

**LEFT ARROW**

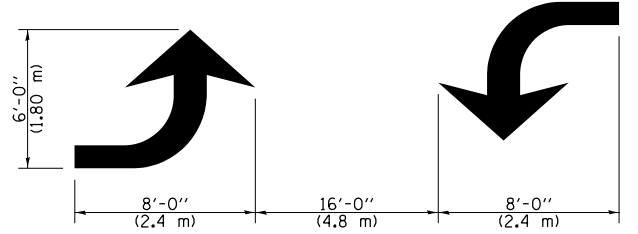

**TYPICAL DOUBLE TURN ARROWS (WHITE)**

NOT TO SCALE

Note: All dimensions are in INCHES (millimeters) unless otherwise shown.

**DISTRICT 7 DETAIL NO. 78000001**

FILE NAME =	USER NAME = steffenmk	DESIGNED -	REVISED -	<b>STATE OF ILLINOIS DEPARTMENT OF TRANSPORTATION</b>	<b>PAVEMENT MARKING AND RAISED REFLECTIVE PAVEMENT MARKERS (RURAL &amp; URBAN APPLICATIONS)</b>	F.A.P. RTE.	SECTION	COUNTY	TOTAL SHEETS	SHEET NO.
ei:\pw\work\p\d03\steffenmk\d0396327\074603-sht-details.dgn	PLOT SCALE = 100.0000' / in.	DRAWN -	REVISED -			781	3 RS-3		18	16
	PLOT DATE = 5/13/2014	CHECKED -	REVISED -			CRAWFORD & JASPER		CONTRACT NO. 74603		
		DATE -	REVISED -			ILLINOIS FED. AID PROJECT				

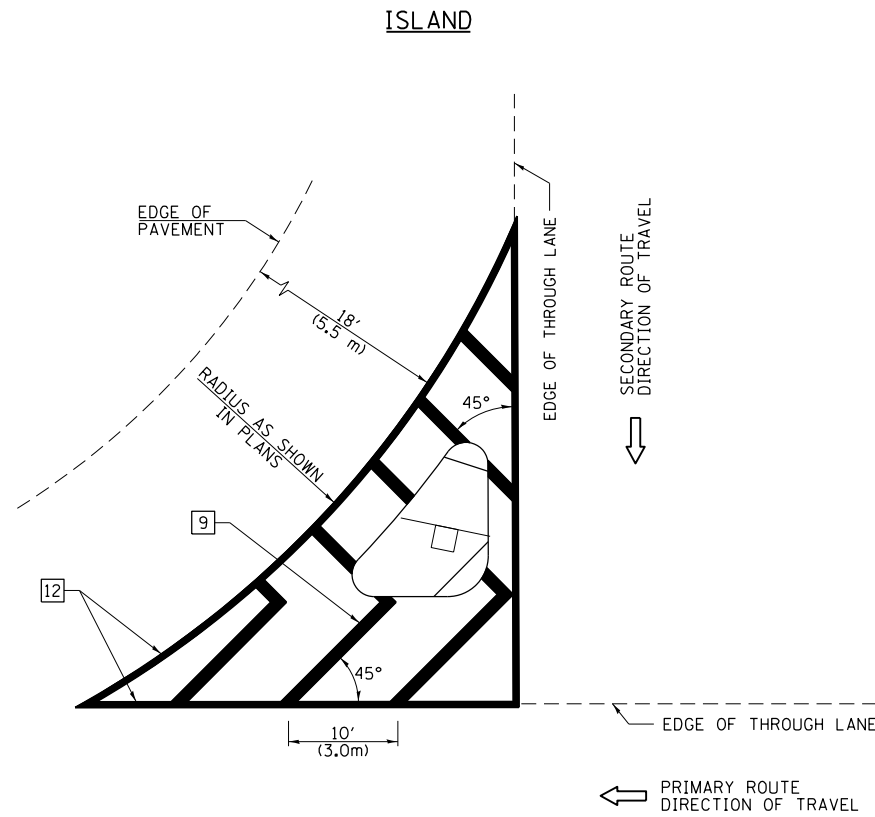

**GENERAL NOTES**

1. RAISED AND CORRUGATED MEDIANS SHALL BE OUTLINED WITH [2] IF PRESENT.
2. SOME OF THE INFORMATION INCLUDED WITH THIS DETAIL MAY NOT BE APPLICABLE TO THIS IMPROVEMENT.
3. PAVEMENT MARKINGS ARE TO BE EXTENDED THROUGH OMISSIONS WHEN APPLICABLE.
4. FINAL PAVEMENT MARKINGS SHALL BE IN PLACE PRIOR TO PLACING ANY RAISED REFLECTIVE PAVEMENT MARKERS.
5. THE FOLLOWING CRITERIA SHALL BE USED FOR SELECTING THE DIAGONAL PAVEMENT MARKING SPACING:

< 30 MPH (< 50 km/h)	15' (4.5 m)
30-45 MPH (50-75 km/h)	20' (6.0 m)
> 45 MPH (> 75 km/h)	30' (9.0 m)

**PAVEMENT MARKING LEGEND**

- [1] 4" (100) SKIP-DASH (YELLOW)
- [2] 4" (100) SOLID (YELLOW)
- [3] 12" (300) DIAGONAL (YELLOW)
- [4] 4" (100) DOUBLE YELLOW (NARROW)
- [5] 12" (300) SOLID WHITE
- [6] RESERVED
- [7] 6" (150) SKIP-DASH (WHITE)
- [8] 4" (100) SOLID (WHITE)
- [9] 12" (300) DIAGONAL (WHITE)
- [10] 6" (150) SOLID (WHITE)
- [11] 24" (600) STOP BAR (WHITE)
- [12] 8" (200) SOLID (WHITE)
- [13] 4" (100) PARKING WHITE

**RURAL LEFT TURN STRIPING**

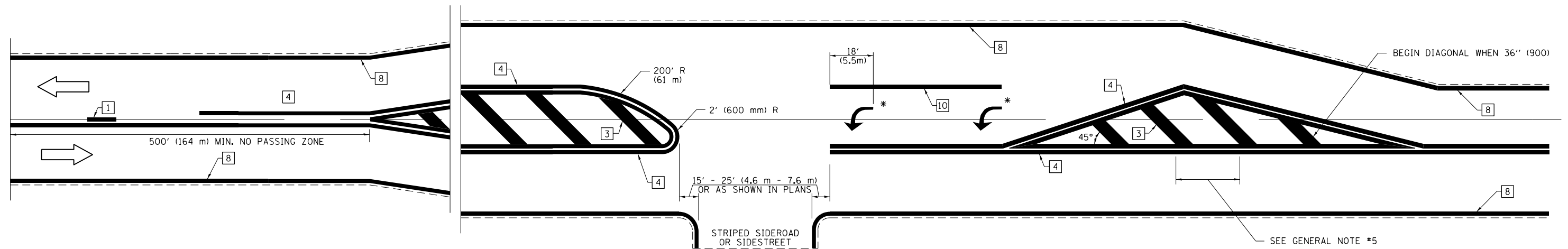

\* PLACE AN ARROW 18' (5.5 m) BACK FROM STOP BAR. PLACE ANOTHER ARROW EVEN WITH THE BEGINNING OF THE SOLID WHITE LINE. SPACE ADDITIONAL ARROWS EVENLY UP TO 80' (24.4 m) MAXIMUM SPACING. USE MINIMUM OF 2 ARROWS.

NOT TO SCALE  
 Note: All dimensions are in INCHES (millimeters) unless otherwise shown.

**DISTRICT 7 DETAIL NO. 7800001**

FILE NAME =	USER NAME = steffenmk	DESIGNED -	REVISED -	<b>STATE OF ILLINOIS DEPARTMENT OF TRANSPORTATION</b>	<b>PAVEMENT MARKING AND RAISED REFLECTIVE PAVEMENT MARKERS (RURAL &amp; URBAN APPLICATIONS)</b>	F.A.P. RTE.	SECTION	COUNTY	TOTAL SHEETS	SHEET NO.	
ei:\pw\work\p\idot\steffenmk\d0396327\074603-sht-details.dgn	PLOT SCALE = 100.0000' / in.	DRAWN -	REVISED -			781	3 RS-3		18	17	
	PLOT DATE = 5/13/2014	CHECKED -	REVISED -			CRAWFORD & JASPER		CONTRACT NO. 74603		ILLINOIS FED. AID PROJECT	
		DATE -	REVISED -			SCALE:	SHEET NO. 3 OF 4 SHEETS	STA.	TO STA.		

PAVEMENT MARKINGS AT RAILROAD-HIGHWAY GRADE CROSSING

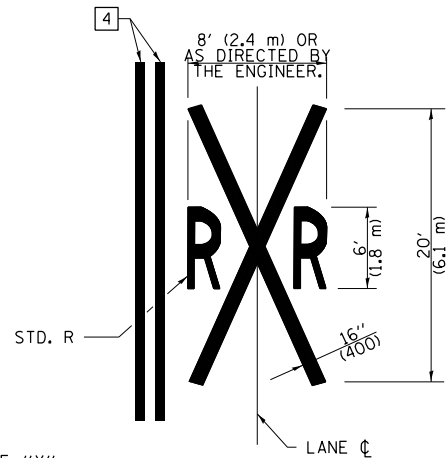
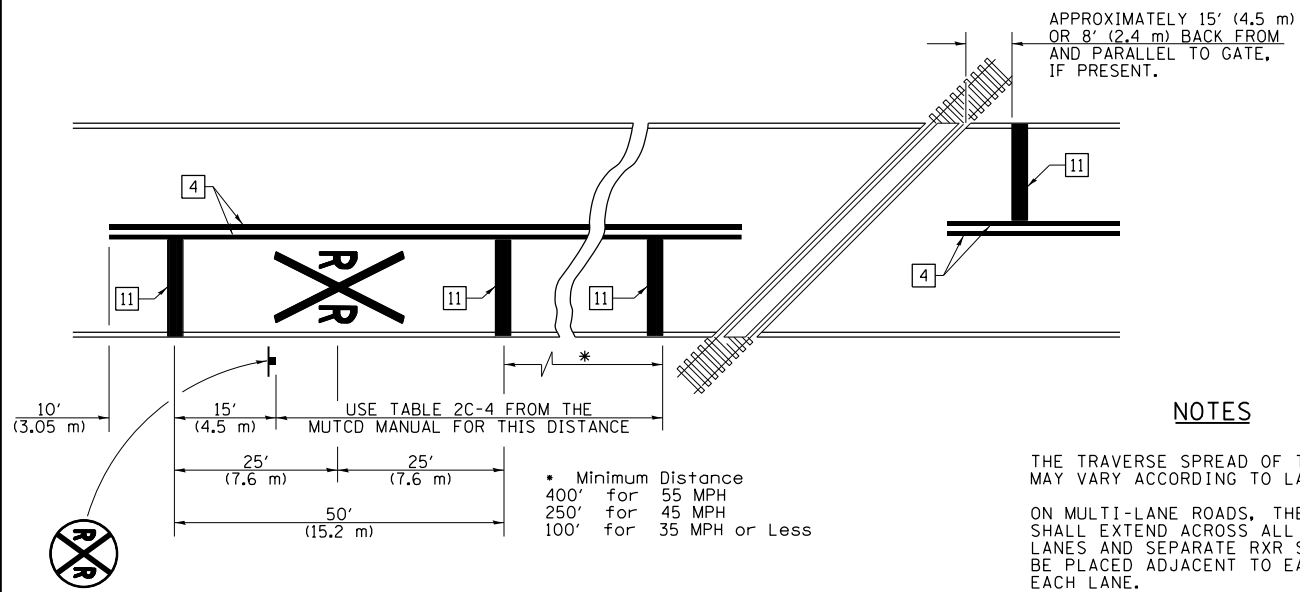

NOTES

THE TRAVERSE SPREAD OF THE "X" MAY VARY ACCORDING TO LANE WIDTH.

ON MULTI-LANE ROADS, THE STOP LINES SHALL EXTEND ACROSS ALL APPROACH LANES AND SEPARATE RXR SYMBOLS SHALL BE PLACED ADJACENT TO EACH OTHER IN EACH LANE.

WHEN THE PAVEMENT MARKING SYMBOL IS USED, A PORTION OF THE SYMBOL SHOULD BE LOCATED DIRECTLY ADJACENT TO THE ADVANCE WARNING SIGN (W10-1) AS PLACED BY TABLE II-1, CONDITION B OF THE MUTCD.

PAVEMENT MARKING LEGEND

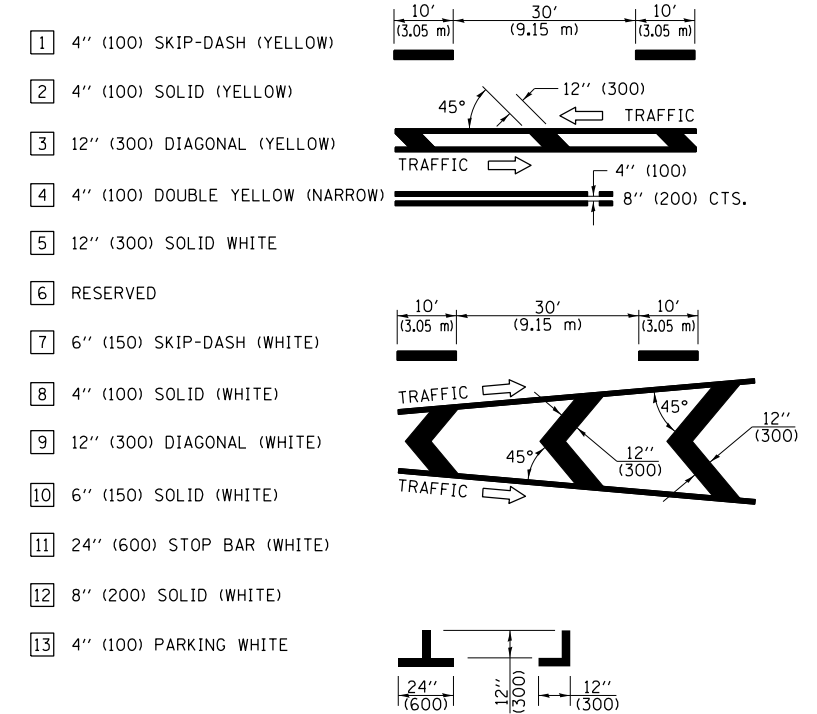

RAILROAD CROSSING WITH INTERCONNECT ONLY

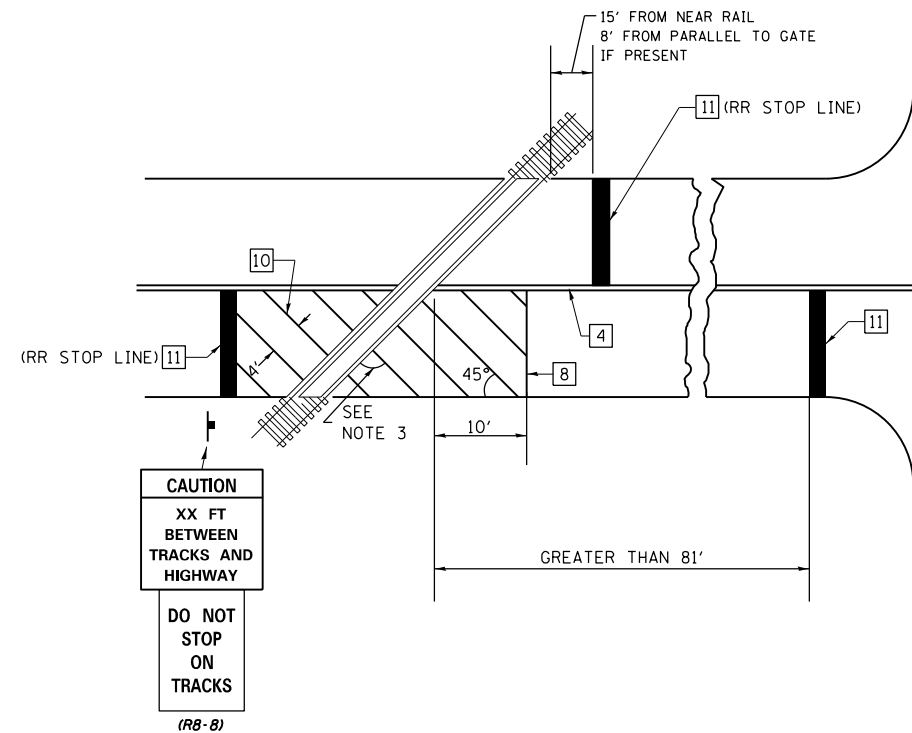

RAILROAD CROSSING WITH INTERCONNECT AND PRE-SIGNALS

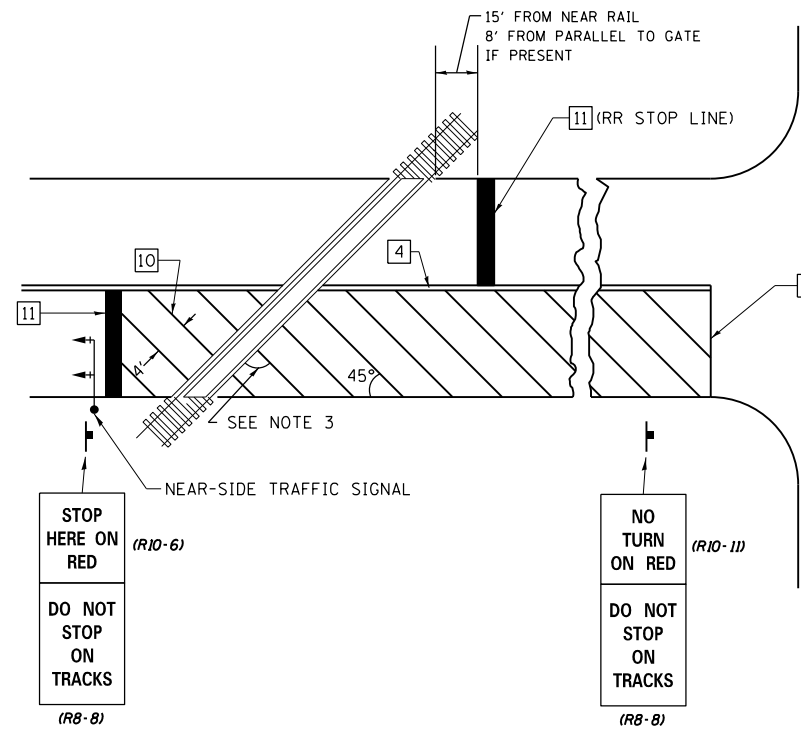

GENERAL NOTES

- SUPPLEMENTAL PAVEMENT MARKINGS TO BE INSTALLED ONLY ON APPROACHES TO INTERSECTIONS CONTROLLED BY TRAFFIC SIGNALS WHICH ARE INTERCONNECTED WITH THE RAILROAD WARNING SIGNALS.
- EXTEND PAVEMENT MARKINGS TO THE INTERSECTION ONLY WHERE NEAR-SIDE TRAFFIC SIGNALS ARE USED.
- WHERE THE ANGLE BETWEEN THE DIAGONAL PAVEMENT MARKINGS AND THE TRACK WOULD BE LESS THAN 20°, THE PAVEMENT MARKINGS SHOULD BE PLACED IN THE OPPOSITE DIRECTION FROM THAT SHOWN.

SUPPLEMENTAL PAVEMENT MARKING TREATMENT FOR RAILROAD-HIGHWAY GRADE CROSSING

NOT TO SCALE

Note: All dimensions are in INCHES (millimeters) unless otherwise shown.

FILE NAME =	USER NAME = steffenmk	DESIGNED -	REVISED -
c:\pwork\pwork\stevfemk\d0396327\074603-sht-details.dgn		DRAWN -	REVISED -
	PLOT SCALE = 100.0000' / 1in.	CHECKED -	REVISED -
	PLOT DATE = 5/13/2014	DATE -	REVISED -

STATE OF ILLINOIS  
DEPARTMENT OF TRANSPORTATION

PAVEMENT MARKING AND RAISED REFLECTIVE PAVEMENT MARKERS  
(RURAL & URBAN APPLICATIONS)

SCALE: SHEET NO. 4 OF 4 SHEETS STA. TO STA.

DISTRICT 7 DETAIL NO. 7800001				
F.A.P. RTE.	SECTION	COUNTY	TOTAL SHEETS	SHEET NO.
781	3 RS-3		18	18
CRAWFORD & JASPER			CONTRACT NO. 74603	
ILLINOIS FED. AID PROJECT				