

NORTH LEVEE LOCATION
STA. 1665+00 IL. 146

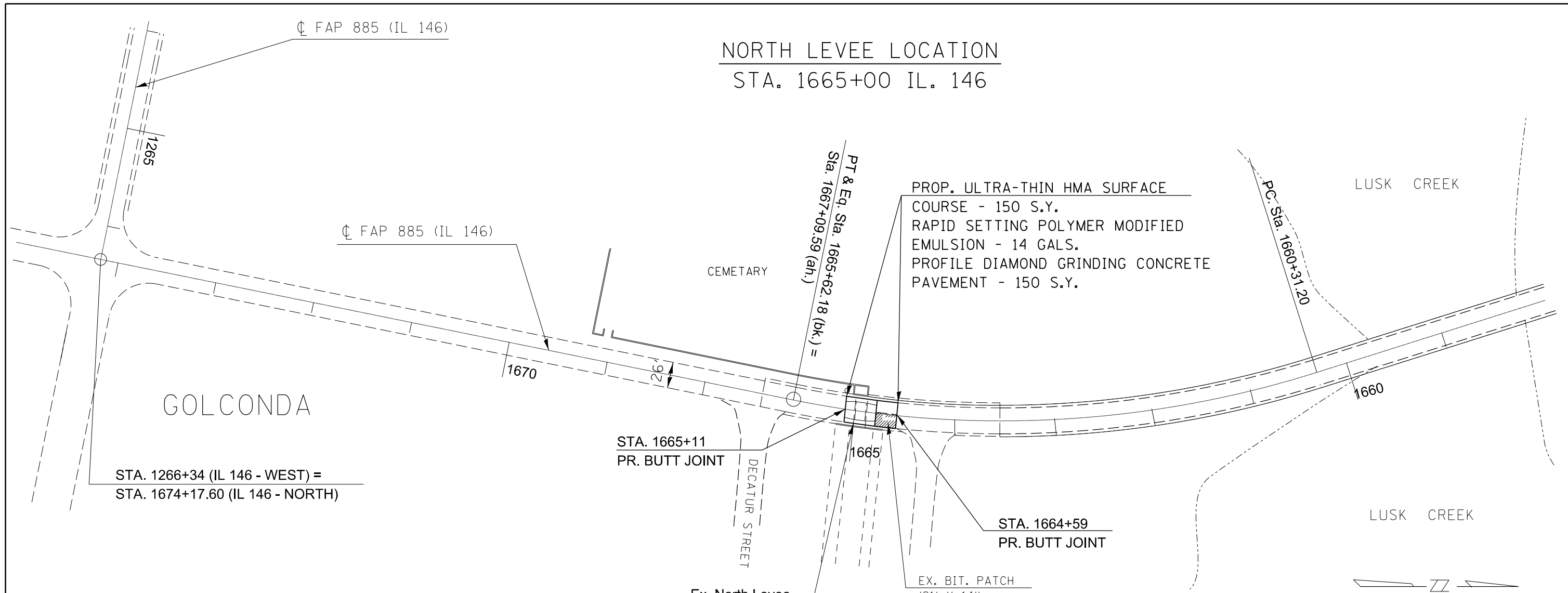

NORTH LEVEE DETAIL

PROP. ULTRA-THIN HMA SURFACE COURSE,
RAPID SETTING POLYMER MODIFIED EMULSION
AND PROFILE DIAMOND GRINDING CONC. PAV'T.

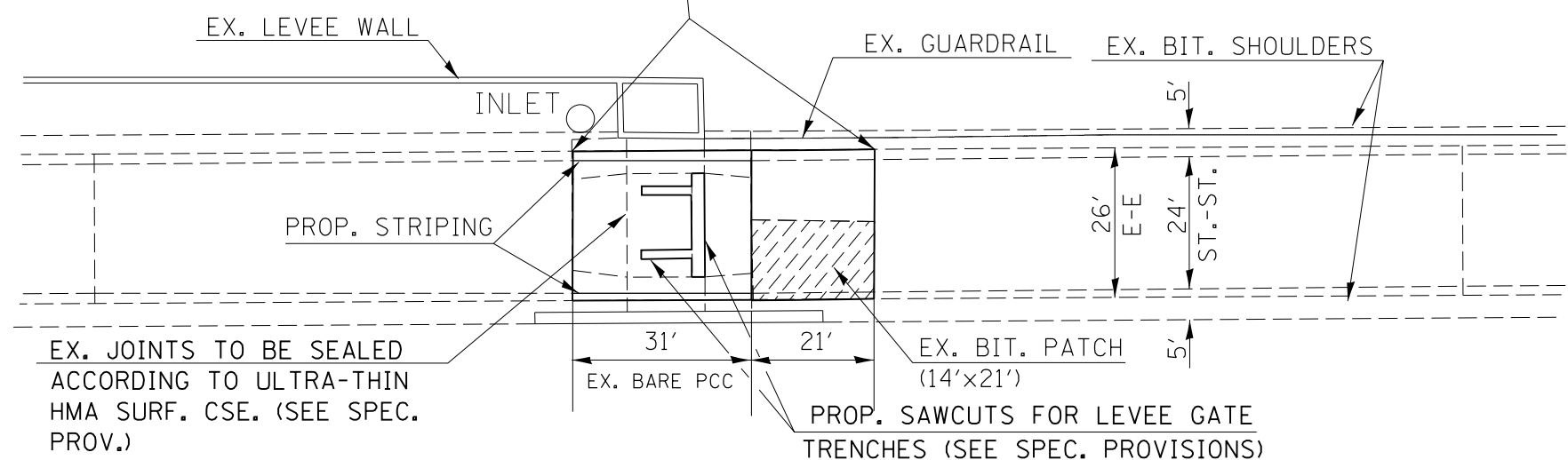

EX. JOINTS TO BE SEALED
ACCORDING TO ULTRA-THIN
HMA SURF. CSE. (SEE SPEC.
PROV.)

•FAP 42(IL 13/127) & FAP 885(IL 146)

FILE NAME =	USER NAME = mccordkr	DESIGNED -	REVISED -
et:\pw\work\p\idot\mccordkr\0342339\78366-sh1-pln.dgn		DRAWN -	REVISED -
Default	PLOT SCALE = 100.0000' / in.	CHECKED -	REVISED -
	PLOT DATE = 12/4/2013	DATE -	REVISED -

STATE OF ILLINOIS
DEPARTMENT OF TRANSPORTATION

NORTH LEVEE DETAILS
ON FAP 885 (IL. 146)

SCALE: SHEET OF SHEETS STA. TO STA.

F.A.P. RTE.	SECTION	COUNTY	TOTAL SHEETS	SHEET NO.
• D9 PAVT PRESERV 2014-1		JACKSON/POPE	23	23
			CONTRACT NO. 78366	
ILLINOIS FED. AID PROJECT				