

• & FAS 903		CN 78277		
F.A.U. RTE.	SECTION	COUNTY	TOTAL SHEETS	SHEET NO.
9588*	39(R-1,B-1,B-2)	WILLIAMSON	224	56
STA 69+00		TO STA 85+00		
FED. ROAD DIST. NO.	ILLINOIS	FED. AID PROJECT		

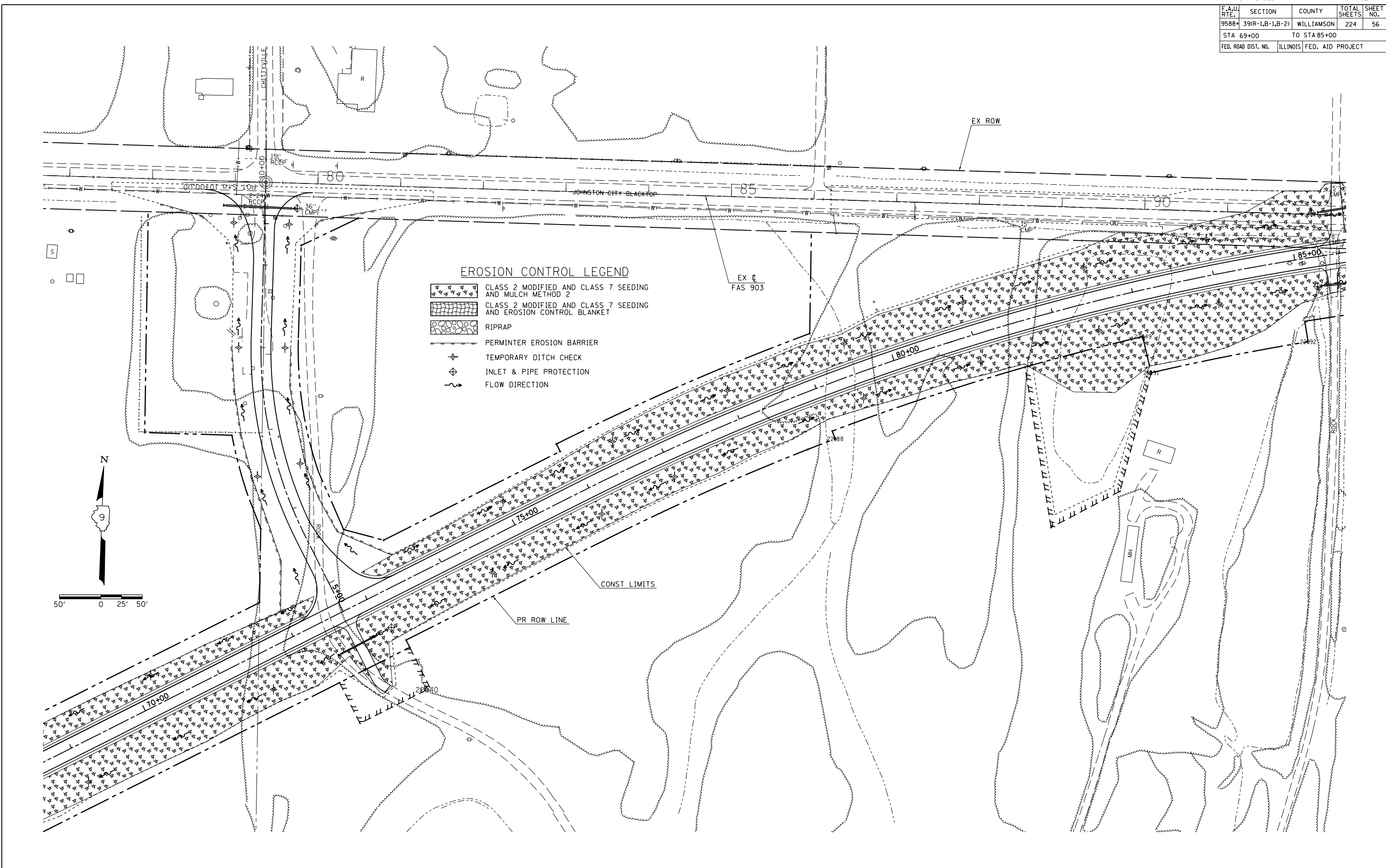

EROSION CONTROL LEGEND

- CLASS 2 MODIFIED AND CLASS 7 SEEDING AND MULCH METHOD 2
- CLASS 2 MODIFIED AND CLASS 7 SEEDING AND EROSION CONTROL BLANKET
- RIPRAP
- PERIMETER EROSION BARRIER
- TEMPORARY DITCH CHECK
- INLET & PIPE PROTECTION
- FLOW DIRECTION

12/12/2013
 C:\DW\WORK\vw\ldot\colemm\0271471\98729-sh1-er.dgn
 REF: m306

EROSION CONTROL PLAN STA 69+00 TO STA 85+00