

• & FAS 903		CN 78277		
F.A.U. RTE.	SECTION	COUNTY	TOTAL SHEETS	SHEET NO.
9588	39(R-1,B-1,B-2)	WILLIAMSON	224	55
STA 57+00		TO STA 71+00		
FED. ROAD DIST. NO.	ILLINOIS	FED. AID PROJECT		

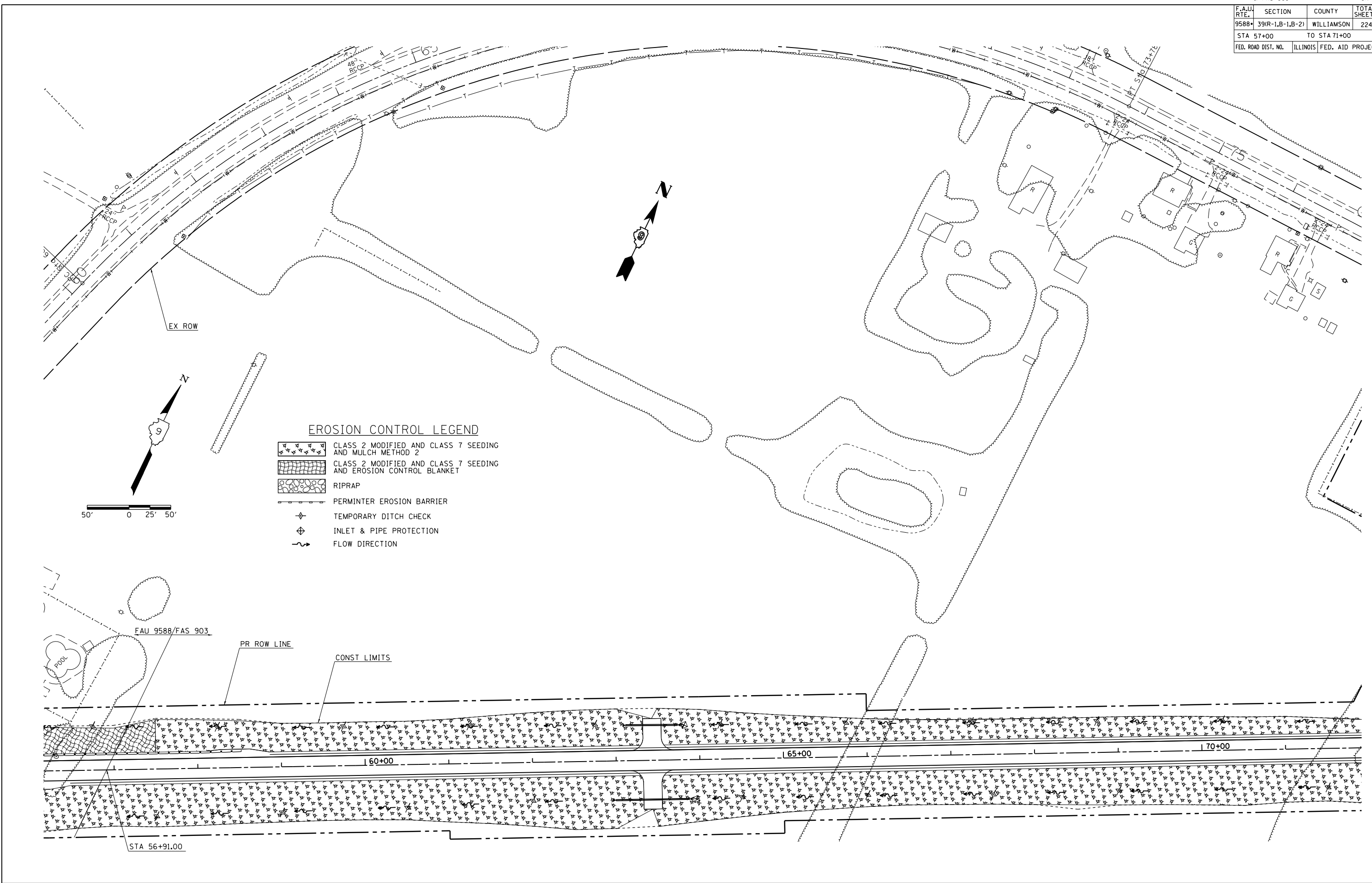

12/12/2013  
 c:\pwwork\vw\dot\colemm\0271741\98729-sh1-er.dgn  
 REF: top05  
 REF: m325

EROSION CONTROL PLAN STA 57+00 TO STA 71+00